



CLICK HERE FOR  
**VIDEO TOUR**



**CUSHMAN &  
WAKEFIELD**

FOR SUBLEASE

**201 REDWOOD SHORES PARWAY**

**SUITE 200: ±12,971 RSF**

Redwood City, California



## PROPERTY HIGHLIGHTS

- ±12,971 RSF Potentially Divisible to ±10,560 RSF
- Available Immediately
- LED: January 31, 2026
- Furniture Available

## SPACE FEATURES

- 1 Board Room
- 26 Offices/Conference Rooms
- Open Area for Workstations
- 2 Phone Rooms
- 2 Kitchenettes
- IT Closet
- Printer/Work Room

**Steve Lico**  
**Managing Director**  
 steve.lico@cushwake.com  
 +1 650 867 0992  
 LIC # 01207120

**Chris Blom**  
**Senior Associate**  
 chris.blom@cushwake.com  
 +1 650 320 0206  
 LIC # 02031205



VIEW SITE SPECIFIC  
COVID - 19  
PREVENTION PLAN

525 University Ave, Ste 220  
 Palo Alto, California 94301  
 main +1 650 852 1200  
 cushmanwakefield.com

©2022 Cushman & Wakefield. All rights reserved. The information contained in this communication is strictly confidential. This information has been obtained from sources believed to be reliable but has not been verified. NO WARRANTY OR REPRESENTATION, EXPRESS OR IMPLIED, IS MADE AS TO THE CONDITION OF THE PROPERTY (OR PROPERTIES) REFERENCED HEREIN OR AS TO THE ACCURACY OR COMPLETENESS OF THE INFORMATION CONTAINED HEREIN, AND SAME IS SUBMITTED SUBJECT TO ERRORS, OMISSIONS, CHANGE OF PRICE, RENTAL OR OTHER CONDITIONS, WITHDRAWAL WITHOUT NOTICE, AND TO ANY SPECIAL LISTING CONDITIONS IMPOSED BY THE PROPERTY OWNER(S). ANY PROJECTIONS, OPINIONS OR ESTIMATES ARE SUBJECT TO UNCERTAINTY AND DO NOT SIGNIFY CURRENT OR FUTURE PROPERTY PERFORMANCE.



FOR SUBLEASE

201 REDWOOD SHORES PARKWAY, SUITE 200  
Redwood City, CA 94065

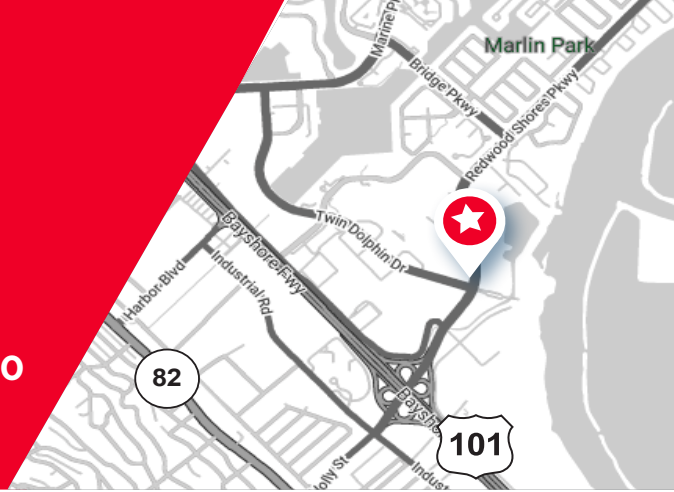

### FLOOR PLAN

±12,971 RSF Potentially Divisible to ±10,560 RSF



[CLICK HERE FOR VIDEO TOUR](#)

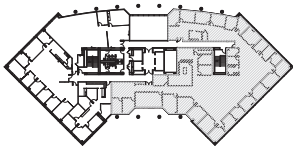

Floor plan not to scale

**Steve Lico**  
Managing Director  
steve.lico@cushwake.com  
+1 650 867 0992  
LIC # 01207120

**Chris Blom**  
Senior Associate  
chris.blom@cushwake.com  
+1 650 931 2210  
LIC # 02031205

525 University Ave, Ste 220  
Palo Alto, California 94301  
main +1 650 852 1200  
cushmanwakefield.com

©2022 Cushman & Wakefield. All rights reserved. The information contained in this communication is strictly confidential. This information has been obtained from sources believed to be reliable but has not been verified. NO WARRANTY OR REPRESENTATION, EXPRESS OR IMPLIED, IS MADE AS TO THE CONDITION OF THE PROPERTY (OR PROPERTIES) REFERENCED HEREIN OR AS TO THE ACCURACY OR COMPLETENESS OF THE INFORMATION CONTAINED HEREIN, AND SAME IS SUBMITTED SUBJECT TO ERRORS, OMISSIONS, CHANGE OF PRICE, RENTAL OR OTHER CONDITIONS, WITHDRAWAL WITHOUT NOTICE, AND TO ANY SPECIAL LISTING CONDITIONS IMPOSED BY THE PROPERTY OWNER(S). ANY PROJECTIONS, OPINIONS OR ESTIMATES ARE SUBJECT TO UNCERTAINTY AND DO NOT SIGNIFY CURRENT OR FUTURE PROPERTY PERFORMANCE.



FOR SUBLEASE

201 REDWOOD SHORES PARKWAY, SUITE 200  
Redwood City, CA 94065

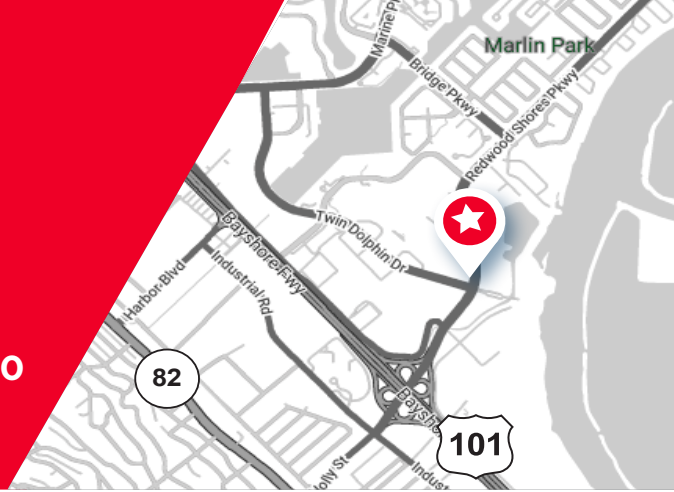

PROPERTY PHOTOS

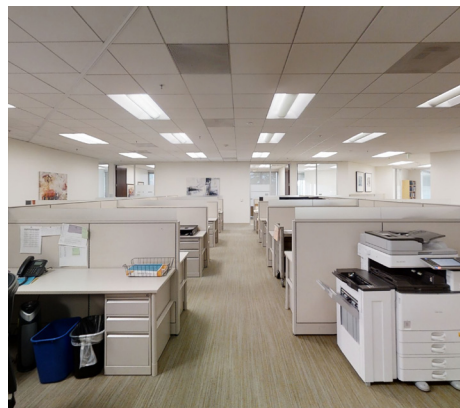

**Steve Lico**  
Managing Director  
steve.lico@cushwake.com  
+1 650 867 0992  
LIC # 01207120

**Chris Blom**  
Senior Associate  
chris.blom@cushwake.com  
+1 650 931 2210  
LIC # 02031205

525 University Ave, Ste 220  
Palo Alto, California 94301  
main +1 650 852 1200  
cushmanwakefield.com



FOR SUBLEASE

201 REDWOOD SHORES PARKWAY, SUITE 200  
Redwood City, CA 94065

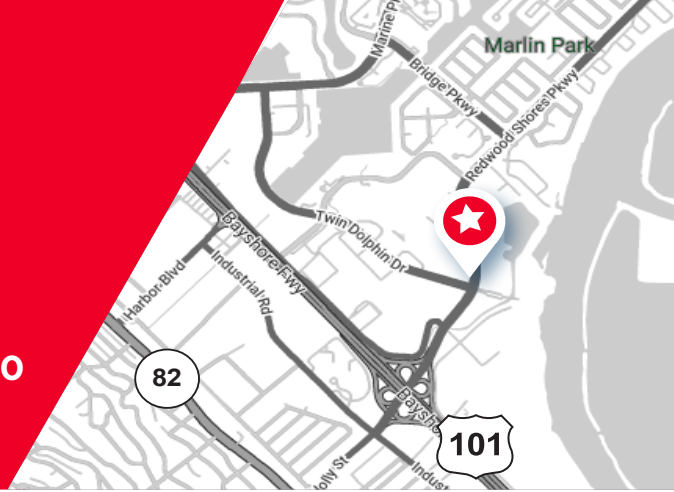

AMENITIES



Steve Lico  
Managing Director  
steve.lico@cushwake.com  
+1 650 867 0992  
LIC # 01207120

Chris Blom  
Senior Associate  
chris.blom@cushwake.com  
+1 650 931 2210  
LIC # 02031205

525 University Ave, Ste 220  
Palo Alto, California 94301  
main +1 650 852 1200  
cushmanwakefield.com