

For Lease

8581 Folsom
Blvd
Sacramento, CA



±37,000 SQUARE FOOT
SINGLE STORY OFFICE BUILDING

FOR LEASE

8581 FOLSOM BLVD

About the Building:

- ±37,000 SF single story building located along Hwy 50 between Howe Ave. & Watt Ave.
- Original BTS for GSA – Social Security Administration Office in 2008
- Incredibly secure property with bollards/fencing surrounding the building
- Interior buildout provides an open plan for a variety of office, storage, and retail uses



Parking Ratio
4.00/1,000 SF

Additional parking available could contribute to an excess of 5-6/1,000 SF

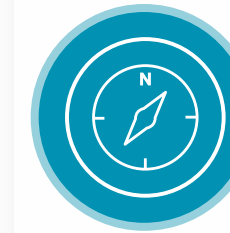

Access to Highway 50 via Watt Ave & 3/4 mile to Watt/Manlove Light Rail Station



Significant Monument Signage in place

Additional Building Signage is Available

Kris Kalmbach

+1 916 288 4421

kris.kalmbach@cushwake.com

CA Lic. #01436668

Spencer Nielsen

+1 916 420 0366

spencer.nielsen@cushwake.com

CA Lic. #01964163

 **CUSHMAN & WAKEFIELD**

Property Highlights:

- ±5 acre parcel consisting of a ±37,000 SF single story office building
- Floor-to-Ceiling height in excess of 10 ft with some areas up to 20 ft
- Single or Multi-Tenant opportunity based on final floorplans
- 2008 construction provides an occupier exceptional savings for any improvements required
- Multiple restroom cores for flexible multi-tenant configurations
- C2 zoning allows multiple uses including office, retail, school, care facility, and fitness



FLOOR PLAN

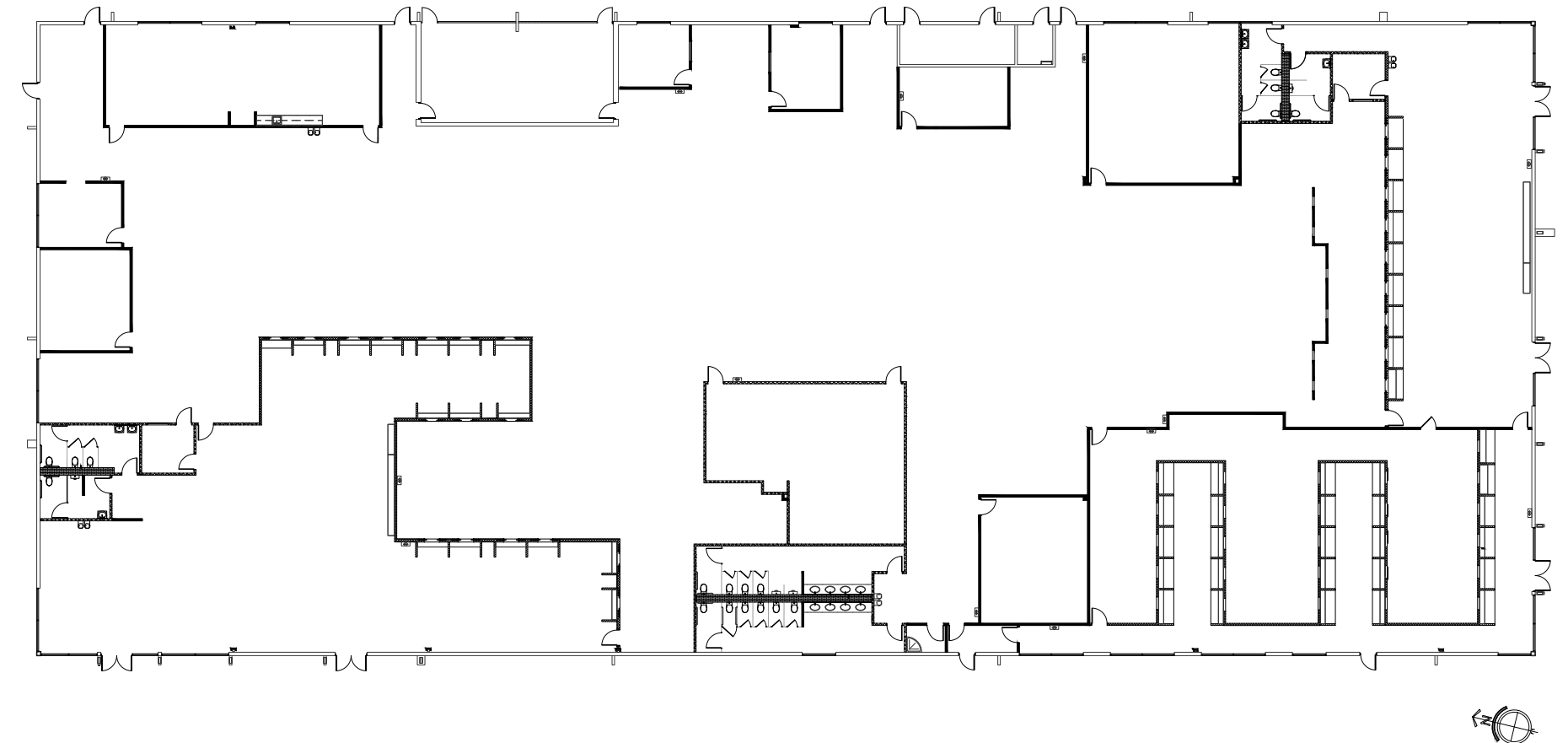

FOLSOM BOULEVARD

Kris Kalmbach

+1 916 288 4421
kris.kalmbach@cushwake.com
CA Lic. #01436668

Spencer Nielsen

+1 916 288 4531
spencer.nielsen@cushwake.com
CA Lic. #01964163

SITE PLAN

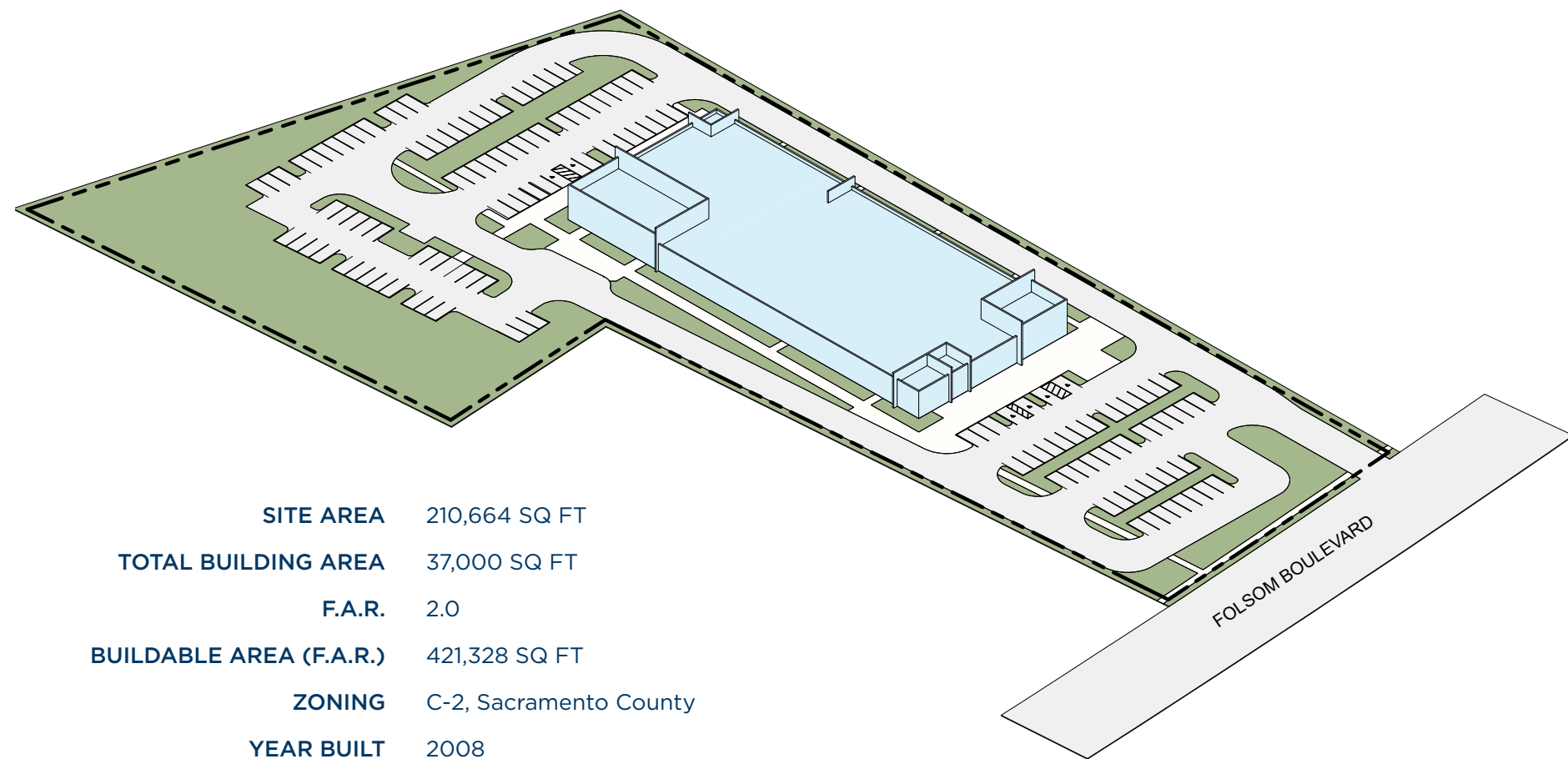

SITE AREA	210,664 SQ FT
TOTAL BUILDING AREA	37,000 SQ FT
F.A.R.	2.0
BUILDABLE AREA (F.A.R.)	421,328 SQ FT
ZONING	C-2, Sacramento County
YEAR BUILT	2008
PARKING	4.0/1,000 SQ FT*
	*Can accommodate up to 6.0/1,000 SQ FT

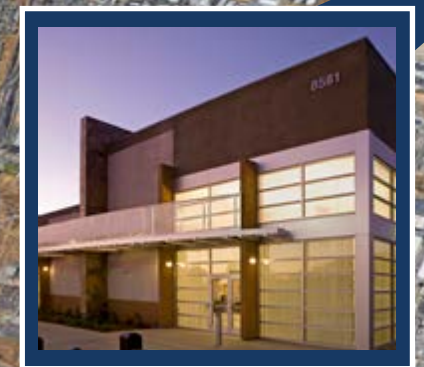

Kris Kalmbach
 +1 916 288 4421
 kris.kalmbach@cushwake.com
 CA Lic. #01436668

Spencer Nielsen
 +1 916 288 4531
 spencer.nielsen@cushwake.com
 CA Lic. #01964163





Kris Kalmbach
 +1 916 288 4421
 kris.kalmbach@cushwake.com
 CA Lic. #01436668

Spencer Nielsen
 +1 916 288 4531
 spencer.nielsen@cushwake.com
 CA Lic. #01964163

©2020 Cushman & Wakefield. All rights reserved. The information contained in this communication is strictly confidential. This information has been obtained from sources believed to be reliable but has not been verified. NO WARRANTY OR REPRESENTATION, EXPRESS OR IMPLIED, IS MADE AS TO THE CONDITION OF THE PROPERTY (OR PROPERTIES) REFERENCED HEREIN OR AS TO THE ACCURACY OR COMPLETENESS OF THE INFORMATION CONTAINED HEREIN, AND SAME IS SUBMITTED SUBJECT TO ERRORS, OMISSIONS, CHANGE OF PRICE, RENTAL OR OTHER CONDITIONS, WITHDRAWAL WITHOUT NOTICE, AND TO ANY SPECIAL LISTING CONDITIONS IMPOSED BY THE PROPERTY OWNER(S). ANY PROJECTIONS, OPINIONS OR ESTIMATES ARE SUBJECT TO UNCERTAINTY AND DO NOT SIGNIFY CURRENT OR FUTURE PROPERTY PERFORMANCE.

