

FOR LEASE
±368,881 SF



I-35 LOGISTICS PARK

BUILDING II | 15800 S. GREEN ROAD, OLATHE, KS

PROPERTY HIGHLIGHTS

Building Size:	569,584 SF
Space Available:	148,227 - 368,881 SF
Office Area:	±2,600 SF (Expandable)
Site Area:	30 Acres
Clear Height:	36'
Loading:	52 (Fully Equipped, Expandable) 2 Drive-In Doors
Auto Parking Spaces:	253
Trailer Parking Spaces:	116
Column Spacing:	54' x 50' typical with Speed bays 54' x 60'
Building Dimensions:	1,092' x 520'
Lighting:	LED Lights on Motion Sensors
Slab Thickness:	7' Unreinforced
Fire Protection:	ESFR Sprinkler
Power:	2400 Amp, 480 Volt, 3 Phase, 4 Wire
Zoning:	M2
Taxes:	10 Years, 50% Abatement
Insurance:	\$0.15
CAM:	\$0.30

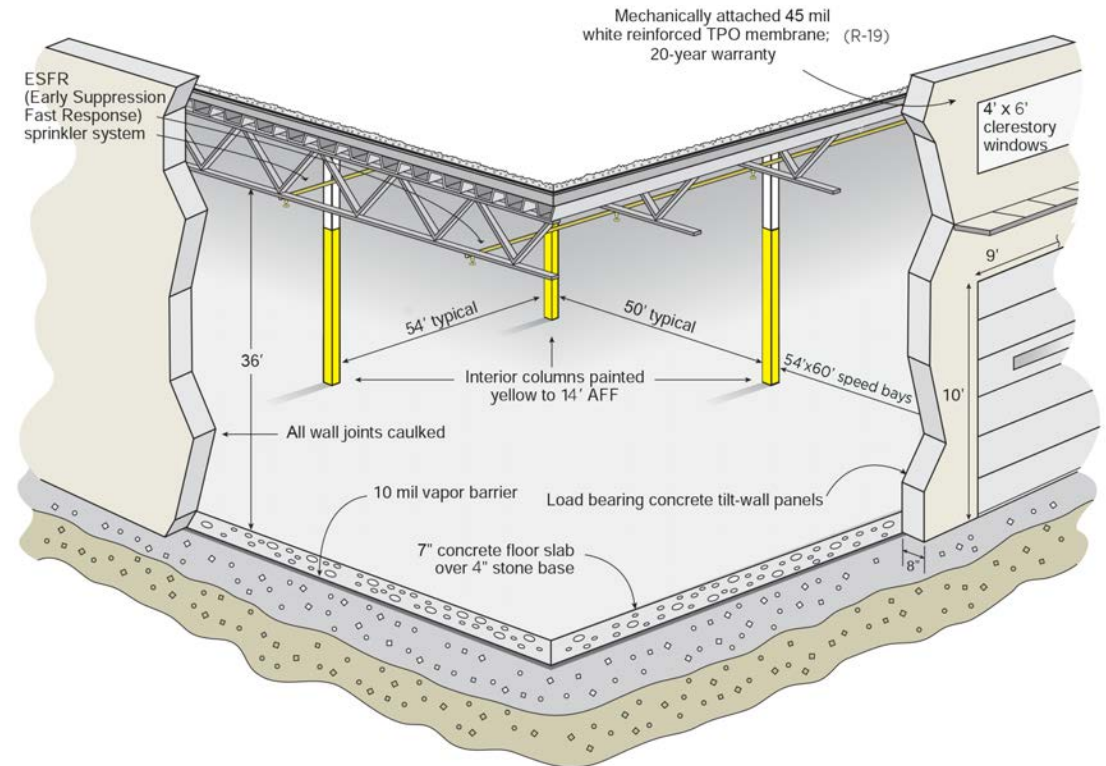

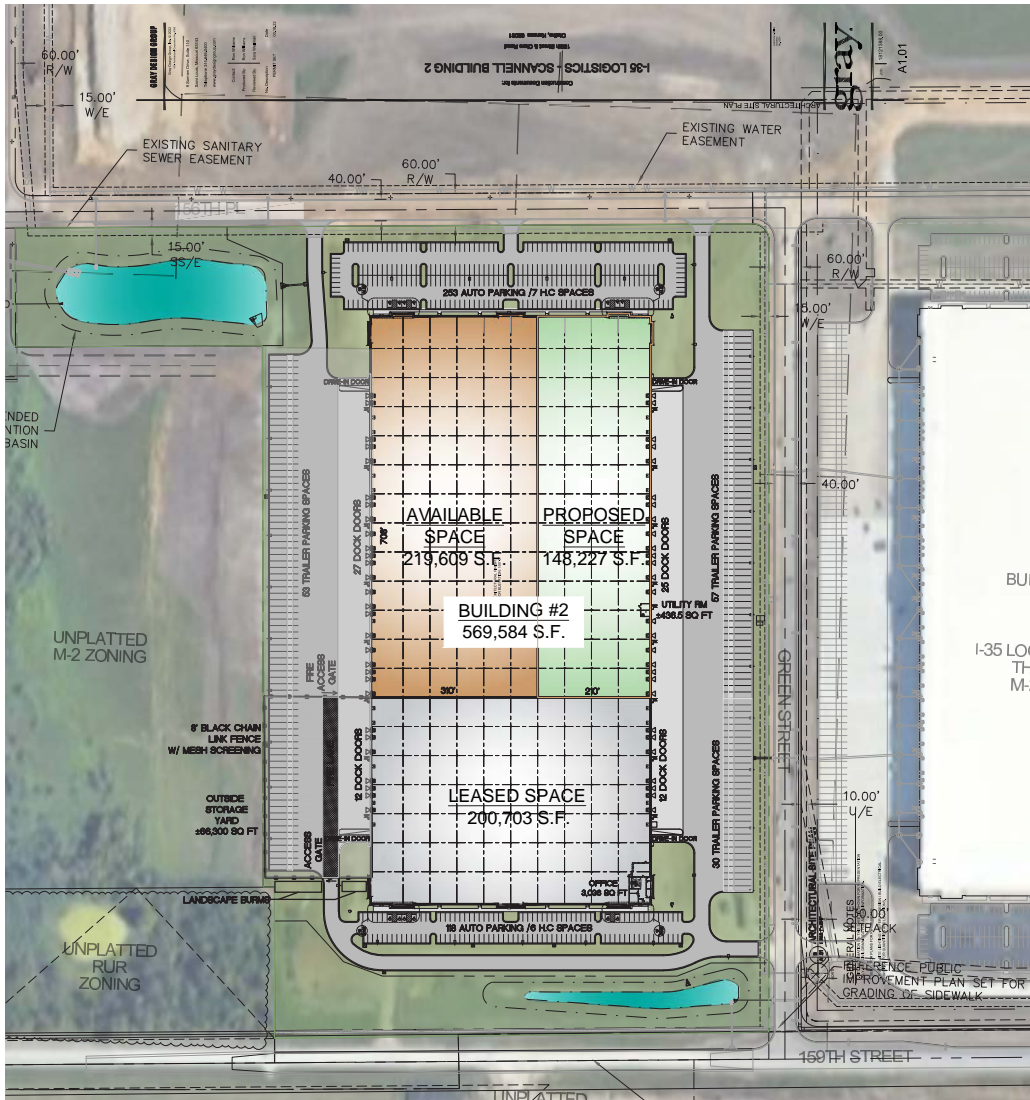

SPEC OFFICE PLAN

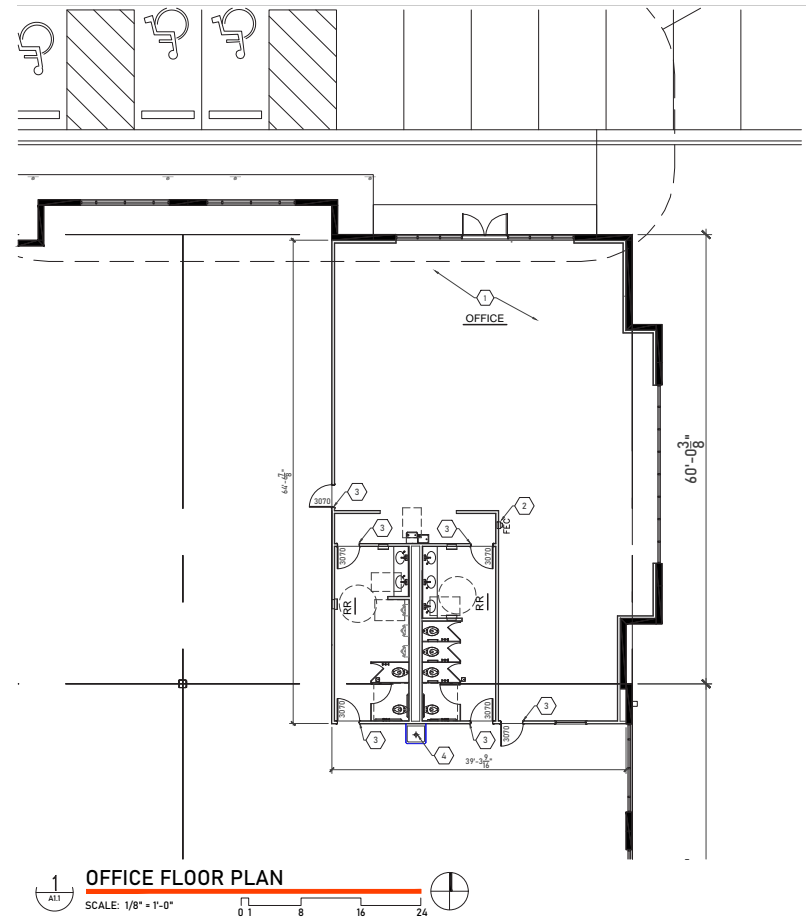

BUILDING PLAN
±368,881 SF

LOCATION AERIAL

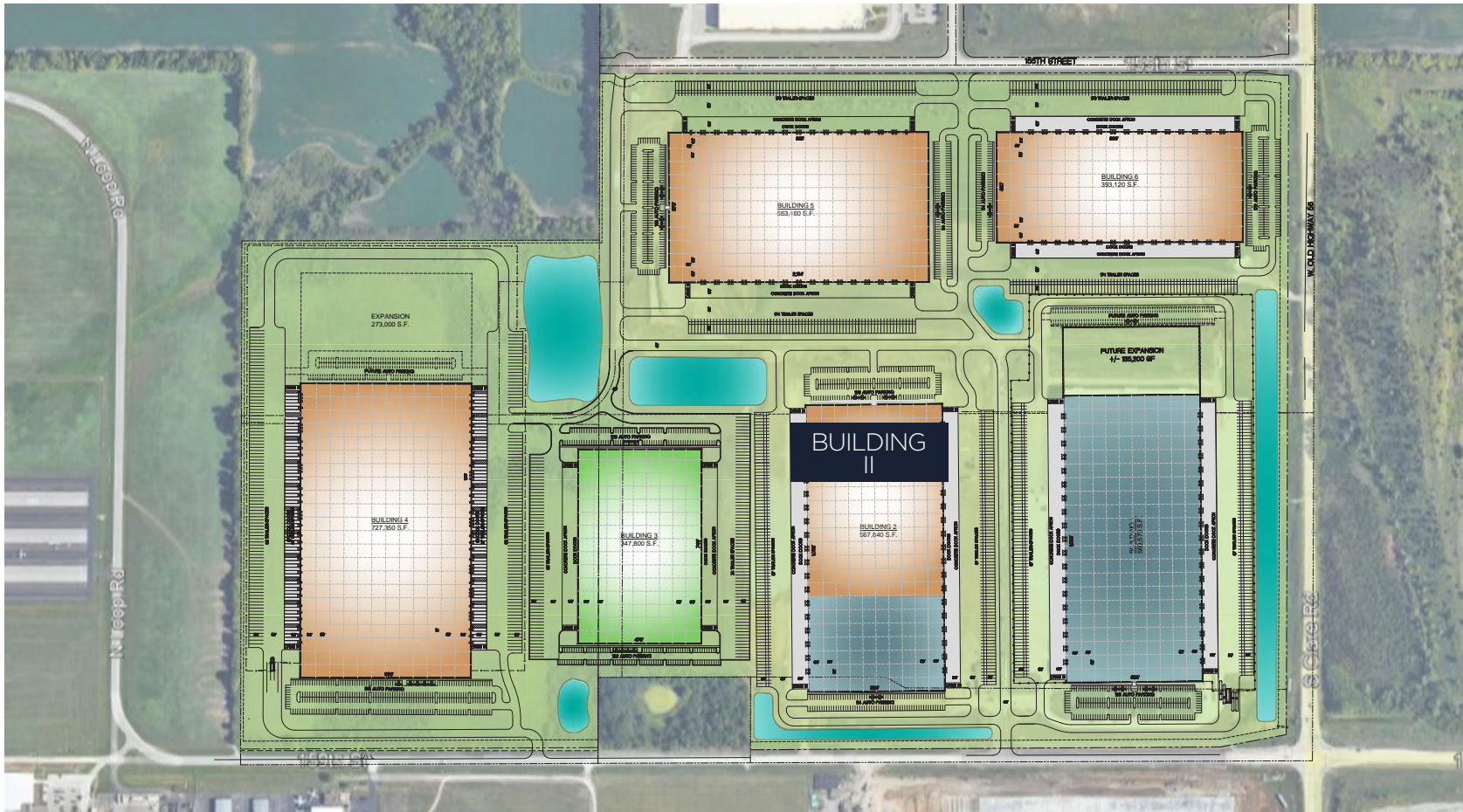

CONTACT INFORMATION:

JOSEPH S. ACCURSO

Vice Chair
+1 816 412 0216
joe.accurso@cushwake.com

ROB M. HOLLAND, CCIM

Managing Director
+1 816 412 0214
rob.holland@cushwake.com

