



# STEIN MART PLAZA RETAIL SPACE FOR LEASE

25001-25099 CENTER RIDGE RD, WESTLAKE, OHIO 44145

# 25001-25099 CENTER RIDGE RD WESTLAKE, OHIO 44145

## OVERVIEW

- Signalized access from Center Ridge Road (over 11,500 VPD); over 520' of frontage on Center Ridge.
- Easy accessibility: approximately 1.25 miles from I-90 and 3.5 miles to I-480
- Flexible general business zoning allowing for a variety of retail/commercial uses
- Neighboring tenants include: Travel Centers of America, Cuyahoga Community College, Walgreens, GetGo, Primrose Day CareCenter, Gales Nursey, Once Upon A Child, and O'Reilly Auto Parts

## AVAILABLE SPACE

1,120 SF

10,000 SF\*

\*Demisable to 5,000 SF

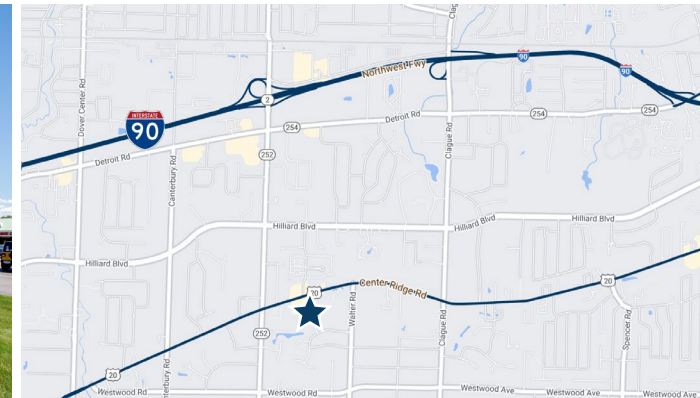

## DEMOGRAPHICS

**159,184**  
Population  
(2024 | 5 Mile)

**44.4**  
Median Age  
(2024 | 5 Mile)

**71,569**  
Households  
(2024 | 5 Mile)

**\$131,928**  
HH Income  
(2024 | 5 Mile)

**6,748**  
Total Businesses  
(2024 | 5 Mile)

25001-25099  
CENTER RIDGE RD  
WESTLAKE, OHIO 44145



168 PARKING SPACES

CENTER RIDGE RD 12,149 VPD



# 25001-25099 CENTER RIDGE RD, WESTLAKE, OHIO 44145

**ALEX SMITH**  
Senior Associate  
+1 216 525 1490  
asmith@crescorealestate.com

**RYAN FISHER**  
Senior Vice President  
+1 216 525 1497  
rfisher@crescorealestate.com

**CAMERON CALLAHAN**  
Associate  
+1 216 232 4101  
ccallahan@crescorealestate.com

Cushman & Wakefield | CRESCO Real Estate  
6100 Rockside Woods Blvd, Suite 200,  
Cleveland, OH 44131  
crescorealestate.com

©2024 Cushman & Wakefield. All rights reserved. The information contained in this communication is strictly confidential. This information has been obtained from sources believed to be reliable but has not been verified. NO WARRANTY OR REPRESENTATION, EXPRESS OR IMPLIED, IS MADE AS TO THE CONDITION OF THE PROPERTY (OR PROPERTIES) REFERENCED HEREIN OR AS TO THE ACCURACY OR COMPLETENESS OF THE INFORMATION CONTAINED HEREIN, AND SAME IS SUBMITTED SUBJECT TO ERRORS, OMISSIONS, CHANGE OF PRICE, RENTAL OR OTHER CONDITIONS, WITHDRAWAL WITHOUT NOTICE, AND TO ANY SPECIAL LISTING CONDITIONS IMPOSED BY THE PROPERTY OWNER(S). ANY PROJECTIONS, OPINIONS OR ESTIMATES ARE SUBJECT TO UNCERTAINTY AND DO NOT SIGNIFY CURRENT OR FUTURE PROPERTY PERFORMANCE.