



CENTRAL LOCATION SERVING SANTA CRUZ, MONTEREY AND SAN BENITO COUNTIES

Property Highlights

- Three (3) Dock High & One (1) Grade Level Roll Up Door
- Ample Power (400A 3ph 208V)
- 12 On-Site Parking Spaces & 7 across the Street -
Totaling 19 Parking Spaces

Space/Pricing Details

- Total Building Size: ±88,721 SF
- Total SF Available: ±39,447 SF
(44.46% of Building)

\$0.65/SF/Month Base Rent plus NNN @ **(\$0.35±)**

\$39,447 per month (Base Rent + NNN)

Reuben Helick
Managing Director
+1 831 647 2109
reuben.helick@cushwake.com
LIC #01171272

Doud Arcade Building | Suite 202
Ocean Avenue South
PO Box 999
Carmel-by-the-Sea, CA 93921 | USA
main +1 831 375 8000
cushmanwakefield.com

Floor Plan

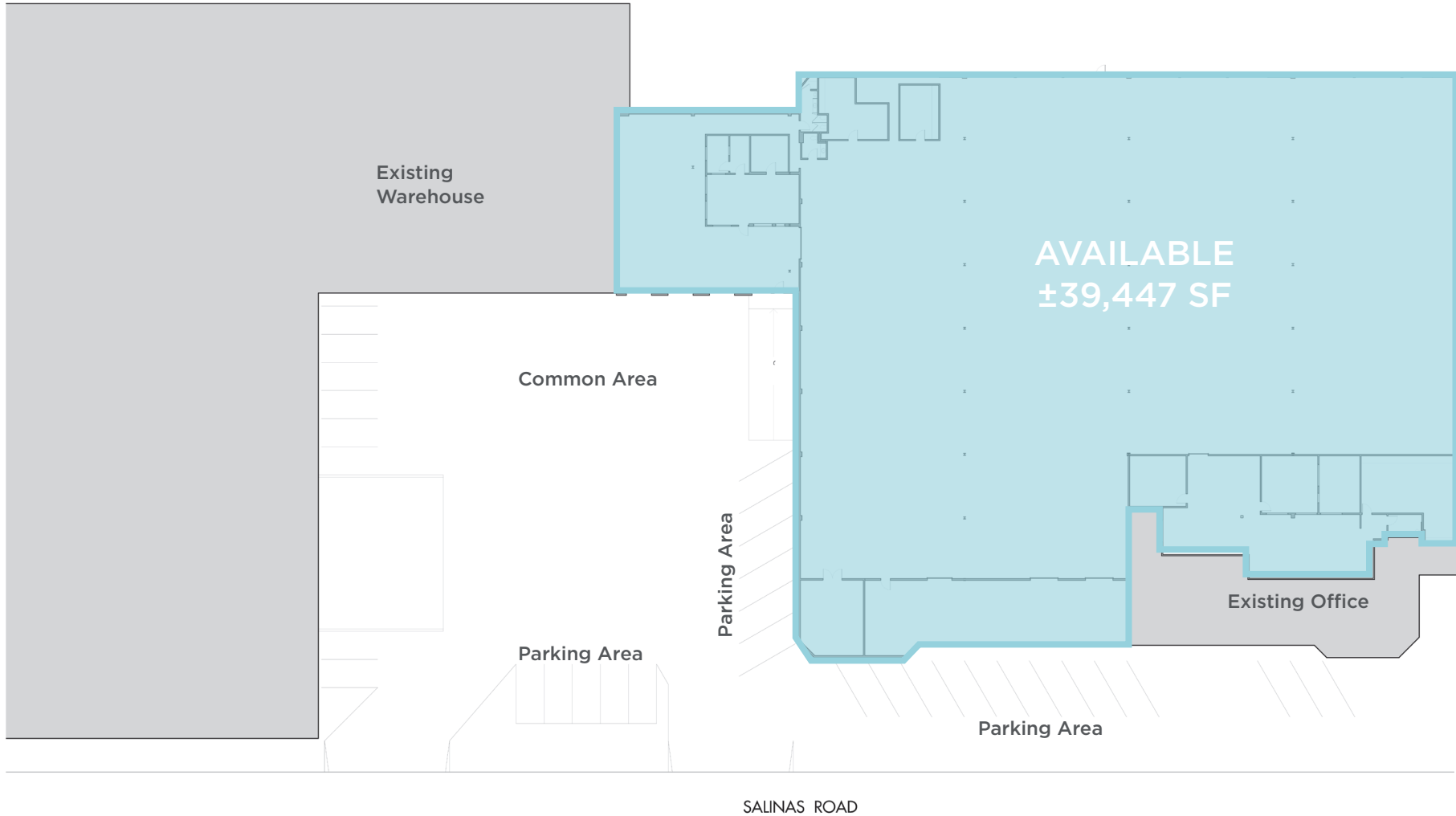

Reuben Helick
Managing Director
+1 831 647 2109
reuben.helick@cushwake.com
LIC #01171272

Doud Arcade Building | Suite 202
Ocean Avenue South
PO Box 999
Carmel-by-the-Sea, CA 93921 | USA
main +1 831 375 8000
cushmanwakefield.com

Interior Photos



THREE DOCK HIGH ROLL UP DOORS



WAREHOUSE INTERIOR



SHIPPING/RECEIVING OFFICE



INSULATED, AIR CONDITIONED WAREHOUSE

Reuben Helick
Managing Director
+1 831 647 2109
reuben.helick@cushwake.com
LIC #01171272

Doud Arcade Building | Suite 202
Ocean Avenue South
PO Box 999
Carmel-by-the-Sea, CA 93921 | USA
main +1 831 375 8000
cushmanwakefield.com

Location Map



Exterior Photos



Reuben Helick
Managing Director
+1 831 647 2109
reuben.helick@cushwake.com
LIC #01171272

Doud Arcade Building | Suite 202
Ocean Avenue South
PO Box 999
Carmel-by-the-Sea, CA 93921 | USA
main +1 831 375 8000
cushmanwakefield.com