



ONE & TWO
PENN MARK

FOR
LEASE:

CLASS A OFFICE

COMPLEX IN

PRESTIGIOUS

CARMEL MERIDIAN

CORRIDOR

11595 - 11555 NORTH MERIDIAN STREET / CARMEL, INDIANA 46032

ONE PENN MARK PLAZA

—
ATRIUM LOBBY
RENOVATIONS



REDEFINING THE FIRST-CLASS EXPERIENCE

TWO PENN MARK PLAZA

LOBBY
RENOVATIONS



IN THE CARMEL MERIDIAN CORRIDOR

THE NEW WORK-LIFE STANDARD

START STRONG

Start your day with the welcoming glow of freshly renovated front lobbies



BUILD CONNECTIONS:

Take time to delve into today's opportunities over a quick game of pool in the Millennium Lounge

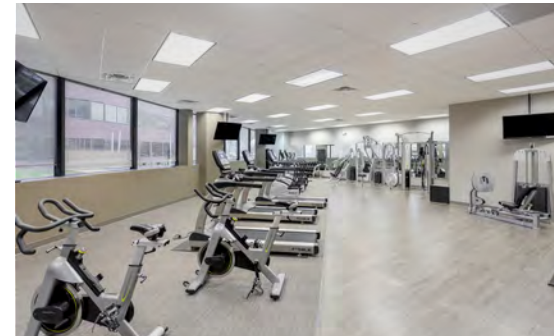

GET PUMPED

Enhance your commitment to wellness at the on-site fitness center, offering modern equipment, towel service, private lockers, and showers

TAKE IT OUTSIDE

Connect and recharge with informal, sunlit meetings and outdoor exercise machines



LEVELED UP COLLABORATION

Whether you need a meeting for 10 or 60+, the upgraded conference center can be customized to fit your conferencing needs

KEEPING YOU MOVING AT THE SPEED OF BUSINESS

HIGH VISIBILITY

Enjoy unobstructed Meridian Corporate Corridor exposure along US-31 and 116th Street along with an opportunity for monument and exterior signage



ON-SITE CAFÉ

Grab a quick meal or coffee to stay focused on what matters most

FULL-FLOOR SUITES

Get the space you need to grow your business

PARKING

4.3/1,000 parking ratio

ENERGY STAR CERTIFIED

Constructed with maximum productivity and conservation in mind, One and Two Penn Mark Plaza generates an average of 35% fewer greenhouse gas emissions and costs \$0.054 less to operate

LEAVE THE DETAILS TO US

On-site property management and concierge ensure you don't have stress over the little details



ONE PENN MARK

FLOORPLANS

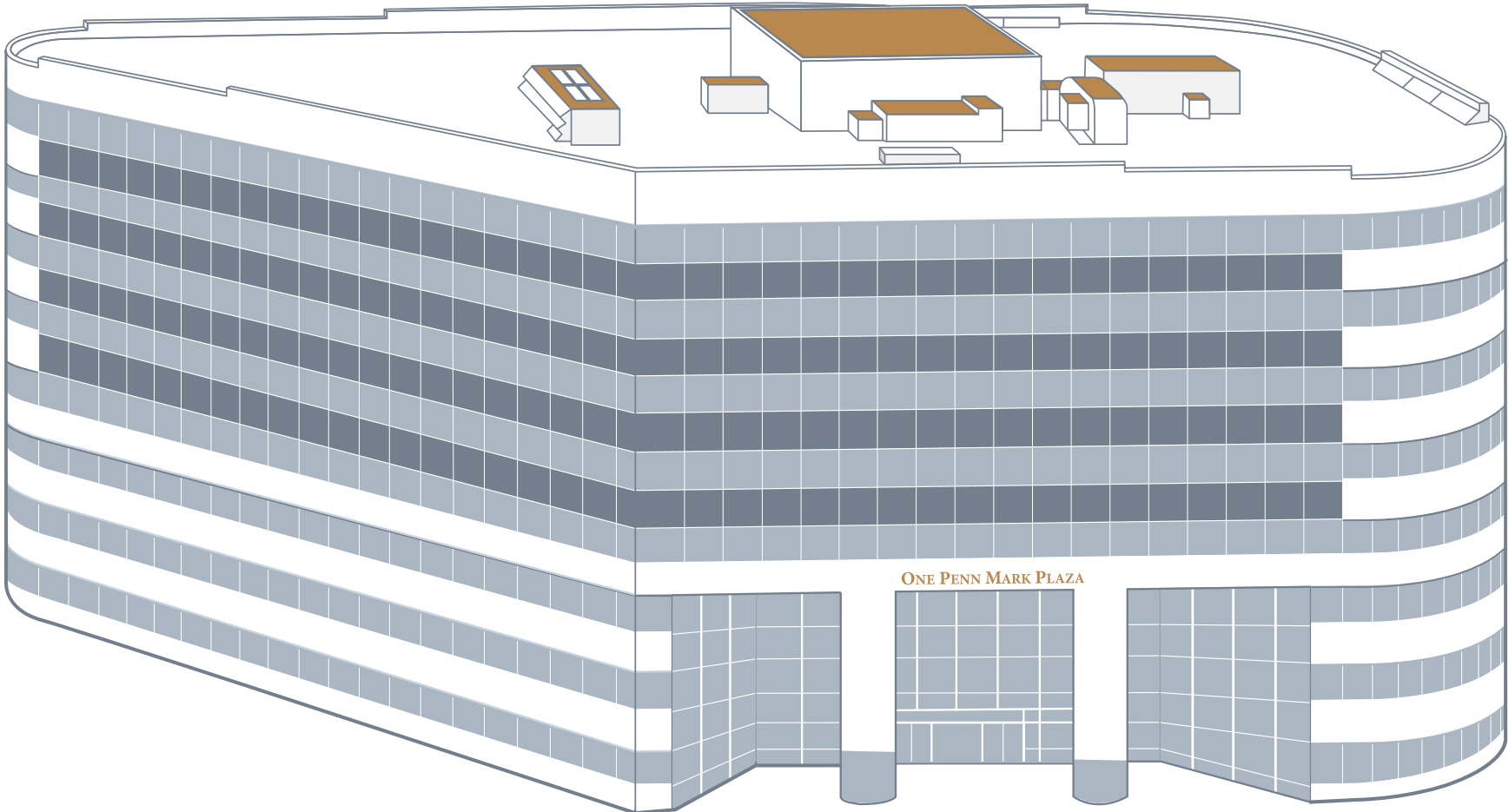

CLICK ABOVE TO
VIEW DETAILS

TWO PENN MARK

FLOORPLANS

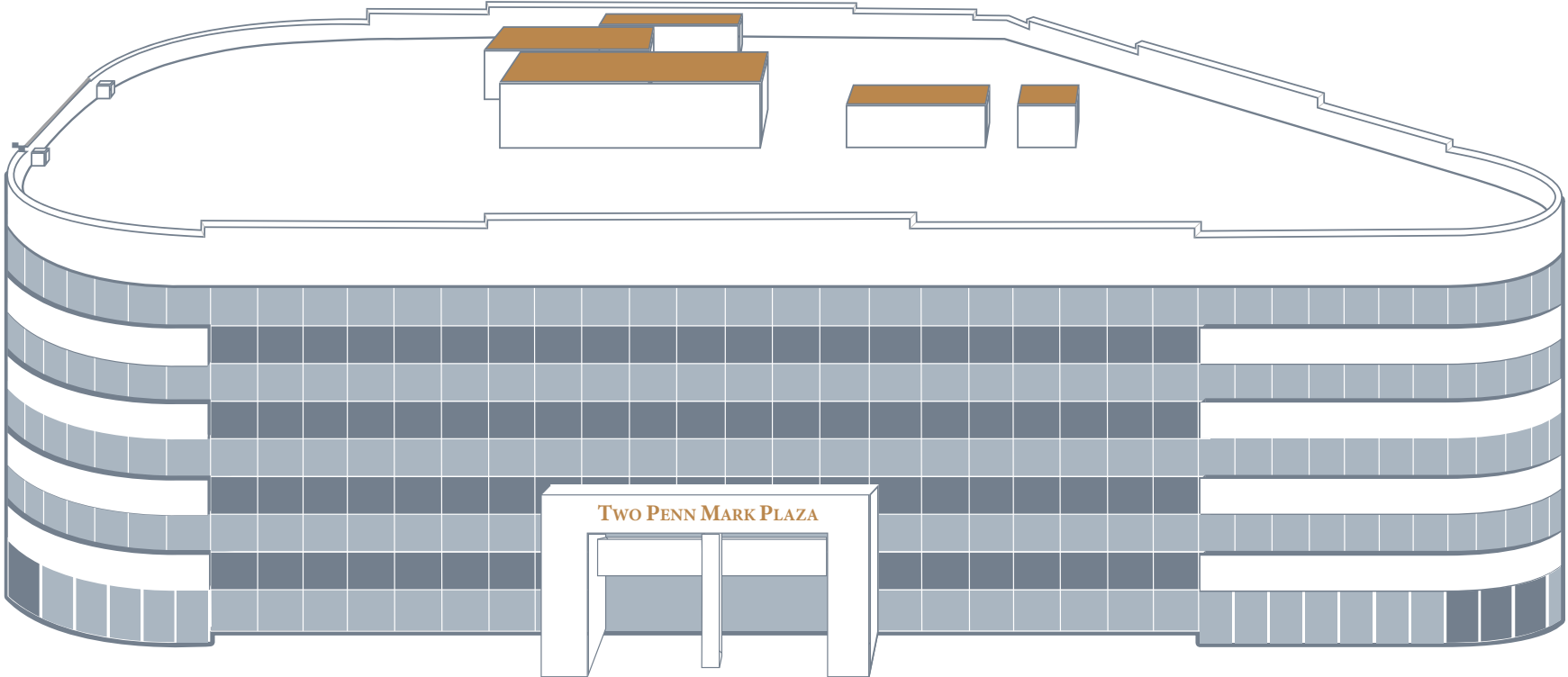

CLICK ABOVE TO
VIEW DETAILS

LOCAL AMENITIES

Located at the intersection of US-31 and 116th Street in the heart of The Meridian Corridor, One & Two Penn Mark Plaza is steps away from everything you need to thrive.

- | | | |
|----------------------------|------------------------|----------------------|
| 1 The Pint Room | 1 Hilton Garden Inn | 16 Sauce on the Side |
| 2 Peace Water Winery | 2 Fairfield Inn | 17 Yats |
| 3 Sun King Brewery | 3 Home2Suites | 18 Condado Tacos |
| 4 The Palladium | 4 Hyatt Place | 19 Miracle Sushi |
| 5 Booth Tarkington Theatre | 5 Renaissance North | 20 Divvy |
| 6 Central Park | 6 Residence Inn | 21 Matt the Miller's |
| 1 Vitality Bowls | 7 SpringHill Suites | 22 The Old Spaghetti |
| 2 Chicken Salad Chick | 8 Hotel Carmichael | Factory |
| 3 Naf Naf Grill | 9 Homewood Suites | 23 Flight Burger |
| 4 Chipotle | 10 Staybridge Suites | 24 Wahlburgers |
| 5 Panda Express | 1 Wild Eggs | 25 Upland Tap House |
| 6 Blaze Pizza | 2 Fat Dan's Deli | 26 Caliente |
| 7 Alli Poke | 3 Bub's Burgers | 27 Piada Italian |
| 8 Subway | 4 Pad Thai | 28 City Barbeque |
| 9 Kolache Factory | 5 Juniper on Main | 29 Convivio Italian |
| 10 Noodles & Co | 6 Verde of Mexico | Artisan |
| 11 Panera Bread | 7 Bar Louie | 30 Caffe Buondi |
| 12 Bibibop Asian Grill | 8 Rize Carmel | 31 Los Arroyos |
| 13 Jimmy John's | 9 BRU Burger Bar | 32 Lou Malnati's |
| 14 McDonalds | 10 Anthony's Chophouse | 1 Meijer |
| 15 GetGo Cafe Market | 11 Bazbeaux Pizza | 2 Carmel City Centre |
| 16 Starbucks | 12 Ristorante Roma | 3 Kroger |
| 1 Burn Boot Camp | 13 Muldoon's | 4 CVS Pharmacy |
| 2 SoulCycle | 14 Social Cantina | 5 Walgreens |
| 3 Shred415 Indy | 15 La Hacienda | 6 Market District |

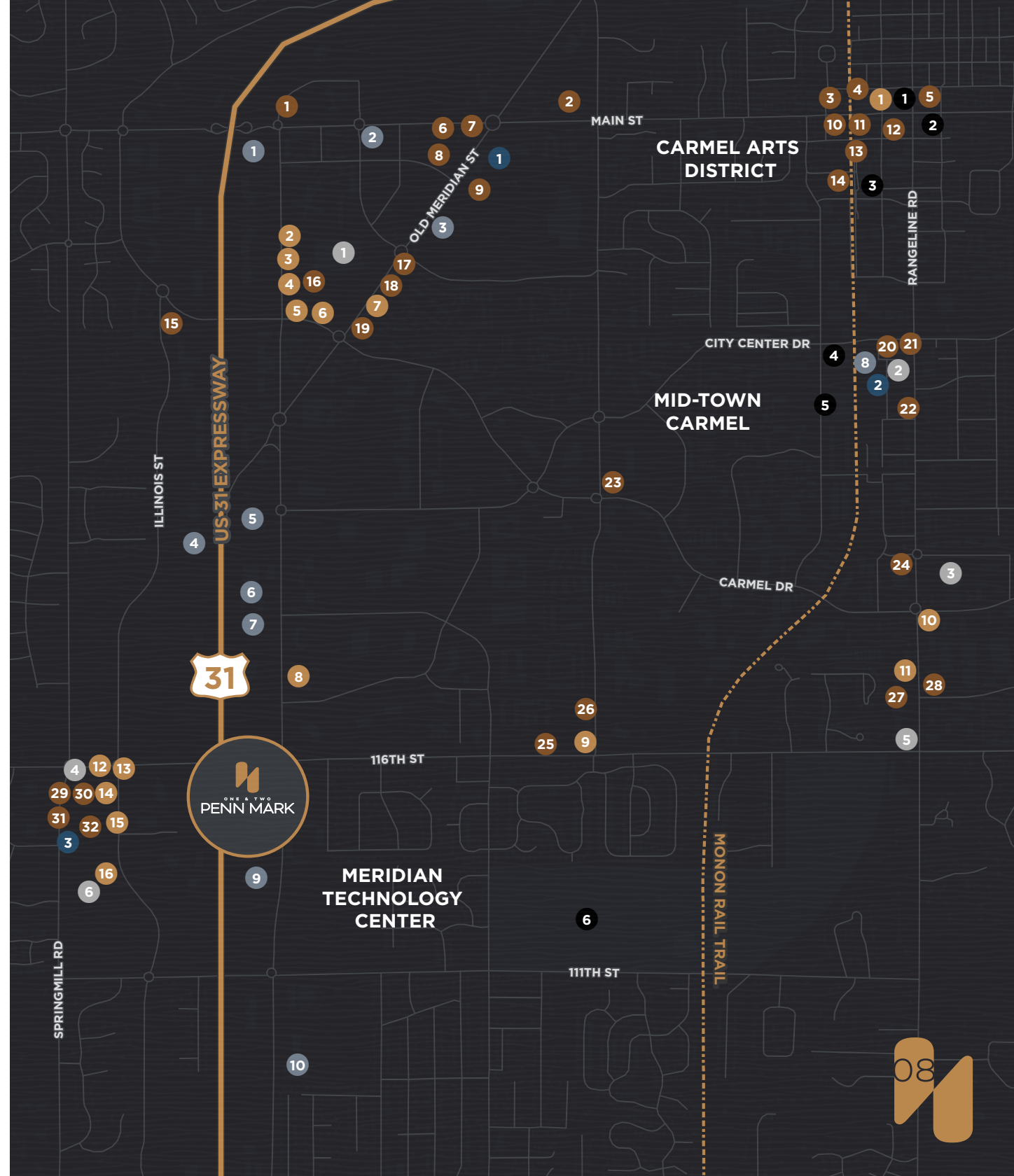



FOR MORE
INFORMATION,
PLEASE
CONTACT

DAVE MOORE
MANAGING DIRECTOR

317 639-0490

david.moore@cushwake.com

BENNETT M. WILLIAMS
DIRECTOR

+1 317 639 0442

bennett.williams@cushwake.com

OWNED BY



LEASED AND MANAGED BY



2023 Cushman & Wakefield. All rights reserved. The information contained in this communication is strictly confidential. This information has been obtained from sources believed to be reliable but has not been verified. No warranty or representation, express or implied, is made as to the condition of the property (or properties) referenced herein or as to the accuracy or completeness of the information contained herein, and same is submitted subject to errors, omissions, change of price, rental or other conditions, withdrawal without notice, and to any special listing conditions imposed by the property owner(s). Any projections, opinions or estimates are subject to uncertainty and do not signify current or future property performance.