

650 SOUTH EXETER STREET

BUILDING SIGNAGE OPPORTUNITY



BUILDING FEATURES

11-STORY, 207,000 SF CLASS-A OFFICE BUILDING

- Home to local Baltimore office of Morgan Stanley
- Large 34,815 SF efficient column-free floor plates
- In-building amenities include Maryland Athletic Club, Starbucks, Bonobos, Landmark Theater, Arhaus, White House Black Market, Lululemon, Allen Edmonds, Häagen Dazs, CVS Pharmacy and more
- Direct elevator access from parking garage to office floors
- 1/1,000 in-building parking and 2/1,000 in various area garages for a total of 3/1,000
- BOMA Mid-Atlantic Building of the Year 2015 Award Recipient
- BOMA 360 Designation



34,815 SF FLOOR PLATE

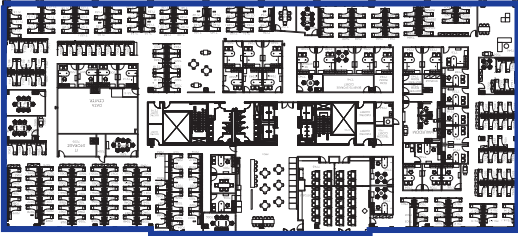

7TH FLOOR
34,815 RSF
DIVISIBLE TO 5,000 SF

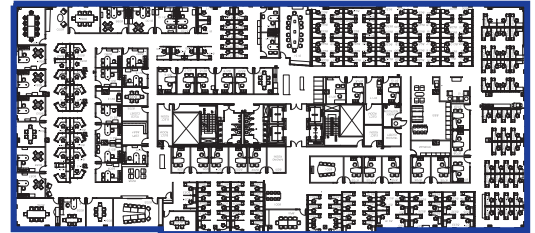

8TH FLOOR
34,815 RSF
DIVISIBLE TO 5,000 SF

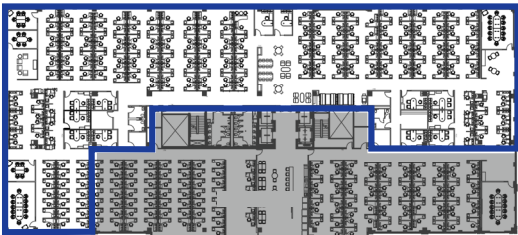

9TH FLOOR
22,841 RSF
DIVISIBLE TO 5,000 SF



10TH FLOOR
4,206 - 11,816
CONTIGUOUS RSF

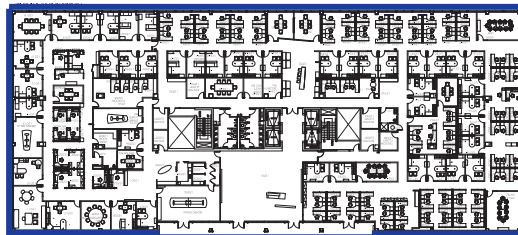

12TH FLOOR
34,815 RSF
DIVISIBLE TO 5,000 SF

available space

69,630 RSF CONTIGUOUS
139,102 RSF TOTAL AVAILABLE

Brian P. Wyatt
T: +1 410 347 7804
brian.wyatt@cushwake.com

Bronwyn LeGette
T: +1 410 347 7565
bronwyn.legette@cushwake.com

David J. Downey, Jr., CCIM
T: +1 410 347 7536
david.downey@cushwake.com