



# 125 EAST COURT

CINCINNATI, OH 45202



**CUSHMAN &  
WAKEFIELD**



## BUILDING SPECS

**98,568**  
BUILDING SF

**19,488**  
AVAILABLE SF

**19,488**  
LARGEST  
CONTIGUOUS  
RSF

**3,151**  
MINIMUM  
DIVISIBLE  
RSF

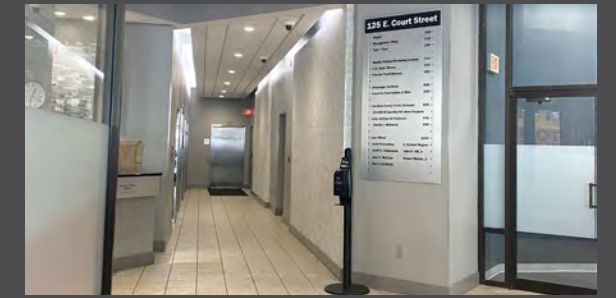

Lobby entrance with on-site security.



Attached parking garage located behind the building.

### **LIMITED TIME OPPORTUNITY!**

**\$12.95/SF FSG FOR A FULL FLOOR TENANT ON THE 5TH FLOOR!  
MOVE-IN READY, PLUG & PLAY SPACE DELIVERED IN AS-IS CONDITION**

**ASKING \$14.95/SF FSG**

# HIGHLIGHTS

- Ten-story office building with first floor retail
- First floor retail features Dunkin' Donuts
- The first four floors of the building provide direct access to the attached six-story parking garage
- On-site management and security guard
- Located downtown Cincinnati and across from Kroger on the Rhine
- Walking distance to the Court House, Washington Park, Over-the-Rhine, Pendleton, Hard Rock Casino and many other amenities



# 125 EAST COURT PHOTOS



# LIMITED TIME OPPORTUNITY!

\$12.95/SF FSG FOR A FULL FLOOR TENANT  
ON THE 5TH FLOOR!  
MOVE-IN READY, PLUG & PLAY SPACE  
DELIVERED IN AS-IS CONDITION

## 5TH FLOOR PLUG & PLAY SPACE

- 12,676 TOTAL RSF
- FURNISHED
- TWO FULL KITCHENS - CAN BE USED AS TEST KITCHEN
- LOUNGE AREA
- COLLABORATIVE BREAK ROOM
- ATTRACTIVE FINISHES
- TWO CONFERENCE ROOMS
- MODERN LAYOUT
- MIX OF PRIVATE OFFICES AND OPEN WORKSPACE
- OPEN TO A SHORT TERM LEASE

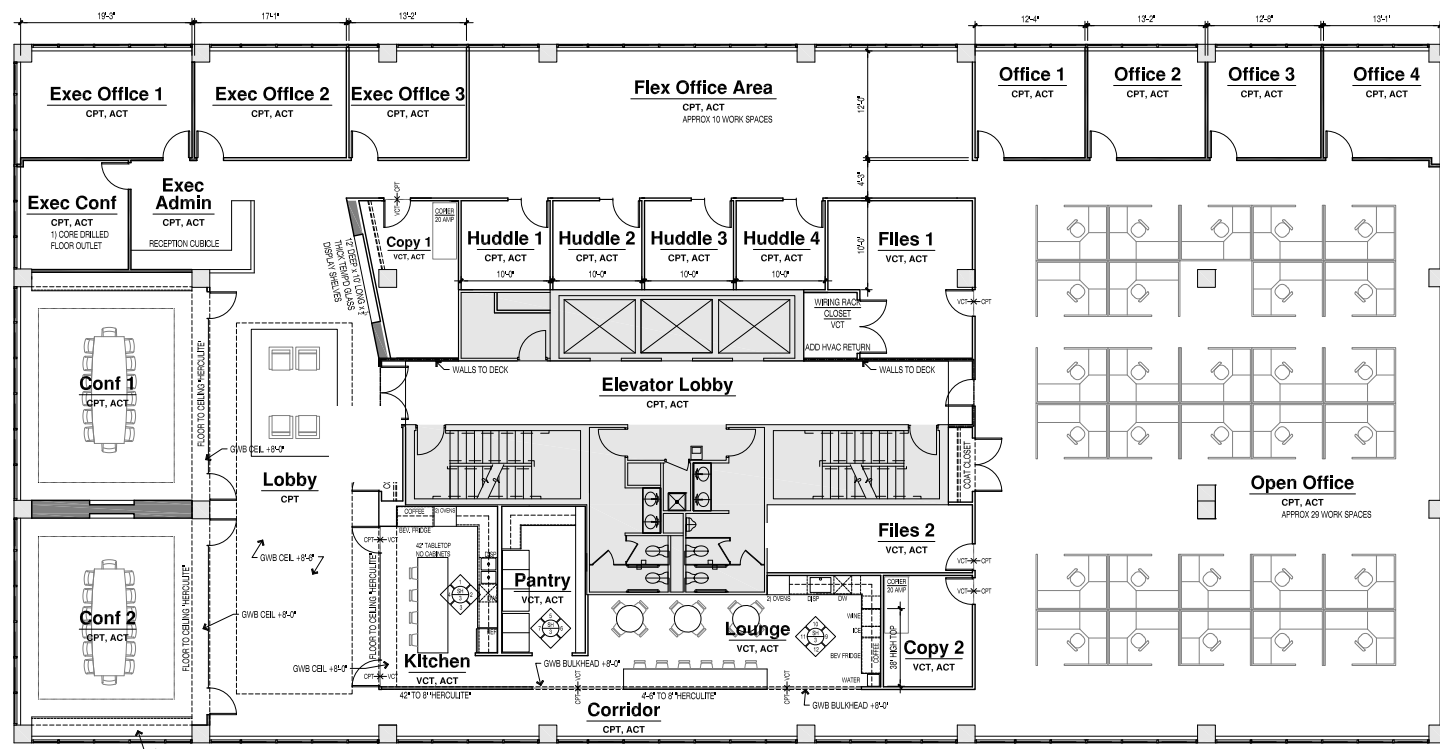

# MOVE-IN READY & FURNISHED!



# 4TH FLOOR

6,812 TOTAL RSF

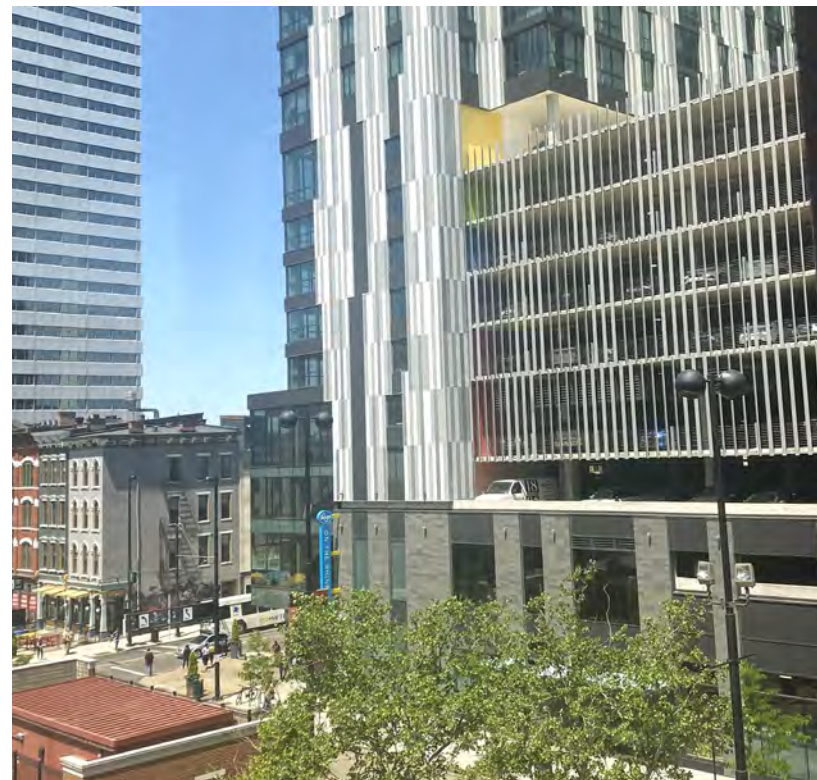
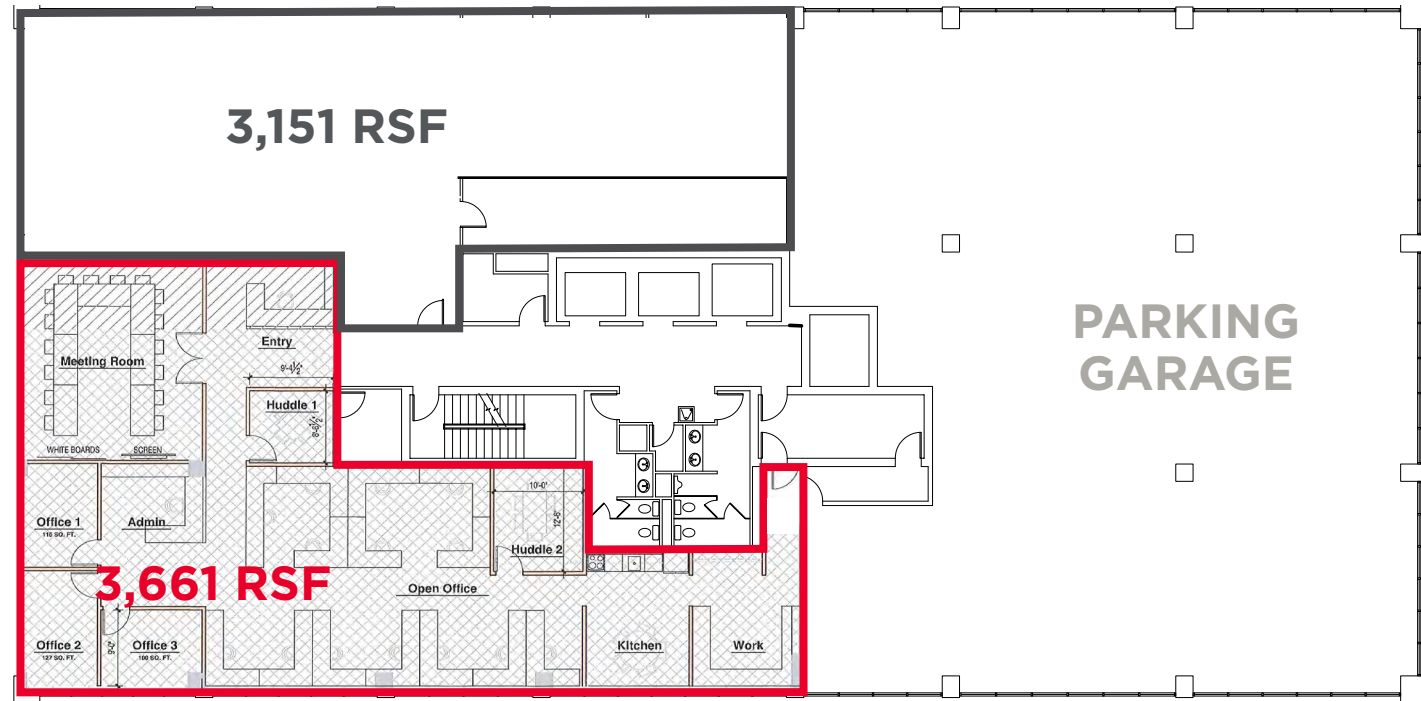

# NEIGHBORHOOD

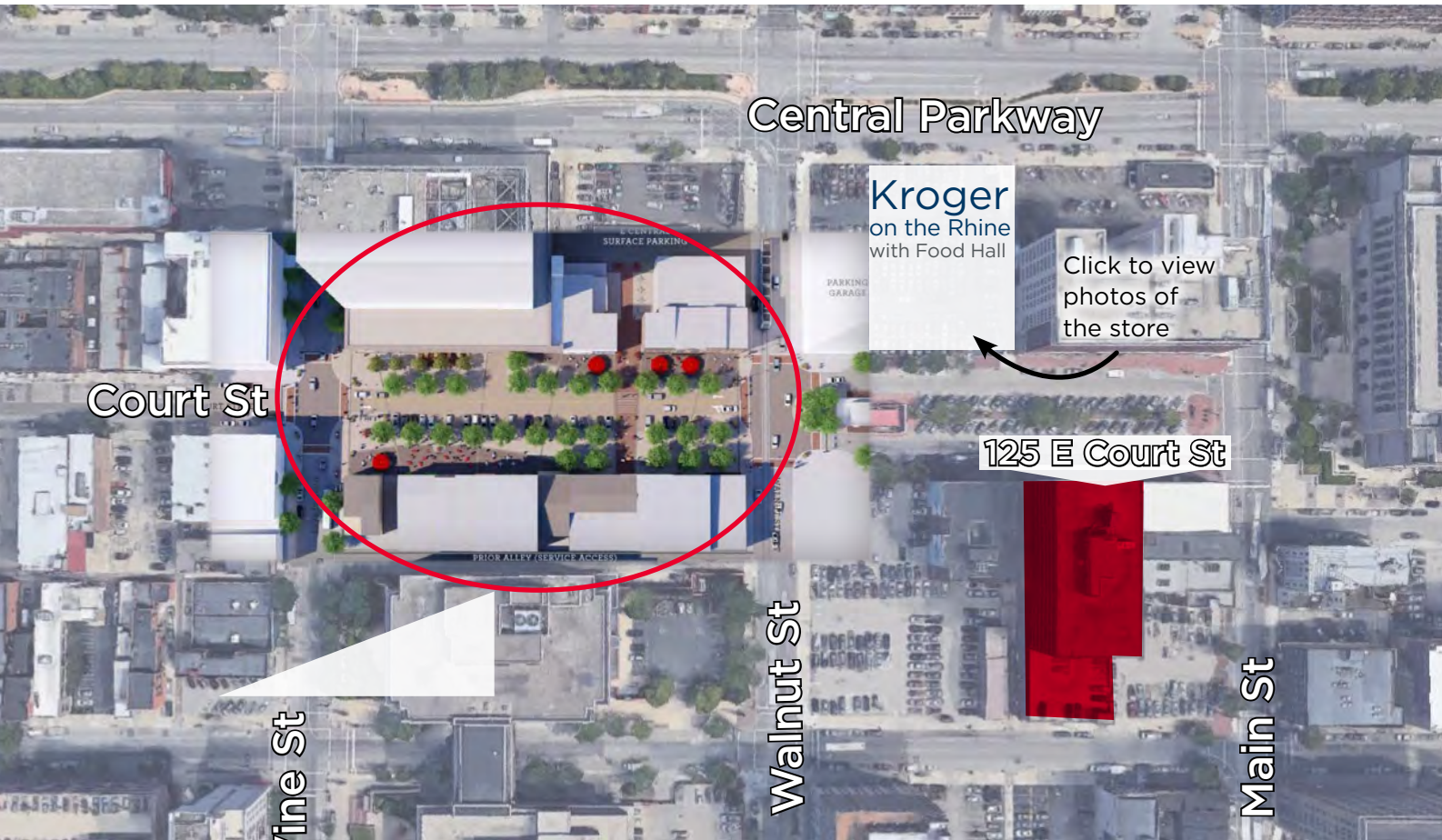

Click to learn more about the revitalization of Court Street!



## CENTRAL TO OVER-THE-RHINE, FOUNTAIN SQUARE & THE BANKS





**JOE JANSZEN**  
Senior Director  
+1 513 549 3011  
[joe.janszen@cushwake.com](mailto:joe.janszen@cushwake.com)

[cincyofficeadvisors.com](http://cincyofficeadvisors.com)

