

FOR LEASE

440 Regency Building

440 Regency Pkwy, Omaha, NE 68114



2,130- 5,060 SF Office Space Lease Rate: \$18.50 PSF, Modified Full Service

Property Highlights

Rare opportunity to be conveniently located in Regency at an affordable modified full service rental rate. Easy access to I-680, Pacific Street and West Dodge Road. Advertised rental rate excludes janitorial services.

Contact Information

SPENCER SECOR, CCIM
Senior Associate, Office Specialist
+1 402 548 4069
spencer.secor@lundco.com

MARTIN PATZNER, CCIM, SIOR, CPM, RPA
Vice President, Office Specialist
+1 402 548 4033
martin.patzner@lundco.com

450 Regency Parkway, Suite 200
Omaha, NE 68114
+1 402 393 8811
lundco.com

Independently Owned and Operated / A Member of the Cushman & Wakefield Alliance

Cushman & Wakefield Copyright 2024. No warranty or representation, express or implied, is made to the accuracy or completeness of the information contained herein, and same is submitted subject to errors, omissions, change of price, rental or other conditions, withdrawal without notice, and to any special listing conditions imposed by the property owner(s). As applicable, we make no representation as to the condition of the property (or properties) in question.

FOR LEASE

440 Regency Building

440 Regency Pkwy, Omaha, NE 68114



Availability

Lease Rate	\$18.50 SF (Modified Full Service)
Total Available	7,198 SF
Total Contiguous	5,060 SF

Property Highlights

Building Size	53,324 SF
Year Built	1973
No. of Floors	2
Total Site Area	2.93 AC

Suite	Square Feet (min - max)	Price/SF MFS	Date Available
100*	5,060 - 5,060	\$18.50	Immediately
210	2,138 - 2,138	\$18.50	Immediately

*former Bank Space

Contact Information

SPENCER SECOR, CCIM
Senior Associate, Office Specialist
+1 402 548 4069
spencer.secor@lundco.com

MARTIN PATZNER, CCIM, SIOR, CPM, RPA
Vice President, Office Specialist
+1 402 548 4033
martin.patzner@lundco.com

450 Regency Parkway, Suite 200
Omaha, NE 68114
+1 402 393 8811
lundco.com

Independently Owned and Operated / A Member of the Cushman & Wakefield Alliance

Cushman & Wakefield Copyright 2024. No warranty or representation, express or implied, is made to the accuracy or completeness of the information contained herein, and same is submitted subject to errors, omissions, change of price, rental or other conditions, withdrawal without notice, and to any special listing conditions imposed by the property owner(s). As applicable, we make no representation as to the condition of the property (or properties) in question.

FIRST FLOOR PLAN

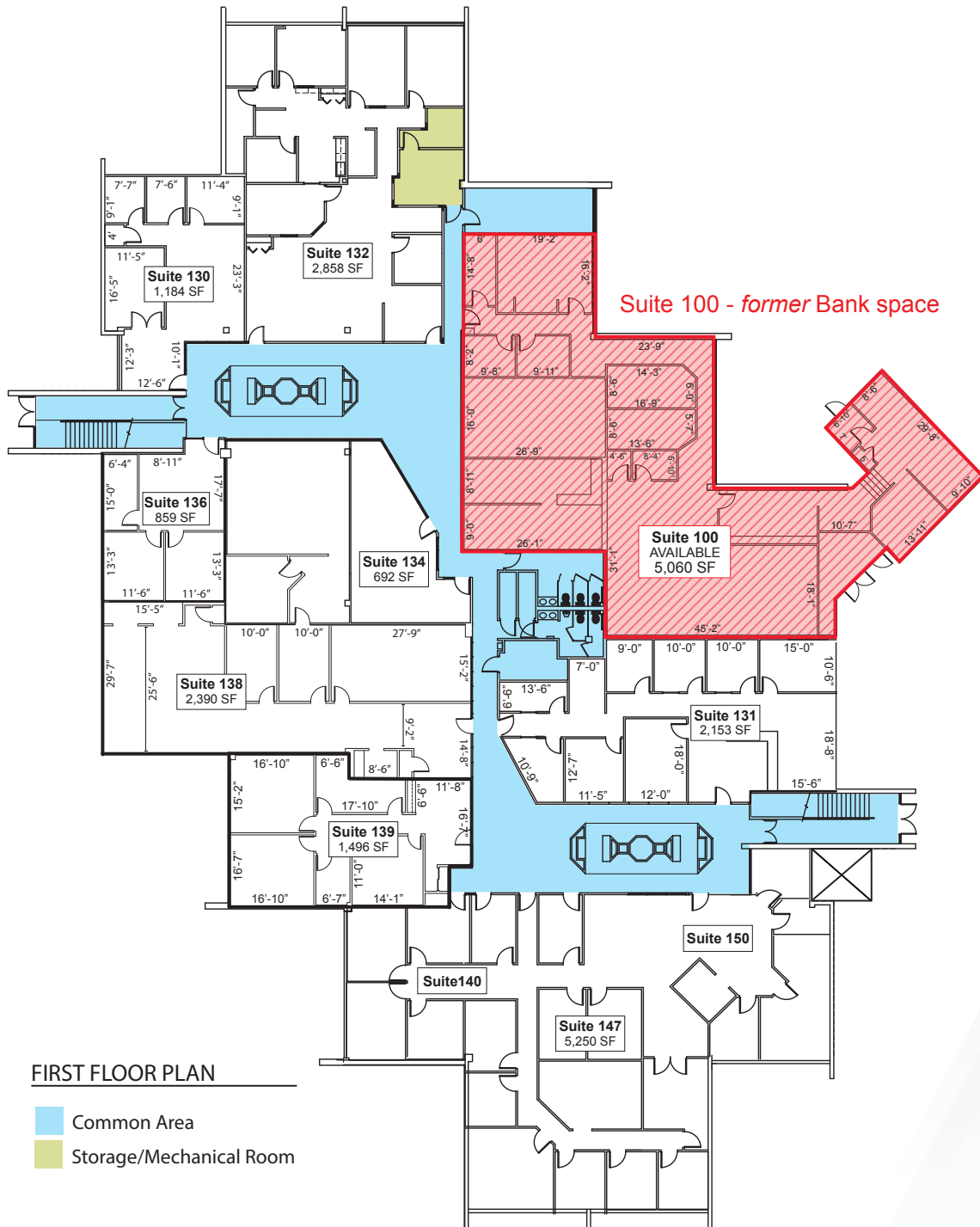

FIRST FLOOR PLAN

- Common Area
- Storage/Mechanical Room

*Floor plan measurements are approximate and are for illustration purposes only.

FOR LEASE

440 Regency Building

440 Regency Pkwy, Omaha, NE 68114



FLOOR PLAN: Suite 100 (former Bank space) - 5,060 SF

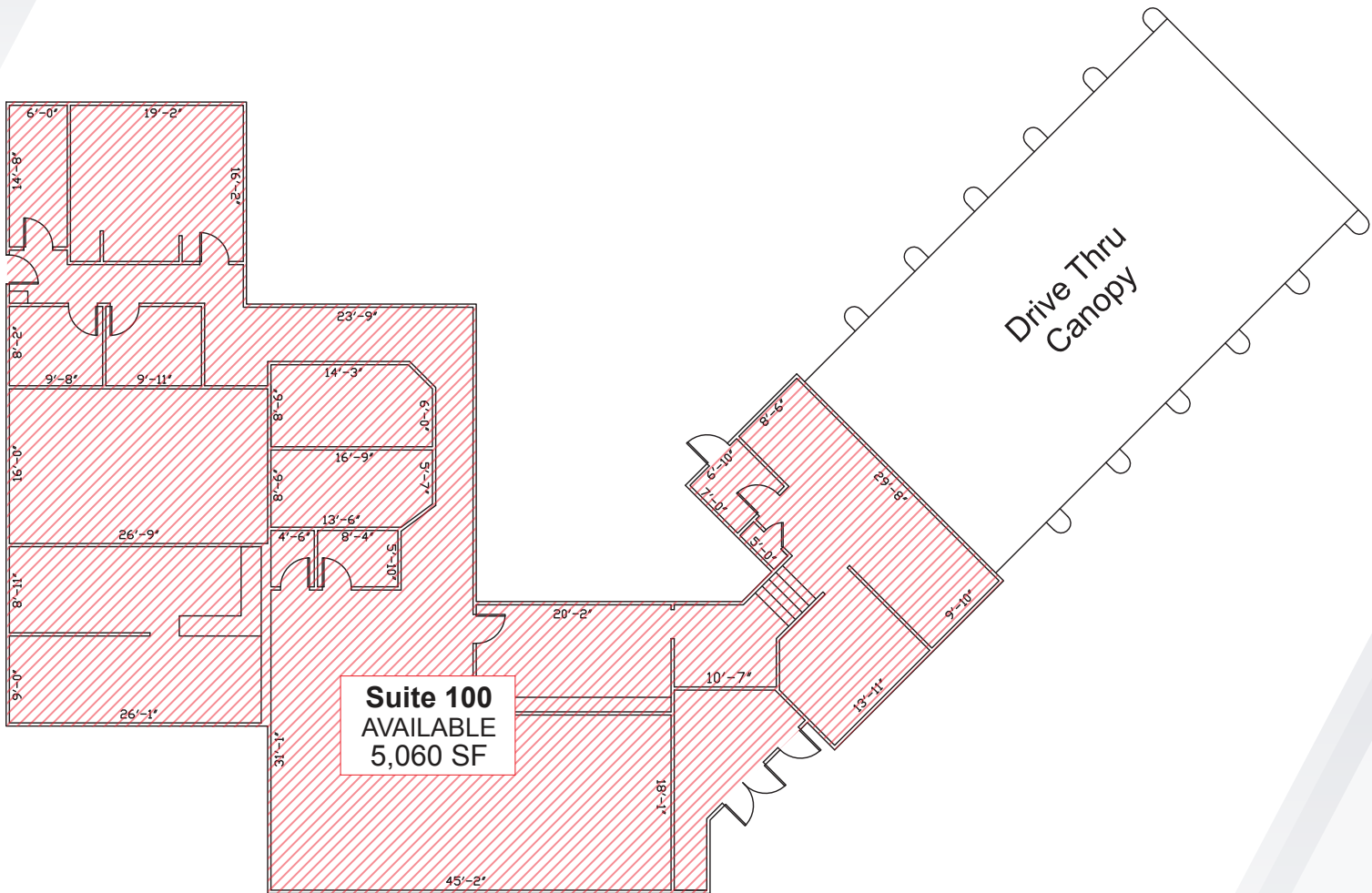

*Floor plan measurements are approximate and are for illustration purposes only.

Contact Information

SPENCER SECOR, CCIM
Senior Associate, Office Specialist
+1 402 548 4069
spencer.secor@lundco.com

MARTIN PATZNER, CCIM, SIOR, CPM, RPA
Vice President, Office Specialist
+1 402 548 4033
martin.patzner@lundco.com

450 Regency Parkway, Suite 200
Omaha, NE 68114
+1 402 393 8811
lundco.com

Independently Owned and Operated / A Member of the Cushman & Wakefield Alliance

Cushman & Wakefield Copyright 2023. No warranty or representation, express or implied, is made to the accuracy or completeness of the information contained herein, and same is submitted subject to errors, omissions, change of price, rental or other conditions, withdrawal without notice, and to any special listing conditions imposed by the property owner(s). As applicable, we make no representation as to the condition of the property (or properties) in question.

FOR LEASE

440 Regency Building

440 Regency Pkwy, Omaha, NE 68114



SECOND FLOOR PLAN

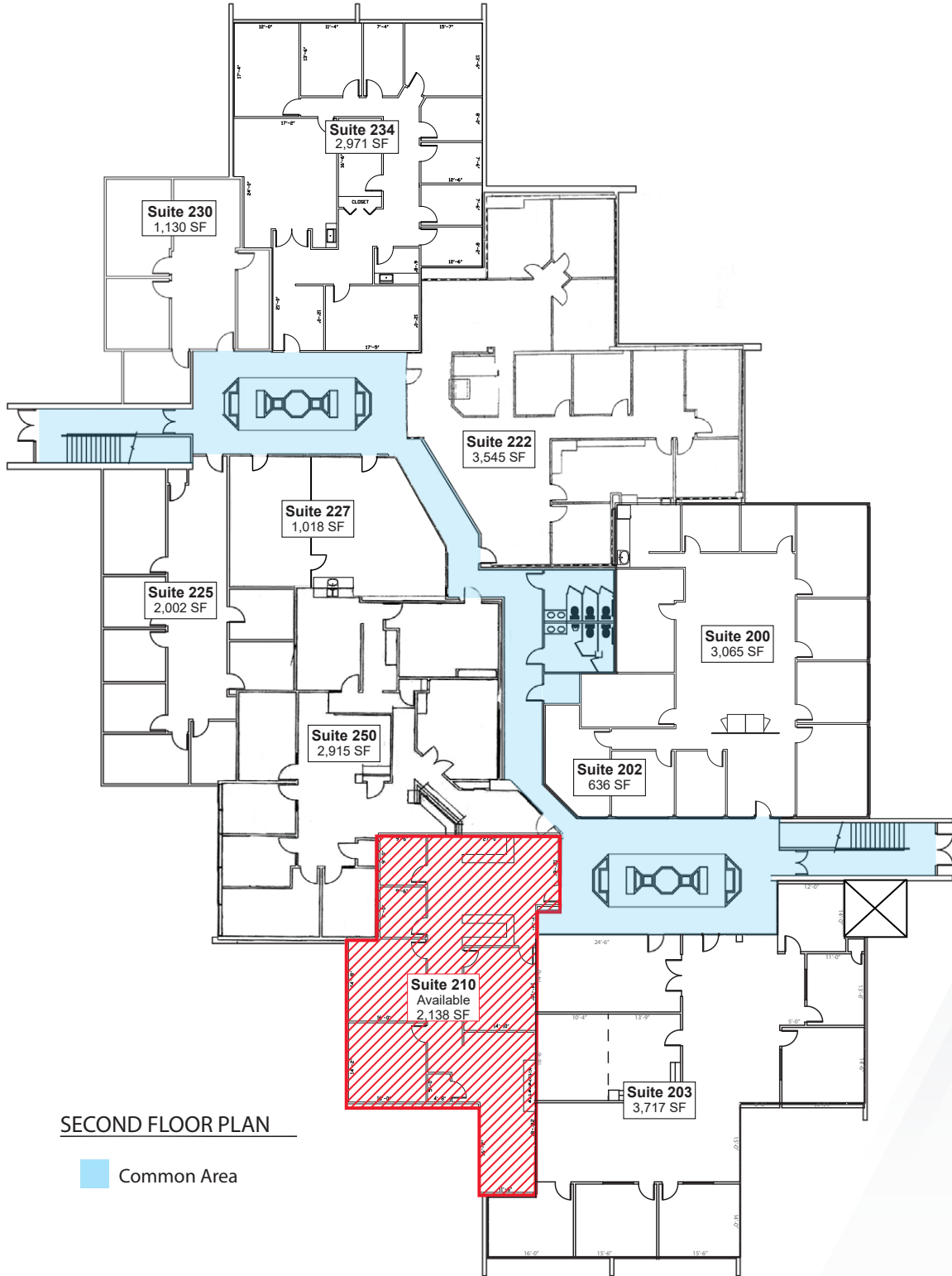

SECOND FLOOR PLAN

Common Area

*Floor plan measurements are approximate and are for illustration purposes only.

FOR LEASE
440 Regency Building
440 Regency Pkwy, Omaha, NE 68114



AERIAL MAP

