



**CUSHMAN &
WAKEFIELD**
Ottawa

**APPROXIMATELY 84,142 SF OF MOVE IN READY
OFFICE SPACE**

ONE 60

**ELGIN
STREET**





ONE 60

ELGIN STREET

Today's future forward companies recognize that the dynamics that accelerate decisions, achieve innovation, or generate ideas hinge on collaboration between groups. ONE 60 Elgin Street is perfectly suited to facilitate those connections and cooperation.

PREMISE DETAILS

ONE 60 Elgin Street

- Part of the 2nd floor 8,430 sf
- All of the 3rd floor 37,871 sf
- All of the 4th floor 37,841 sf
- Part of the 7th floor 24,841 sf
- Sublease terms – Lease Expiry: February 28th, 2032
- Sublease Rate – Negotiable
- Additional Rent – \$19.84 (2022)

HIGHLIGHTS

- Underground parking available
- Transit stop at the door on Elgin Street
- Direct to Hwy 417 via Elgin Street or Nicholas Street
- Located on the ground floor, the Cuisine Club offers 10 food offerings in a modern, brightly lit environment the Cuisine Club restaurants: Booster Juice, Bridgehead, California Thai, The Cupcake Lounge, Gabriel Pizza, Green Rebel, Mac's Sushi, Ya Habibi, Marcello's and Brown's Social Club.
- Building amenities include: complimentary Wi-Fi, mobile charging stations, heated sidewalks, bird-safe glass
- LEED® Gold Status
- Numerous retail amenities located on the ground floor include: Vivah boutique, Rexall, LCBO, Hillary's, Circle K
- At just under 40,000 SF per floor, 160 Elgin Street is home to the largest floor-plate in downtown Ottawa

ONE 60



A



Modern furniture can be reconfigured for Social Distancing

B



C



D

A/ Lobby Area B/ 3rd Floor C/ Conference Centre D/ Elevators Lobby



A



C



B

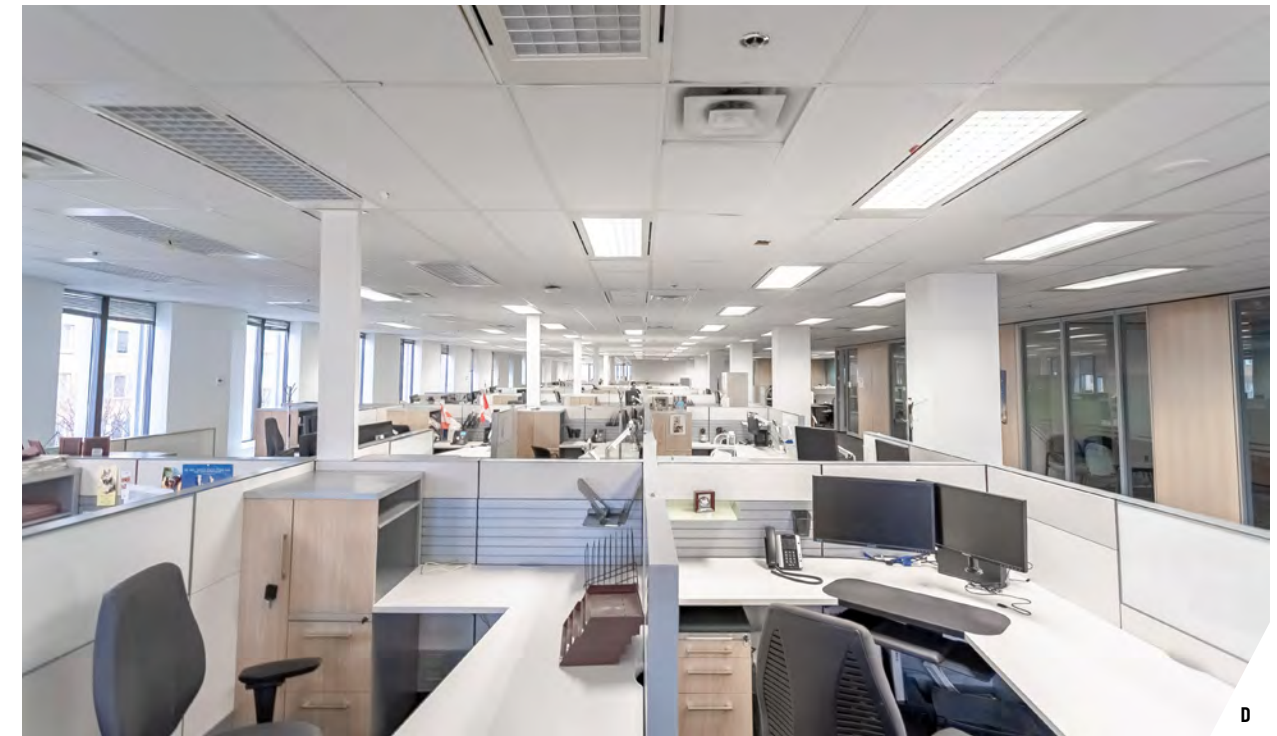

D



E

- A/ Shared Boardroom
- B/ Collaborative Work Space
- C/ Office Space
- D/ Office Space
- E/ Kitchen

ONE 60

Second Floor

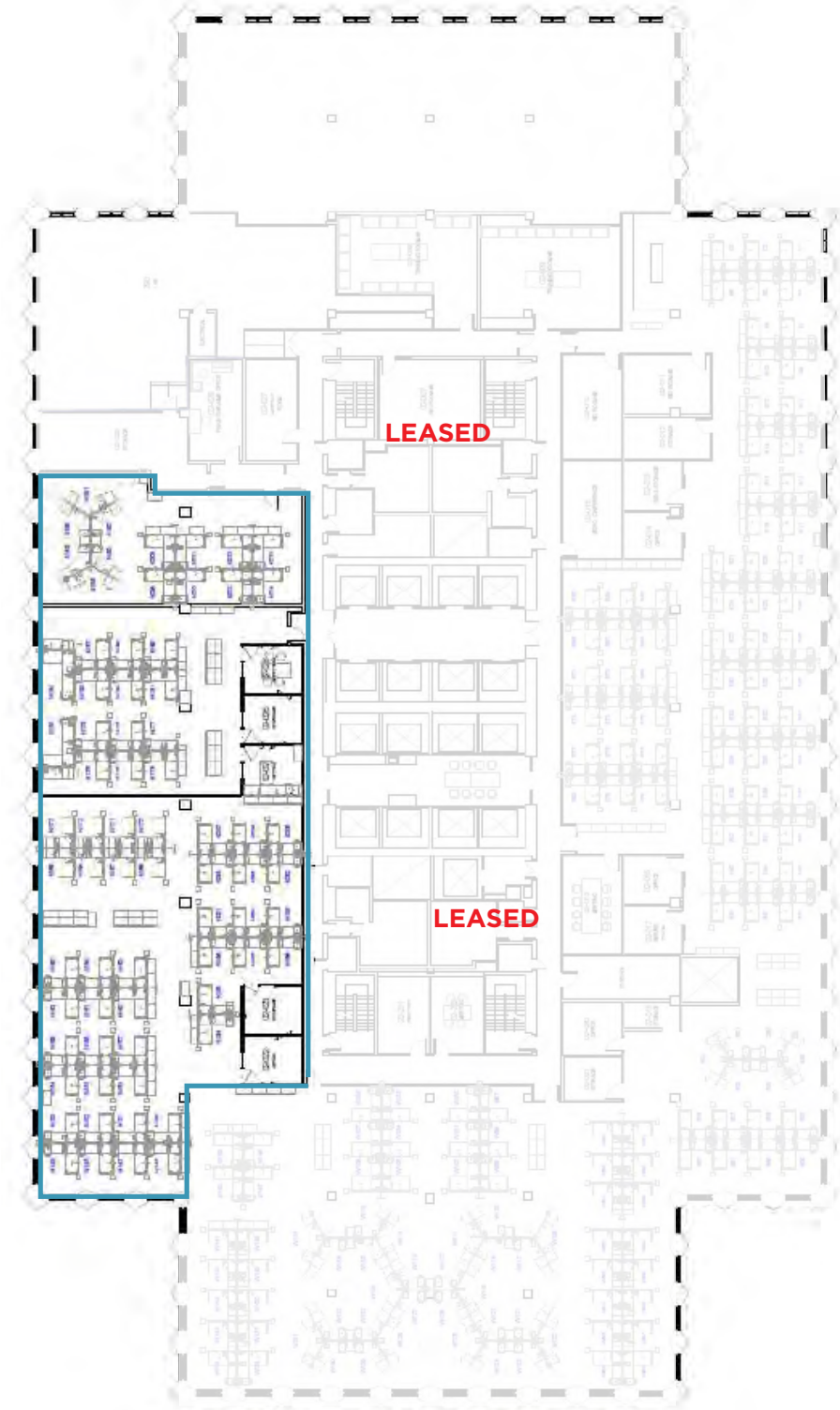

RENTABLE AREA: 2nd FLOOR 8,430 SF



Third Floor



RENTABLE AREA: 3rd FLOOR 37,871 SF



ONE 60

Fourth Floor



RENTABLE AREA: 4th FLOOR 37,841 SF



Seventh Floor

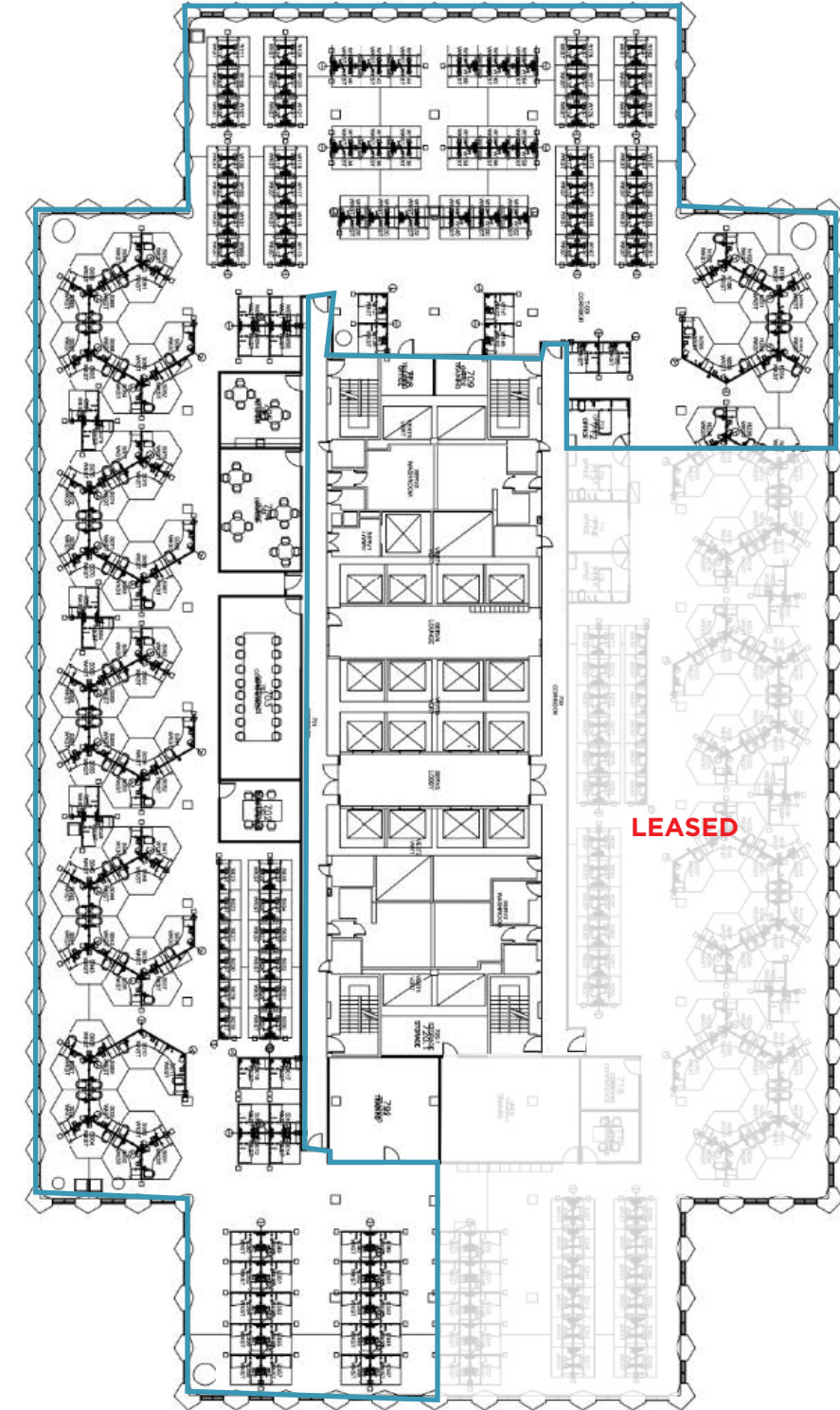

RENTABLE AREA: 7th FLOOR 24,841 SF



An aerial photograph of Ottawa, Canada, showing a dense urban landscape. The central focus is a tall, modern skyscraper with a distinctive facade of vertical, light-colored panels. To its left is a shorter, brick building with arched windows. The surrounding area is filled with various other buildings, including older structures with green roofs and modern glass-fronted towers. In the background, the city extends to the horizon under a cloudy sky. A wide road with traffic is visible in the lower right, and snow is scattered on the rooftops and ground.

Located in the heart
of Ottawa's unique
landscape

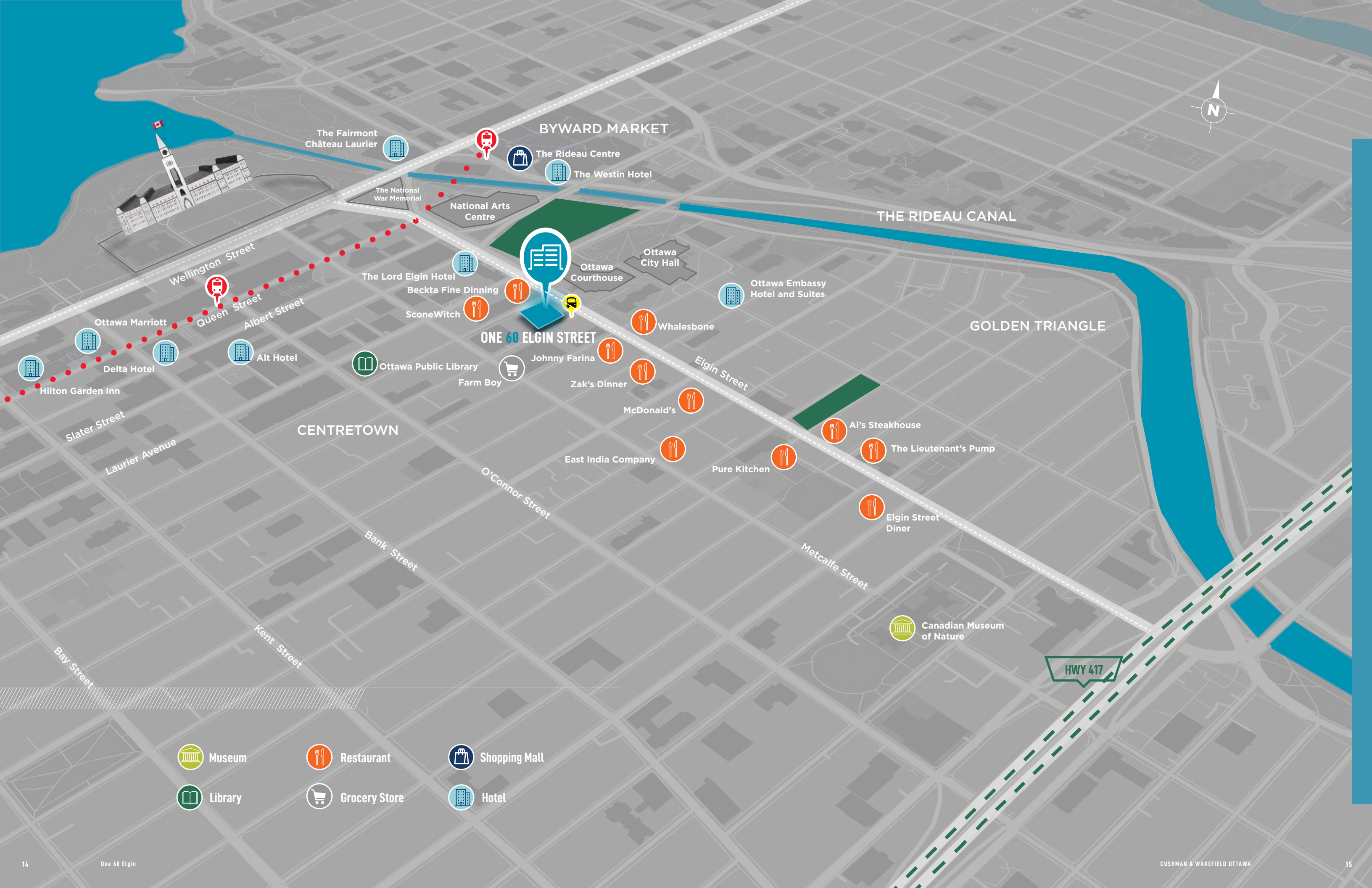

BYWARD MARKET

THE RIDEAU CANAL

GOLDEN TRIANGLE

CENTRETOWN

ONE 60 ELGIN STREET



The Fairmont Château Laurier

The Rideau Centre

The Westin Hotel

The National War Memorial

National Arts Centre

Ottawa Courthouse

Ottawa City Hall

Ottawa Embassy Hotel and Suites

Wellington Street

Queen Street

Albert Street

The Lord Elgin Hotel

Beckta Fine Dining

SconeWitch

Johnny Farina

Zak's Dinner

McDonald's

East India Company

Pure Kitchen

Al's Steakhouse

The Lieutenant's Pump

Elgin Street Diner

Canadian Museum of Nature

Ottawa Marriott

Delta Hotel

Hilton Garden Inn

Alt Hotel

Slater Street

Laurier Avenue

Bay Street

Kent Street

Bank Street

O'Connor Street

Elgin Street

Metcalfe Street

HWY 417

Museum

Library

Restaurant

Grocery Store

Shopping Mall

Hotel

AMENITIES

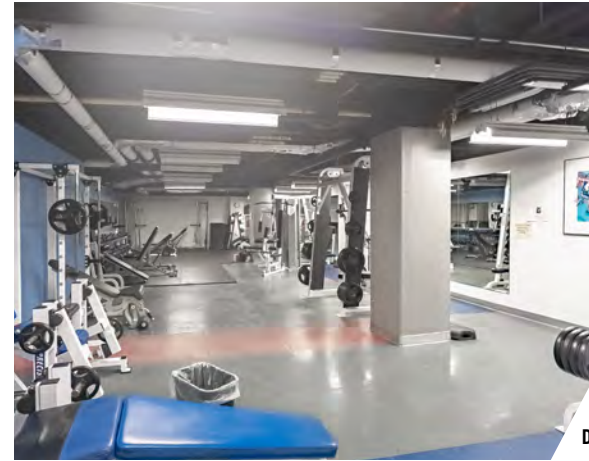

A/ Cuisine Club
 B/ Brown's Social Club
 C/ Bridgehead
 D/E/F/G Fitness Facility



ONE 60

ELGIN STREET

FOR MORE INFORMATION ON THIS OPPORTUNITY, CONTACT:

Kimberley Hall
Vice President*
613 780 1585
khall@cwottawa.com

*Sales Representative



Cushman & Wakefield Ottawa, Brokerage
55 Metcalfe Street, Suite 400
Ottawa, ON K1P 6L5
cwottawa.com