



833  
CHESTNUT

# ABOUT THE BUILDING

A NEWLY RENOVATED HISTORIC CENTER CITY LOCATION, OFFERING DYNAMIC OPEN SPACES

FEATURING LARGE 50,361 SF FLOOR PLATES

NEAR AMENITIES, GREEN SPACE, RETAIL, RESTAURANTS

EXCELLENT PUBLIC TRANSPORTATION

NEW ELEVATORS, BIKE STORAGE, AND LOBBY

HISTORIC ARCHITECTURE AND MODERN AMENITIES

24-HOUR ON-SITE SECURITY



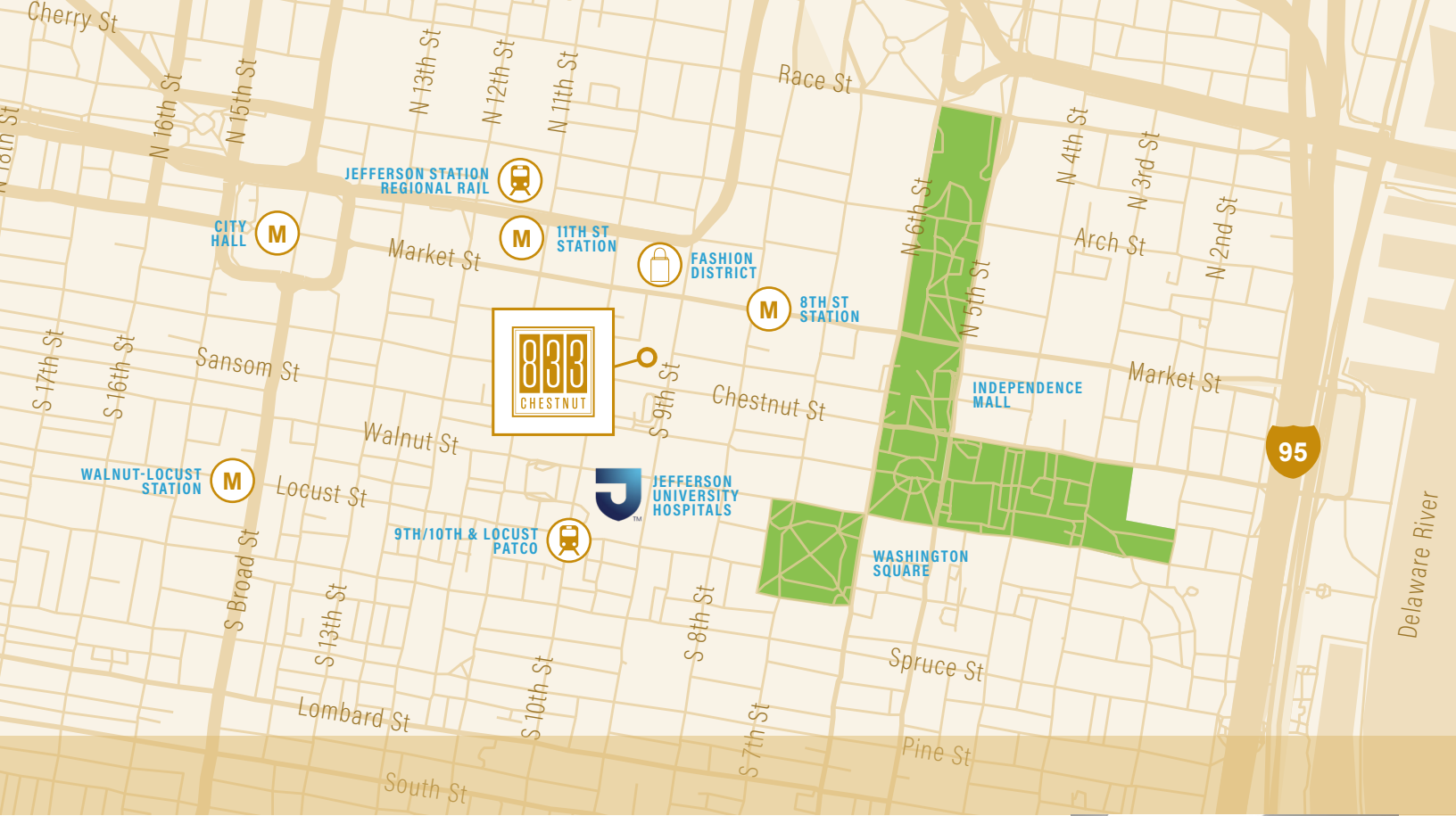

# CURRENT AVAILABILITIES

UP TO 69,530 SF CONTIGUOUS SPACE AVAILABLE

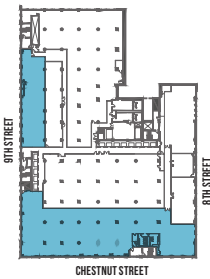

## 8TH FLOOR

**SUITE 830**  
13,964 SF

**SUITE 830A**  
4,747 SF

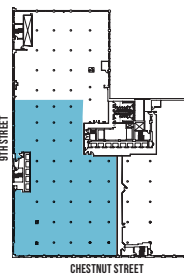

## 11TH FLOOR

**SUITE 1120**  
22,263 SF

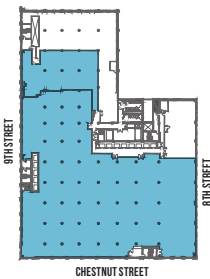

## 12TH FLOOR

**SUITE 1220**  
47,267 SF

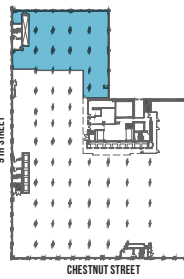

## 14TH FLOOR

**SUITE 1402**  
7,687 SF

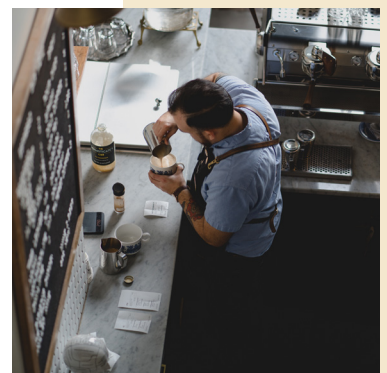
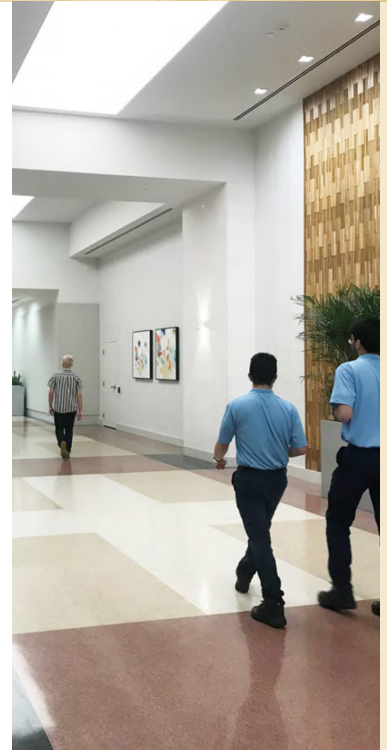



**CUSHMAN &  
WAKEFIELD**



**Healthpeak™**  
PROPERTIES

**SHANE FUNSTON**

SENIOR DIRECTOR  
+1 215 963 4052

[shane.funston@cushwake.com](mailto:shane.funston@cushwake.com)

**JACK MEYERS**

EXECUTIVE DIRECTOR  
+1 215 963 4054

[jack.meyers@cushwake.com](mailto:jack.meyers@cushwake.com)

**DAN BROGAN**

SENIOR DIRECTOR  
+1 215 963 4040

[dan.brogan@cushwake.com](mailto:dan.brogan@cushwake.com)