



100  
MONTGOMERY

100 MONTGOMERY  
SAN FRANCISCO, CA

CUSHMAN &  
WAKEFIELD

## BRAND NEW PLUG / PLAY SUBLEASE

- Bike Parking / Storage
- Gym & Showers
- Outdoor Shared Patio
- Operable Windows
- LEED Platinum Certified



Tony Lucchesi  
+1 415 677 0434  
tony.lucchesi@cushwake.com  
CA Lic. 01420285

Eli Ceryak  
+1 415 568 3424  
eli.ceryak@cushwake.com  
CA Lic. 01304628



100  
MONTGOMERY

# Plug & Play Sublease

## ► 5th Floor | Suite 500

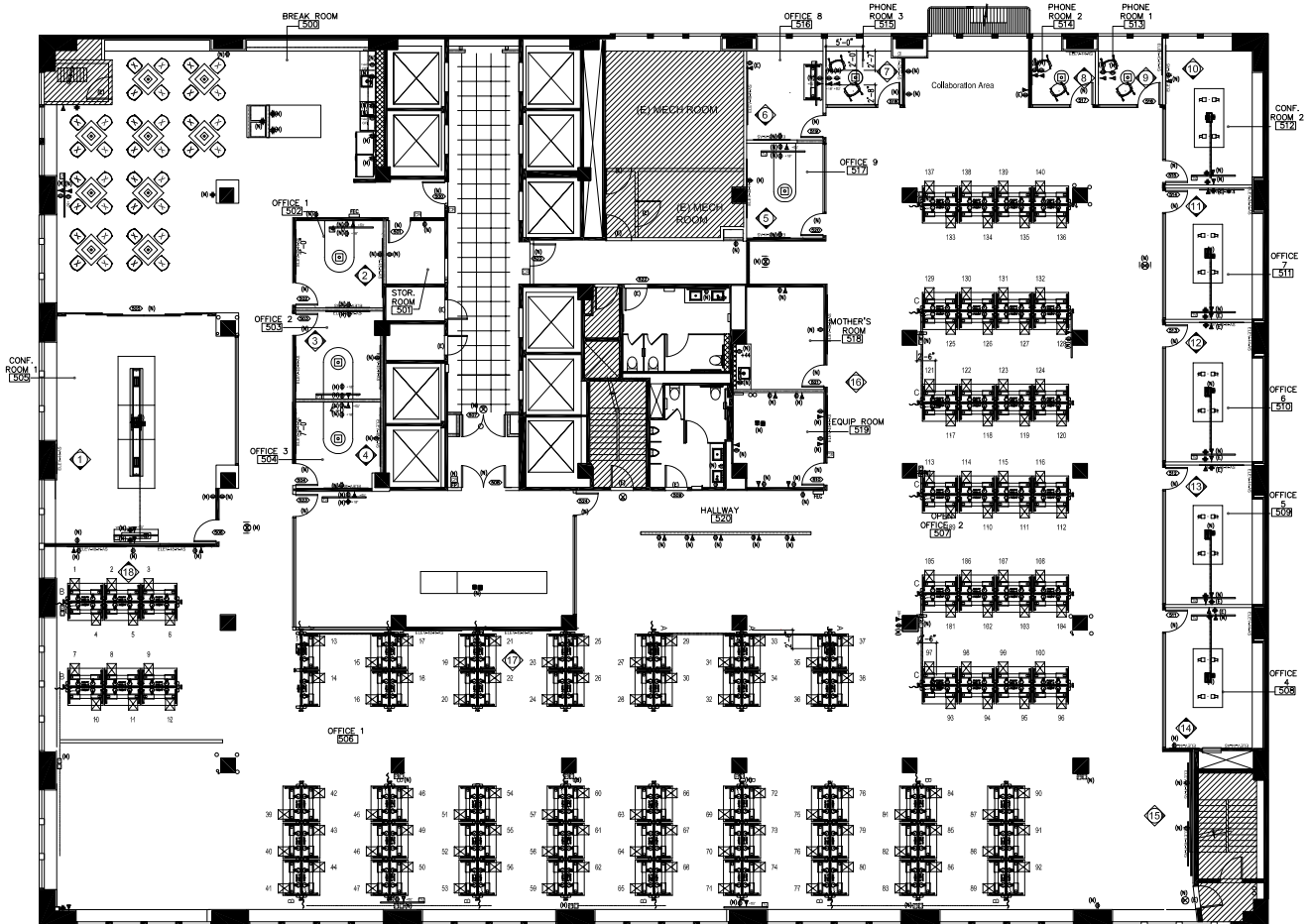

- 20,432 Square Feet
- Full Floor
- Brand New Buildout
- Exposed Ceilings
- Large Boardroom with Sliding Walls to All Hands Area
- Large Kitchen & Break Room
- Collaboration Space
- 13 Team Rooms and Offices
- FF&E Can Be Included
- LED: May 2026
- Price: Negotiable

©2020 Cushman & Wakefield. NO WARRANTY OR REPRESENTATION, EXPRESS OR IMPLIED, IS MADE TO THE ACCURACY OR COMPLETENESS OF THE INFORMATION CONTAINED HEREIN, AND SAME IS SUBMITTED SUBJECT TO ERRORS, OMISSIONS, CHANGE OF PRICE, RENTAL OR OTHER CONDITIONS, WITHDRAWAL WITHOUT NOTICE, AND TO ANY SPECIAL LISTING CONDITIONS IMPOSED BY THE PROPERTY OWNER(S). AS APPLICABLE, WE MAKE NO REPRESENTATION AS TO THE CONDITION OF THE PROPERTY (OR PROPERTIES) IN QUESTION.

**CUSHMAN & WAKEFIELD**