



6,000 - 26,000 SF AVAILABLE
FOR LEASE

**1650 LAKE
COOK RD**

DEERFIELD, IL





ABOUT THE BUILDING

1650 Lake Cook Rd is a 125,690 RBA building, built in 1995. The proximity to retail, dining and an abundance of other entertainment gives the Deerfield area an urban feel with the convenience of the suburbs.

FEATURES

- 20 Minutes to O'Hare International Airport
- Adjacent to Hyatt Regency Deerfield
- Adjacent to 4-way interchange @ I-294
- On-site management
- Efficient 26,000 rsf floor plates





CLICK TO TOUR AMENITIES



- Underground Executive Parking
- Grab n' Go Deli
- Fitness Center
- Daycare on-site

THE LOCATION

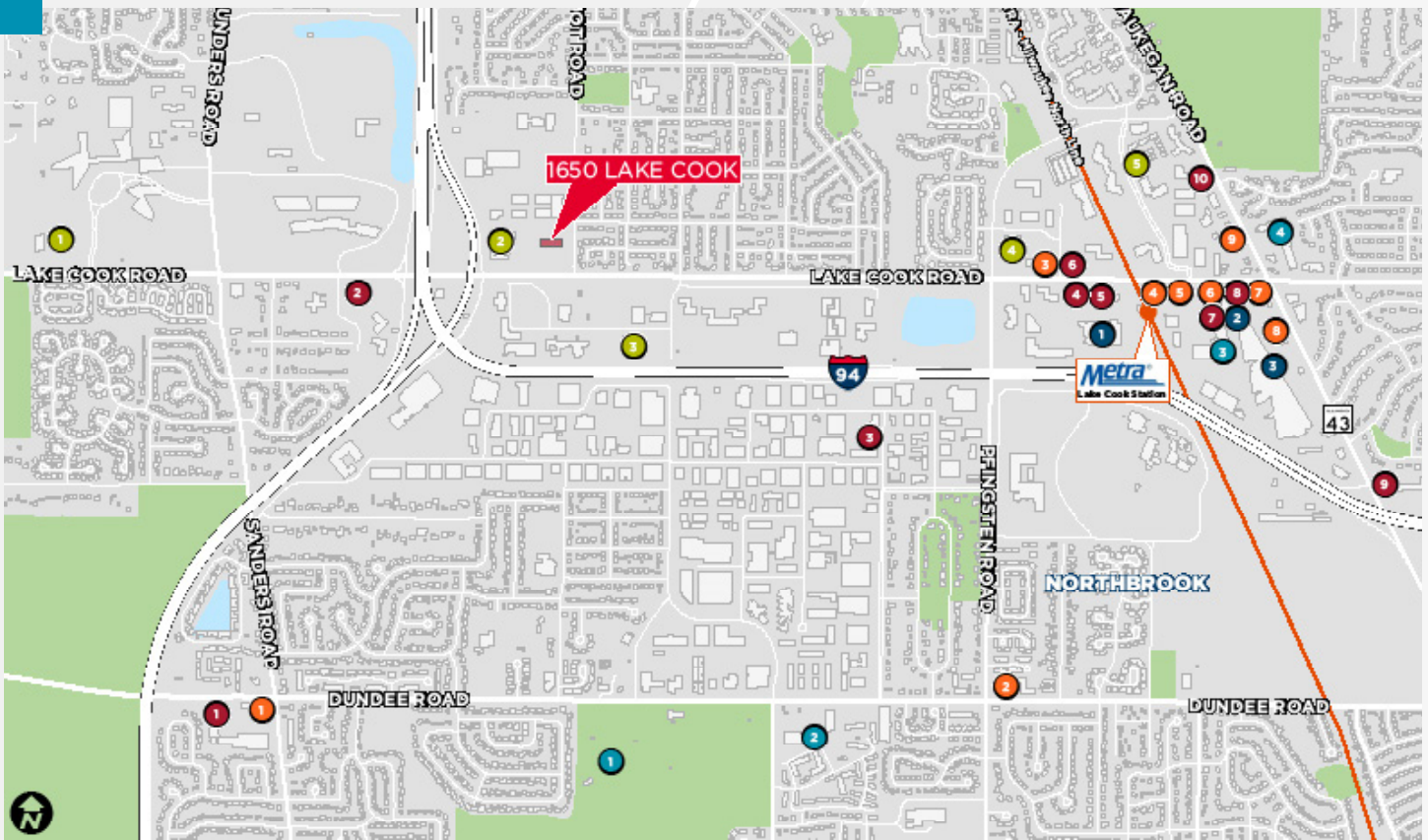

FAST FOOD

- 1 Culver's
- 2 Once Upon a Bagel
- 3 Portillo's
- 4 Jimmy John's
- 5 Dunkin'
- 6 Panera Bread
- 7 Starbucks Coffee
- 8 MOD Pizza
- 9 McDonald's
- 10 Potbelly
- 11 Cafe Zupas
- 12 Chipotle

13 Naf Naf Grill

FULL SERVICE DINING

- 1 Butterfield's
- 2 Redland's Grill
- 3 Maestro Seafood & Grill
- 4 McAlister's Deli
- 5 El Tradicional
- 6 Demetri's
- 7 Jimmy Thai
- 8 City Barbeque
- 9 Max & Benny's
- 10 Carson's Prime Steaks
- 11 Parkway Grill

12 IL Forno

- 13 Rosebud
 - 14 Bartaco
 - 15 Bobby's Deerfield
 - 16 Deerfield Italian Kitchen
- ## HOTELS
- 1 Holiday Inn Express
 - 2 Hyatt Regency Deerfield
 - 3 Embassy Suites
 - 4 Courtyard by Marriott
 - 5 Residence Inn by Marriott
 - 6 Marriott Suites

RECREATION

- 1 Sportsman's Country Club
- 2 Orangetheory Fitness
- 3 Sachs Recreation Center
- 4 Planet Fitness
- 5 Parkway Athletic Club
- 6 Briarwood Country Club

RETAIL

- 1 The Home Depot
- 2 Jewel-Osco
- 3 Deerbrook Shopping Center
- 4 Whole Foods Market
- 5 Walgreens

5-MILE DEMOGRAPHICS

67,725

Population

\$101,708

Median Household Income

46

Median Age



1650 LAKE COOK RD



Daniel Svachula
+1 847 518 3256
daniel.svachula@cushwake.com

Allyson Birchmeier
+1 847 720 1315
allyson.birchmeier@cushwake.com