



OFFICE SUBLEASE

211 Perimeter Center

211 Perimeter Center Pky., Atlanta, GA 30346



21,889 RSF

Negotiable

11/30/2028

4.0/1,000 SF

**AVAILABLE ON
5th FLOOR**

**FULL-SERVICE
RATE**

**SUBLEASE
EXPIRATION**

**SURFACE/COVERED
PARKING**

Space Features & Highlights

- Excellent views and elevator lobby exposure
- Highly improved space
- Move-in ready
- Furniture optional

Excellent Amenities & Location

- Café and expanded outdoor patio
- Fitness center
- Conference facility
- On-site management and security
- Walking distance to MARTA, Perimeter Mall and abundant retail and amenities

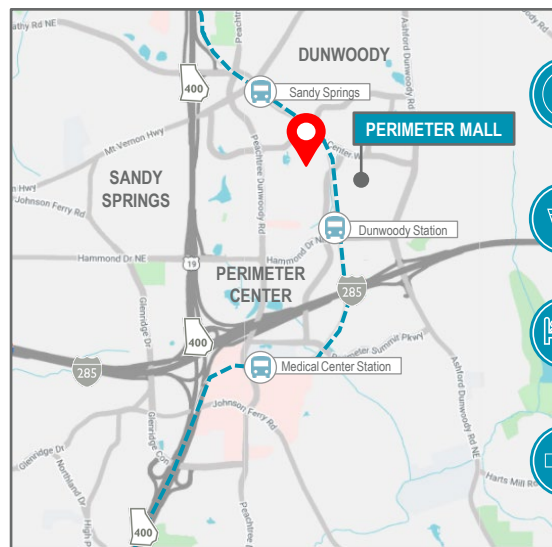

- 30+** RESTAURANTS
- 15+** RETAIL OPTIONS
- 10+** HOTELS
- 4** HOSPITALS

KIRK DIAMOND
Executive Managing Director
(404) 682 3407
kirk.diamond@cushwake.com
License #150352

ERIN SMITH
Senior Director
(404) 682 3444
erin.smith@cushwake.com
License #337500

STEVEN TAYLOR
Senior Manager
(404) 682 3383
steven.taylor@cushwake.com
License #338982

CUSHMAN & WAKEFIELD, INC.
1180 Peachtree Street, NE, Suite 3100
Atlanta, Georgia 30309
www.cushmanwakefield.com

The depiction in the included photograph of any person, entity, sign, logo or property, other than Cushman & Wakefield's (C&W) client and the property offered by C&W, is incidental only, and is not intended to connote any affiliation, connection, association, sponsorship or approval by or between that which is incidentally depicted and C&W or its client. This listing shall not be deemed an offer to lease, sublease or sell such property; and, in the event of any transaction for such property, no commission shall be earned by or payable to any cooperating broker except if otherwise provided pursuant to the express terms, rates and conditions of C&W's agreement with its principal, if, as and when such commission (if any) is actually received from such principal. (A copy of the rates and conditions referred to above with respect to this property is available upon request.)



21,889 RSF – 5TH FLOOR

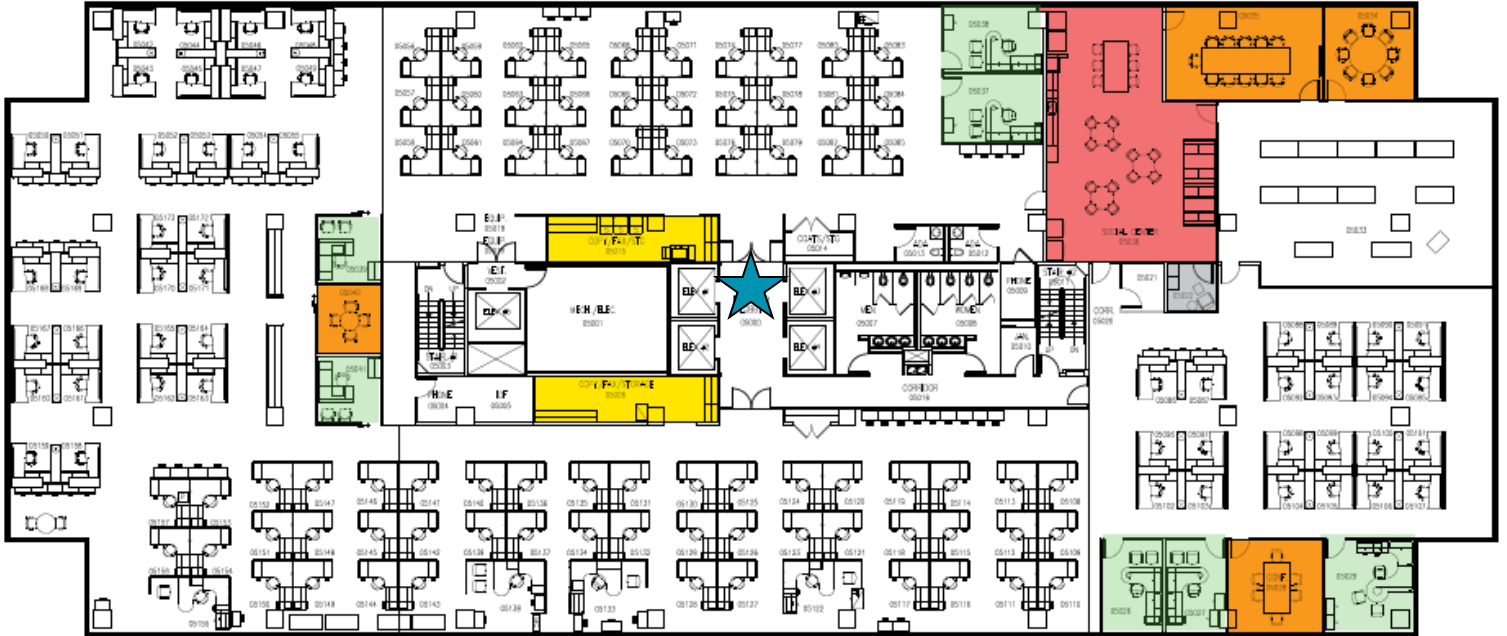

WORKSPACE LEGEND:

- SOCIAL CENTER (1) MAIN ENTRANCE/ELEV LOBBY
- CONF./COLLAB./FOCUS (4)
- BUSINESS CENTER (2)
- WELLNESS ROOM (1)
- OFFICES (7)
- WORKSTATIONS (132)

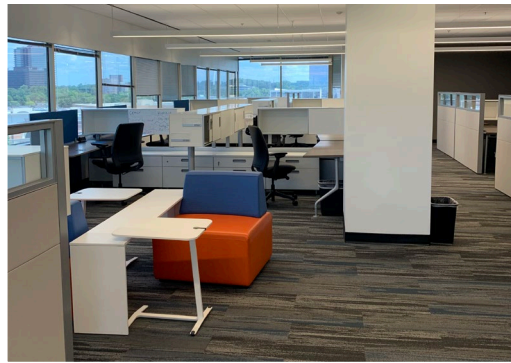

KIRK DIAMOND
Executive Managing Director
(404) 682 3407
kirk.diamond@cushwake.com
License #150352

ERIN SMITH
Senior Director
(404) 682 3444
erin.smith@cushwake.com
License #337500

STEVEN TAYLOR
Senior Manager
(404) 682 3383
steven.taylor@cushwake.com
License #338982

CUSHMAN & WAKEFIELD, INC.
1180 Peachtree Street, NE, Suite 3100
Atlanta, Georgia 30309
www.cushmanwakefield.com

The depiction in the included photograph of any person, entity, sign, logo or property, other than Cushman & Wakefield's (C&W) client and the property offered by C&W, is incidental only, and is not intended to connote any affiliation, connection, association, sponsorship or approval by or between that which is incidentally depicted and C&W or its client. This listing shall not be deemed an offer to lease, sublease or sell such property; and, in the event of any transaction for such property, no commission shall be earned by or payable to any cooperating broker except if otherwise provided pursuant to the express terms, rates and conditions of C&W's agreement with its principal, if, as and when such commission (if any) is actually received from such principal. (A copy of the rates and conditions referred to above with respect to this property is available upon request.)