

# 6070 JOHNSON DR.

## PLEASANTON

±9,908 SF SUBLEASE  
JUNIOR ANCHOR END CAP RETAIL /  
SHOWROOM SUBLEASE



**CUSHMAN &  
WAKEFIELD**

**MICHAEL COPELAND**

+1 925 548 8592

michael.copeland@cushwake.com

LIC#00898210

**ALEX LAGEMANN**

+1 408 221 2310

alex.lagemann@cushwake.com

LIC#02024474



# 6070 JOHNSON DR.

PLEASANTON



## SUBLEASE HIGHLIGHTS

- Pleasanton Square Shopping Center
- ±9,908 SF Junior Anchor End Cap Space
- Credit Sublessor
- Term Through 2/28/2027
- Anchored by Home Depot & Bevmo
- 3 Grade Level Loading Doors
- Easy Access to I-580 & I-680

# 6070 JOHNSON DR.

## PLEASANTON

SUITE F: ±9,908 SF

- 2 OFFICES
- BREAK ROOM
- RESTROOM
- 3 GRADE LEVEL DOORS

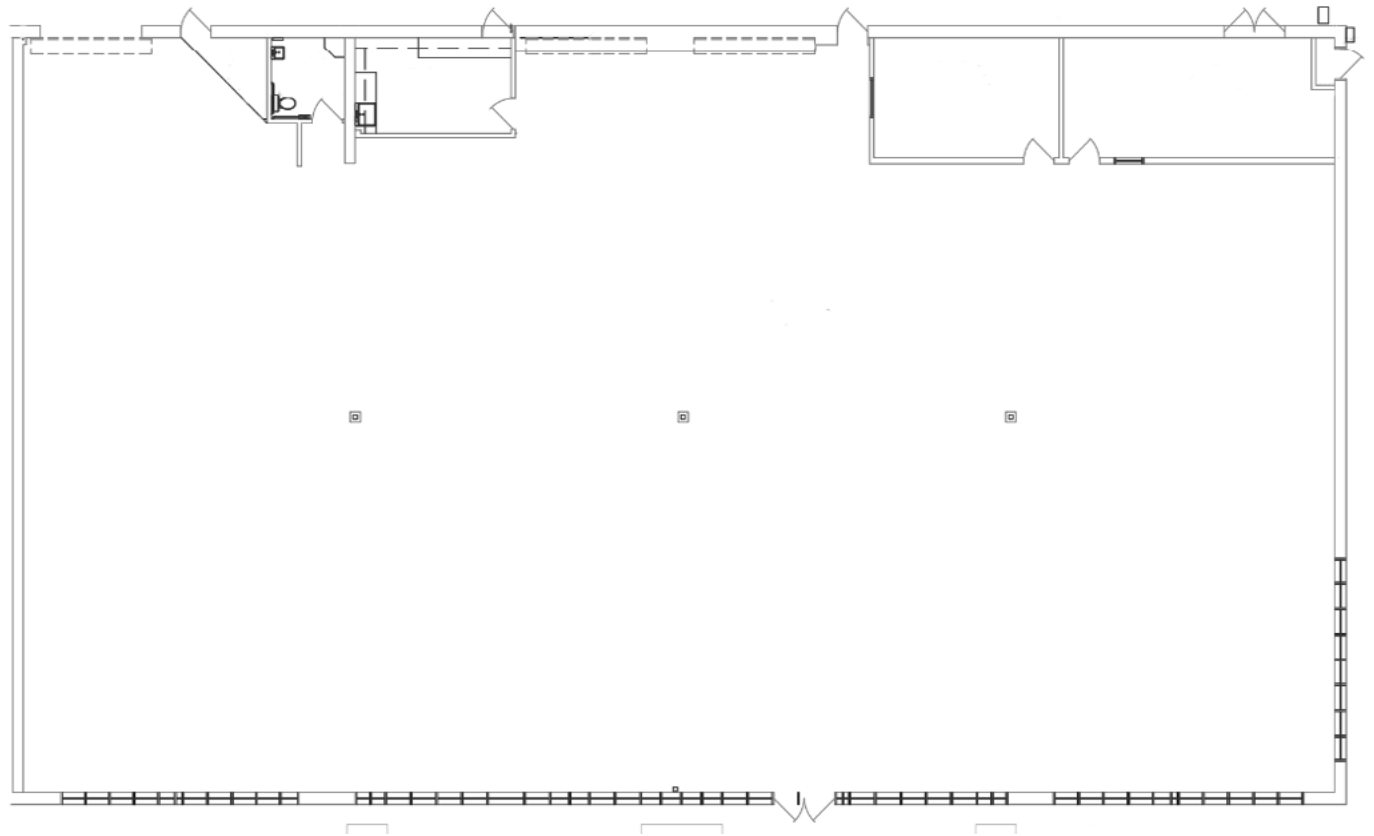







# 6070 JOHNSON DR.

PLEASANTON



**±9,908 SF  
SUBLEASE**

**JUNIOR ANCHOR  
END CAP RETAIL /  
SHOWROOM  
SUBLEASE**

**CONTACT:**

**MICHAEL COPELAND**  
+1 925 548 8592  
michael.copeland@cushwake.com  
LIC#00898210

**ALEX LAGEMANN**  
+1 408 221 2310  
alex.lagemann@cushwake.com  
LIC#02024474

©2023 Cushman & Wakefield. All rights reserved. The information contained in this communication is strictly confidential. This information has been obtained from sources believed to be reliable but has not been verified. NO WARRANTY OR REPRESENTATION, EXPRESS OR IMPLIED, IS MADE AS TO THE CONDITION OF THE PROPERTY (OR PROPERTIES) REFERENCED HEREIN OR AS TO THE ACCURACY OR COMPLETENESS OF THE INFORMATION CONTAINED HEREIN, AND SAME IS SUBMITTED SUBJECT TO ERRORS, OMISSIONS, CHANGE OF PRICE, RENTAL OR OTHER CONDITIONS, WITHDRAWAL WITHOUT NOTICE, AND TO ANY SPECIAL LISTING CONDITIONS IMPOSED BY THE PROPERTY OWNER(S). ANY PROJECTIONS, OPINIONS OR ESTIMATES ARE SUBJECT TO UNCERTAINTY AND DO NOT SIGNIFY CURRENT OR FUTURE PROPERTY PERFORMANCE.

