

FOR SALE

2332 CLARKE STREET

PORT MOODY, BC



±26,691 SF INDUSTRIAL SITE
WITH FUTURE RESIDENTIAL DEVELOPMENT UPSIDE
ENVIRONMENTAL CERTIFICATE OF COMPLIANCE AVAILABLE



Rick Eastman

Personal Real Estate Corporation
Executive Vice President, Industrial
604 640 5863
rick.eastman@cushwake.com

FOR SALE

2332 CLARKE STREET PORT MOODY, BC



LOCATION

Bordered by Coquitlam on the east and south, Burnaby on the west, and Burrard Inlet to the north, Port Moody is located a 40 minute drive from both downtown Vancouver and the US border and offers easy access to the lifestyle pursuits of the area's local mountains, trails and seaside.

The city has grown exponentially in the last several years, with the West Coast Express and SkyTrain transit lines, efficiently connecting the area's residents to downtown Vancouver in under 40 minutes.

LEGAL DESCRIPTION

Parcel 1 District Lot 202 Group 1 New Westminster District Plan EPP78956

PID: 030-338-263

SITE SIZE

Approximately ±26,691 sf or 0.61 acre

ZONING

M1 (Light Industrial)

PROPERTY TAXES (2023)

\$35,100.60

ASKING PRICE

\$3,950,000

OCP DESIGNATION

Mixed Use - Moody Centre

Mixed Use - Moody Centre designated areas within the Heritage Commercial District are intended to be compatible in scale and character with other parts of the Moody Centre Heritage Conservation Area. For the vacant lots on the eastern portion of the 2400 block of Clarke Street, building heights up to 6 storeys will be considered. In other areas within the Heritage Commercial District, building heights up to a maximum of 3 storeys will be considered.

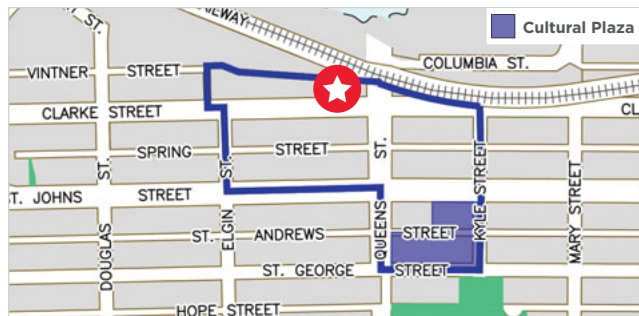

SITE DESCRIPTION

The subject property is approximately ±26,691 sf and is located on the north side of Clarke Street, west of Queen Street in the Port Moody Centre Neighbourhood.

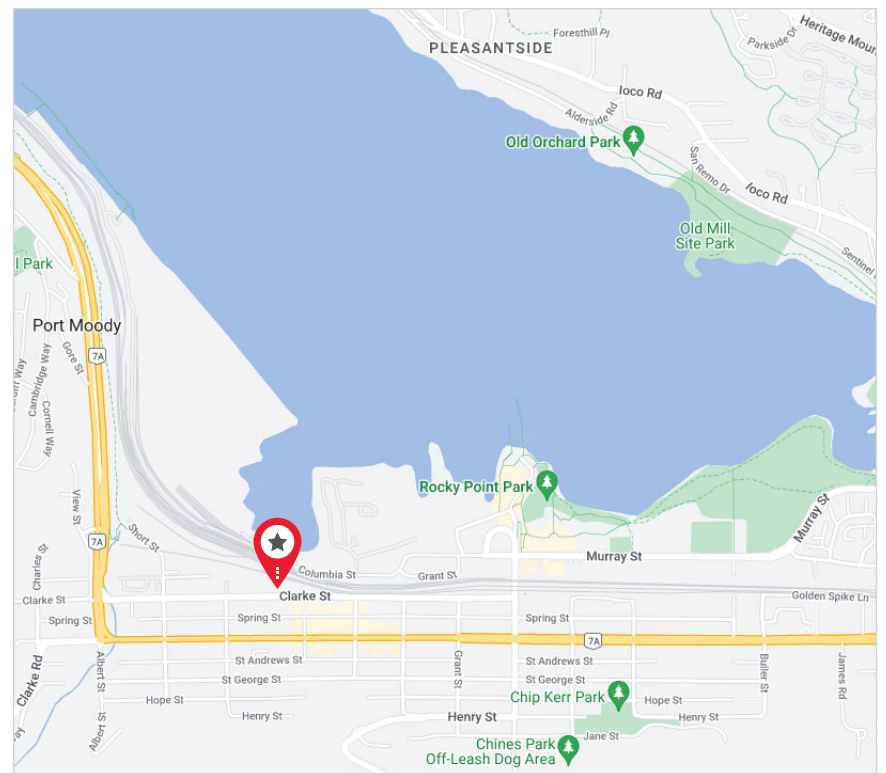
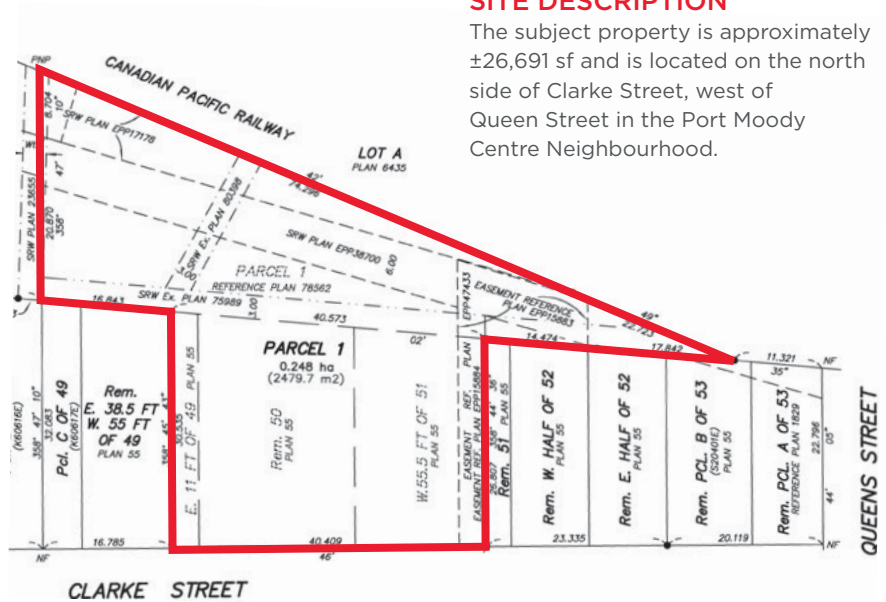

Rick Eastman

Personal Real Estate Corporation
Executive Vice President, Industrial
604 640 5863
rick.eastman@cushwake.com

©2023 Cushman & Wakefield ULC. All rights reserved. The information contained in this communication is strictly confidential. This information has been obtained from sources believed to be reliable but has not been verified. NO WARRANTY OR REPRESENTATION, EXPRESS OR IMPLIED, IS MADE AS TO THE CONDITION OF THE PROPERTY (OR PROPERTIES) REFERENCED HEREIN OR AS TO THE ACCURACY OR COMPLETENESS OF THE INFORMATION CONTAINED HEREIN, AND SAME IS SUBMITTED SUBJECT TO ERRORS, OMISSIONS, CHANGE OF PRICE, RENTAL OR OTHER CONDITIONS, WITHDRAWAL WITHOUT NOTICE, AND TO ANY SPECIAL LISTING CONDITIONS IMPOSED BY THE PROPERTY OWNER(S). ANY PROJECTIONS, OPINIONS OR ESTIMATES ARE SUBJECT TO UNCERTAINTY AND DO NOT SIGNIFY CURRENT OR FUTURE PROPERTY PERFORMANCE.