

# MOFFETT TOWERS

— 1000, 1020 & 1050 ENTERPRISE WAY | SUNNYVALE —



±38,392 - ±815,528 SF AVAILABLE





# MOFFETT TOWERS

1000, 1020 & 1050 ENTERPRISE WAY | SUNNYVALE

## PROJECT HIGHLIGHTS

1000 Enterprise Way: Single Floor up to  $\pm 317,166$  SF (6/30/26 LED)

1020 Enterprise Way: Single Floor up to  $\pm 317,166$  SF (12/31/30 LED)

1050 Enterprise Way: Single Floor up to  $\pm 181,196$  SF (9/30/27 LED)

- Class A 8-Story Three Building Campus
- $\pm 40,000$  SF Average Floor Plate
- Exceptional Glass Line & Views
- Expansive Outdoor Space with Seating Areas
- Full Service Café at 1000 Enterprise Way
- Moffett Towers Club:  $\pm 48,000$  SF State-of-the-Art Health Club  
Featuring Cardio & Weight Rooms, Group Exercise, Personal Training, Aquatics & Basketball
- $\pm 3.3/1,000$  Parking
- Double Door Loading
- EV Charging Stations & Bike Lockers
- Moffett Towers Shuttle: Round Trip Shuttle Service to Berryessa BART, Milpitas BART & Sunnyvale Caltrain
- 2 Minute Walk to Moffett Park VTA Light Rail Station
- 9 Minute Ride on VTA Light Rail to Downtown Mountain View





# MOFFETT TOWERS

1000, 1020 & 1050 ENTERPRISE WAY | SUNNYVALE

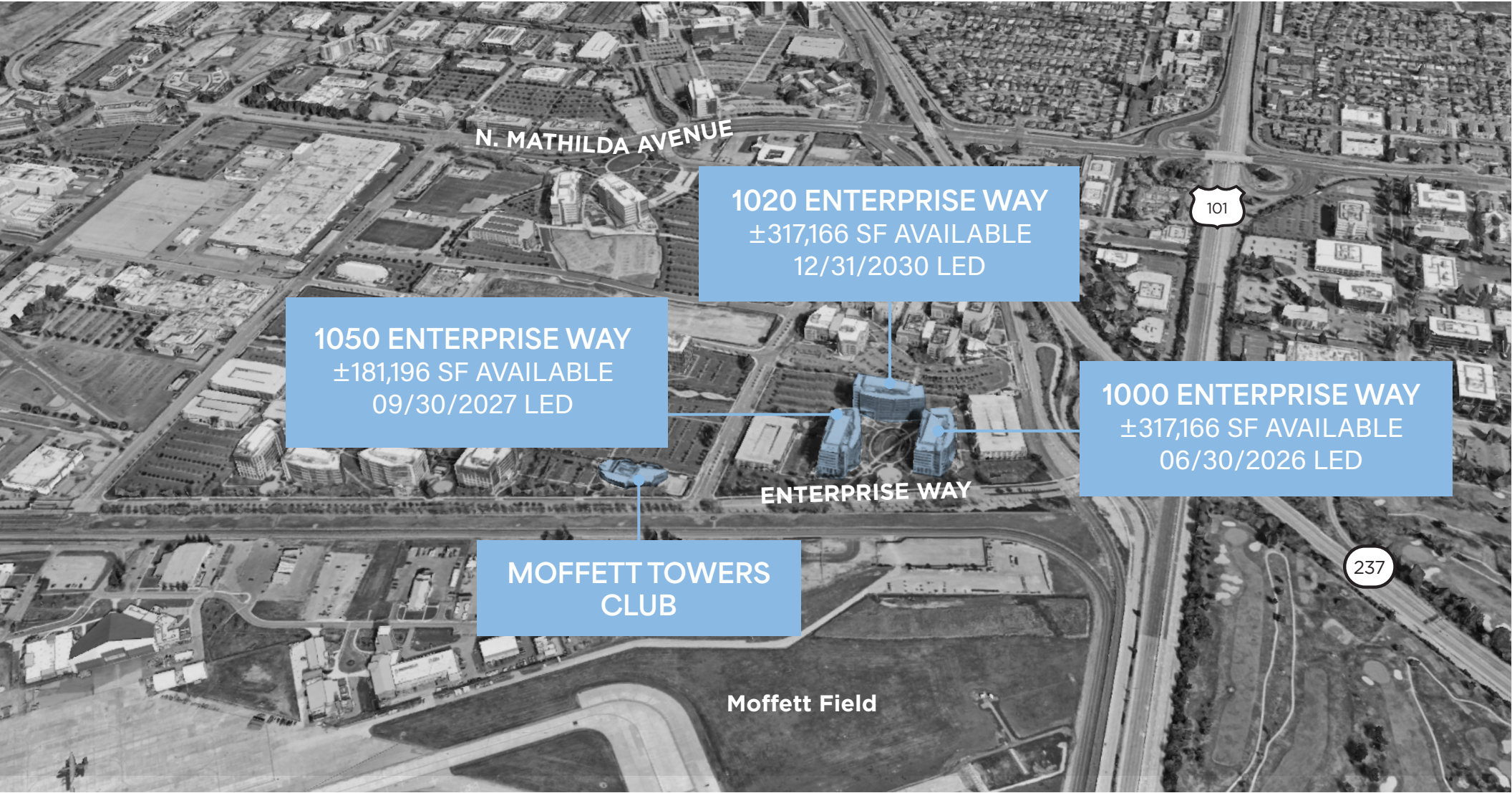

N. MATHILDA AVENUE

**1020 ENTERPRISE WAY**  
±317,166 SF AVAILABLE  
12/31/2030 LED

**1050 ENTERPRISE WAY**  
±181,196 SF AVAILABLE  
09/30/2027 LED

**1000 ENTERPRISE WAY**  
±317,166 SF AVAILABLE  
06/30/2026 LED

**MOFFETT TOWERS CLUB**

ENTERPRISE WAY

Moffett Field



# MOFFETT TOWERS

1000, 1020 & 1050 ENTERPRISE WAY | SUNNYVALE



MOFFETT TOWERS CLUB

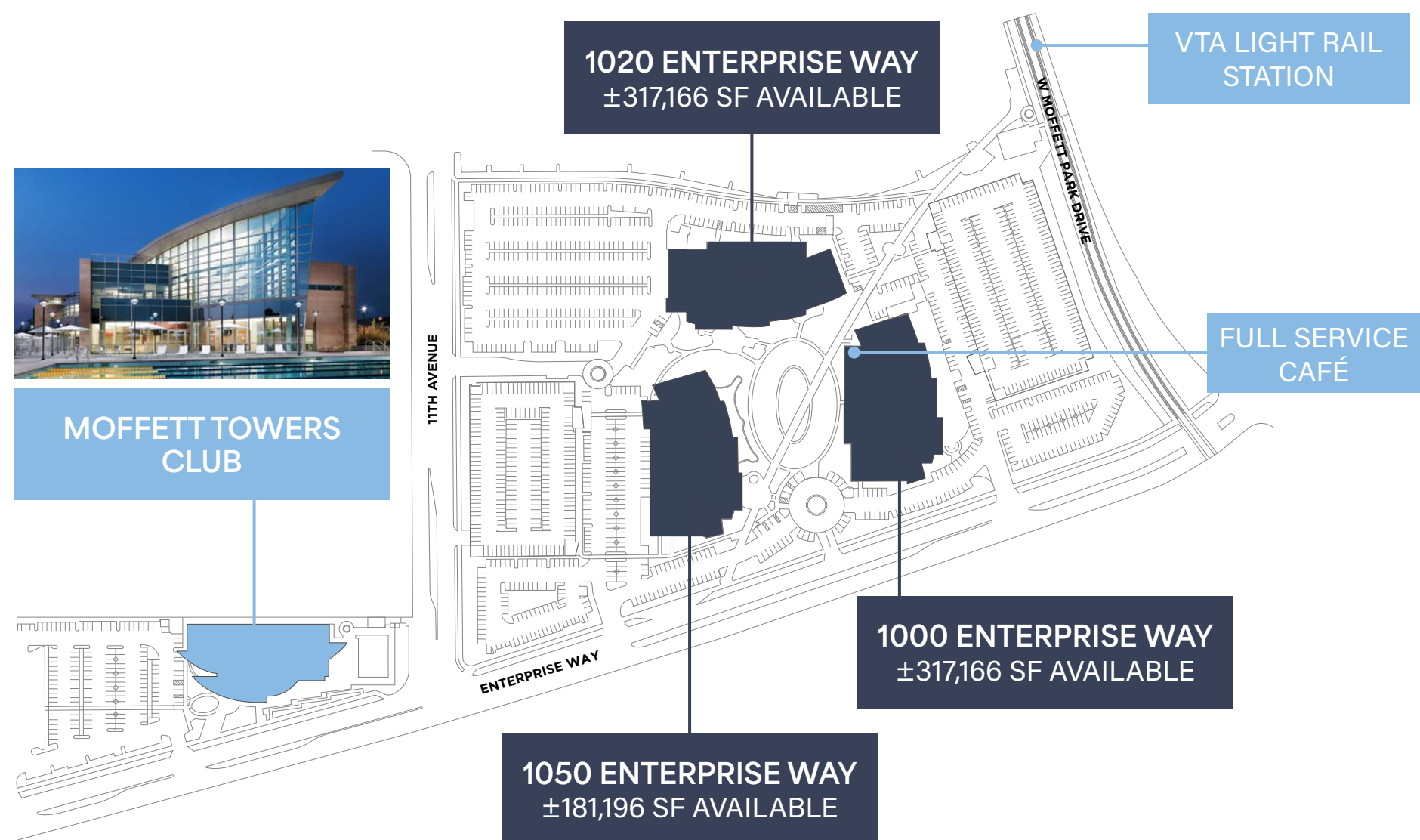

1020 ENTERPRISE WAY  
±317,166 SF AVAILABLE

VTA LIGHT RAIL STATION

FULL SERVICE CAFÉ

1000 ENTERPRISE WAY  
±317,166 SF AVAILABLE

1050 ENTERPRISE WAY  
±181,196 SF AVAILABLE



# MOFFETT TOWERS CLUB

The Moffett Towers Club is a +48,000 SF Health, Fitness & Wellness Club. The Club is a state-of-the-art facility offering a wide range of amenities to cater to all fitness needs. Dive into our inviting pool for a refreshing aquatic workout or simply unwind. For those looking for personalized guidance, our certified personal trainers are here to help you achieve your fitness goals. Join our invigorating group exercise classes, which provide a sense of community and motivation while breaking a sweat. And for those inclined towards strength training, our well-equipped weight training area awaits you. Moffett Towers Club is designed to provide a holistic approach to health and fitness, ensuring that you leave feeling rejuvenated and ready to tackle the challenges of your workday.

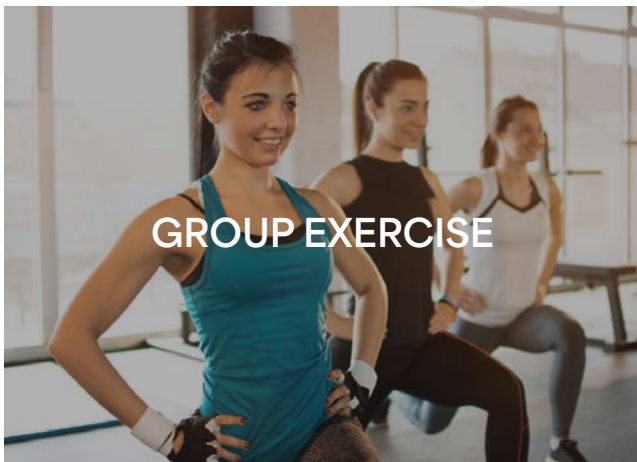

GROUP EXERCISE



SPECIALTY PROGRAMS

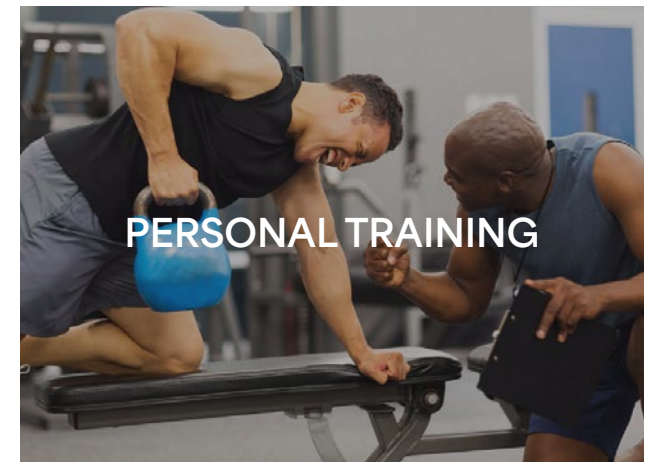

PERSONAL TRAINING



GYMNASIUM



AQUATICS



# MOFFETT TOWERS

1000, 1020 & 1050 ENTERPRISE WAY | SUNNYVALE





# MOFFETT TOWERS

1000, 1020 & 1050 ENTERPRISE WAY | SUNNYVALE



# 1000 ENTERPRISE WAY

FIRST FLOOR | ±37,887 SF

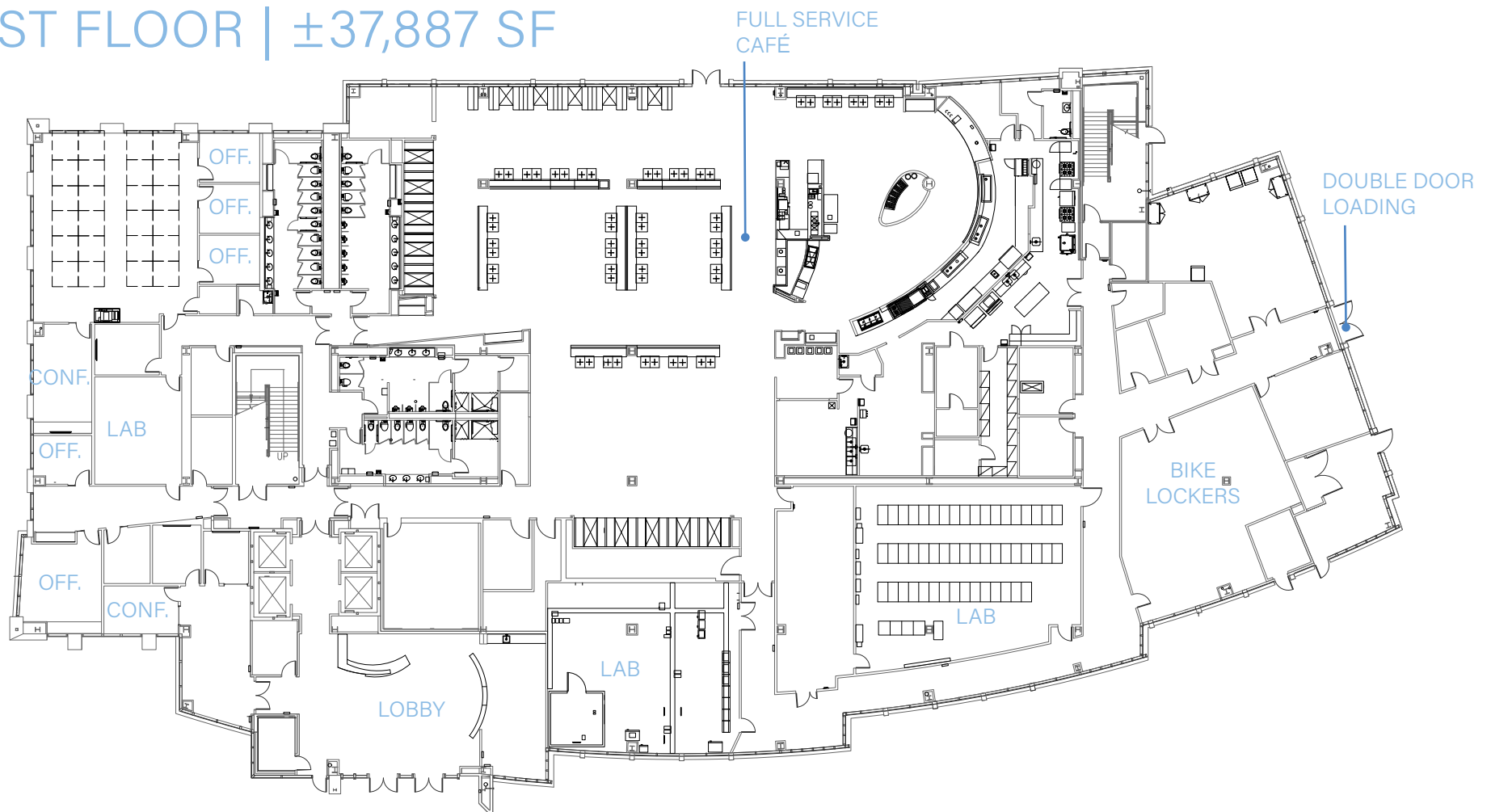

- 24 Workstations
- 2 Conference Rooms
- Labs
- Café
- Bike Lockers



# 1000 ENTERPRISE WAY

SECOND FLOOR | ±40,434 SF

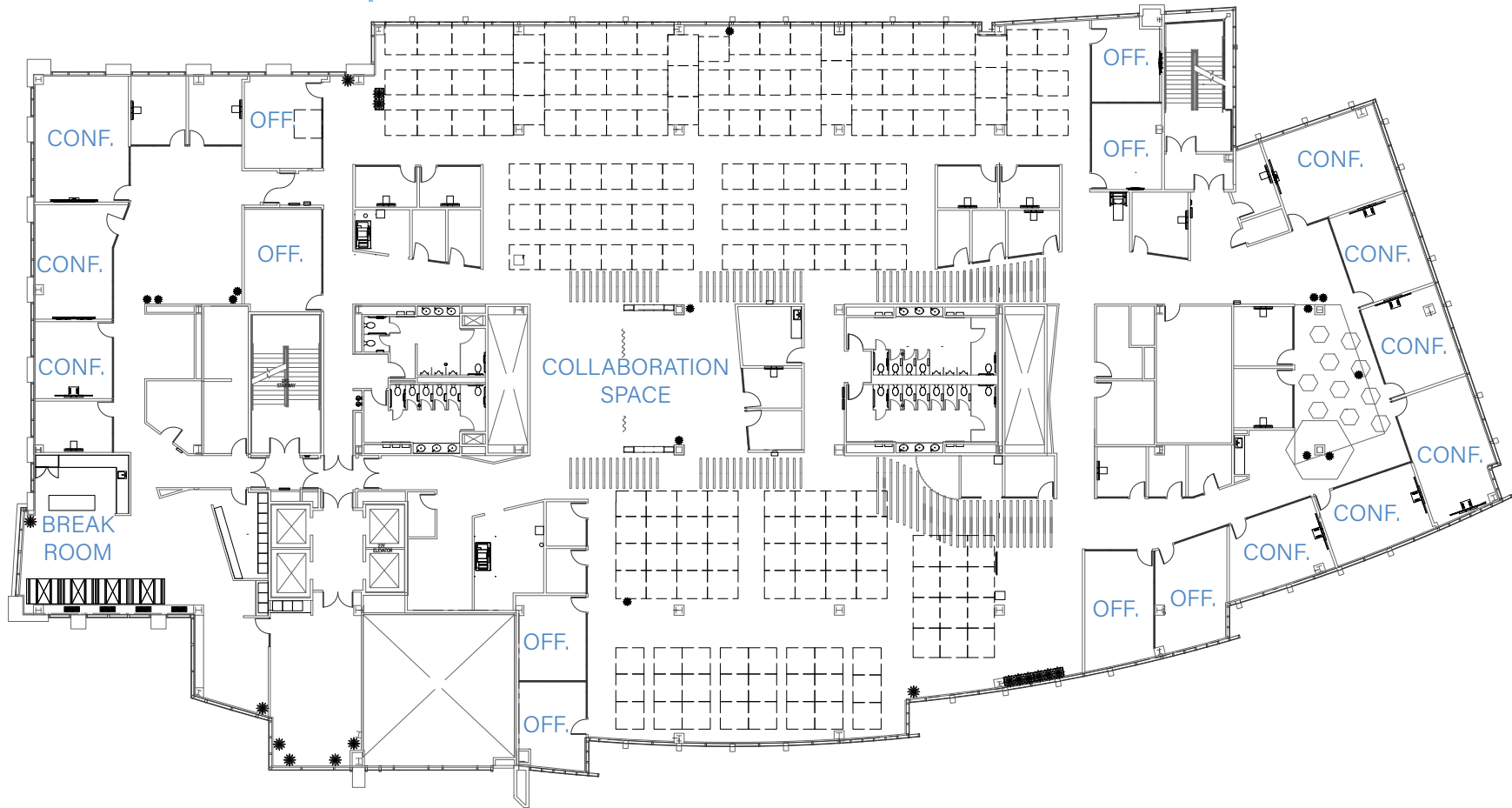

- 156 Workstations
- 9 Conference Rooms
- Break Room

# 1000 ENTERPRISE WAY

THIRD FLOOR | ±40,434 SF

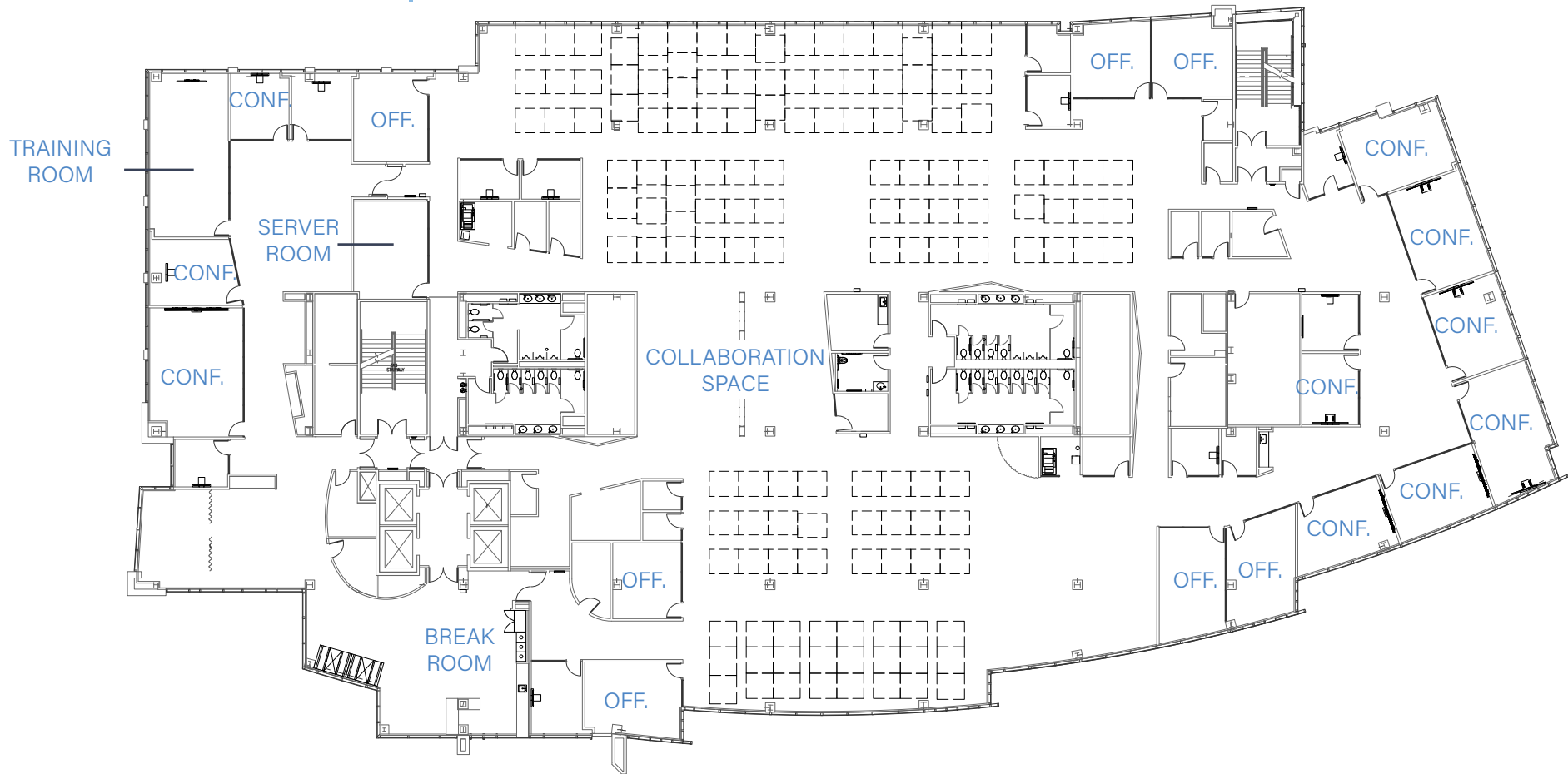

- 133 Workstations
- 10 Conference Rooms
- 1 Training Room
- Server Room
- Break Room



# 1000 ENTERPRISE WAY

FOURTH FLOOR | ±40,334 SF

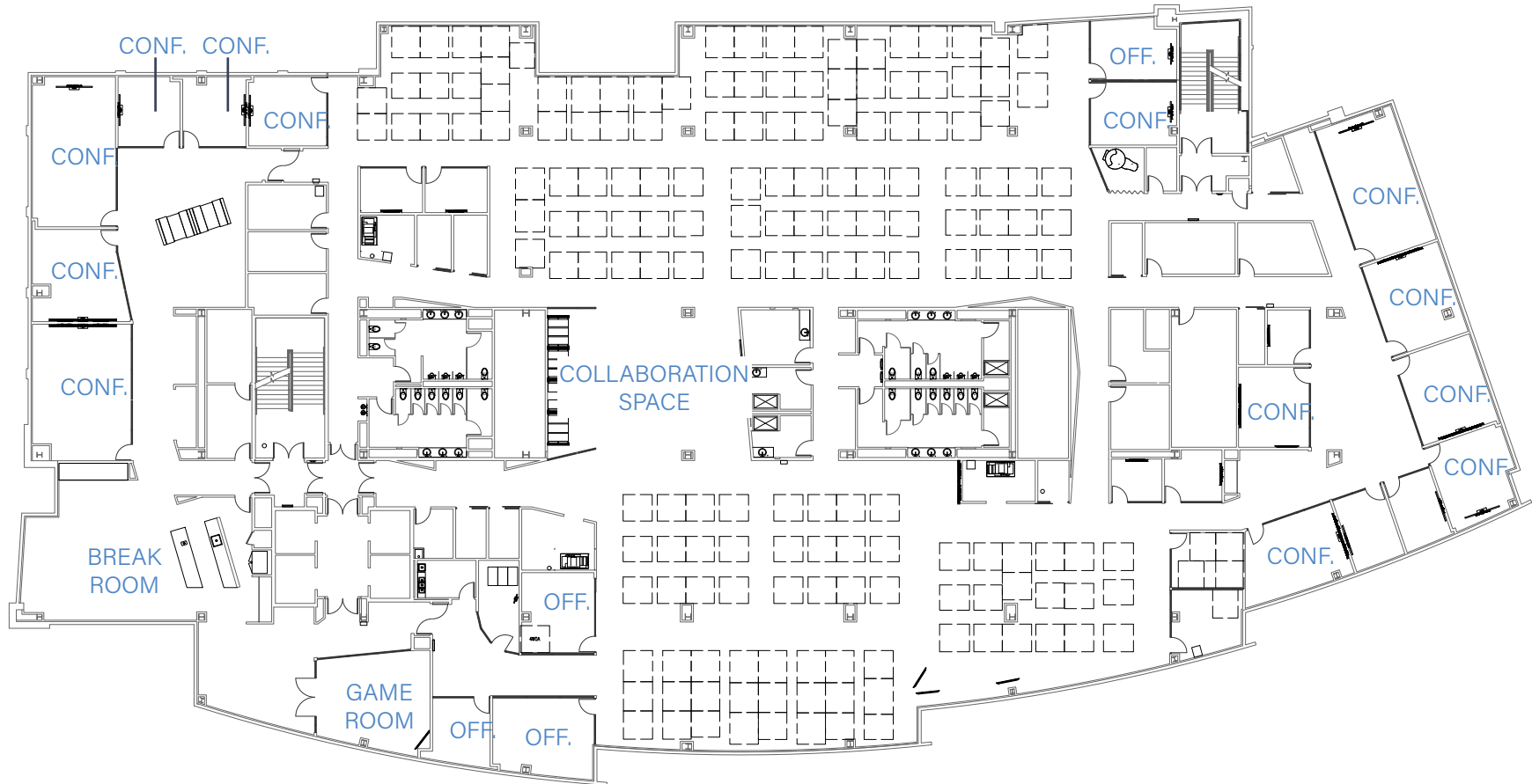

- 154 Workstations
- 13 Conference Rooms
- Break Room
- Game Room

# 1000 ENTERPRISE WAY

FIFTH FLOOR | ±40,335 SF

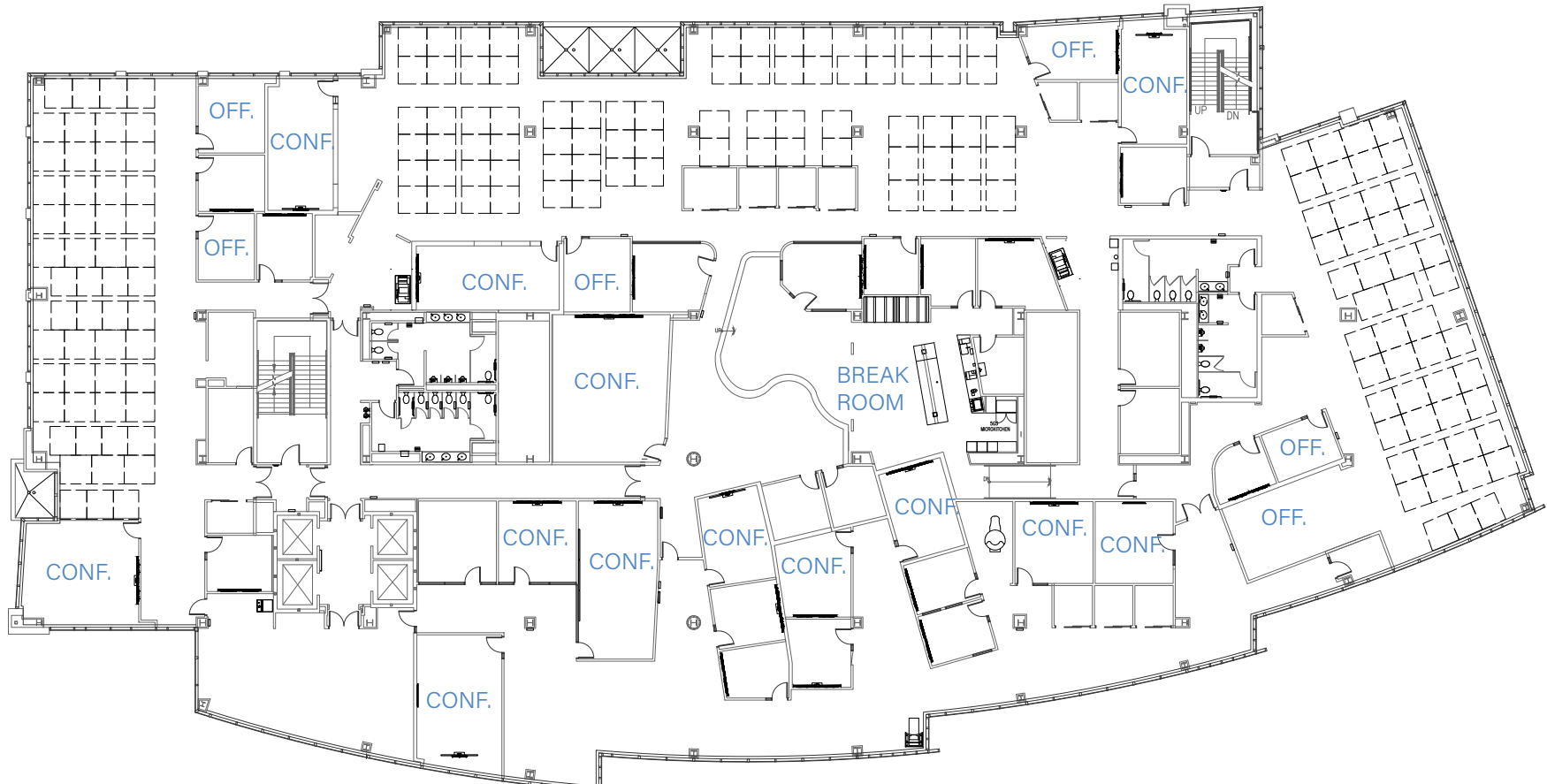

- 178 Workstations
- 13 Conference Rooms



# 1000 ENTERPRISE WAY

SIXTH FLOOR | ±40,184 SF

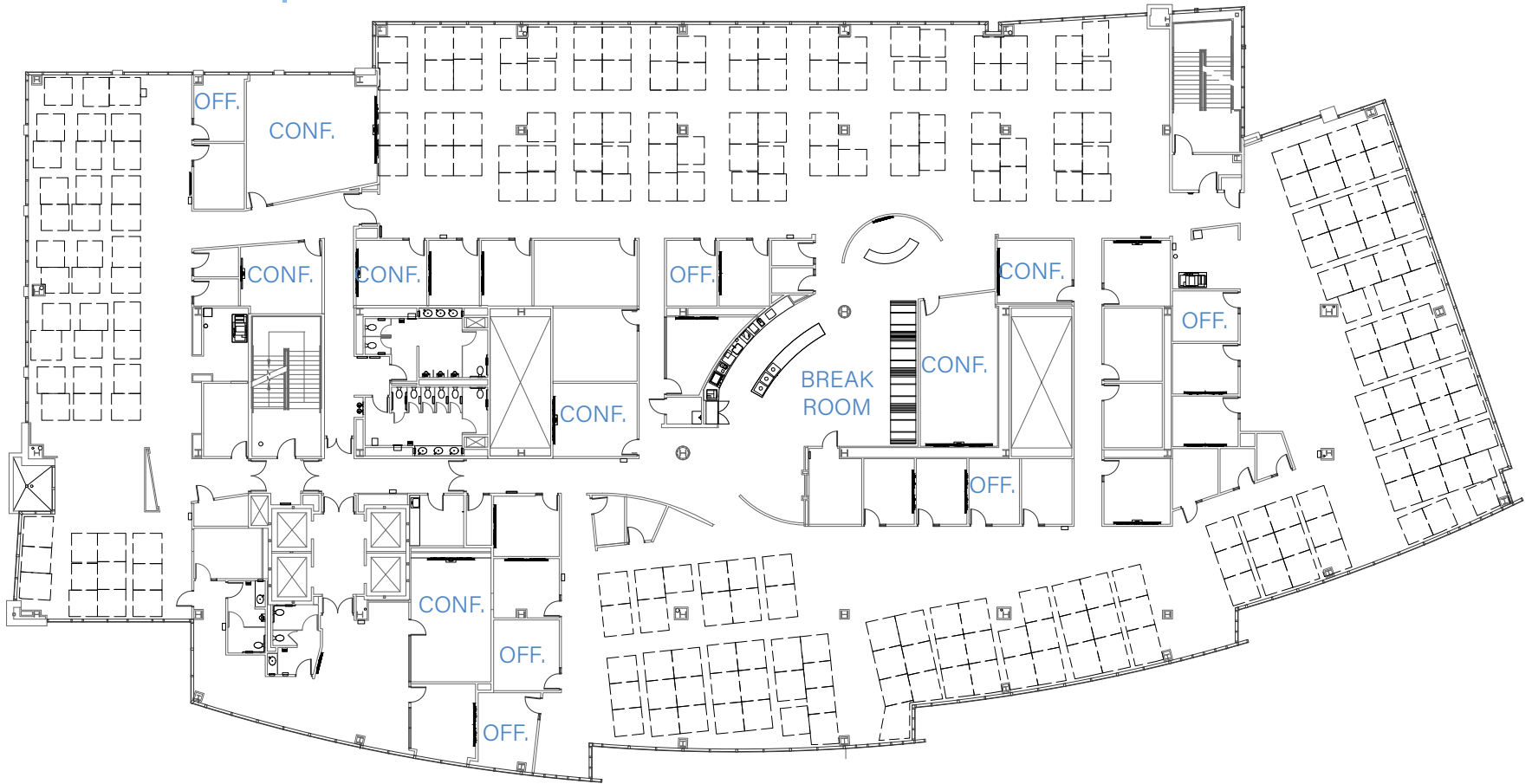

- 238 Workstations
- 7 Conference Rooms
- Break Room

# 1000 ENTERPRISE WAY

SEVENTH FLOOR | ±40,172 SF



- 136 Workstations
- 11 Conference Rooms
- Server Room
- Break Room



# 1000 ENTERPRISE WAY

EIGHTH FLOOR | ±38,392 SF

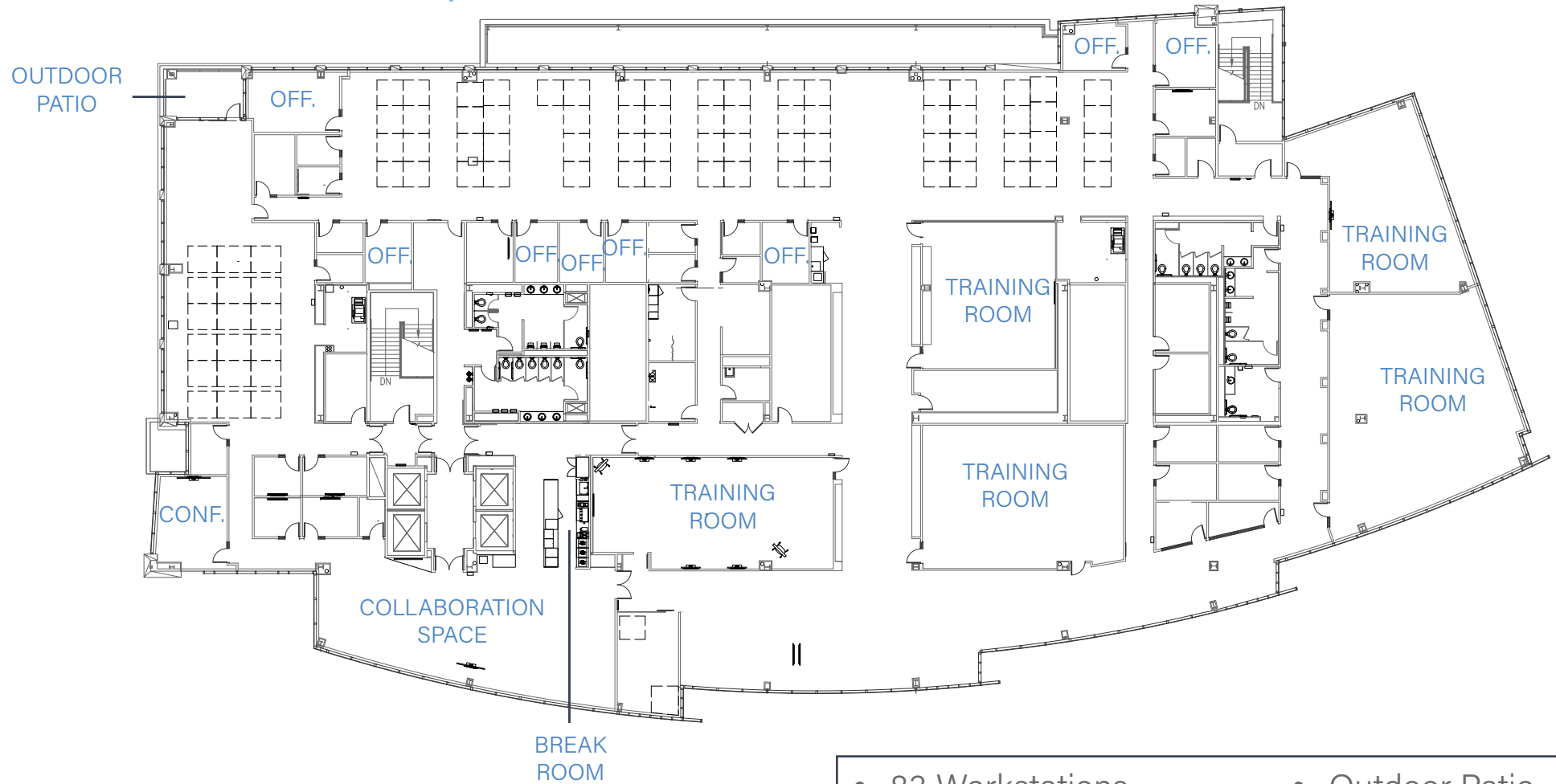

- 83 Workstations
- 1 Conference Room
- 5 Training Rooms
- Outdoor Patio
- Break Room

# AMENITY & TRANSPORTATION MAP





# MOFFETT TOWERS

1000, 1020 & 1050 ENTERPRISE WAY | SUNNYVALE

1000 Enterprise Way: ±317,166 SF

1020 Enterprise Way: ±317,166 SF

1050 Enterprise Way: ±181,196 SF

±38,392 - ±815,528 SF

## CONTACT

ERIK HALLGRIMSON | +1 408 615 3435 | ERIK.HALLGRIMSON@CUSHWAKE.COM | LIC #01274540

BRANDON BAIN | +1 408 615 3416 | BRANDON.BAIN@CUSHWAKE.COM | LIC #01308375

KELLY YODER | +1 408 615 3427 | KELLY.YODER@CUSHWAKE.COM | LIC #01821117

STEVE HORTON | +1 408 615 3412 | STEVE.HORTON@CUSHWAKE.COM | LIC #01127340

