

600
LEXINGTON
AVENUE

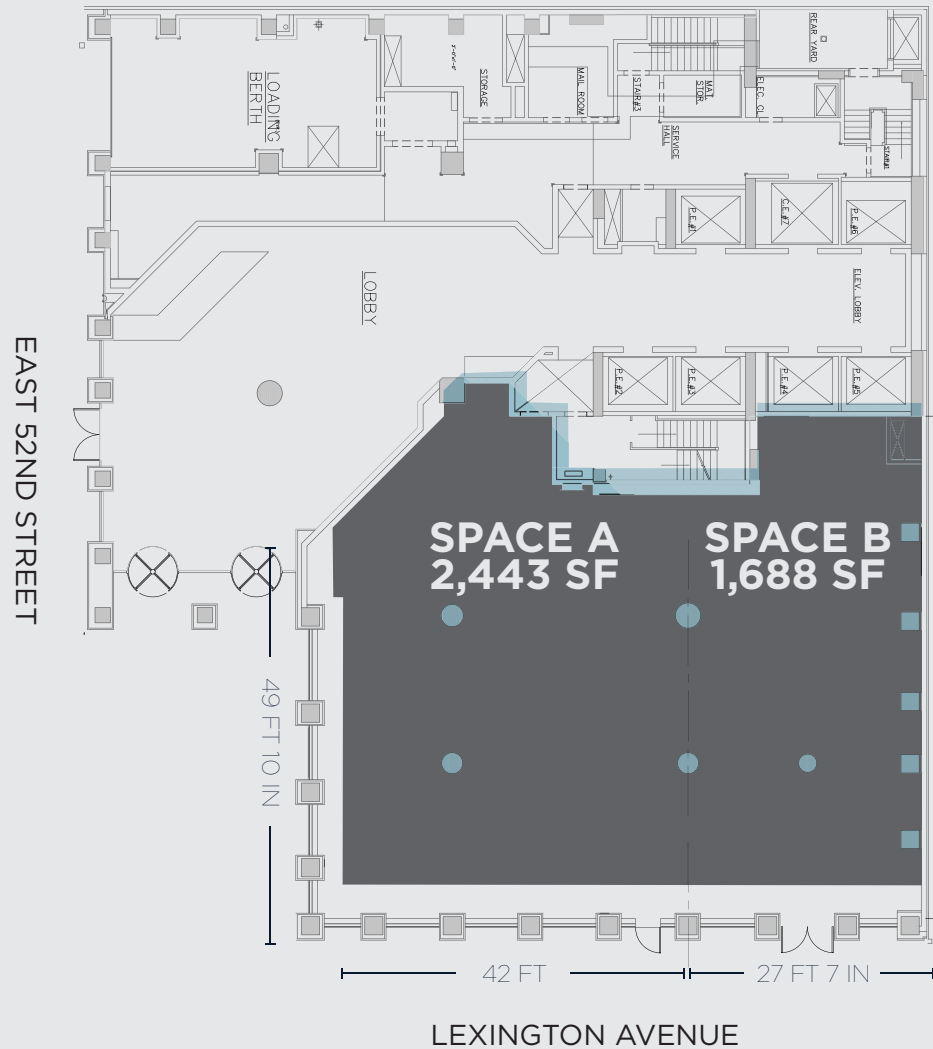

600

LEXINGTON
AVENUE



Premises

Ground A: 2,443 SF

Ground B: 1,688 SF

Total: 4,131 SF

Ceiling Height
19'

Possession
Immediate

Frontage

Space A: 42' on Lexington

Space B: 27' on Lexington

Comments

- Highly visible retail on Lexington, directly across from the 53rd Street Subway stop (19,000,000 annual ridership)
- At the base of a 36-story office tower
- Flexible division plan - all uses considered
- HVAC and ADA restrooms in place
- Fantastic neighboring co-tenants, including Sweetgreen, Shake Shack, Sugarfish, and Amazon Go
- One block from Urbanspace, and the newly opened Hugh Food Hall

54TH STREET



399 PARK AVENUE
1.7MM SF CLASS A
OFFICE BUILDING UNDER
REDEVELOPMENT



LEXINGTON AVENUE

ST. PETER'S
CHURCH



601 LEXINGTON
1.7MM SF CLASS A
OFFICE BUILDING



53RD STREET

LE JARDINIER



599 LEXINGTON
1.1MM SF



52ND STREET

LE RELAIS DE
VENISE
L'ENTRECOTE



DIG



MAISON KAYSER
ARTISAN BOUTIQUE
- PARIS

DUANEreade



51ST STREET



fresh&co

NeueHouse



DOUBLE TREE
by Hilton

DEMARCO
Coffee

THE NATIONAL
BAR & BISTRO GROUP

**Over 5 Million
Square Feet**
OF OFFICE SPACE IN 4
BLOCK RADIUS

ST. PATRICK'S
CATHEDRAL
Over 5 million
ANNUAL VISITORS

JP MORGAN CHASE'S
NEW HQ
2.5 million SF
OF OFFICE SPACE

600
LEXINGTON
AVENUE

Bloomingdale's
BLOOMINGDALE'S
800,000 SF FLAGSHIP

**19MM annual
ridership**
53RD STREET E, M, & 6
SUBWAY STATION

GRAND CENTRAL
TERMINAL
over 21 million
ANNUAL VISITORS

TIMES
SQUARE

GRAND
CENTRAL
TERMINAL

EMBASSY
PLAZA

PLAZA
DISTRICT

TOWN

ROCKEFELLER
CENTER

Michael A. Azarian

212 841 7831

MICHAEL.AZARIAN@CUSHWAKE.COM

James Ariola

212 698 2572

JAMES.ARIOLA@CUSHWAKE.COM

