



FOR LEASE

30311 Whipple Road

Alvarado Business Park | Union City, California

End Unit



Property Highlights

- ±15,439 Square Feet Warehouse (End Unit with Adjacent Parking)
- ±1,500 Square Feet Office Space
- 24' Minimum Clear Height
- 3 Dock High Doors / 1 Grade Level Door
- ±0.33 GPM/3,000 SF Sprinkler System
- 24' X 60' Column Spacing
- Available September 1, 2023

Lease Rate: Call Broker

ALVARADO BUSINESS PARK is a 10 building 1.2 million square foot business park with close access to I-880 and HWY 92 offering solutions for today and expansion for future growth.

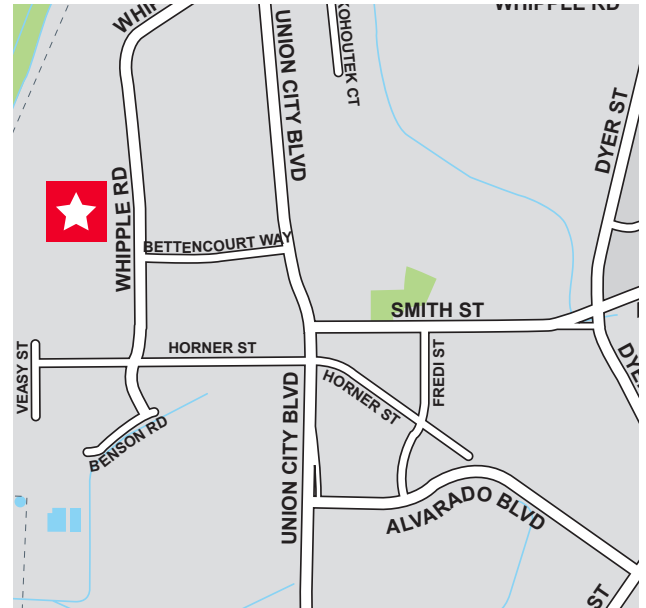

Jeff Starkovich, SIOR
Executive Managing Director
+1 510 409 1111
jeff.starkovich@cushwake.com
LIC #00644571 | cushmanwakefield.com



Mark Maguire, SIOR
Executive Vice President
+1 510 433 5835
mark.maguire@colliers.com
LIC #01190597 | www.colliers.com





FOR LEASE

30311 Whipple Road

Alvarado Business Park | Union City, California

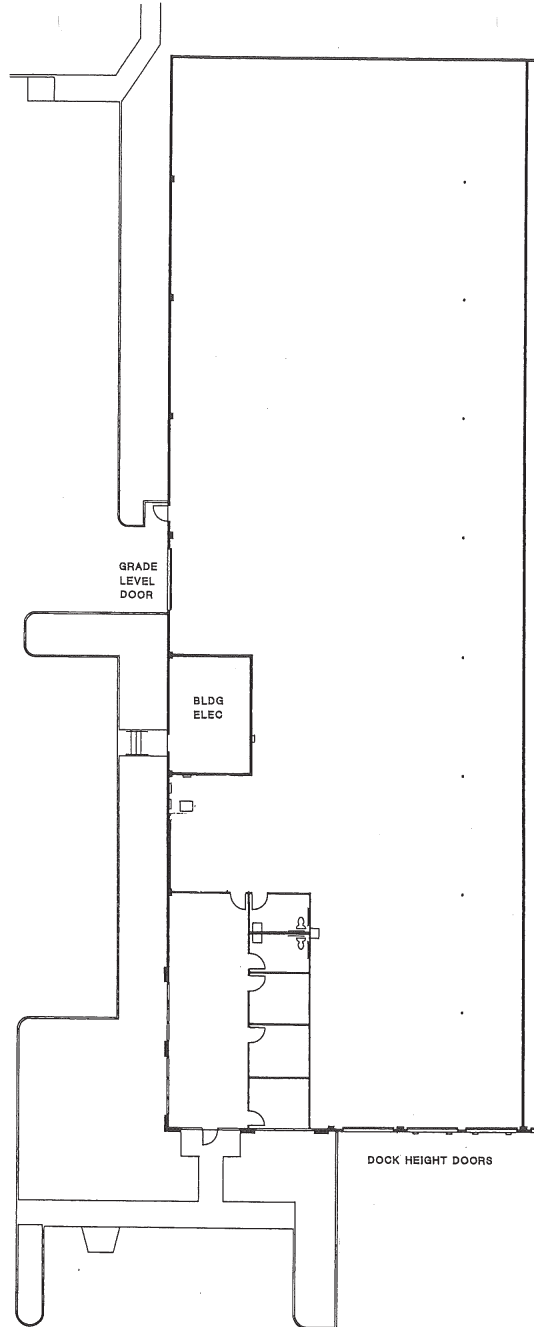

Jeff Starkovich, SIOR
Executive Managing Director
+1 510 409 1111
jeff.starkovich@cushwake.com
LIC #00644571 | cushmanwakefield.com



Mark Maguire, SIOR
Executive Vice President
+1 510 433 5835
mark.maguire@colliers.com
LIC #01190597 | www.colliers.com

