

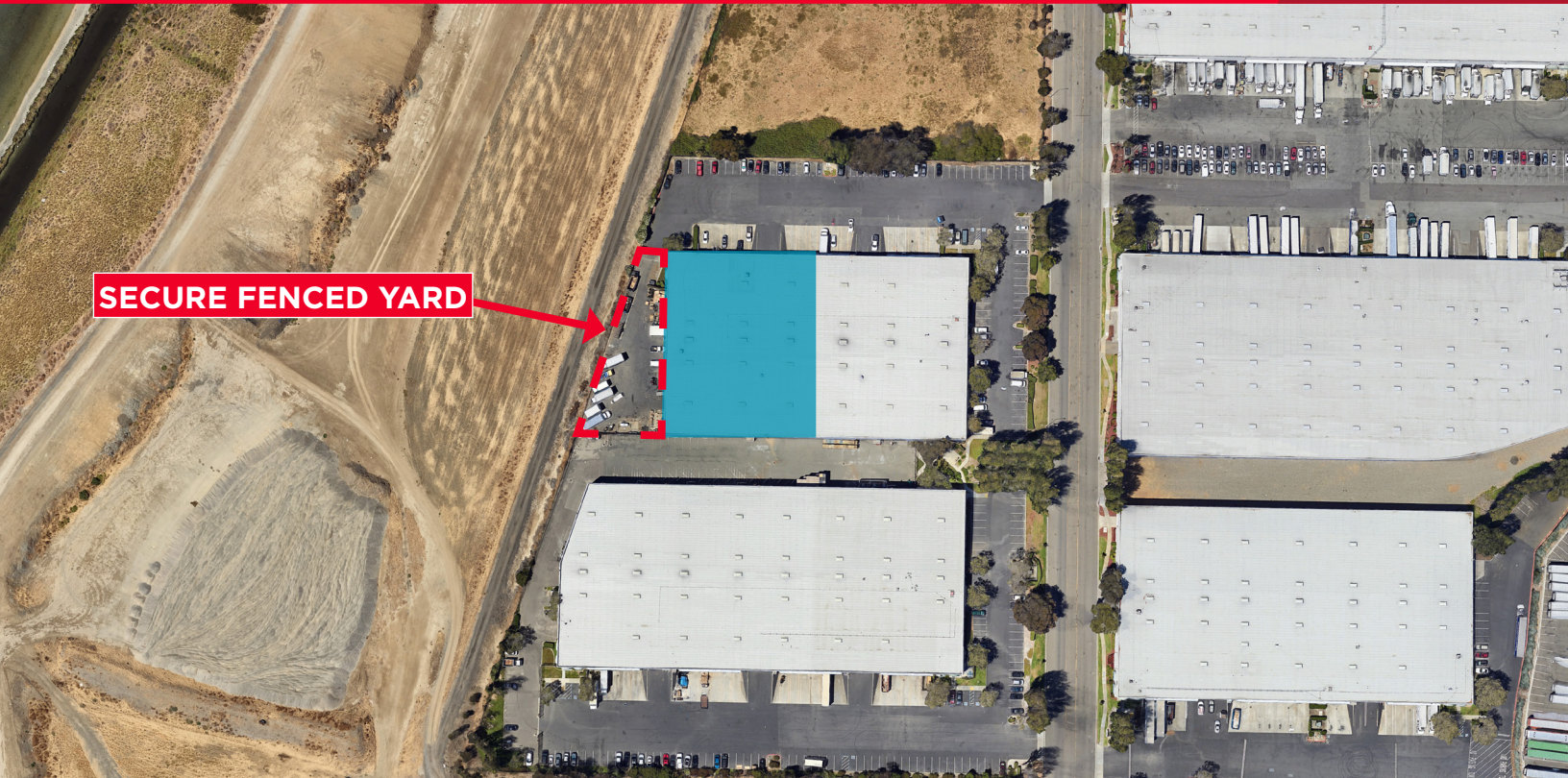

FOR LEASE

30361 Whipple Road

Alvarado Business Park | Union City, California



Property Highlights

- ±39,150 SF of Warehouse Space
- ±4,000 SF of Office Space
- 24' Minimum Clear Height
- 6 Dock Doors / 3 Drive-in Doors
- 24' x 60' column spacing
- Power: 1,000 Amps 277/480 Volt
- Fenced side yard area
- High image business park
- Corner unit
- Close proximity to I-880
- Available Now

ALVARADO BUSINESS PARK is a 10 building 1.2 million square foot business park with close access to I-880 and HWY 92 offering solutions for today and expansion for future growth.

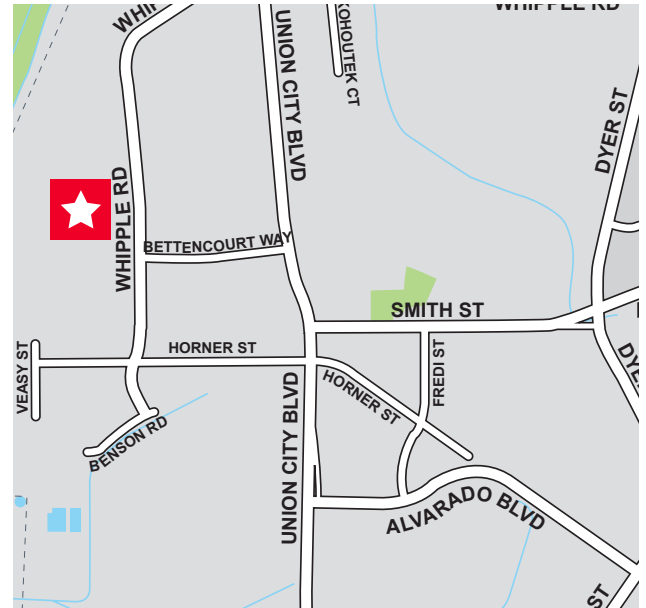

Jeff Starkovich, SIOR
Executive Managing Director
+1 510 409 1111
jeff.starkovich@cushwake.com
LIC #00644571 | cushmanwakefield.com



Mark Maguire, SIOR
Executive Vice President
+1 510 219 7854
mark.maguire@colliers.com
LIC #01190597 | www.colliers.com





**CUSHMAN &
WAKEFIELD**

FOR LEASE

30361 Whipple Road

Alvarado Business Park | Union City, California

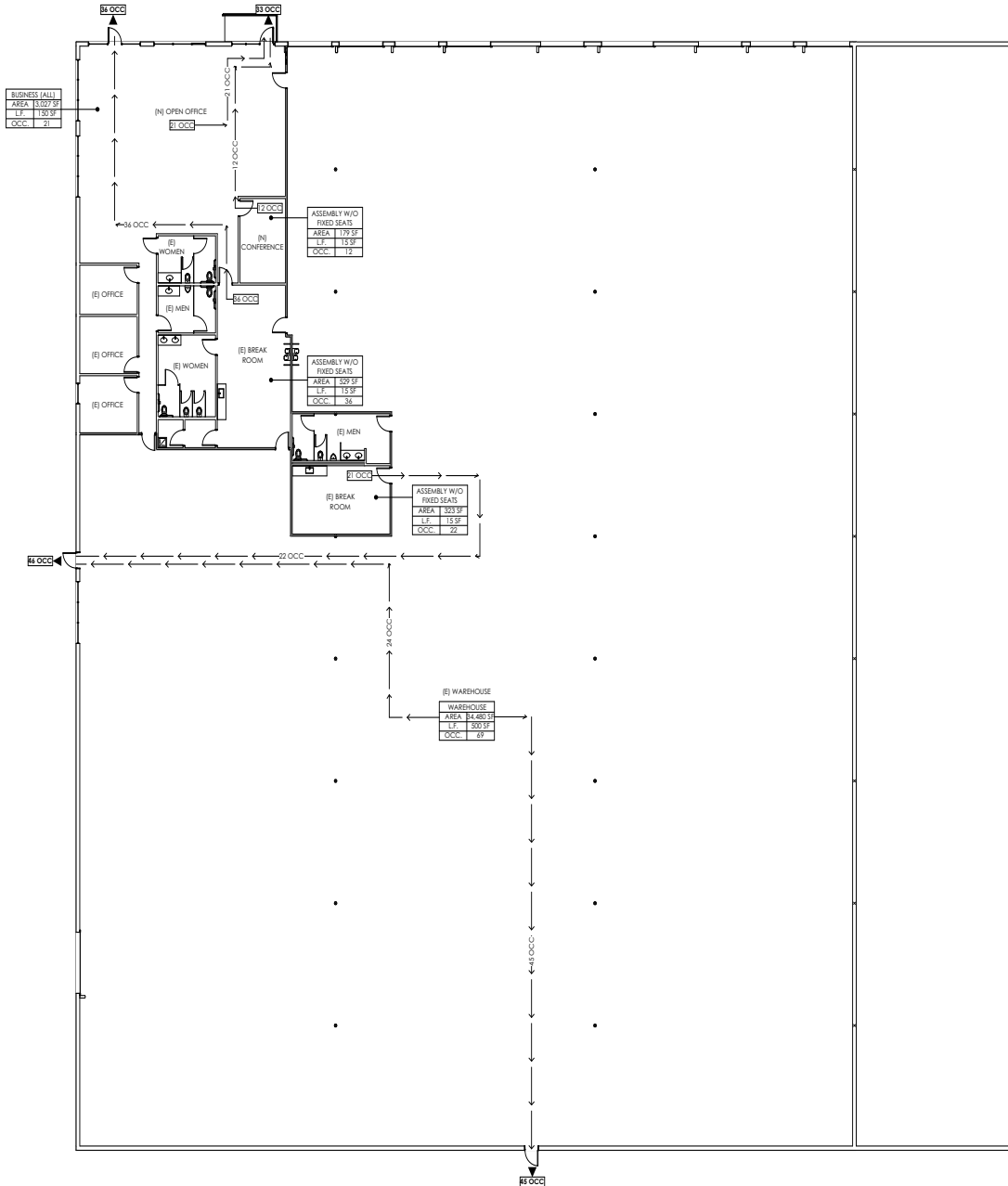

Jeff Starkovich, SIOR
Executive Managing Director
+1 510 409 1111
jeff.starkovich@cushwake.com
LIC #00644571 | cushmanwakefield.com



Mark Maguire, SIOR
Executive Vice President
+1 510 219 7854
mark.maguire@colliers.com
LIC #01190597 | www.colliers.com

