



LEVEL 9 - 12,093 RSF FOR SUBLEASE

TWO MEMORIAL CITY PLAZA
820 GESSNER
HOUSTON, TEXAS 77024

SUBLEASE TERMS

- 9th Floor- 12,093 RSF
- Immediate Availability
- Term through August 31, 2023
- Rate: Negotiable
- OPEX: \$13.80/RSF
- Parking: 41 unreserved spaces at \$25.00/space/month
- “As-Is”
- Furniture: Negotiable



CONTACT:
KEVIN R. SNODGRASS
Vice Chairman
713 877 8539
kevin.snodgrass@cushwake.com

Floor Plan

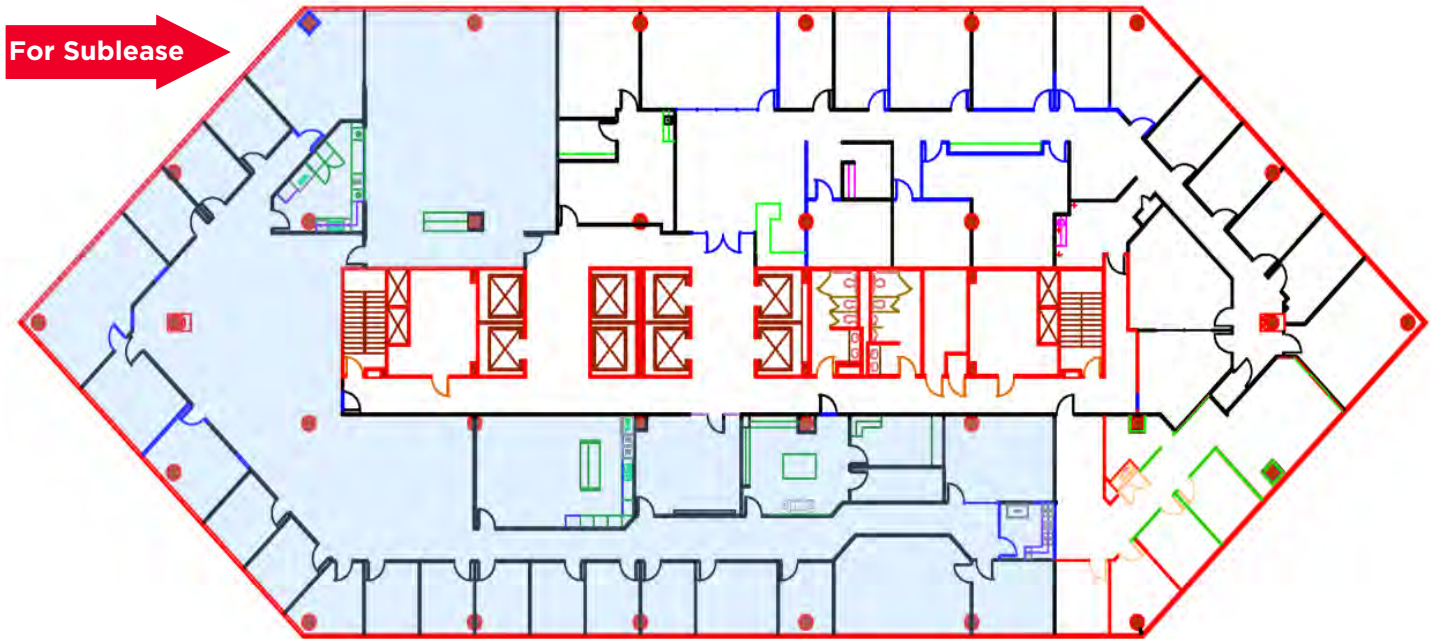

Level 9 - 12,093 RSF

- 23 Private Offices
- Workstations
- Large Workroom
- Large Conference room with seating
- Kitchen/Breakroom
- Reception
- Server Room

Building Amenities

- 24-Hour on-site security
- Air Conditioned Skywalk
- On-site Deli
- Walking distance to Memorial City Mall
- Access to tenant only gym

CONTACT:

KEVIN R. SNODGRASS

Vice Chairman

713 877 8539

kevin.snodgrass@cushwake.com

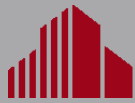

**CUSHMAN &
WAKEFIELD**



CONTACT:

KEVIN R. SNODGRASS

Vice Chairman

713 877 8539

kevin.snodgrass@cushwake.com

©2021 Cushman & Wakefield. All rights reserved. The information contained in this communication is strictly confidential. This information has been obtained from sources believed to be reliable but has not been verified. NO WARRANTY OR REPRESENTATION, EXPRESS OR IMPLIED, IS MADE AS TO THE CONDITION OF THE PROPERTY (OR PROPERTIES) REFERENCED HEREIN OR AS TO THE ACCURACY OR COMPLETENESS OF THE INFORMATION CONTAINED HEREIN, AND SAME IS SUBMITTED SUBJECT TO ERRORS, OMISSIONS, CHANGE OF PRICE, RENTAL OR OTHER CONDITIONS, WITHDRAWAL WITHOUT NOTICE, AND TO ANY SPECIAL LISTING CONDITIONS IMPOSED BY THE PROPERTY OWNER(S). ANY PROJECTIONS, OPINIONS OR ESTIMATES ARE SUBJECT TO UNCERTAINTY AND DO NOT SIGNIFY CURRENT OR FUTURE PROPERTY PERFORMANCE.