



381 EAST EVELYN AVENUE



±46,682 SF SUBLEASE
AVAILABLE NOW

MOUNTAIN VIEW, CA

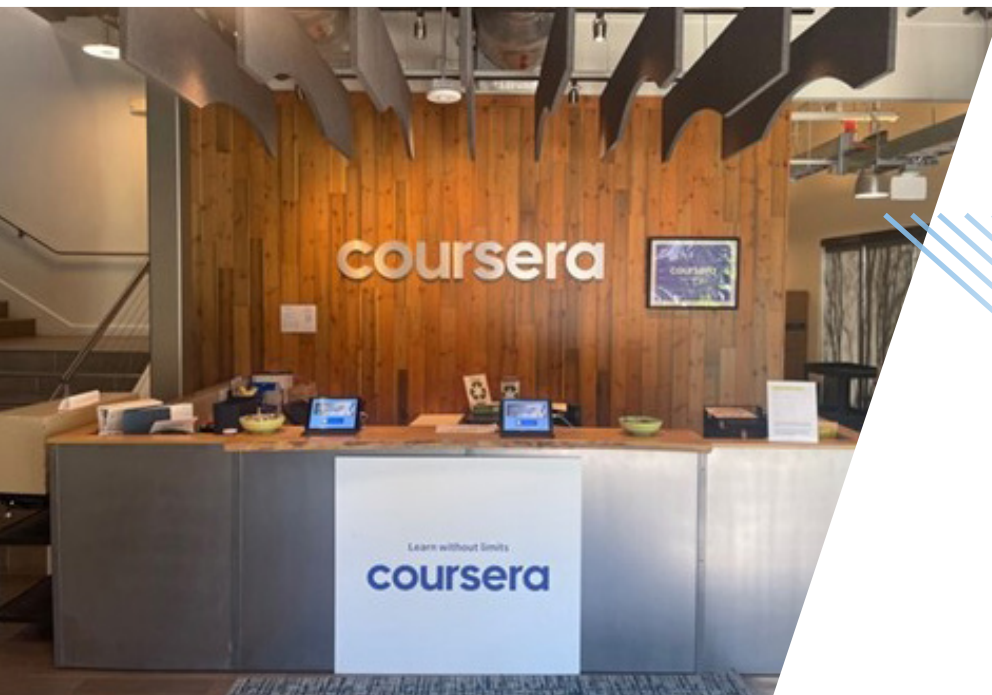

OPPORTUNITY HIGHLIGHTS

- ▶ Class A Creative Office Space
- ▶ 3.83/1,000 Parking Ratio
- ▶ LED: 11/30/2024
(Longer Term Available Direct)
- ▶ Full Project Landscape Renovation Completed
- ▶ FF&E Available
- ▶ On-Site Bike Storage

FIRST FLOOR

±23,341 SF



SECOND FLOOR

±23,341 SF

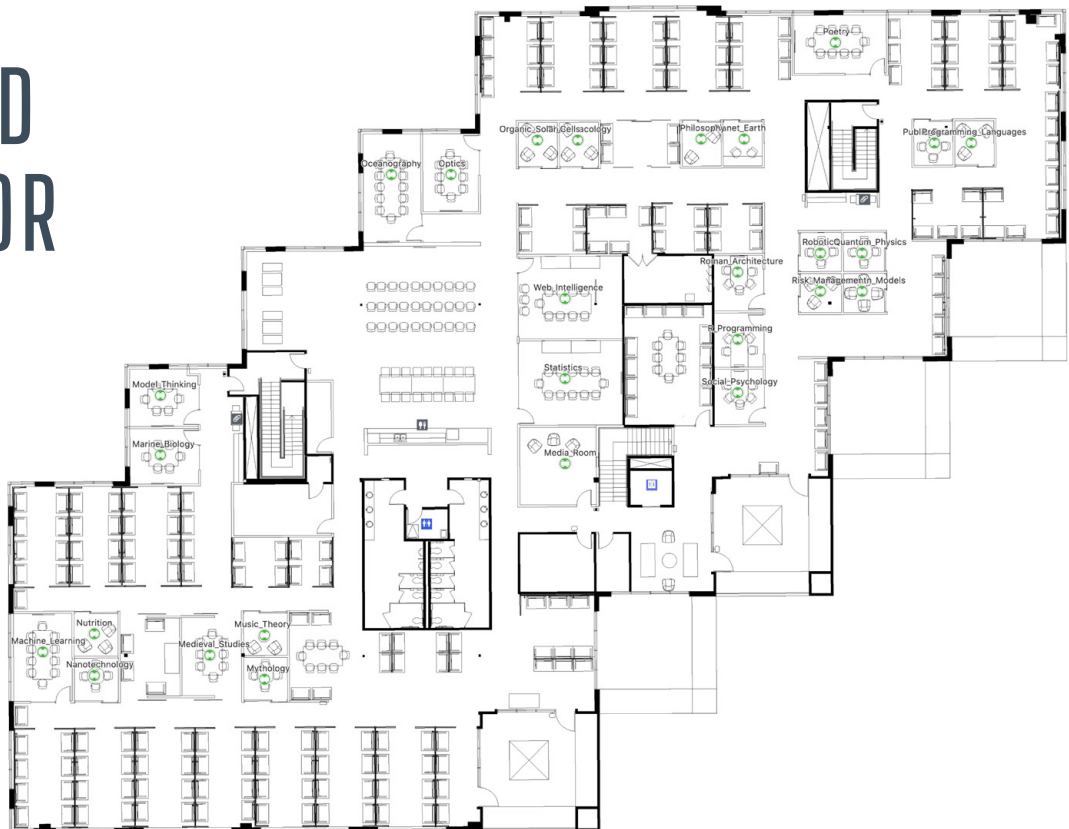

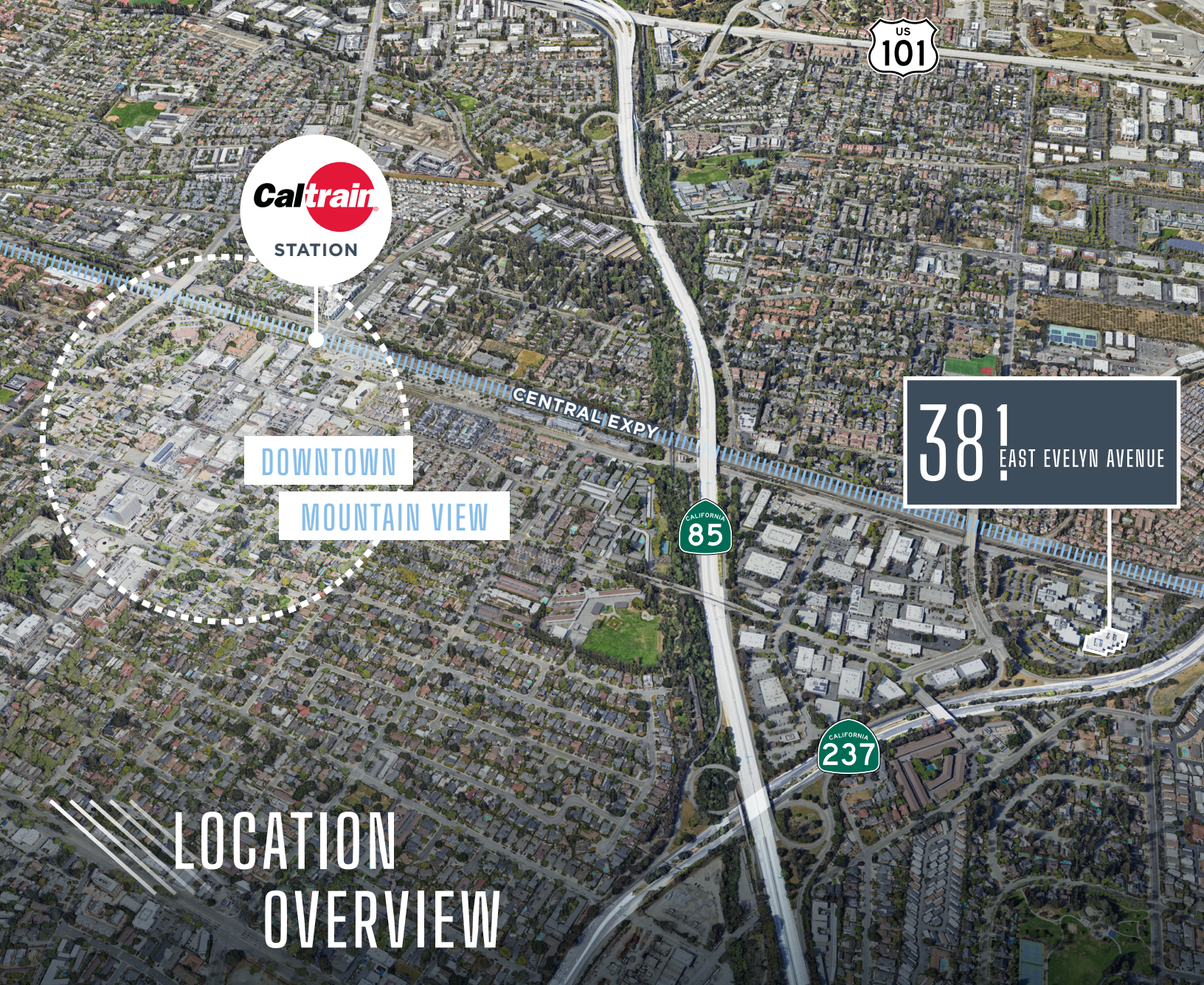

- ▶ 1 Mile from Downtown Mountain View Amenities, Caltrain, Restaurants & Light Rail
- ▶ Direct access to CA-237 freeway
- ▶ Easy access to nearby Stevens Creek Trail

DOWNTOWN MOUNTAIN VIEW AMENITIES:

- | | | |
|----------------|-------------------------|---------------------------|
| The Posh Bagel | Dana Street Roasting | Crepvine |
| Cascal | KappoNami Nam | Cafe Baklava |
| Kirin Chinese | Steins Beer Garden | NijiSushi |
| Scratch | Tied House | Shalala |
| Bierhaus | Molly Magees | AmarinThai Cuisine |
| Sakoon | St. Stephen' s Green | Xanh |
| Shiva's Indian | Red Rock Coffee Ephesus | Mountain View Post Office |
| Sushi Tomi | Fu Lam Mum | Subway |
| Maru Ichi | Olympus Caffè & Bakery | Agave Mexican Bistro |



381

EAST EVELYN AVENUE
MOUNTAIN VIEW, CA

±46,682 SF SUBLEASE
AVAILABLE NOW

For More Information, Please Contact:

Mike Mordaunt

Executive Vice Chairman

Mobile: 415-992-1095

Mike.Mordaunt@cushwake.com

Lic #01778048

Nate Currie

Executive Managing Director

Mobile: 650-804-9103

Nate.Currie@cushwake.com

Lic #01418567

