



FOR SUBLEASE

# 200 BAY STREET, NORTH TOWER

52,650 SF OVER THREE FLOORS





FLOORPLAN  
7<sup>th</sup> Floor - 17,540 SF

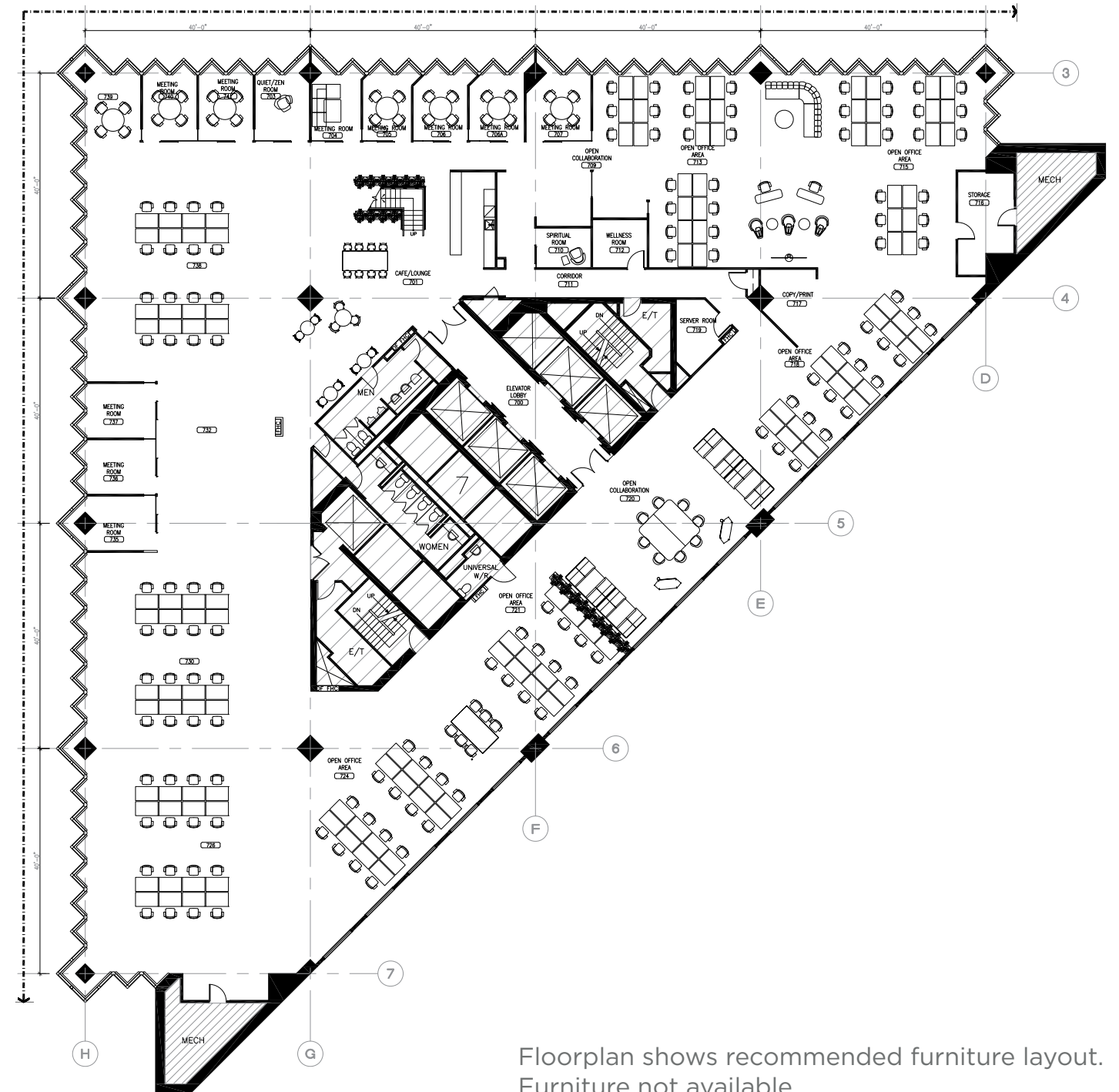

Floorplan shows recommended furniture layout. Furniture not available.



FOR SUBLEASE  
**200 BAY STREET,  
NORTH TOWER**

DETAILS

Availability: 7<sup>th</sup> Floor - 17,540 SF  
8<sup>th</sup> Floor - 17,570 SF  
9<sup>th</sup> Floor - 17,540 SF  
*Floors can be leased separately or together*

Net Rent: Negotiable  
(call Listing Agent)

Additional Rent: \$34.04 PSF (2024 est.)

Occupancy: Immediately

Sublease Term: October 31, 2027

HIGHLIGHTS

- Newly renovated premises
- Built out with offices on glass, meeting rooms, open area, kitchen located on each floor and interconnecting stairwell
- Building amenities include bicycle parking, showers and change facilities
- Steps away from Union Station, TTC Subway, streetcars and buses
- PATH Connected

# FLOORPLAN

8<sup>th</sup> Floor - 17,570 SF

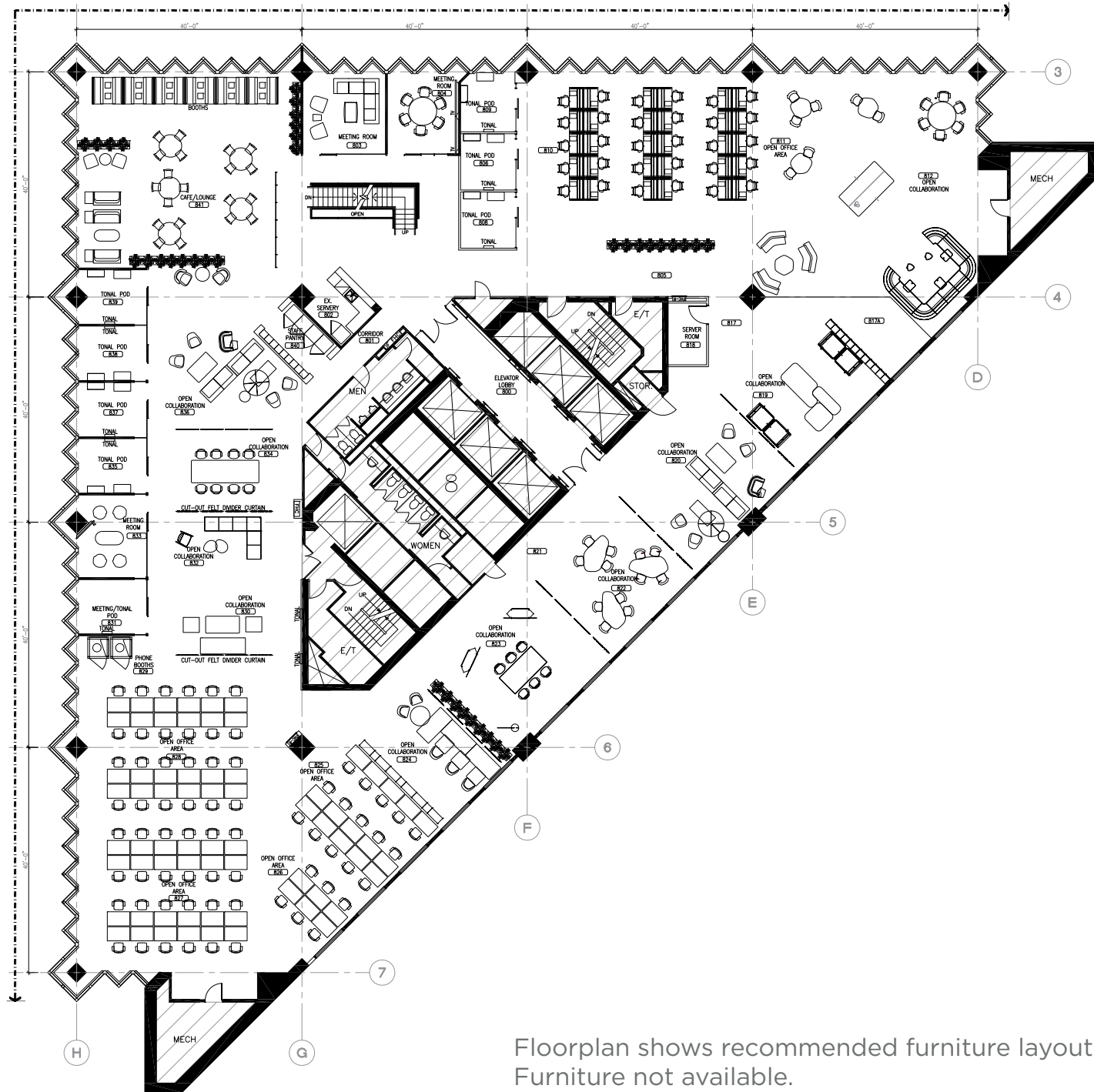

Floorplan shows recommended furniture layout. Furniture not available.



# FLOORPLAN

9<sup>th</sup> Floor - 17,540 SF

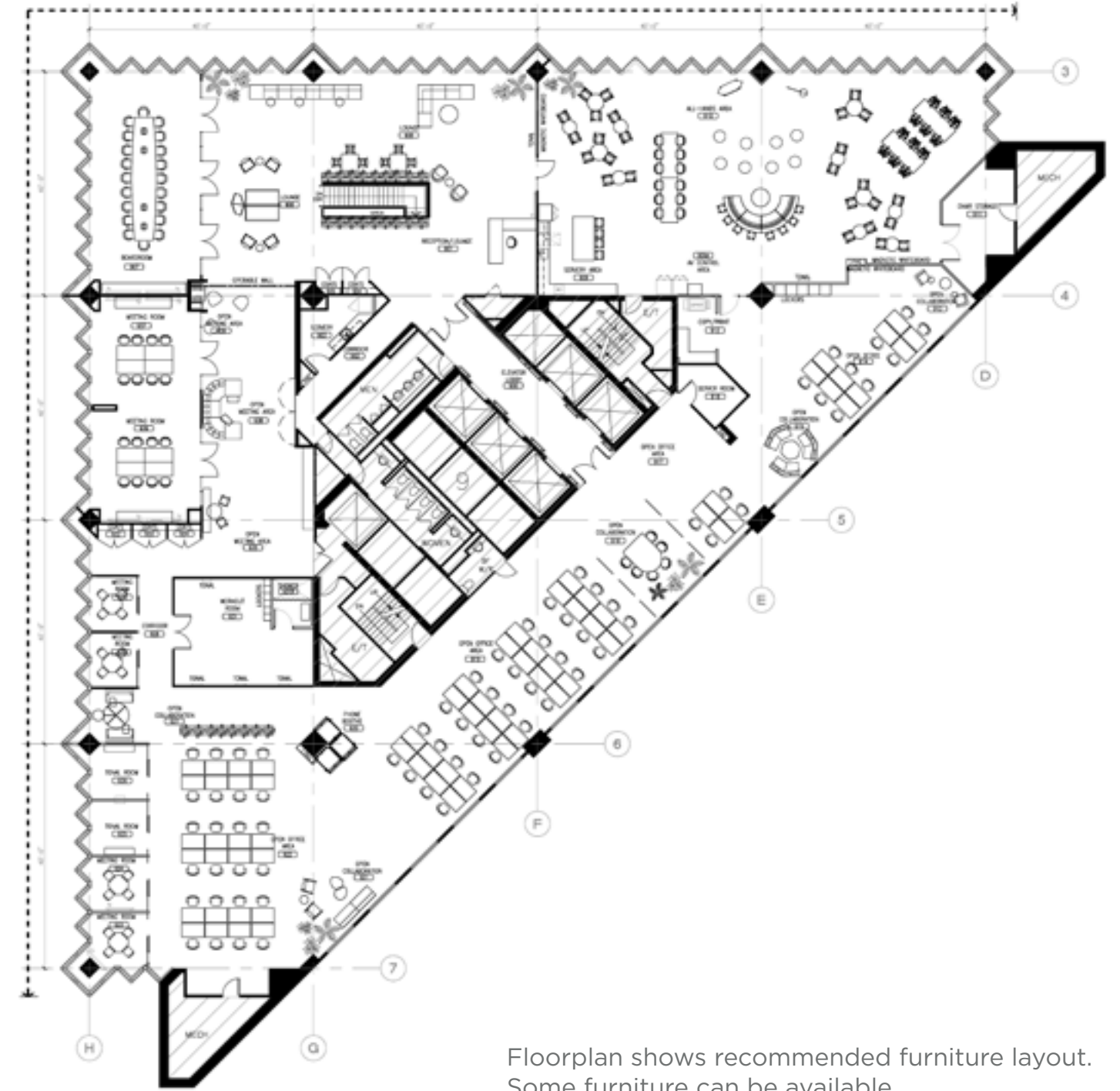

Floorplan shows recommended furniture layout. Some furniture can be available.



7<sup>TH</sup> FLOOR  
17,540 SF



8<sup>TH</sup> FLOOR  
17,570 SF



9<sup>TH</sup> FLOOR  
17,540 SF



## CONTACT

**Sabrina Oliver\***

Associate

416 359 2758

sabrina.oliver@cushwake.com

**Derek Snyder\***

Vice Chair

416 359 2459

derek.snyder@cushwake.com

**Cushman & Wakefield ULC, Brokerage**

161 Bay Street, Suite 1500

Toronto, ON M5J 2S1

416 862 0611

**Cushman & Wakefield ULC, Brokerage**

No warranty or representation, expressed or implied, is made as to the accuracy of the information contained herein, and same is submitted subject to errors, omissions, change of price, rental or other conditions, withdrawal without notice, and to any specific listing condition, imposed by our principals. \*Sales Representative

