

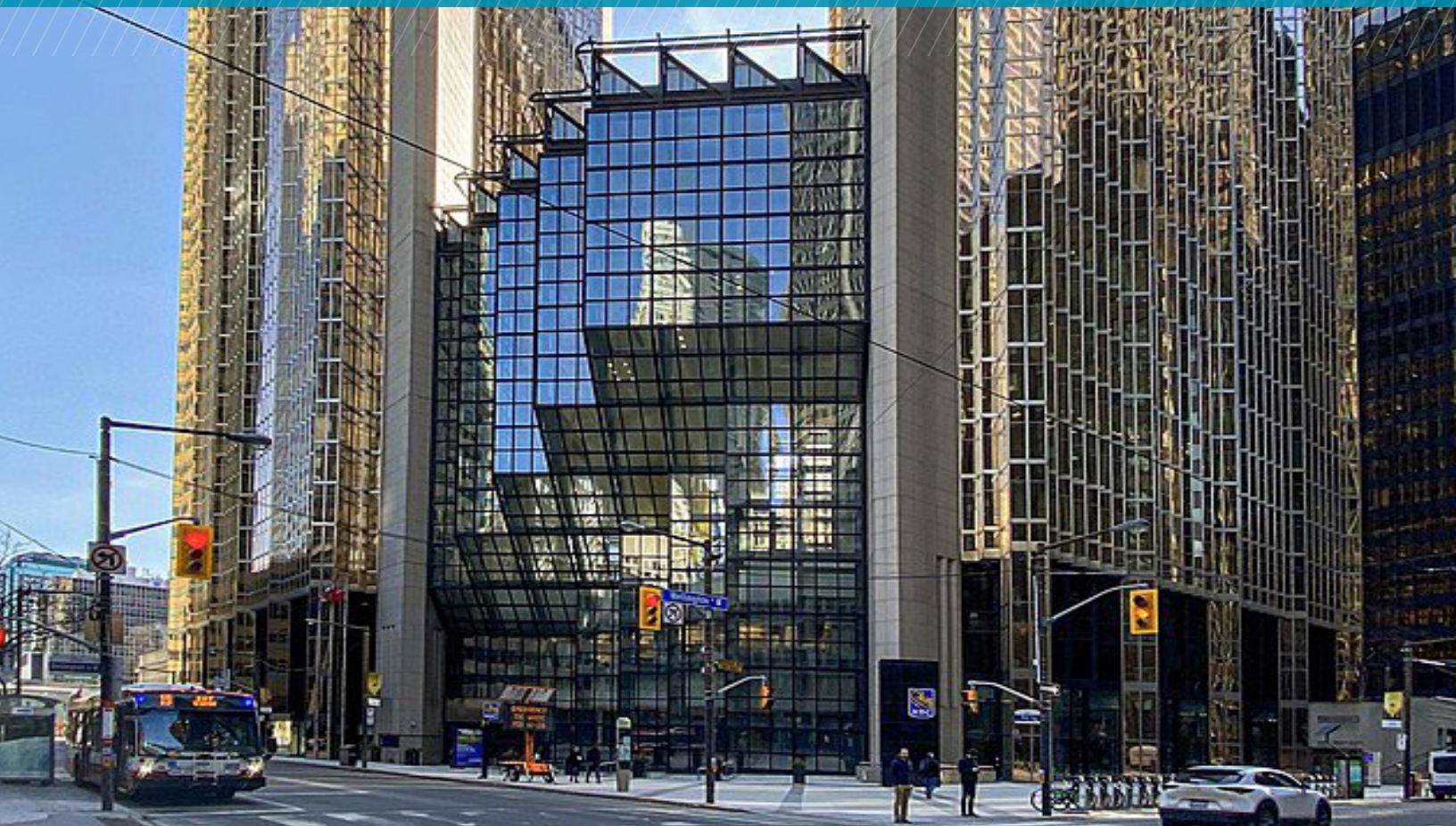

FOR SUBLEASE

200 BAY STREET, NORTH TOWER

52,650 SF OVER THREE FLOORS





FLOORPLAN
7th Floor - 17,540 SF

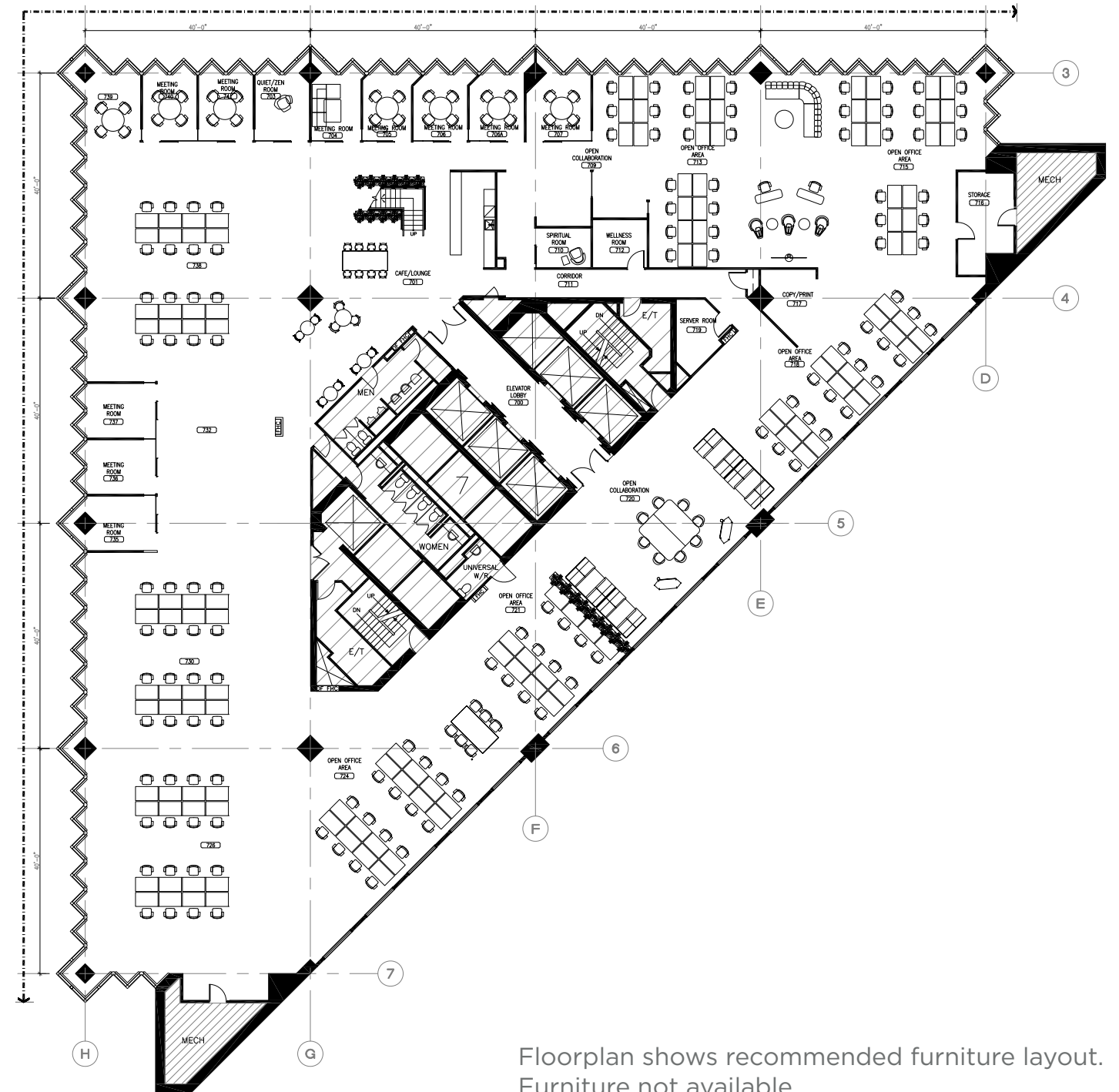

Floorplan shows recommended furniture layout. Furniture not available.



FOR SUBLEASE
**200 BAY STREET,
NORTH TOWER**

DETAILS

Availability:	7th Floor - 17,540 SF 8th Floor - 17,570 SF 9th Floor - 17,540 SF <i>Floors can be leased separately or together</i>
Net Rent:	Negotiable (call Listing Agent)
Additional Rent:	\$31.07 PSF (2023 est.)
Occupancy:	Immediately
Sublease Term:	October 31, 2027

HIGHLIGHTS

- Newly renovated premises
- Built out with offices on glass, meeting rooms, open area, kitchen located on each floor and interconnecting stairwell
- Building amenities include bicycle parking, showers and change facilities
- Steps away from Union Station, TTC Subway, streetcars and buses
- PATH Connected

FLOORPLAN

8th Floor - 17,570 SF

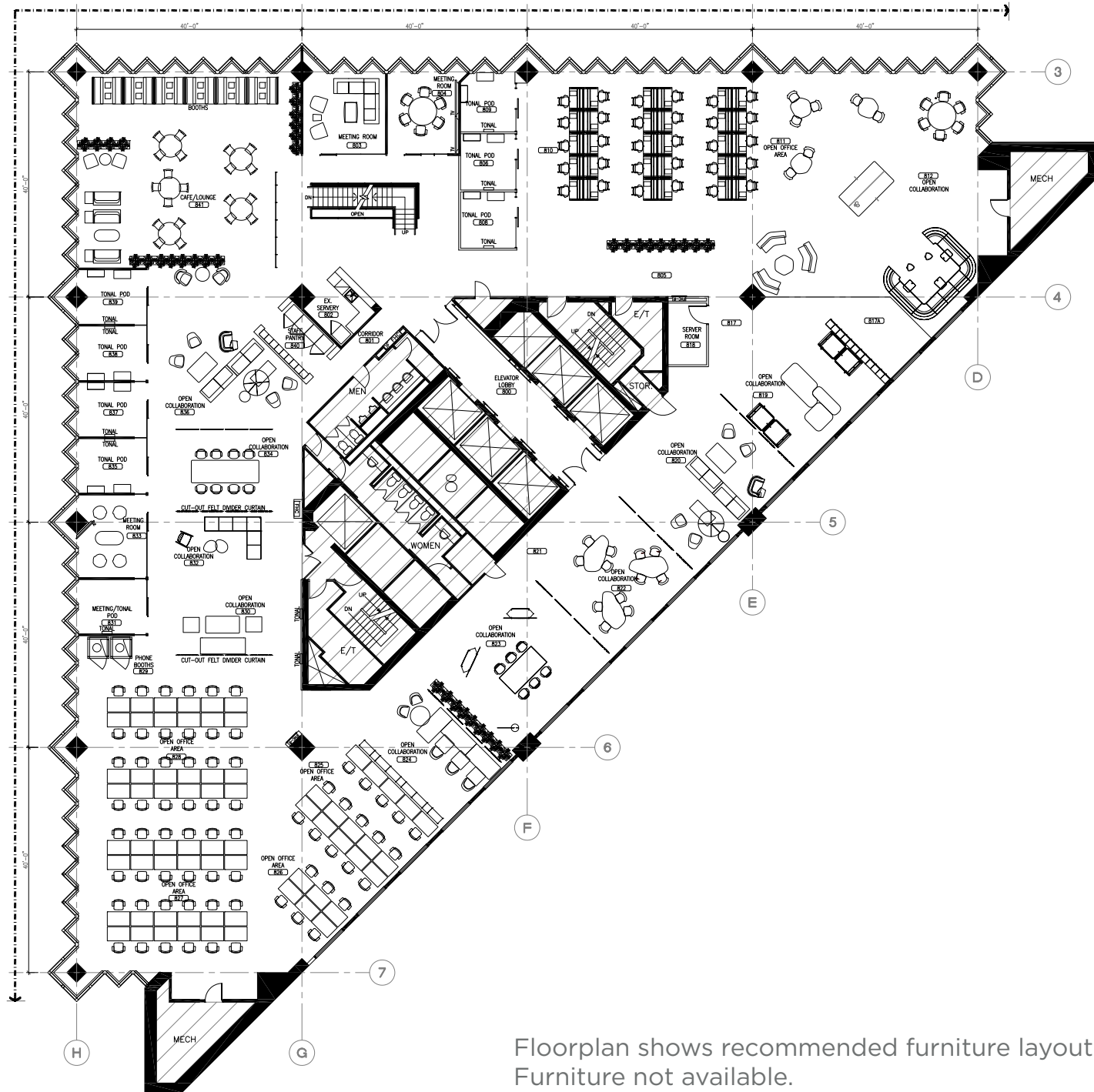

Floorplan shows recommended furniture layout. Furniture not available.



FLOORPLAN

9th Floor - 17,540 SF

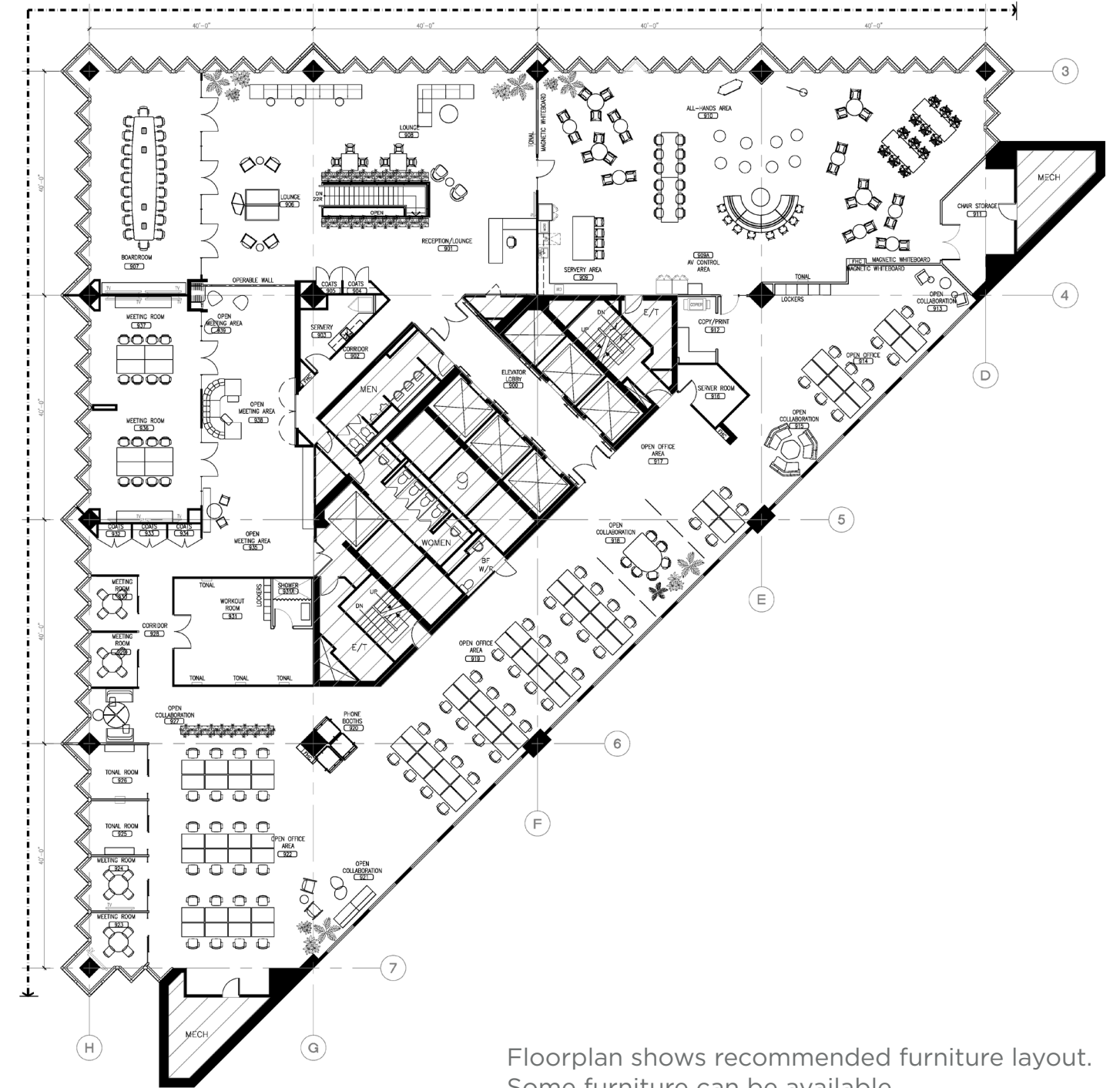

Floorplan shows recommended furniture layout. Some furniture can be available.



7TH FLOOR
17,540 SF



8TH FLOOR
17,570 SF



9TH FLOOR
17,540 SF

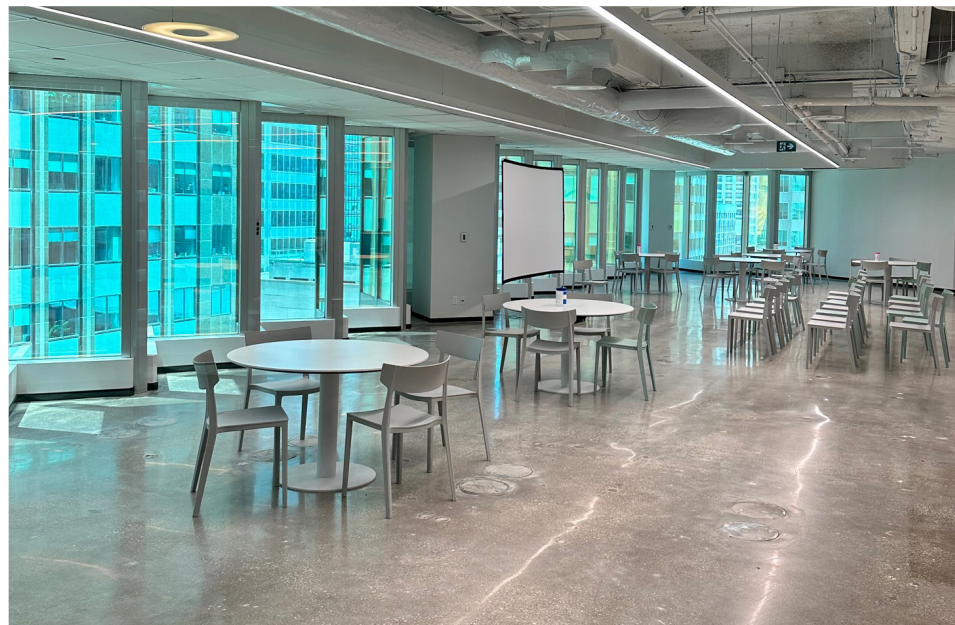

CONTACT

Steven Sotiroff*

Associate

647 580 5030

steven.sotiroff@cushwake.com

Derek Snyder*

Vice Chair

416 359 2459

derek.snyder@cushwake.com

CUSHMAN & WAKEFIELD

Cushman & Wakefield ULC, Brokerage

161 Bay Street, Suite 1500

Toronto, ON M5J 2S1

416 862 0611

Cushman & Wakefield ULC, Brokerage

No warranty or representation, expressed or implied, is made as to the accuracy of the information contained herein, and same is submitted subject to errors, omissions, change of price, rental or other conditions, withdrawal without notice, and to any specific listing condition, imposed by our principals. *Sales Representative