



## Carlow Corporate Center

Bolingbrook, Illinois



**CARLOW XXII - DELIVERING 3Q 2024**

# 221,100 SF AVAILABLE

975 Belle Lane, Bolingbrook, IL



For more information, please contact:

**JASON M. WEST, SIOR**

+1 847 518 3210

[jason.west@cushwake.com](mailto:jason.west@cushwake.com)

**SEAN M. HENRICK, SIOR**

+1 847 518 3215

[sean.henrick@cushwake.com](mailto:sean.henrick@cushwake.com)

**RYAN D. KLINK**

+1 847 518 3211

[ryan.klink@cushwake.com](mailto:ryan.klink@cushwake.com)

No warranty or representation, expressed or implied, is made as to the accuracy of the information contained herein, and same is submitted subject to error and omission.

# 221,100 SF AVAILABLE

975 Belle Lane, Bolingbrook, IL

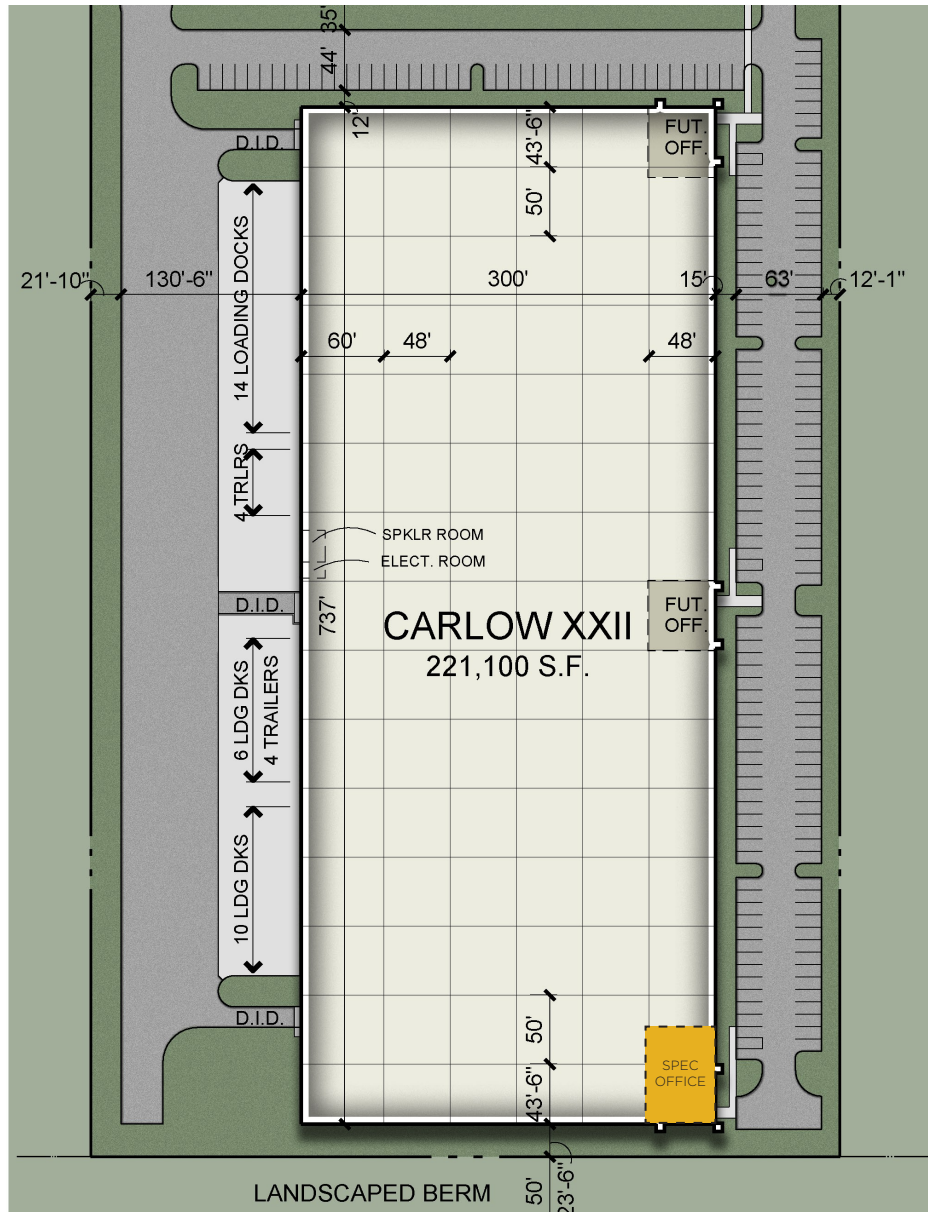

## PROPERTY OVERVIEW

- SPACE AVAILABLE : 221,100 SF
- EXISTING OFFICE SPACE: 2,540 SF
- FUTURE OFFICE SPACE: TO SUIT
- WAREHOUSE: 213,600 SF
- CLEAR HEIGHT: 36'
- EXTERIOR DOCKS: 30
- DRIVE-IN DOORS: 3
- ONSITE PARKING: 187
- TRAILER STALLS: 8
- ACRE SITE: 10.61

CARLOW XXII - DELIVERING 3Q 2024

221,100 SF AVAILABLE

975 Belle Lane, Bolingbrook, IL



# AVAILABLE SPACE

## SPEC OFFICE | 2,540 SF

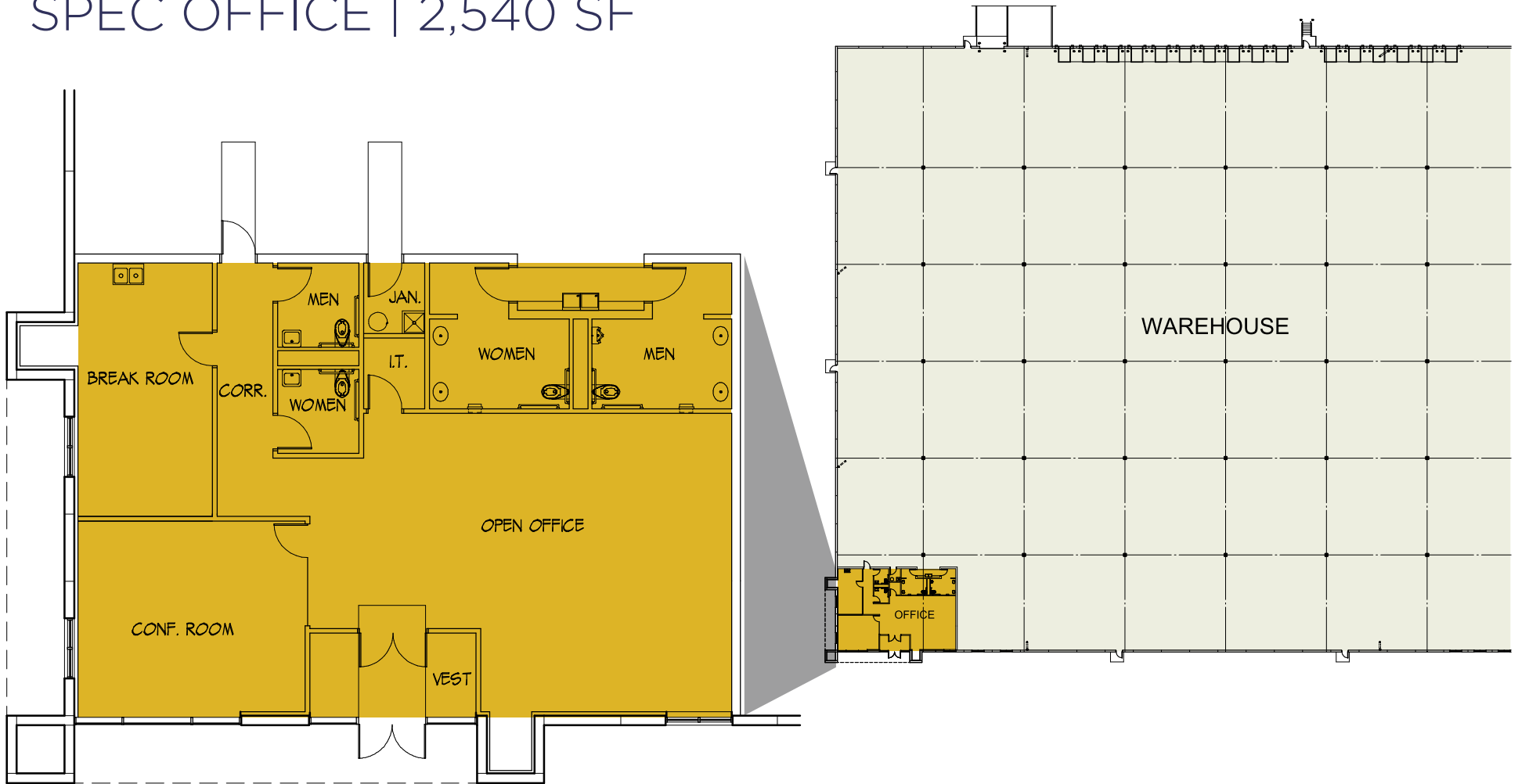

CARLOW XXII - DELIVERING 3Q 2024

221,100 SF AVAILABLE

975 Belle Lane, Bolingbrook, IL



## THE IDEAL INDUSTRIAL PARK SETTING

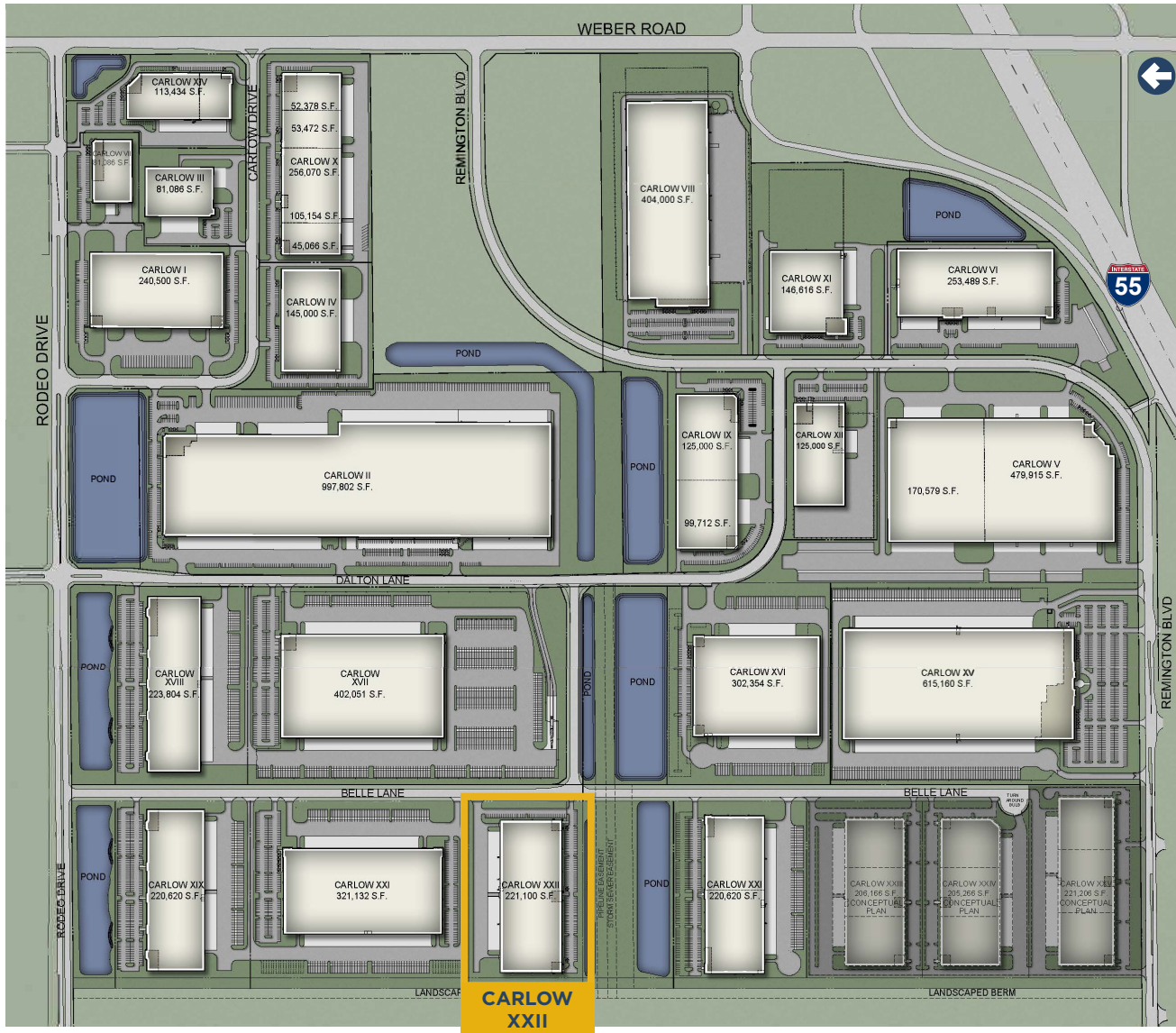

## SITE HIGHLIGHTS

- High Image Park & Building Features
- Strategically Located Between Intermodals & UPS Hub
- Access to Labor from Chicago & Joliet
- Immediate Access to Interstate 55
- Flexible Opportunities for Large & Mid-size Users
- Catering to a Variety of Tenant Needs & Uses
- Surrounded by Amenities including Hotels, Restaurants, Health Club & Gas Stations
- Proven Owner/Developer with 90+ Year History

No warranty or representation, expressed or implied, is made as to the accuracy of the information contained herein, and same is submitted subject to error and omission.

CARLOW XXII - DELIVERING 3Q 2024

# 221,100 SF AVAILABLE

975 Belle Lane, Bolingbrook, IL

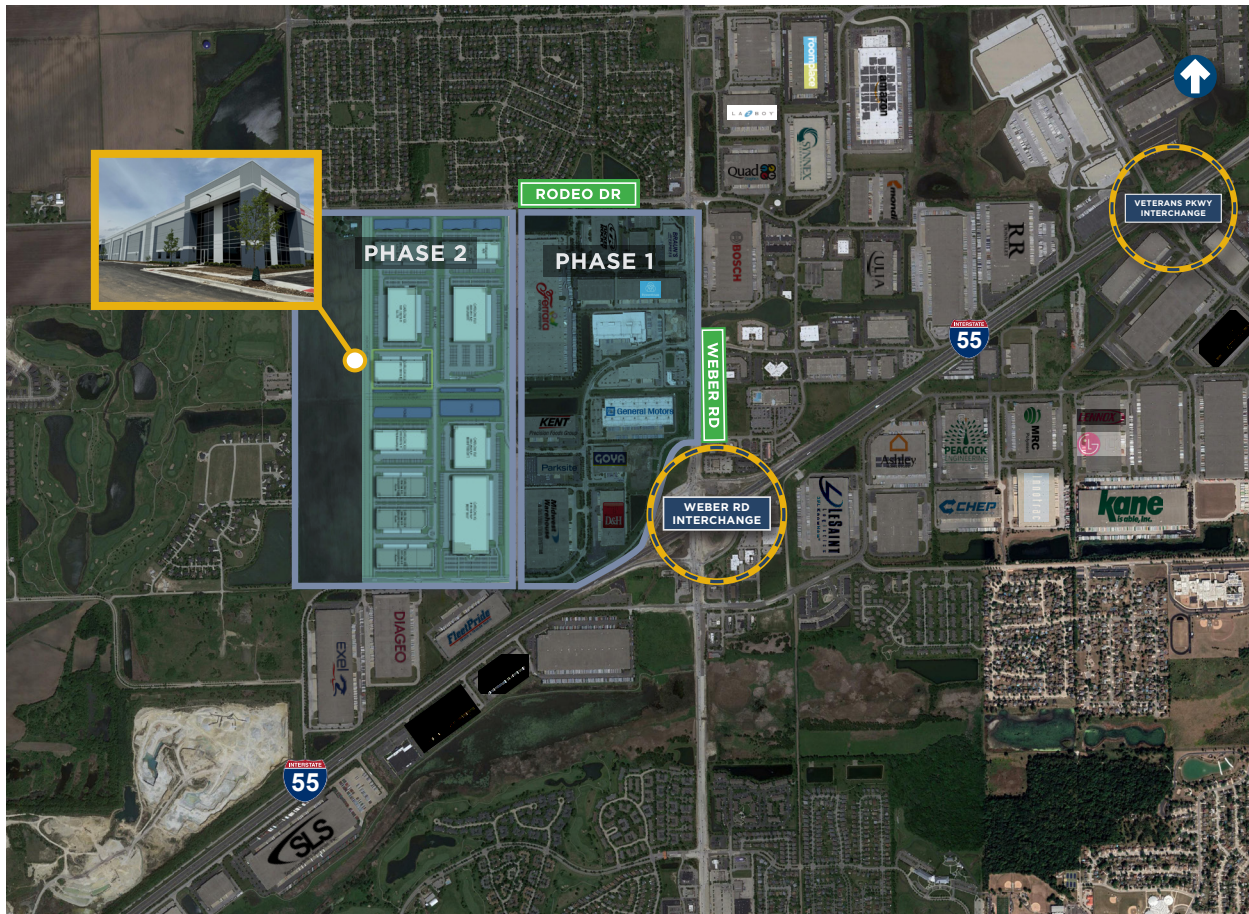

## PRIME LOCATION



CHILD CARE	RESTAURANTS
1 Creme de la Creme	1 Titled Kilt
	2 Cracker Barrel
	3 Wendy's
	4 Arby's
	5 Burger King
HOTELS	RETAIL
1 Extended Stay	1 7-Eleven
2 Comfort Inn	2 Shell Station
3 Country Inn Suites	3 Speedway Station
4 Days Inn	
RECREATION	
1 Lifetime Fitness	

Developed by Northern Builders, Inc., Carlow Corporate Center offers immediate accessibility to I-55 & I-355. Countless amenities including restaurants and shopping centers surround the immediate area.

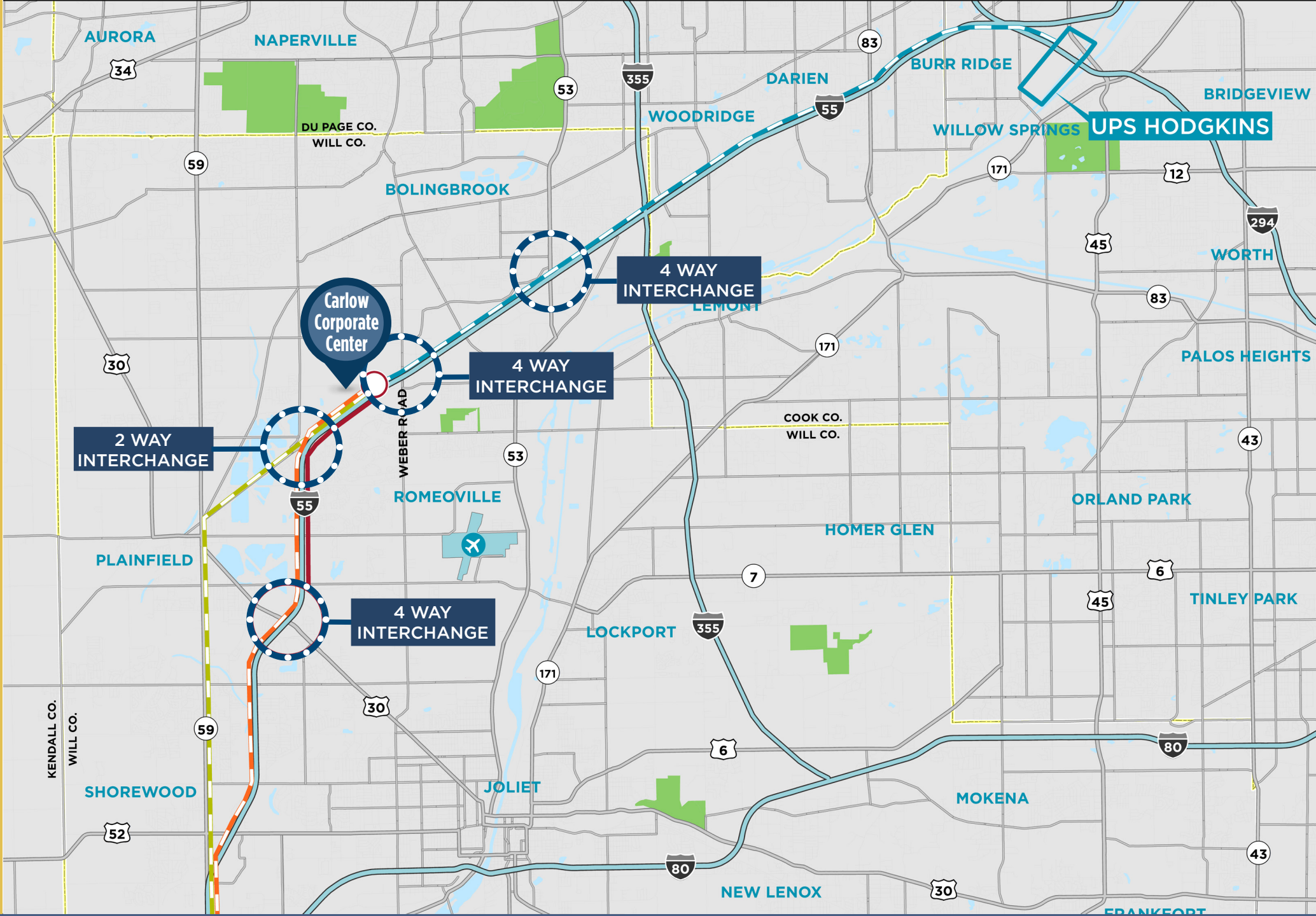

©2024 Cushman & Wakefield. All rights reserved. The information contained in this communication is strictly confidential. This information has been obtained from sources believed to be reliable but has not been verified. NO WARRANTY OR REPRESENTATION, EXPRESS OR IMPLIED, IS MADE AS TO THE CONDITION OF THE PROPERTY (OR PROPERTIES) REFERENCED HEREIN OR AS TO THE ACCURACY OR COMPLETENESS OF THE INFORMATION CONTAINED HEREIN, AND SAME IS SUBMITTED SUBJECT TO ERRORS, OMISSIONS, CHANGE OF PRICE, RENTAL OR OTHER CONDITIONS, WITHDRAWAL WITHOUT NOTICE, AND TO ANY SPECIAL LISTING CONDITIONS IMPOSED BY THE PROPERTY OWNER(S). ANY PROJECTIONS, OPINIONS OR ESTIMATES ARE SUBJECT TO UNCERTAINTY AND DO NOT SIGNIFY CURRENT OR FUTURE PROPERTY PERFORMANCE.