



# MIRAMAR COMMERCE CENTER



8902-8940 ACTIVITY ROAD, SAN DIEGO, CALIFORNIA 92126  
112,530 SQUARE FOOT MULTI-TENANT INDUSTRIAL CENTER



**RYAN DOWNING, SIOR**

858.546.5416

[ryan.downing@cushwake.com](mailto:ryan.downing@cushwake.com)

CA LIC. 01955032

**JACK TICE**

619.500.7626

[jack.tice@cushwake.com](mailto:jack.tice@cushwake.com)

CA LIC. 02161178

**BRANT ABERG, SIOR**

858.546.5464

[brant.aberg@cushwake.com](mailto:brant.aberg@cushwake.com)

CA LIC. 01773573



# MIRAMAR COMMERCE CENTER

## PROPERTY FEATURES

- High-image, five-building, 112,530 SF multi-tenant industrial park
- Located at the corner of Activity Road & Camino Ruiz with Easy access to I-15 via Miramar Road
- 16'-18' warehouse clear height
- Bay sizes from 900 SF and larger
- Concrete driveways
- IL-2-1 zoning
- 3:1000 parking ratio
- 1987/1997 construction

## CURRENT AVAILABILITY

SPACE	SIZE	RATE	COMMENTS
8920 Ste. L	908 SF	\$2.05 IG	(1) Office/reception and (1) restroom, balance warehouse with (1) grade level loading door.
8920 Ste. P	902 SF	\$2.05 IG	(1) Office/reception and (1) resroom, balance warehouse with (1) grade level loading door.
8940 Ste. K	6,911 SF	\$1.95 IG	Open office, (1) private office, (1) conference room, break room, (2) restrooms, production area, balance warehouse with (2) grade level loading doors.

## SITE PLAN

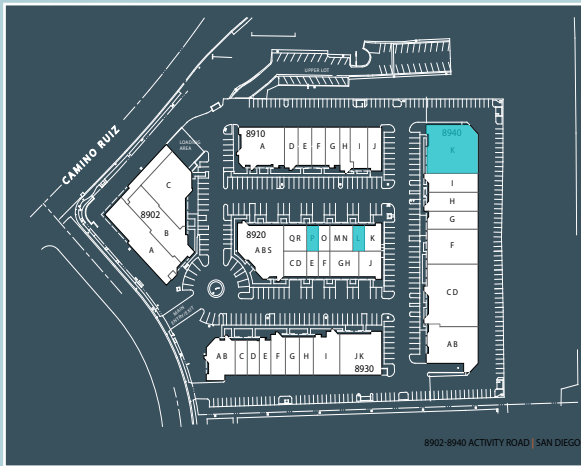

**RYAN DOWNING, SIOR**  
 858.546.5416  
 ryan.downing@cushwake.com  
 CA LIC. 01955032

**JACK TICE**  
 619.500.7626  
 jack.tice@cushwake.com  
 CA LIC. 02161178

**BRANT ABERG, SIOR**  
 858.546.5464  
 brant.aberg@cushwake.com  
 CA LIC. 01773573



# MIRAMAR COMMERCE CENTER

## SUITE SPECIFICATIONS:

- 8920 ACTIVITY RD, SUITE L
- 908 SF
- (1) OFFICE/RECEPTION (1) RESTROOM
- (1) GRADE LEVEL LOADING DOOR
- LEASE RATE: \$2.05 IG PSF/MONTH

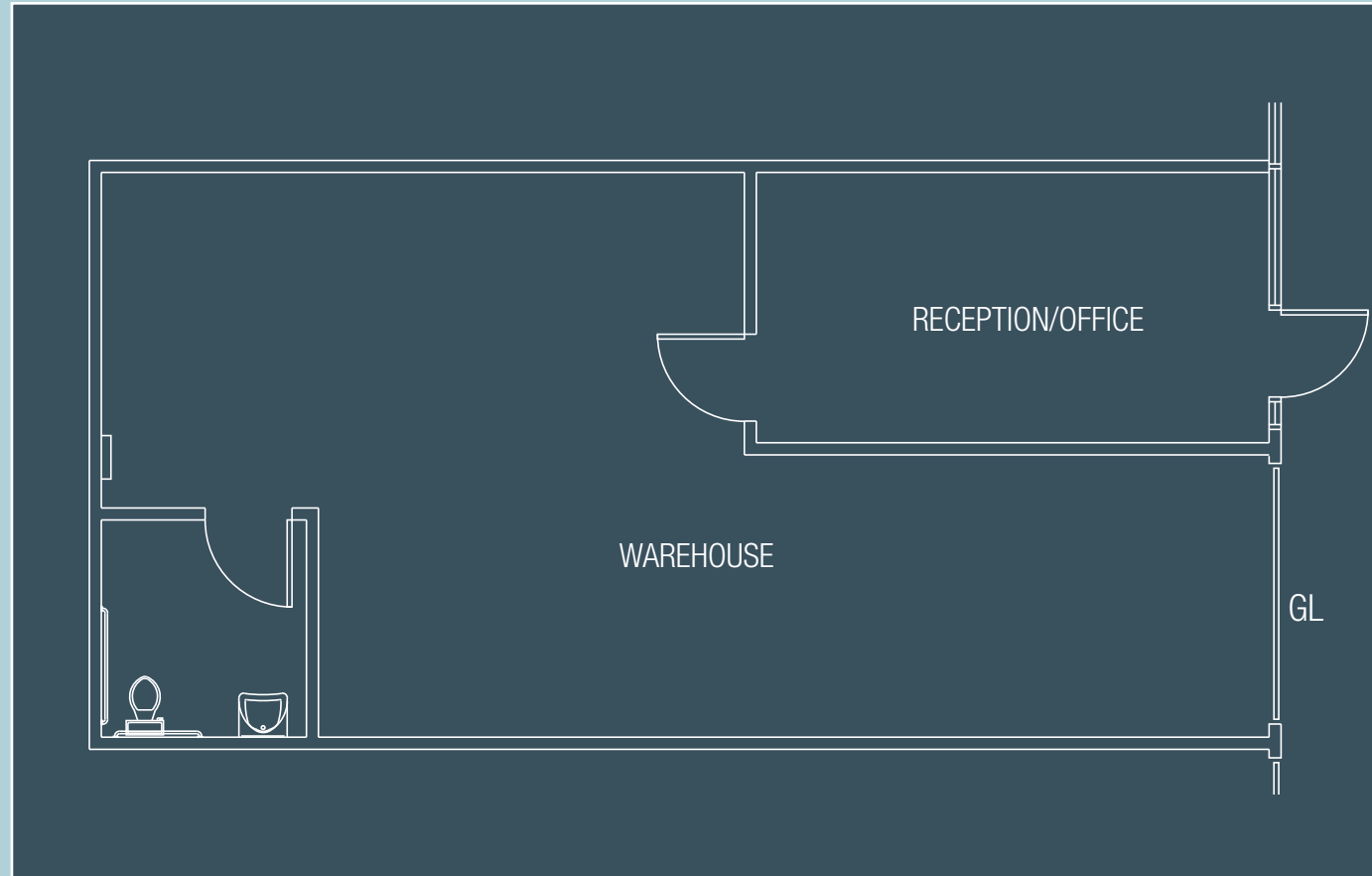



# MIRAMAR COMMERCE CENTER

## SUITE SPECIFICATIONS:

- 8920 ACTIVITY RD, SUITE P
- 902 SF
- (1) OFFICE/RECEPTION AREAS, (1) RESTROOM
- (1) GRADE LEVEL LOADING DOOR
- LEASE RATE: \$2.05 IG PSF/MONTH
- CAN BE COMBINED WITH SUITE P FOR A TOTAL OF 1,812 SF

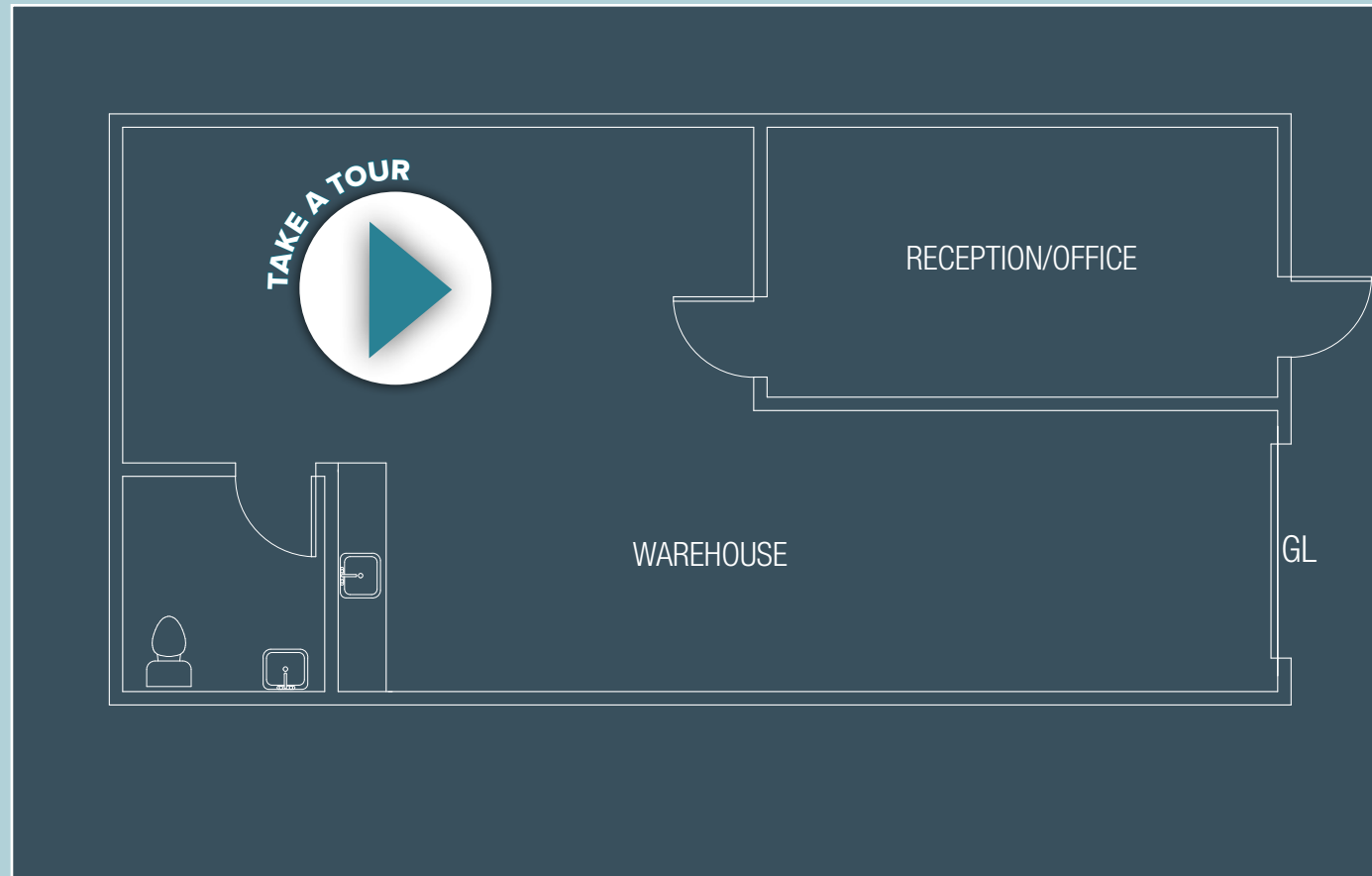
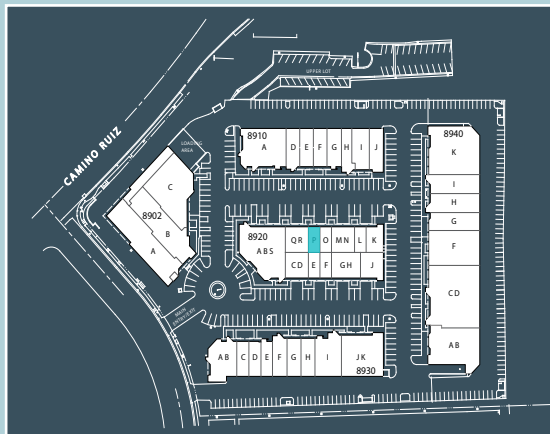



# MIRAMAR COMMERCE CENTER

**FREE RENT PROMO:**  
2 months free for a 3 year deal or 4 months free for a 5 year deal  
on qualified leases signed before 6/30/24

## SUITE SPECIFICATIONS:

- 8940 ACTIVITY RD, SUITE K
- 6,911 SF
- OPEN OFFICE, (1) PRIVATE OFFICE, PRODUCTION AREA, CONFERENCE ROOM, BREAK ROOM, (2) RESTROOMS, BALANCE WAREHOUSE
- (2) GRADE LEVEL LOADING DOORS
- LEASE RATE: \$1.95 IG PSF/MONTH

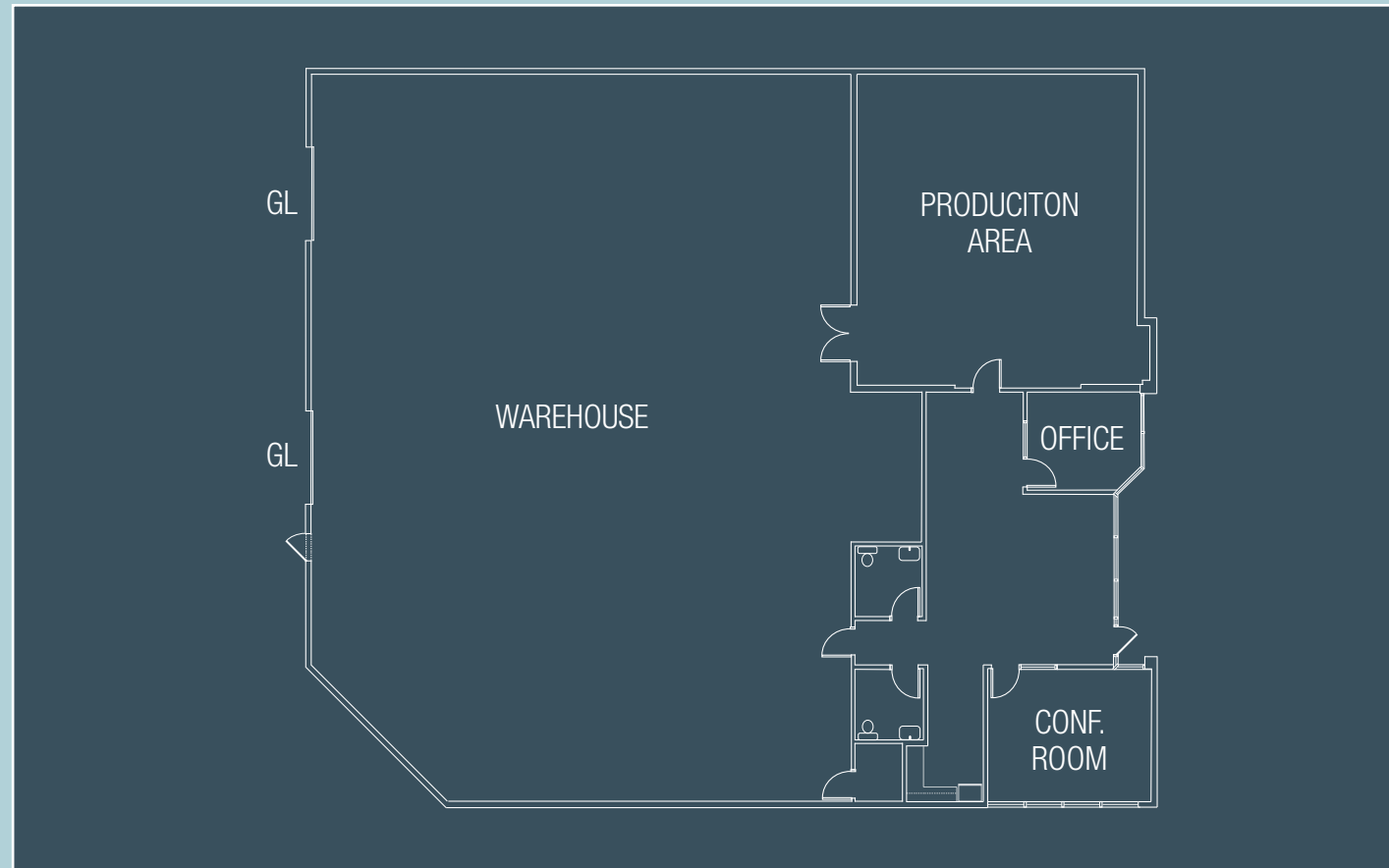
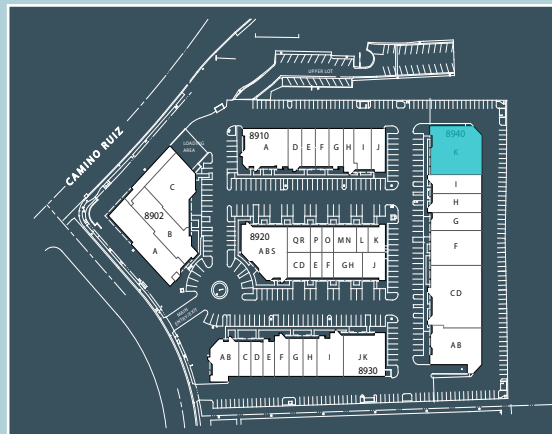



# MIRAMAR COMMERCE CENTER



©Cushman & Wakefield. All rights reserved. This information has been obtained from sources believed to be reliable but has not been verified. NO WARRANTY OR REPRESENTATION, EXPRESS OR IMPLIED, IS MADE AS TO THE CONDITION OF THE PROPERTY (OR PROPERTIES) REFERENCED HEREIN OR AS TO THE ACCURACY OR COMPLETENESS OF THE INFORMATION CONTAINED HEREIN, AND SAME IS SUBMITTED SUBJECT TO ERRORS, OMISSIONS, CHANGE OF PRICE, RENTAL OR OTHER CONDITIONS WITHDRAWAL WITHOUT NOTICE, AND TO ANY SPECIAL LISTING CONDITIONS IMPOSED BY THE PROPERTY OWNER(S).



**RYAN DOWNING, SIOR**

858.546.5416

[ryan.downing@cushwake.com](mailto:ryan.downing@cushwake.com)

CA LIC. 01955032

**JACK TICE**

619.500.7626

[jack.tice@cushwake.com](mailto:jack.tice@cushwake.com)

CA LIC. 02161178

**BRANT ABERG, SIOR**

858.546.5464

[brant.aberg@cushwake.com](mailto:brant.aberg@cushwake.com)

CA LIC. 01773573