



FOR SUBLEASE

7,197 - 21,322 SF
AVAILABLE

ONE KENNEDY SQUARE

777 WOODWARD AVE
DETROIT, MI 48226

BUILDING HIGHLIGHTS

- 7,197 - 21,322 SF Available
 - Suite 850: 7,197 SF
 - Suite 950: 14,125 SF
- Furniture negotiable
- Sublease term through 12/31/25
- \$17.50/SF full-service gross

EXPOSURE

Excellent visibility and access via Jefferson Ave, Woodward Ave, M-10, & I-75

ONSITE AMENITIES

Including Starbucks Coffee, Potbelly Sandwich Shop, and a Citizens Bank

LIVE, WORK, PLAY

Walkable to entertainment, food, high end retail shopping, upscale apartments, and more



LOCATION



777
Woodward
Ave

8TH FLOOR

7,197 RSF (PARTIAL FLOOR)

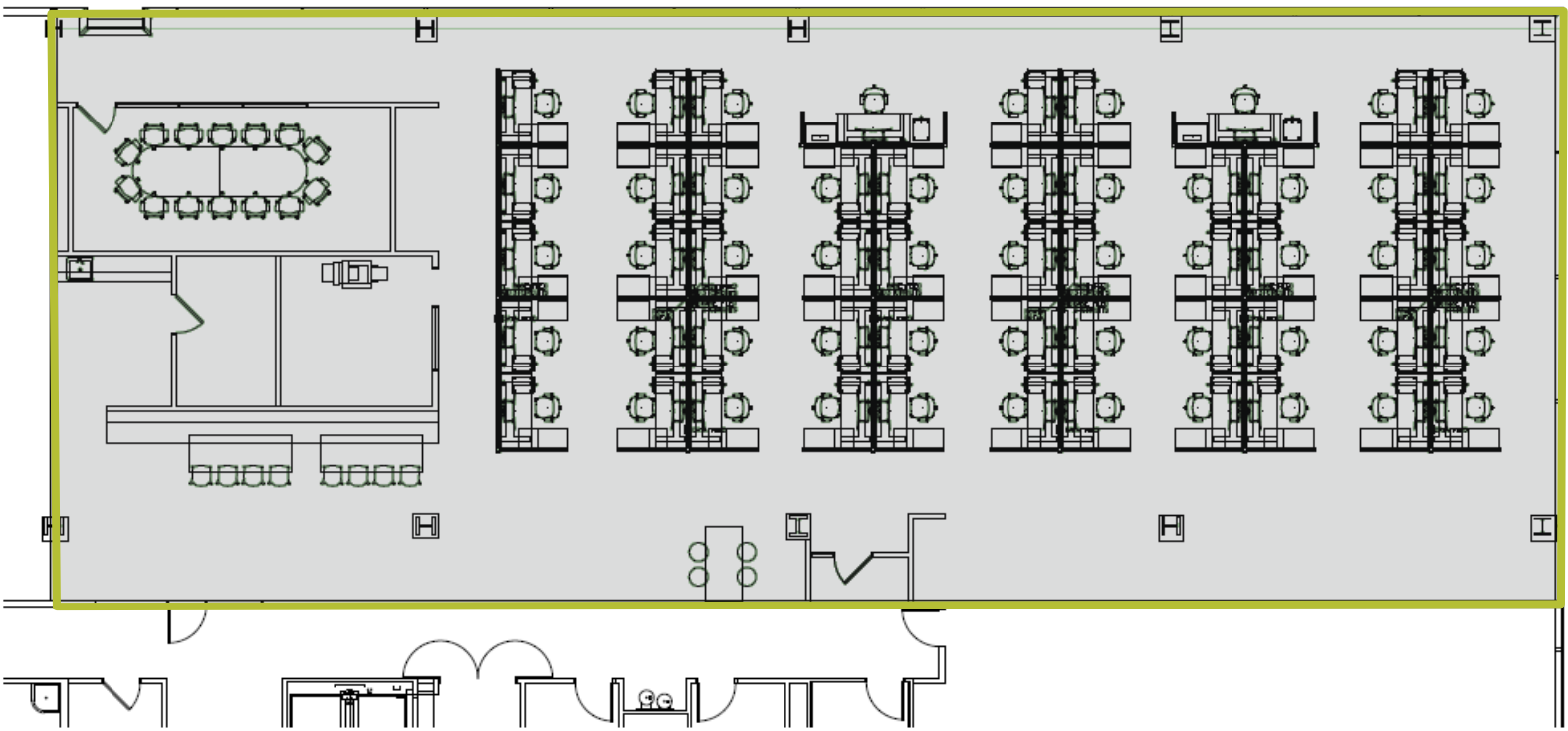

9TH FLOOR

14,125 RSF (PARTIAL FLOOR)

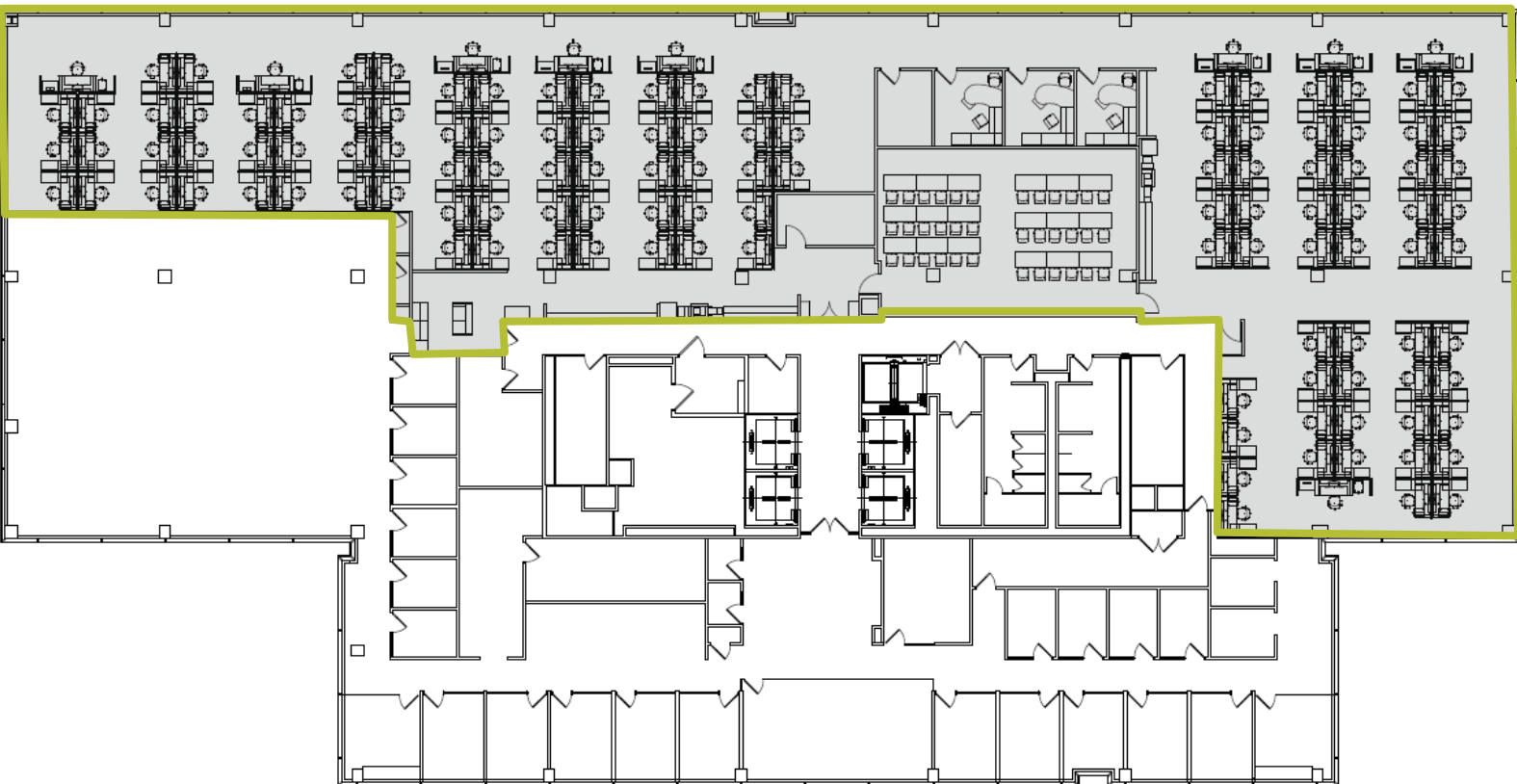



John VanNoord
Senior Associate
+1 248 358 6116
john.vannoord@cushwake.com

Garret Keais, SIOR
Executive Managing Director
+1 248 358 6112
garrett.keais@cushwake.com