



5 TERRITORIAL COURT
BOLINGBROOK, IL

27,265 SF AVAILABLE FOR LEASE
UNIT 2

54,531 SF Building size

*Will consider
short-term deals*

FOR MORE INFORMATION &
LEASING OPPORTUNITIES:

RYAN KLINK
Managing Director
+1 847 518 3211
ryan.klink@cushwake.com

JASON WEST, SIOR
Executive Vice Chair
+1 847 518 3210
jason.west@cushwake.com

SEAN HENRICK, SIOR
Vice Chair
+1 847 518 3215
sean.henrick@cushwake.com





5 TERRITORIAL COURT
BOLINGBROOK, IL

Unit 2

27,265 SF

TOTAL SPACE
AVAILABLE

+2,000 SF

EXISTING OFFICE
SPACE

Subject to Offer

LEASE RATE

24'

CLEAR HEIGHT

8

EXTERIOR DOCKS
(4 LEVELERS)

1

DRIVE-IN DOOR

400 Amps

POWER

27

CAR STALLS

FOR MORE INFORMATION &
LEASING OPPORTUNITIES:

RYAN KLINK
Managing Director

+1 847 518 3211
ryan.klink@cushwake.com

JASON WEST, SIOR
Executive Vice Chair

+1 847 518 3210
jason.west@cushwake.com

SEAN HENRICK, SIOR
Vice Chair

+1 847 518 3215
sean.henrick@cushwake.com





SITE PLAN

5 TERRITORIAL CT • BOLINGBROOK, IL

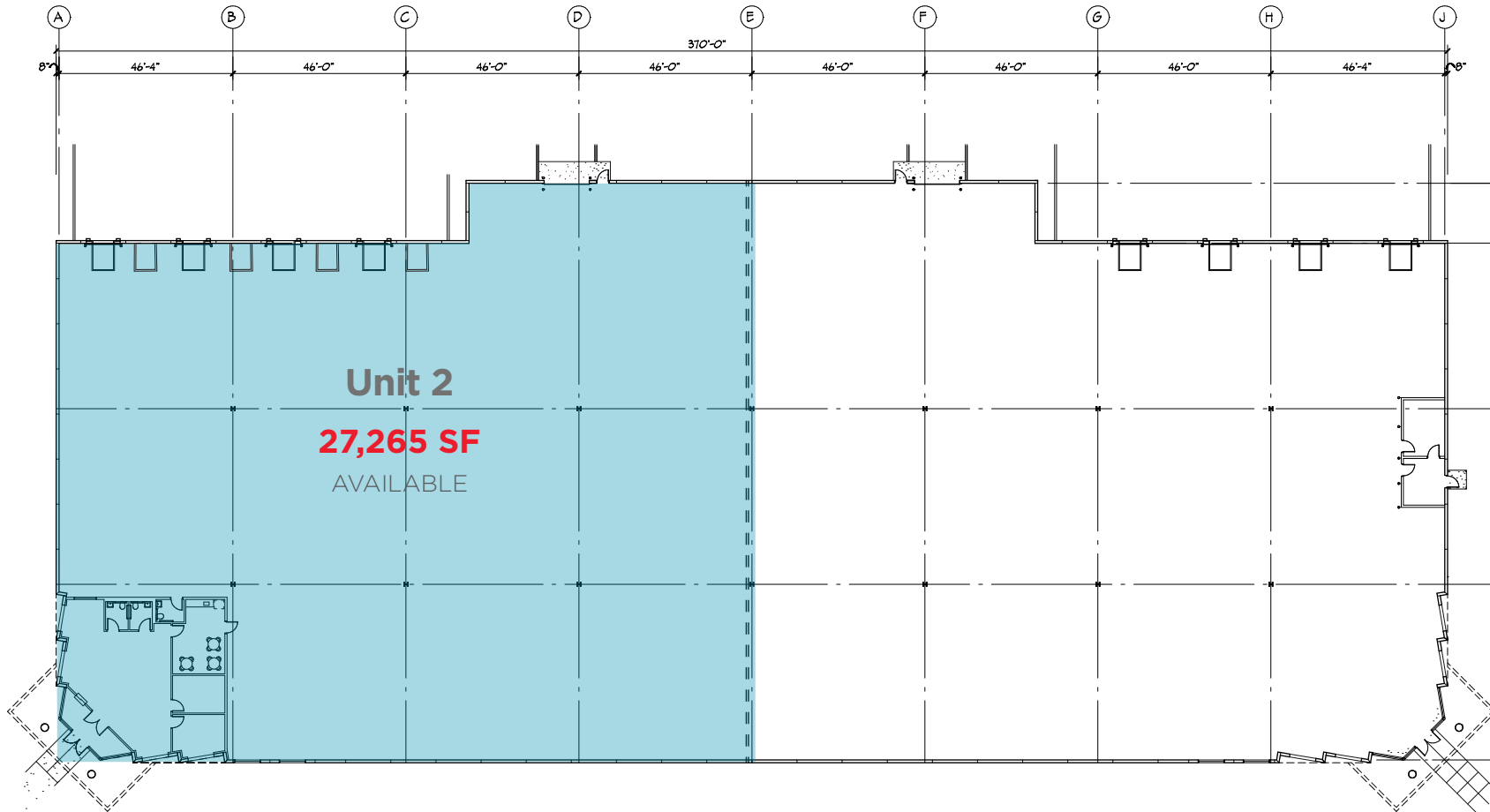

©2023 Cushman & Wakefield. All rights reserved. The information contained in this communication is strictly confidential. This information has been obtained from sources believed to be reliable but has not been verified. NO WARRANTY OR REPRESENTATION, EXPRESS OR IMPLIED, IS MADE AS TO THE CONDITION OF THE PROPERTY (OR PROPERTIES) REFERENCED HEREIN OR AS TO THE ACCURACY OR COMPLETENESS OF THE INFORMATION CONTAINED HEREIN, AND SAME IS SUBMITTED SUBJECT TO ERRORS, OMISSIONS, CHANGE OF PRICE, RENTAL OR OTHER CONDITIONS, WITHDRAWAL WITHOUT NOTICE, AND TO ANY SPECIAL LISTING CONDITIONS IMPOSED BY THE PROPERTY OWNER(S). ANY PROJECTIONS, OPINIONS OR ESTIMATES ARE SUBJECT TO UNCERTAINTY AND DO NOT SIGNIFY CURRENT OR FUTURE PROPERTY PERFORMANCE.

FOR MORE INFORMATION &
LEASING OPPORTUNITIES:

RYAN KLINK
Managing Director

+1 847 518 3211
ryan.klink@cushwake.com

JASON WEST, SIOR
Executive Vice Chair

+1 847 518 3210
jason.west@cushwake.com

SEAN HENRICK, SIOR
Vice Chair

+1 847 518 3215
sean.henrick@cushwake.com



MAP AERIAL

5 TERRITORIAL CT • BOLINGBROOK, IL

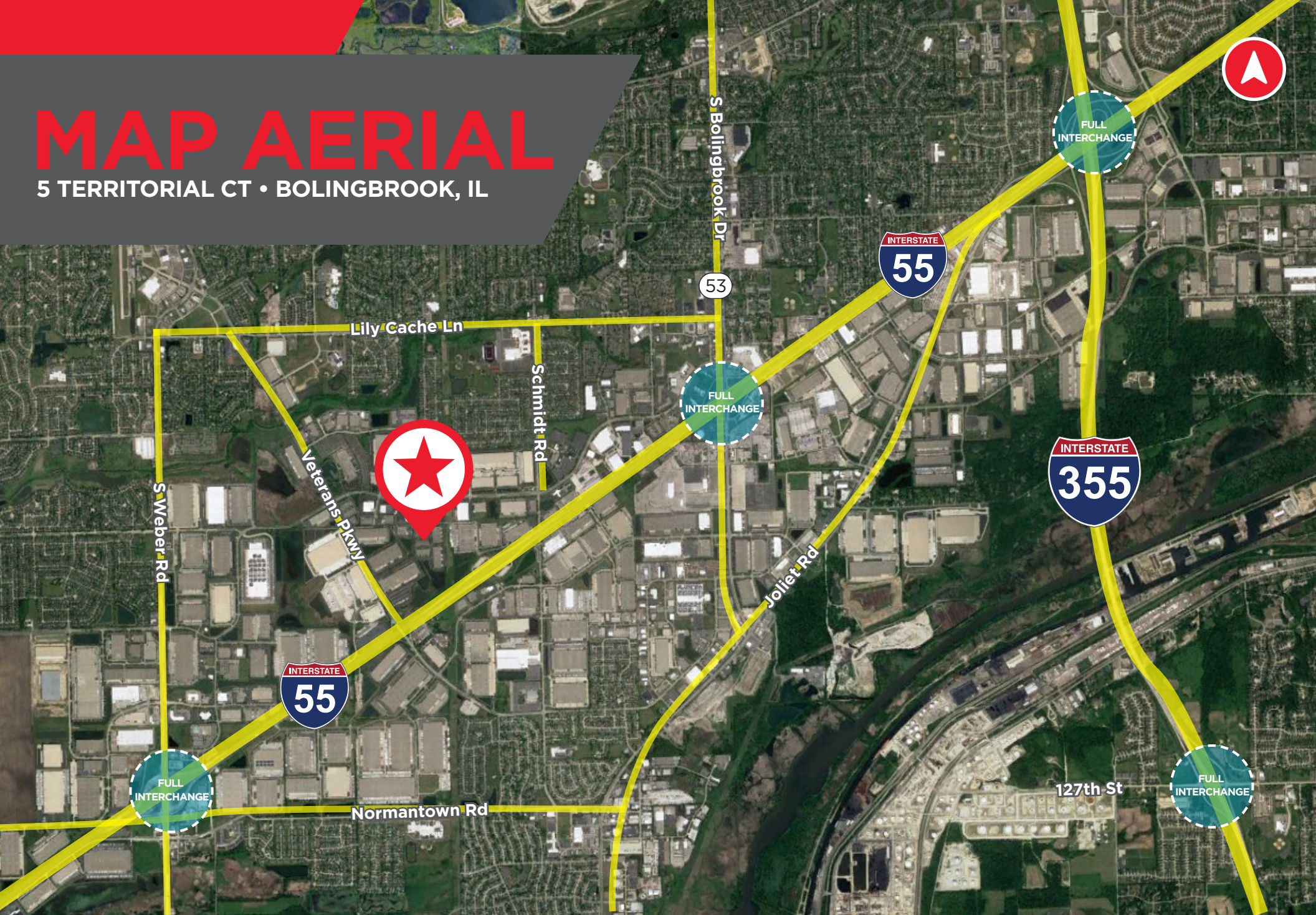

FOR MORE INFORMATION &
LEASING OPPORTUNITIES:

RYAN KLINK
Managing Director

+1 847 518 3211
ryan.klink@cushwake.com

JASON WEST, SIOR
Executive Vice Chair

+1 847 518 3210
jason.west@cushwake.com

SEAN HENRICK, SIOR
Vice Chair

+1 847 518 3215
sean.henrick@cushwake.com

