

HOMESTEAD PAVILION | PAD-GL/BTS/SALE
SEC 6000 S. SR 108 (3500 W)
Clinton/Roy, Utah



PROPERTY HIGHLIGHTS

VASA – NOW OPEN

- PAD Available Sale/GL/BTS – call agents for pricing
- Excellent opportunity for owner/user development
- High growth area

Contact

TOM COOK

Senior Director
+1 801 303 5488

tom.cook@cushwake.com

HOMESTEAD PAVILION | PADS-GL/BTS/SALE

SEC 6000 S. SR 108 (3500 W)

Clinton/Roy, Utah

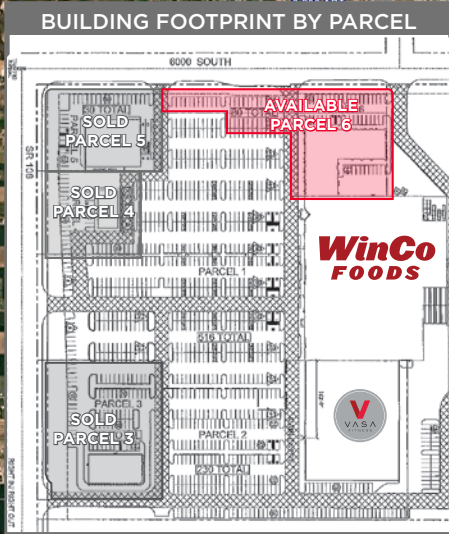

BUILDING FOOTPRINT BY PARCEL

| | Acres | Building Footprint | Status |
|----------|---------|--------------------|-----------|
| PARCEL 3 | 1.65 AC | 7,000 SF | Sold |
| PARCEL 4 | 0.79 AC | 3,400 SF | Sold |
| PARCEL 5 | 1.02 AC | 11,705 SF | Sold |
| PARCEL 6 | 1.59 AC | 16,100 SF | Available |

2021 DEMOGRAPHICS

| | 1 Mile | 3 Mile | 5 Mile |
|--------------------|----------|----------|----------|
| Daytime Population | 11,578 | 78,835 | 149,171 |
| Population | 13,763 | 93,329 | 164,160 |
| Med. HH Income | \$81,945 | \$77,721 | \$76,822 |
| AVG. HH Income | \$91,416 | \$88,881 | \$88,178 |

Contact

TOM COOK

Senior Director

+1 801 303 5488

tom.cook@cushwake.com

170 South Main, Suite 1600

Salt Lake City, UT 84101

Main +1 801 322 2000

cushmanwakefield.com

©2021 Cushman & Wakefield. All rights reserved. The information contained in this communication is strictly confidential. This information has been obtained from sources believed to be reliable but has not been verified. No warranty or representation, express or implied, is made as to the condition of the property (or properties) referenced herein or as to the accuracy or completeness of the information contained herein, and same is submitted subject to errors, omissions, change of price, rental or other conditions, withdrawal without notice, and to any special listing conditions imposed by the property owner(s). Any projections, opinions or estimates are subject to uncertainty and do not signify current or future property performance. G:\Shared\Apps\Gigas\1 - Projects\Cook, T\1 - Flyers\6000s_SR-108_HomesteadPavilion