

2081

ARENA BLVD
SACRAMENTO, CALIFORNIA

±3,036 RSF AVAILABLE

PROPERTY HIGHLIGHTS

SUITE 150

3,036 RSF

- 24,000 SF 2-story Class A office building built in 2007
- Mixed use development with on-site restaurants and shopping
- Easy ingress and egress with immediate access to Interstate 5 and Interstate 80
- Close proximity to Downtown Sacramento, State Capitol and Sacramento International Airport

CONTACT INFORMATION

CHRIS SCHWARZE

EXECUTIVE DIRECTOR

916.288.4803

chris.schwarze@cushwake.com

CA License #01291261

CHAD COOK, MCR, SIOR, CCIM

SENIOR DIRECTOR

916.329.1562

chad.cook@cushwake.com

CA License #01711687

KEVIN PARTINGTON

EXECUTIVE DIRECTOR

916.288.4807

kevin.partington@cushwake.com

CA License #01199010

CUSHMAN & WAKEFIELD INC.

400 Capitol Mall, Suite 1800,

Sacramento, CA 95814

916.288.4800

LIC. #0061633

2081

ARENA BLVD
SACRAMENTO, CALIFORNIA

1ST FLOOR

2ND FLOOR

FLOOR PLANS 1st FLOOR

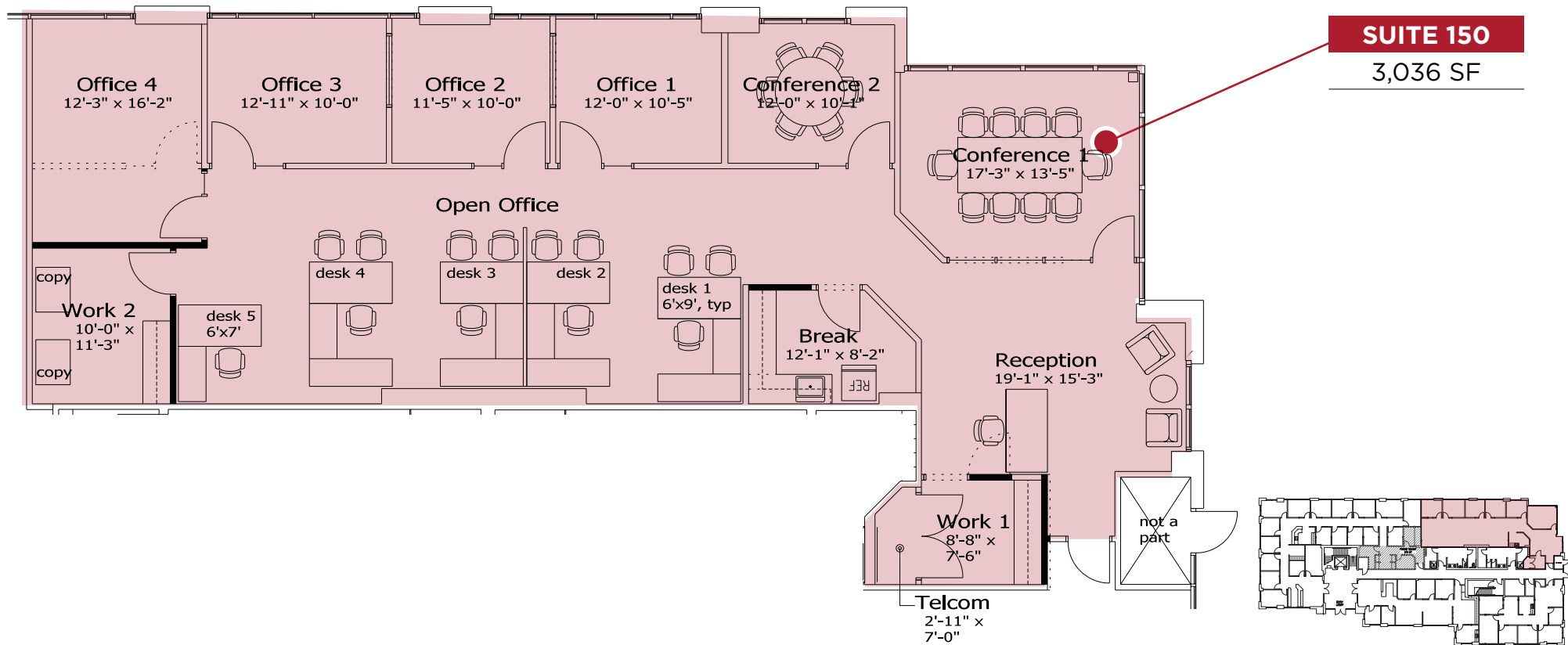

CONTACT INFORMATION

CHRIS SCHWARZE
EXECUTIVE DIRECTOR
916.288.4803
chris.schwarze@cushwake.com
CA License #01291261

CHAD COOK, MCR, SIOR, CCIM
SENIOR DIRECTOR
916.329.1562
chad.cook@cushwake.com
CA License #01711687

KEVIN PARTINGTON
EXECUTIVE DIRECTOR
916.288.4807
kevin.partington@cushwake.com
CA License #01199010

CUSHMAN & WAKEFIELD INC.
400 Capitol Mall, Suite 1800,
Sacramento, CA 95814
916.288.4800
LIC. #0061633

2081

**ARENA BLVD
SACRAMENTO, CALIFORNIA**

GALLERY



CONTACT INFORMATION

CHRIS SCHWARZE
EXECUTIVE DIRECTOR

916.288.4803
chris.schwarze@cushwake.com
CA License #01291261

CHAD COOK, MCR, SIOR, CCIM
SENIOR DIRECTOR

916.329.1562
chad.cook@cushwake.com
CA License #01711687

KEVIN PARTINGTON
EXECUTIVE DIRECTOR

916.288.4807
kevin.partington@cushwake.com
CA License #01199010

CUSHMAN & WAKEFIELD INC.
400 Capitol Mall, Suite 1800,
Sacramento, CA 95814
916.288.4800
LIC. #0061633

2081

ARENA BLVD SACRAMENTO, CALIFORNIA

• HEALTH & WELLNESS •

- 1) Fitness Evolution
- 2) Anytime Fitness
- 3) CA Family Fitness
- 4) Curves
- 5) Bikram Yoga Natomas
- 6) Orangetheory Fitness

• PARKS •

- 1) North Natomas Regional Park
- 2) Kokomo Park
- 3) Quail Park
- 4) Linden Park
- 5) Sundance Park
- 6) Witter Ranch Park
- 7) Tanzanite Park

• FOOD •

- 1) Peet's Coffee & tea
- 2) Jack's Urban Eats
- 3) Jamba Juice
- 4) Freebirds World Burrito
- 5) Corner Bakery Cafe
- 6) Curry Corner
- 7) Bella Bru Cafe
- 8) Tuk Tuk Thai Cuisine
- 9) Panera Bread
- 10) Pete's Restaurant and Brewhouse
- 11) Tapioca Express
- 12) Beach Hut Deli
- 13) Buffalo Wild Wings

• HOTELS •

- 1) Homewood Suites by Hilton
- 2) Hampton Inn & Suites
- 3) Holiday Inn Express & Suites
- 4) Extended Stay America

• BANKS •

- 1) Wells Fargo
- 2) Tri Counties Bank
- 3) Bank of America
- 4) Safe Credit Union
- 5) Chase

• GAS STATIONS •

- 1) Shell
- 2) Chevron
- 3) Safeway

• SCHOOLS •

- 1) Inderkum High School
- 2) American River College Natomas Center
- 3) Natomas School of Music



• OTHER •

- 1) Raleys
- 2) Safeway
- 3) Natomas Veterinary Hospital
- 4) Cost Plus World Market
- 5) BevMo
- 6) Best Buy
- 7) Target
- 8) FedEx

POINTS OF INTEREST

DOWNTOWN SACRAMENTO • GOLDEN 1 CENTER • RAILYARDS • RALEY FIELD • SLEEP TRAIN ARENA • SAC INTERNATIONAL AIRPORT • SPINE BIKE TRAIL • DISCOVERY PARK • OLD TOWN SACRAMENTO

CONTACT INFORMATION

CHRIS SCHWARZE

EXECUTIVE DIRECTOR

916.288.4803

chris.schwarze@cushwake.com

CA License #01291261

CHAD COOK, MCR, SIOR, CCIM

SENIOR DIRECTOR

916.329.1562

chad.cook@cushwake.com

CA License #01711687

KEVIN PARTINGTON

EXECUTIVE DIRECTOR

916.288.4807

kevin.partington@cushwake.com

CA License #01199010

CUSHMAN & WAKEFIELD INC.

400 Capitol Mall, Suite 1800,

Sacramento, CA 95814

916.288.4800

LIC. #0061633