







FOR LEASE

19002-20026 87th Ave S
Kent, WA 98031

Building F



Property Features

-  Over 1.7 MSF with flexible configurations
-  Strategically located with direct access to WA-167 (1 mile), I-5 (3 miles), and I-405 (4 miles)
-  Superior dock-high and grade-level heavy loading
-  Located in Kent Valley Submarket
-  24' Clear Height
-  M2 Zoning (City of Kent)
-  Rail Served by Burlington Northern



Owned By

mapletree

Leasing By

CUSHMAN & WAKEFIELD

Scott Alan, SIOR
Executive Director
+1 206 521 0236
scott.alan@cushwake.com

Patrick Mullin
Managing Director
+1 206 521 0265
patrick.mullin@cushwake.com

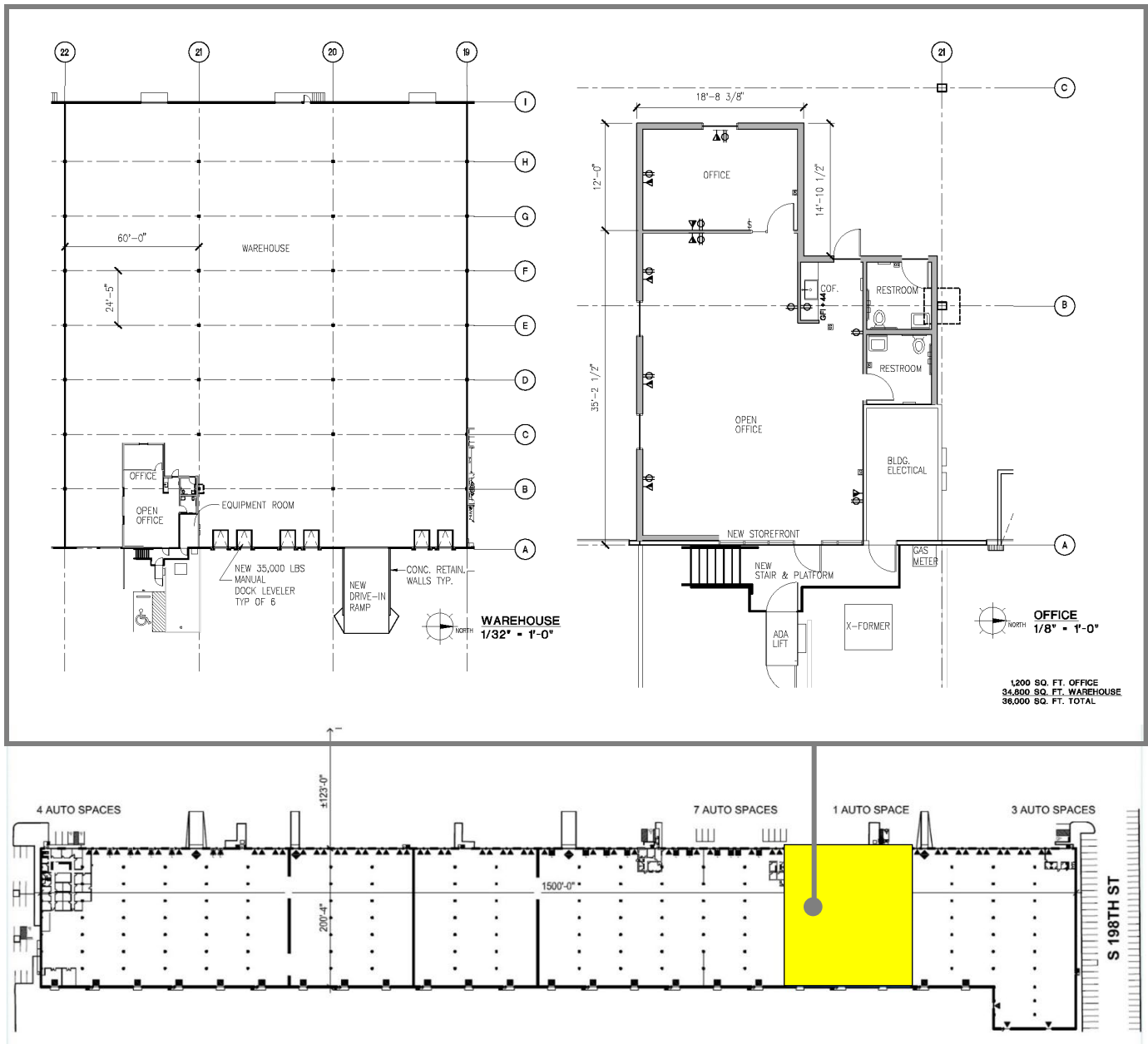

Property Specifications

- » Space Available: 36,000 SF
- » Office Space: 1,199 SF
- » Dock High Doors: 8 dock high (9'.8" x 10')
- » Grade Level Doors: 1 grade level (9'.8" x 10')
- » Column Spacing: 60' x 25'
- » Clear Height: 24'
- » Power: 425 amps 277/480 volts
- » Lighting: T-5 Motion Sensor
- » Configuration: The property supports both heavy logistics and manufacturing users in order to accommodate a variety of business needs.

Owned By

mapleiree

Leasing By

 CUSHMAN & WAKEFIELD

Scott Alan, SIOR
Executive Director
+1 206 521 0236
scott.alan@cushwake.com

Patrick Mullin
Managing Director
+1 206 521 0265
patrick.mullin@cushwake.com

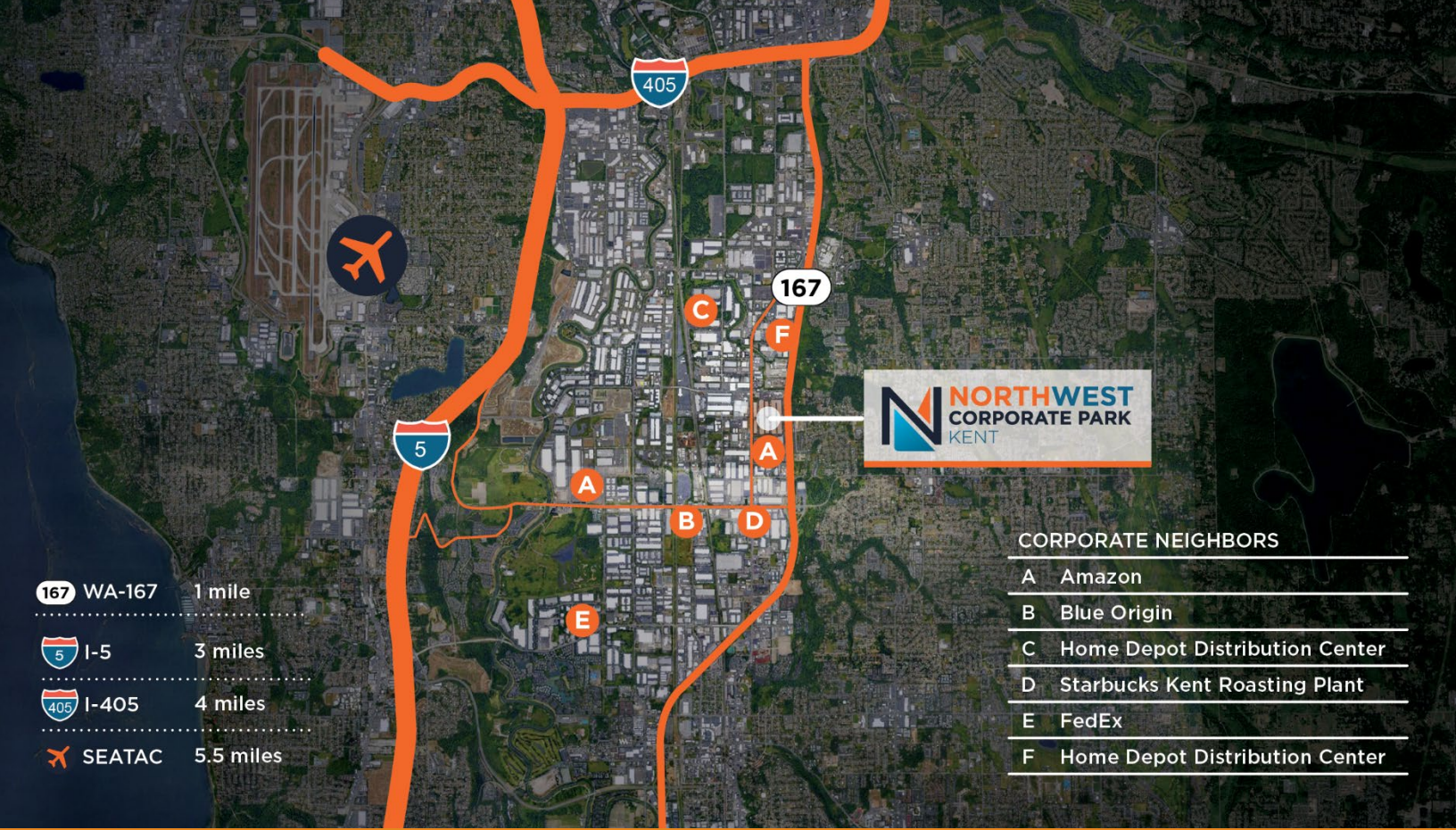

-  167 WA-167 1 mile

-  I-5 3 miles

-  I-405 4 miles

-  SEATAC 5.5 miles

CORPORATE NEIGHBORS	
A	Amazon
B	Blue Origin
C	Home Depot Distribution Center
D	Starbucks Kent Roasting Plant
E	FedEx
F	Home Depot Distribution Center



Owned By
mapleiree

Leasing By
 **CUSHMAN & WAKEFIELD**

Scott Alan, SIOR
 Executive Director
 +1 206 521 0236
 scott.alan@cushwake.com

Patrick Mullin
 Managing Director
 +1 206 521 0265
 patrick.mullin@cushwake.com

©2021 Cushman & Wakefield. All rights reserved. The information contained in this communication is strictly confidential. This information has been obtained from sources believed to be reliable but has not been verified. NO WARRANTY OR REPRESENTATION, EXPRESS OR IMPLIED, IS MADE AS TO THE CONDITION OF THE PROPERTY (OR PROPERTIES) REFERENCED HEREIN OR AS TO THE ACCURACY OR COMPLETENESS OF THE INFORMATION CONTAINED HEREIN, AND SAME IS SUBMITTED SUBJECT TO ERRORS, OMISSIONS, CHANGE OF PRICE, RENTAL OR OTHER CONDITIONS, WITHDRAWAL WITHOUT NOTICE, AND TO ANY SPECIAL LISTING CONDITIONS IMPOSED BY THE PROPERTY OWNER(S). ANY PROJECTIONS, OPINIONS OR ESTIMATES ARE SUBJECT TO UNCERTAINTY AND DO NOT SIGNIFY CURRENT OR FUTURE PROPERTY PERFORMANCE.