

# 311,608 SF

Industrial Space For Lease



## Prologis Woodridge



1433 Internationale Parkway  
Woodridge, IL 60517

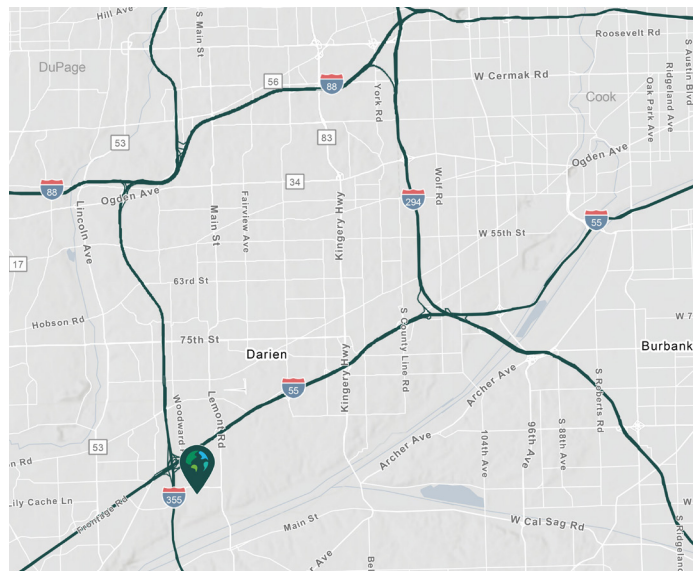

### LOCATION

- Located in prestigious Internationale Centre Business Park
- Easy access to I-55 & I-355

### FACILITY

- 311,608 sf available
- 35,887 sf of office
- 33,658 sf of mezzanine office
- 3,136 sf of warehouse office
- 31' clear height
- 20 dock doors, 2 drive-in-doors
- 425 car stalls
- Motion censored LED lighting
- 2,800A 277/480V
- ESFR sprinkler system
- 53' x 50' typical column spacing with 49'8" speed bays

### ADVANTAGES AND AMENITIES

- Low DuPage County taxes
- Centrally located with efficient access to metropolitan Chicago, Wisconsin and Indiana

**Prologis Essentials: your single-source service for efficient move-in and operations at [prologisessentials.com](http://prologisessentials.com)**

[www.prologis.com](http://www.prologis.com)

# 311,608 SF

Industrial Space For Lease



## Prologis Woodridge

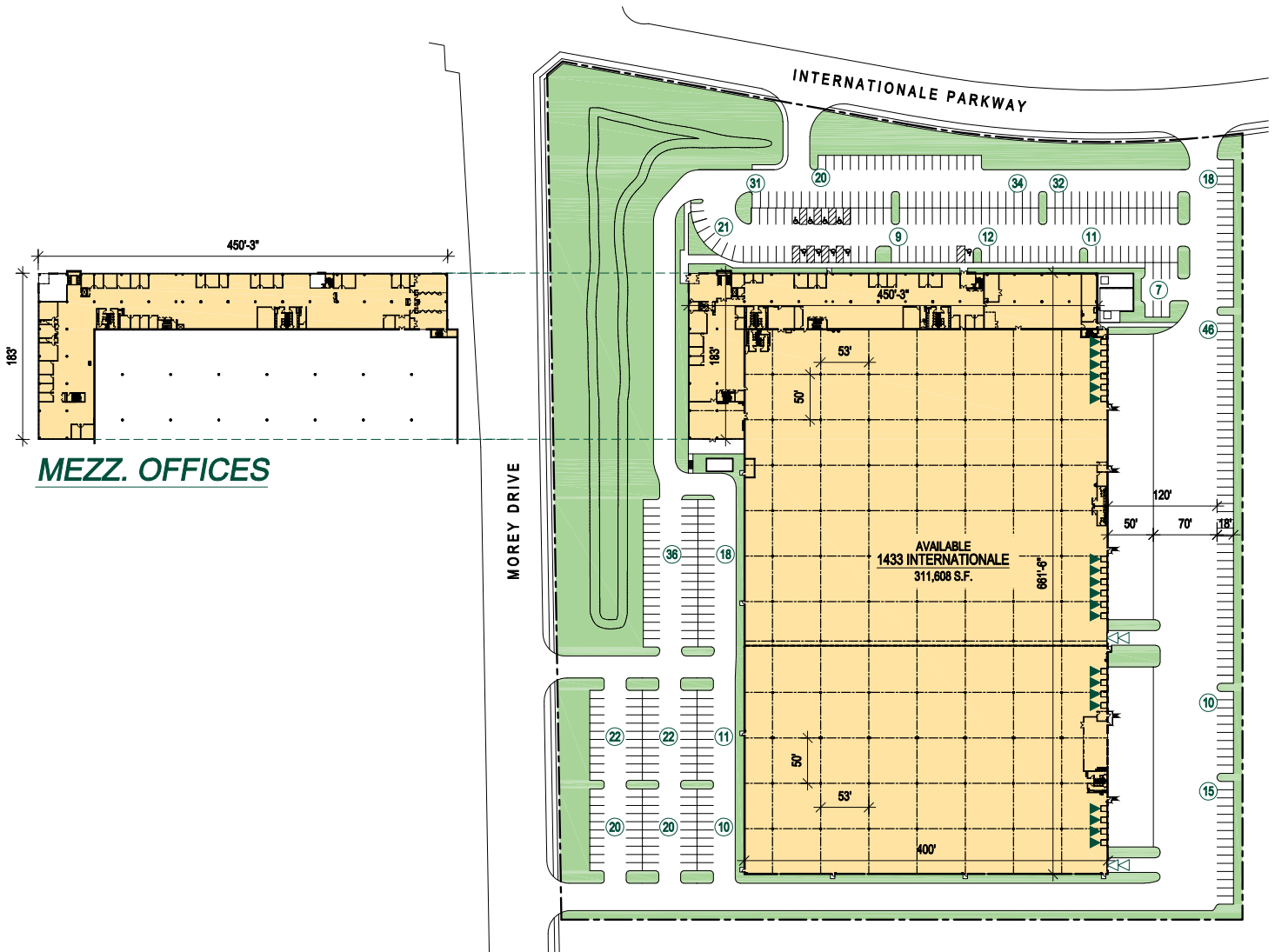

**Cushman & Wakefield**  
Jason West, SIOR  
jason.west@cushwake.com  
ph +1 847 518 3210  
cell +1 630 363 4395  
9500 W. Bryn Mawr  
Suite 600  
Rosemont, IL 60018 USA

**Cushman & Wakefield**  
Sean Henrick, SIOR, CCIM  
sean.henrick@cushwake.com  
ph +1 847 518 3215  
cell +1 847 571 2080  
9500 W. Bryn Mawr  
Suite 600  
Rosemont, IL 60018 USA

**Cushman & Wakefield**  
Ryan Klink  
ryan.klink@cushwake.com  
ph +1 847 518 3211  
cell +1 815 997 2144  
9500 W. Bryn Mawr  
Suite 600  
Rosemont, IL 60018 USA

**Prologis**  
Trevor Jeske  
tjeske@prologis.com  
ph +1 847 292 3866  
cell +1 248 212 9014  
6250 N. River Road  
Suite 1100  
Rosemont, IL 60018 USA