



12,067 SF AVAILABLE FOR LEASE

2540 WEST FLOURNOY STREET

Chicago, IL

PROPERTY OVERVIEW

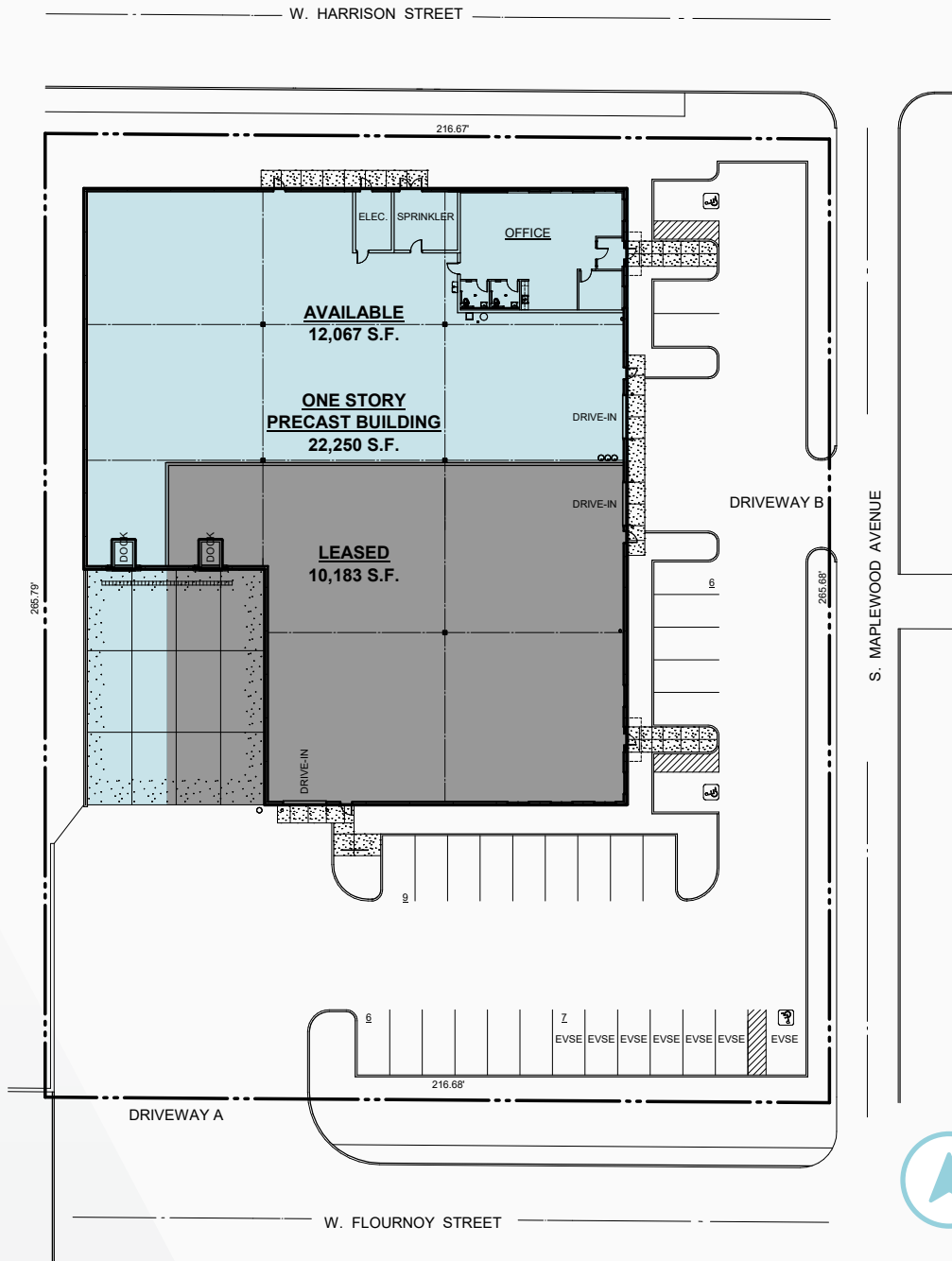

Property Features

- Total Building Size: 22,250 SF
- Available Unit Size: 12,067 SF
- Spec Office: 1,572 SF
- Year Built: 2023
- Clear Height: 24'
- Exterior Dock (9'x10'): 1
- Drive-in Door (12'x14'): 1
- Car Parking: 16 stalls
- Lighting: LED
- Lease Rate: Subject to Offer

2540

West Flourney Street

Chicago, IL



AERIAL MAP

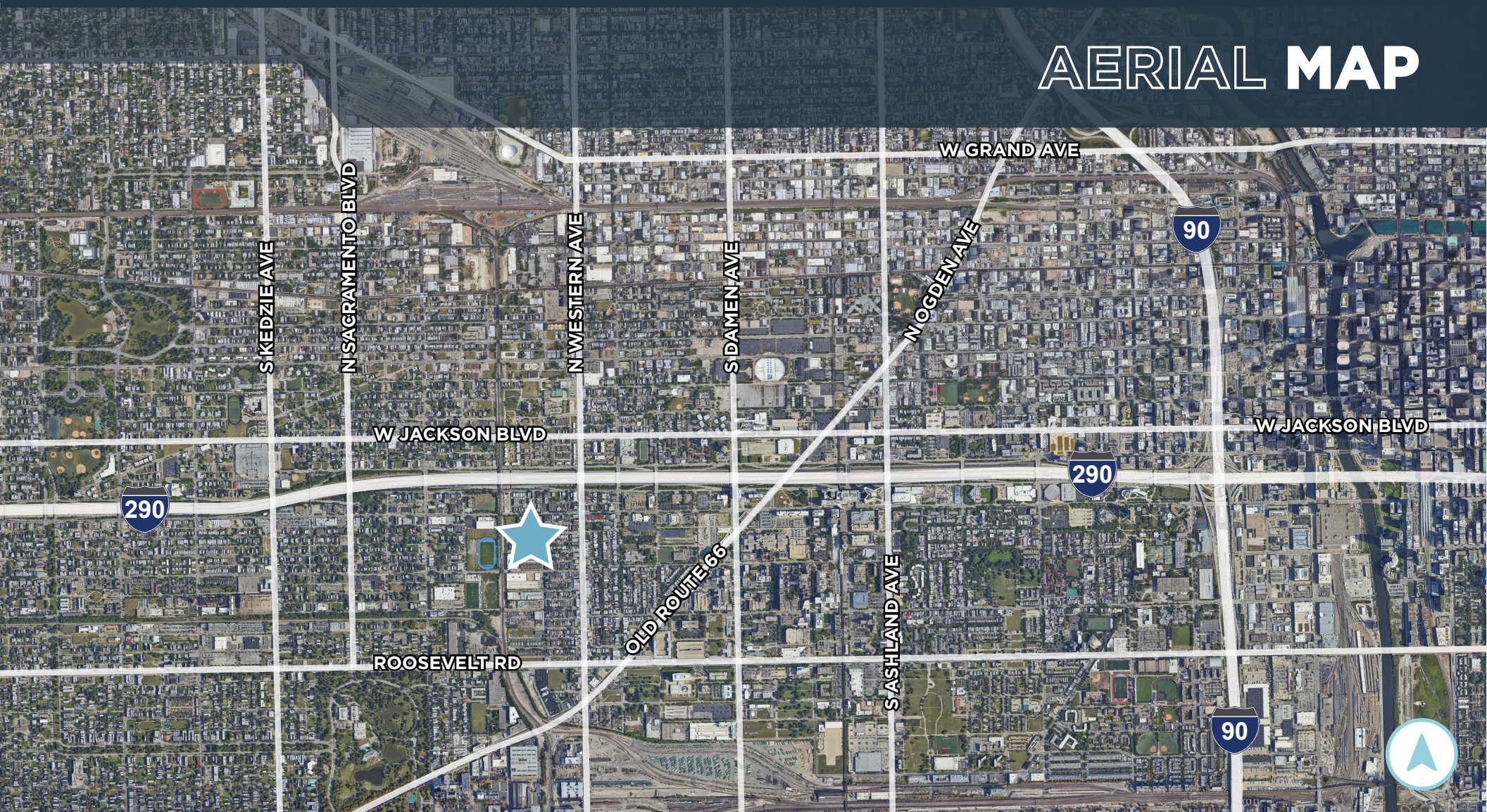

2540

West Flourney Street

Chicago, IL

Location Highlights

- 2.5 Miles to I-290/I-90 Interchange
- 2.9 Miles to Union Station
- 3.5 Miles to Downtown Chicago
- 7.9 Miles to Midway Airport
- 11.3 Miles to Kennedy Expressway
- 23.1 Miles to O'Hare Airport

2540 WEST FLOURNOY STREET



Ryan Klink
Managing Director
+1 847 518 3211
ryan.klink@cushwake.com

Sean Henrick
Vice Chair
+1 847 518 3215
sean.henrick@cushwake.com

©2023 Cushman & Wakefield. All rights reserved. The information contained in this communication is strictly confidential. This information has been obtained from sources believed to be reliable but has not been verified. NO WARRANTY OR REPRESENTATION, EXPRESS OR IMPLIED, IS MADE AS TO THE CONDITION OF THE PROPERTY (OR PROPERTIES) REFERENCED HEREIN OR AS TO THE ACCURACY OR COMPLETENESS OF THE INFORMATION CONTAINED HEREIN, AND SAME IS SUBMITTED SUBJECT TO ERRORS, OMISSIONS, CHANGE OF PRICE, RENTAL OR OTHER CONDITIONS, WITHDRAWAL WITHOUT NOTICE, AND TO ANY SPECIAL LISTING CONDITIONS IMPOSED BY THE PROPERTY OWNER(S). ANY PROJECTIONS, OPINIONS OR ESTIMATES ARE SUBJECT TO UNCERTAINTY AND DO NOT SIGNIFY CURRENT OR FUTURE PROPERTY PERFORMANCE.