

# SUBLEASE FORUM II

7990 IH 10 WEST  
SAN ANTONIO, TX 78230



## PROPERTY DESCRIPTION

Forum II is an 85,547 SF, Class A Building. It is located right along Interstate 10, it is within walking distance of retail and restaurants. Conveniently located 10 minutes away from Downtown as well as 5 minutes away from the Medical Center.

## PROPERTY FEATURES

- Lease expiration is June 30, 2026
- All Furniture and Equipment are included in the Sublease
- Onsite Property Management
- Onsite FedEx Shipping Center
- Workout Facility with Showers
- 24/7 card key access

**54,323 RSF AVAILABLE FOR SUBLEASE**  
**1ST FLOOR: 27,204 RSF | 2ND FLOOR: 27,119 RSF**

**RENTAL RATE**

**\$20.00 sf/yr (Full Service)**

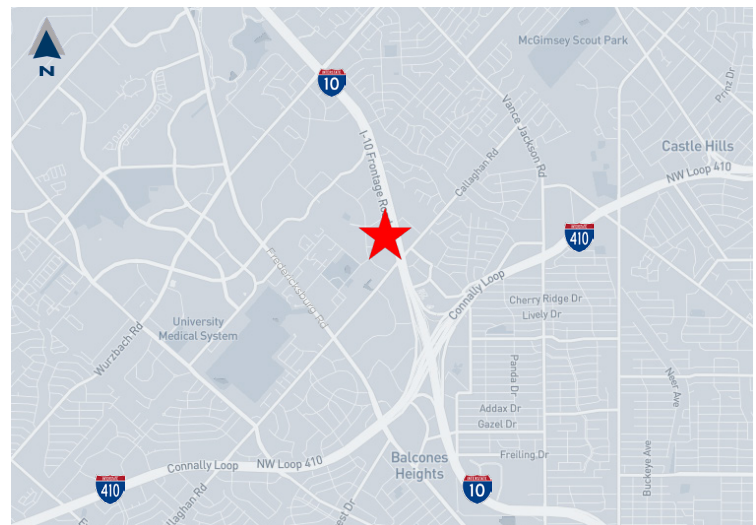

# SUBLEASE FORUM II

7990 W IH 10 SAN ANTONIO, TX 78230

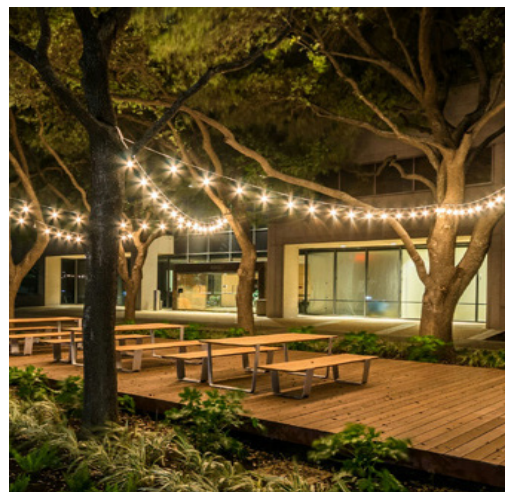

For more information, please contact:

**BRYAN SETHNEY**  
Managing Director

210 305 4280

[bryan.sethney@cushwake.com](mailto:bryan.sethney@cushwake.com)

4040 Broadway

Suite 602

San Antonio, TX 78209

[cushmanwakefield.com](http://cushmanwakefield.com)

# SUBLEASE FORUM II

7990 W IH 10 SAN ANTONIO, TX 78230



CUSHMAN &  
WAKEFIELD

## 1st Floor | 27,204 RSF

Workstations 171

Offices 7

Meeting Rooms 4

Classroom 1

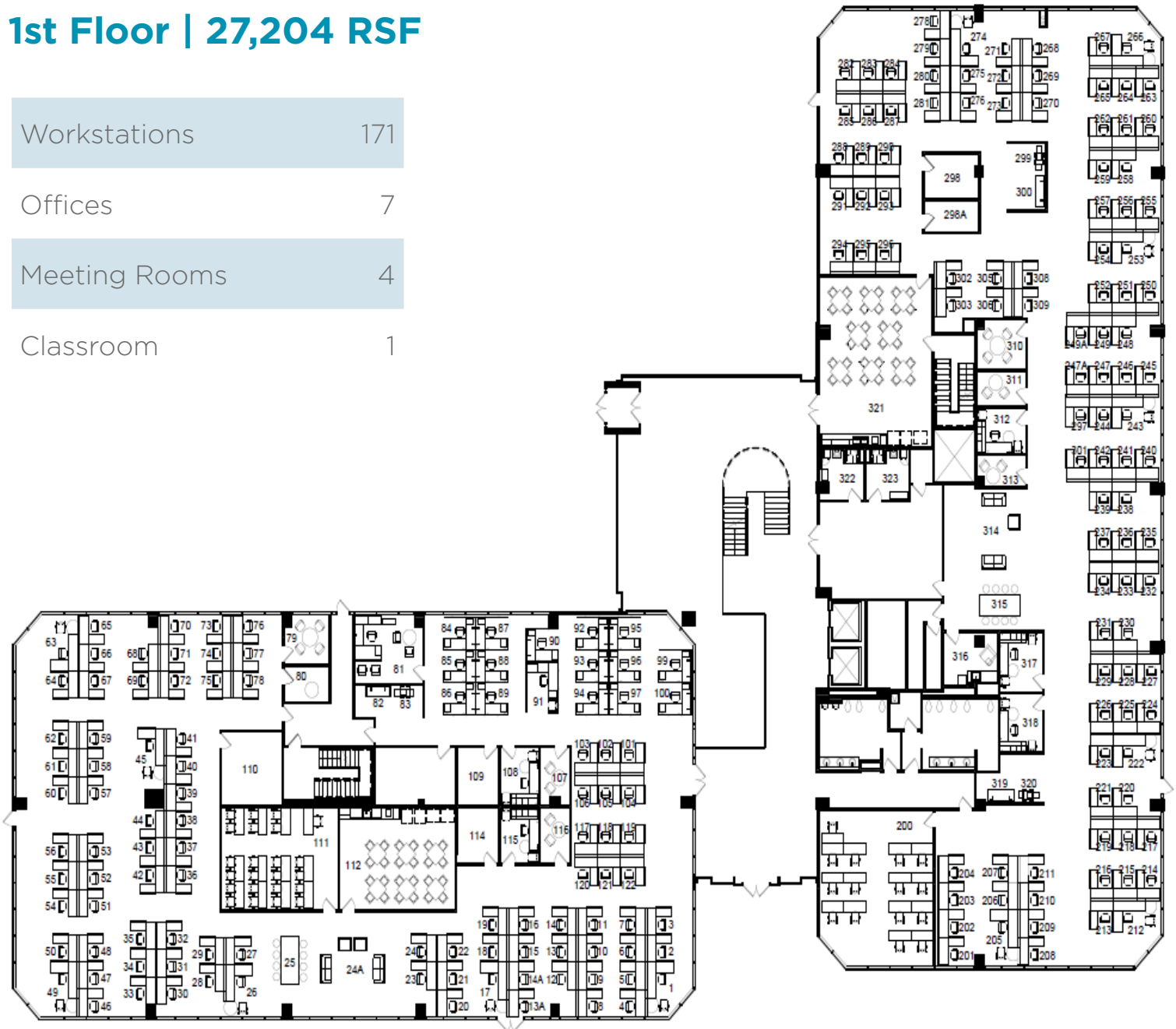

For more information, please contact:

**BRYAN SETHNEY**  
Managing Director  
210 305 4280  
bryan.sethney@cushwake.com

4040 Broadway  
Suite 602  
San Antonio, TX 78209  
cushmanwakefield.com

# SUBLEASE FORUM II

7990 W IH 10 SAN ANTONIO, TX 78230



## 2nd Floor | 27,119 RSF

Workstations 157

Offices 22

Meeting Rooms 3

Classroom 1

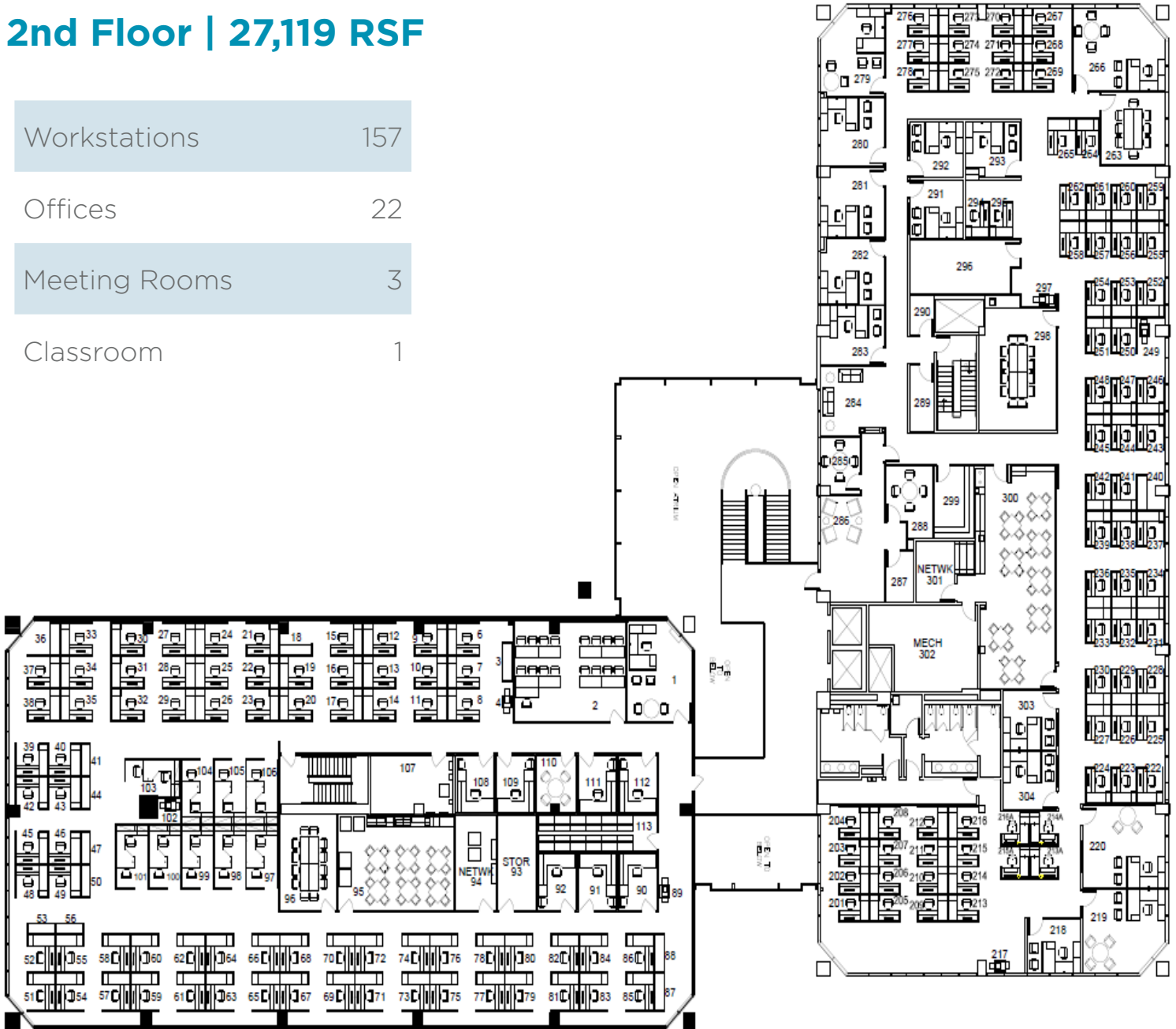

For more information, please contact:

**BRYAN SETHNEY**  
Managing Director  
210 305 4280  
bryan.sethney@cushwake.com

4040 Broadway  
Suite 602  
San Antonio, TX 78209  
cushmanwakefield.com