

FOR LEASE

## BAYVIEW PAVILION

15550 Lightwave Drive Clearwater, FL  
20,117 SF



### PROPERTY HIGHLIGHTS

- From 9,257 SF to 20,117 SF
- Three-story, Class "A" office building
- Up to 20,117 SF available for lease on the ground floor
- 447 parking spaces (4.85/1000) including 196 covered spaces in attached garage
- 3-story glass entrance with marble floor
- Office ceiling heights of 14'
- 30,000 sq. ft. floor plates
- Constructed in 1998
- Possible truck level rear loading dock
- High visibility location
- Outdoor patio area

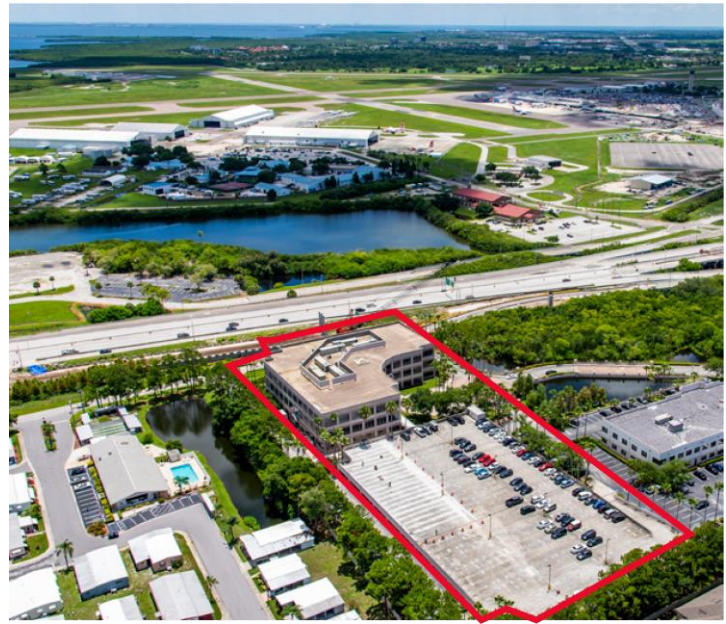

LEASE RATE \$28.00/SF, Full Service

#### MELANIE JACKSON CCIM, SIOR

Director

+1 813 424 3210

[Melanie.Jackson@cushwake.com](mailto:Melanie.Jackson@cushwake.com)

#### ANGELA ODELL

Senior Director

+1 813 514 2435

[Angela.Odell@cushwake.com](mailto:Angela.Odell@cushwake.com)



CUSHMAN &  
WAKEFIELD

[cushmanwakefield.com](http://cushmanwakefield.com)



# BAYVIEW PAVILION

15550 Lightwave Drive Clearwater, FL  
20,117 SF

FOR LEASE

From 9,257 SF to 20,117 SF

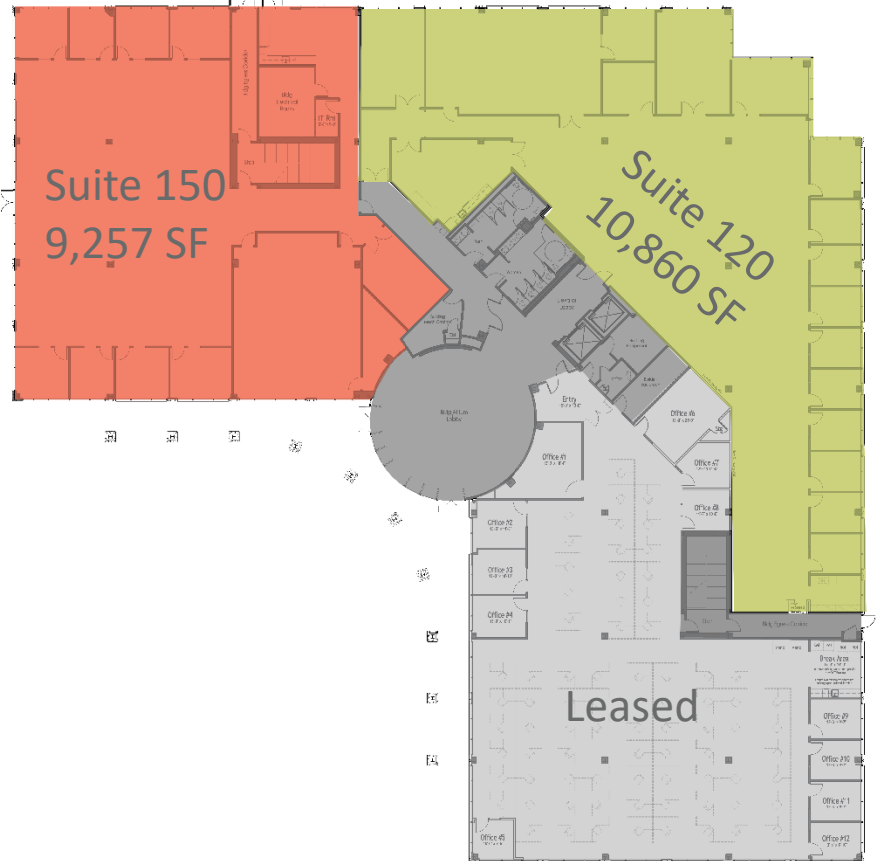

©2020 Cushman & Wakefield. All rights reserved. The information contained in this communication is strictly confidential. This information has been obtained from sources believed to be reliable but has not been verified. No warranty or representation, express or implied, is made as to the condition of the property (or properties) referenced herein or as to the accuracy or completeness of the information contained herein, and same is submitted subject to errors, omissions, change of price, rental or other conditions, withdrawal without notice, and to any special listing conditions imposed by the property owner(s). Any projections, opinions or estimates are subject to uncertainty and do not signify current or future property performance.



**CUSHMAN &  
WAKEFIELD**

[cushmanwakefield.com](http://cushmanwakefield.com)