

148,019 SF

Industrial Space For Lease



Prologis Bolingbrook



900 Carlow Drive
Bolingbrook, IL 60490

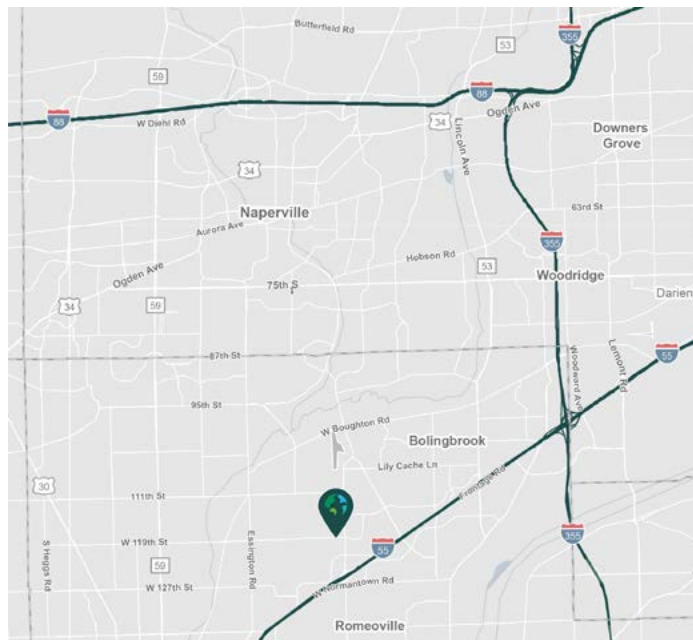

LOCATION

- Located in prestigious Carlow Corporate Center
- Immediate access to I-55 & Weber Road

FACILITY

- 148,019 sf available
- 2,354 sf office
- 30' clear height
- 22 dock doors
- 1 drive-in-door
- 159 car parking stalls (entire building)
- 29 trailer parking stalls (entire building)
- ESFR sprinkler system
- 50' x 40' typical column spacing with 50' speed bays
- LED motion sensor lighting

ADVANTAGES AND AMENITIES

- Low Will County taxes
- Centrally located with efficient access to metropolitan Chicago, Wisconsin and Indiana

148,019 SF

Industrial Space For Lease



Prologis Bolingbrook

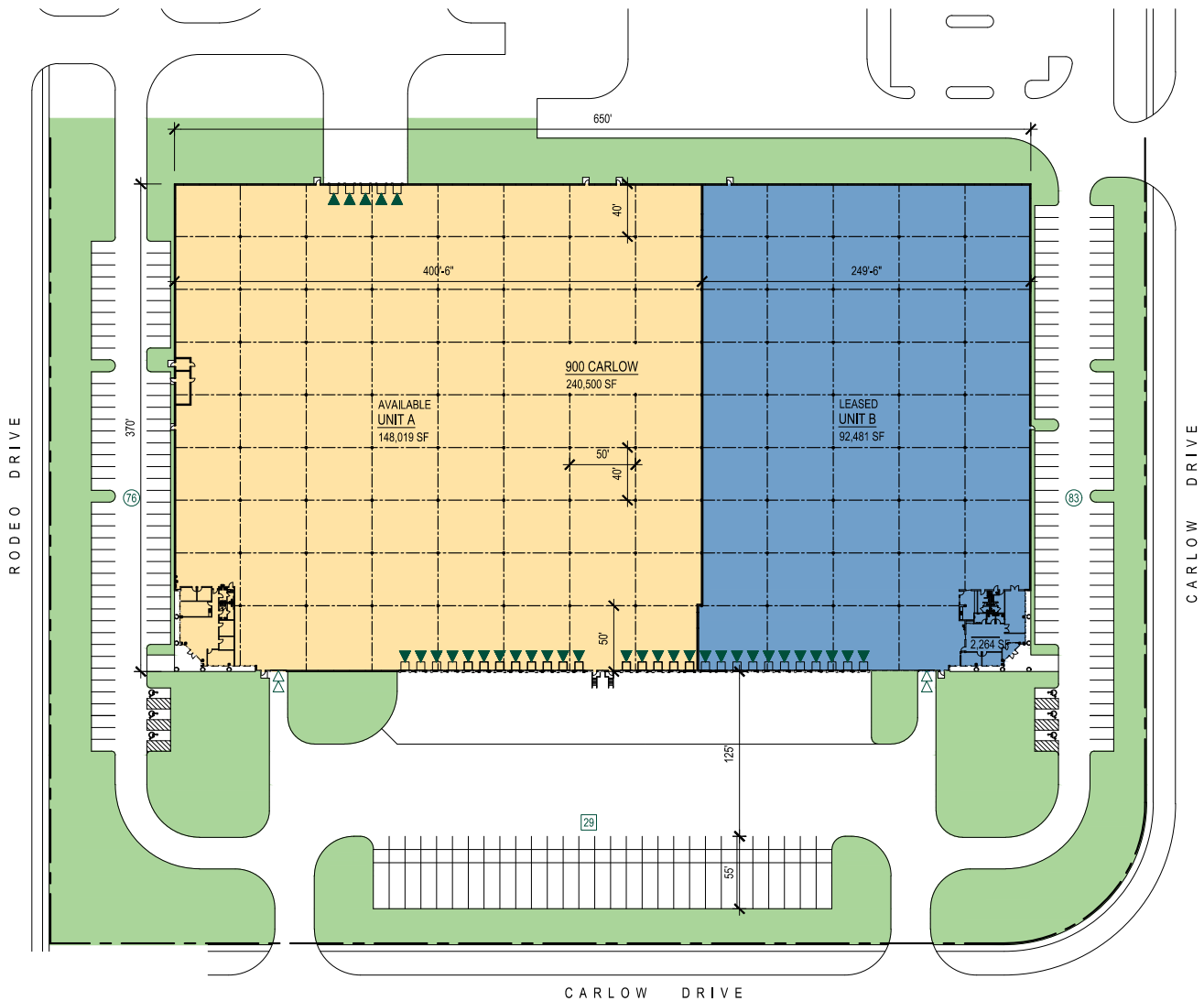

Cushman & Wakefield
Jason West, SIOR
jason.west@cushwake.com
ph +1 847 518 3210
cell +1 630 363 4395
9500 W. Bryn Mawr
Suite 600
Rosemont, IL 60018 USA

Cushman & Wakefield
Sean Henrick, SIOR, CCIM
sean.henrick@cushwake.com
ph +1 847 518 3215
cell +1 847 571 2080
9500 W. Bryn Mawr
Suite 600
Rosemont, IL 60018 USA

Cushman & Wakefield
Ryan Klink
ryan.klink@cushwake.com
ph +1 847 518 3211
cell +1 815 997 2144
9500 W. Bryn Mawr
Suite 600
Rosemont, IL 60018 USA

Prologis
Trevor Jeske
tjeske@prologis.com
ph +1 847 292 3866
cell +1 248 212 9014
6250 N. River Road
Suite 1100
Rosemont, IL 60018 USA

Prologis Essentials: your single-source service for efficient move-in and operations at prologisessentials.com

No warranty or representation, expressed or implied, is made as to the accuracy of the information contained herein, and same is submitted subject to error and omissions.

148,019 SF

Industrial Space For Lease



Prologis Bolingbrook



WAREHOUSE



WAREHOUSE /
LOADING

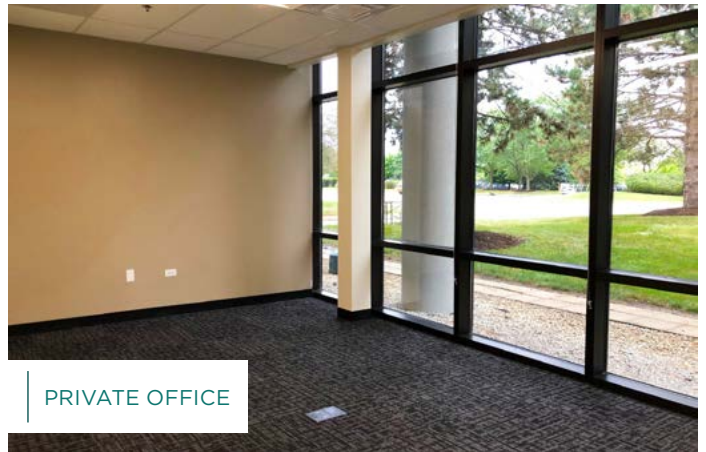

PRIVATE OFFICE



BREAK ROOM

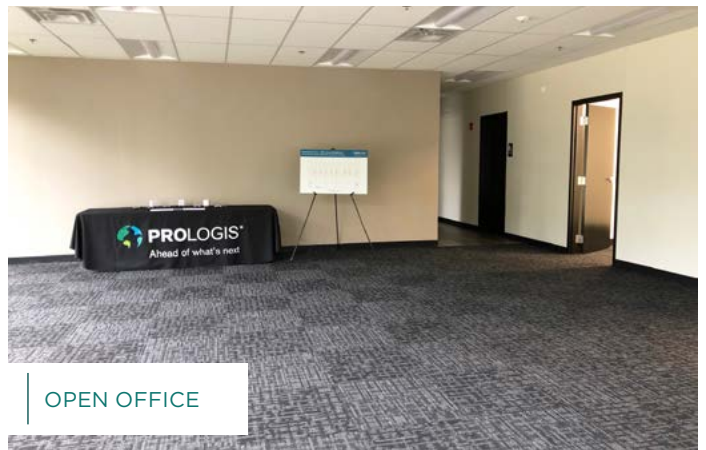

OPEN OFFICE