

**SUBLEASE OFFICE SPACE
SUITE 150 - 15,045 RSF**

6261

KATELLA AVE

CYPRESS, CALIFORNIA 90630



SPACE PHOTOS

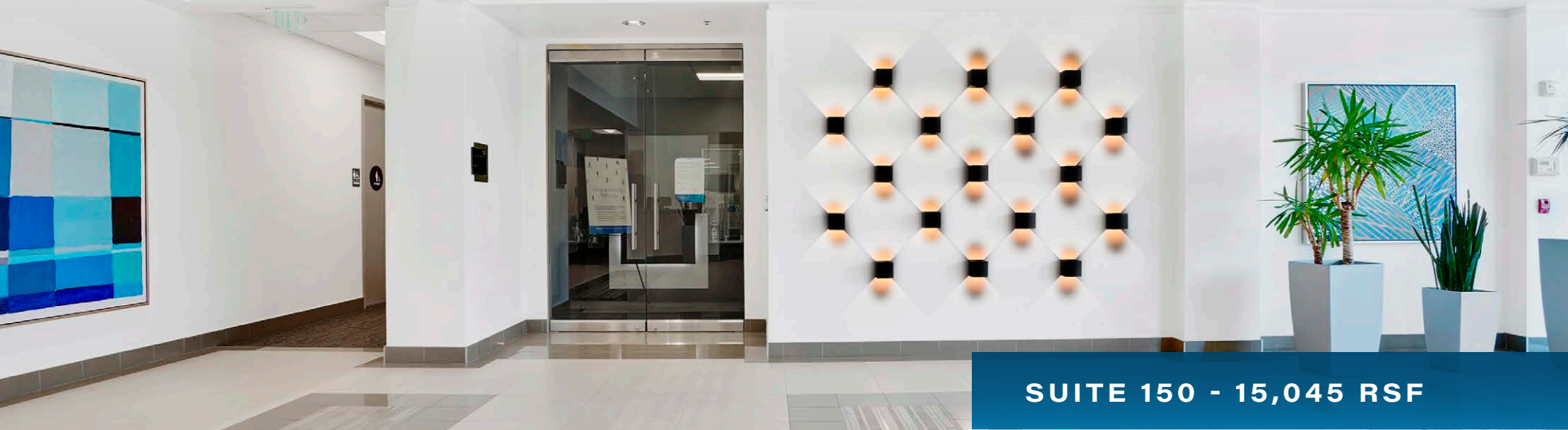

SUITE 150 - 15,045 RSF



SUBLEASE | 6261 KATELLA AVE



CUSHMAN & WAKEFIELD



SUBLEASE HIGHLIGHTS

- ▶ Fully furnished plug & play office space located in the Warland/ Cypress Business Center
- ▶ High-image office building with Katella Avenue frontage
- ▶ Ground floor office space with double-door entry
- ▶ Modern, high-end finishes with like-new furniture
- ▶ Offering 8 private offices, 2 large conference rooms, huddle room/small conference, 2 training rooms, 2 phone booths, reception, server room, storage room, kitchen/break room, coffee wet bar and large open areas with 90+ cubicles
- ▶ Floor to ceiling glass line providing an abundance of natural light
- ▶ Free surface parking
- ▶ Minutes to I-405, CA-22 and I-605 Freeways

CYPRESS LOCATION

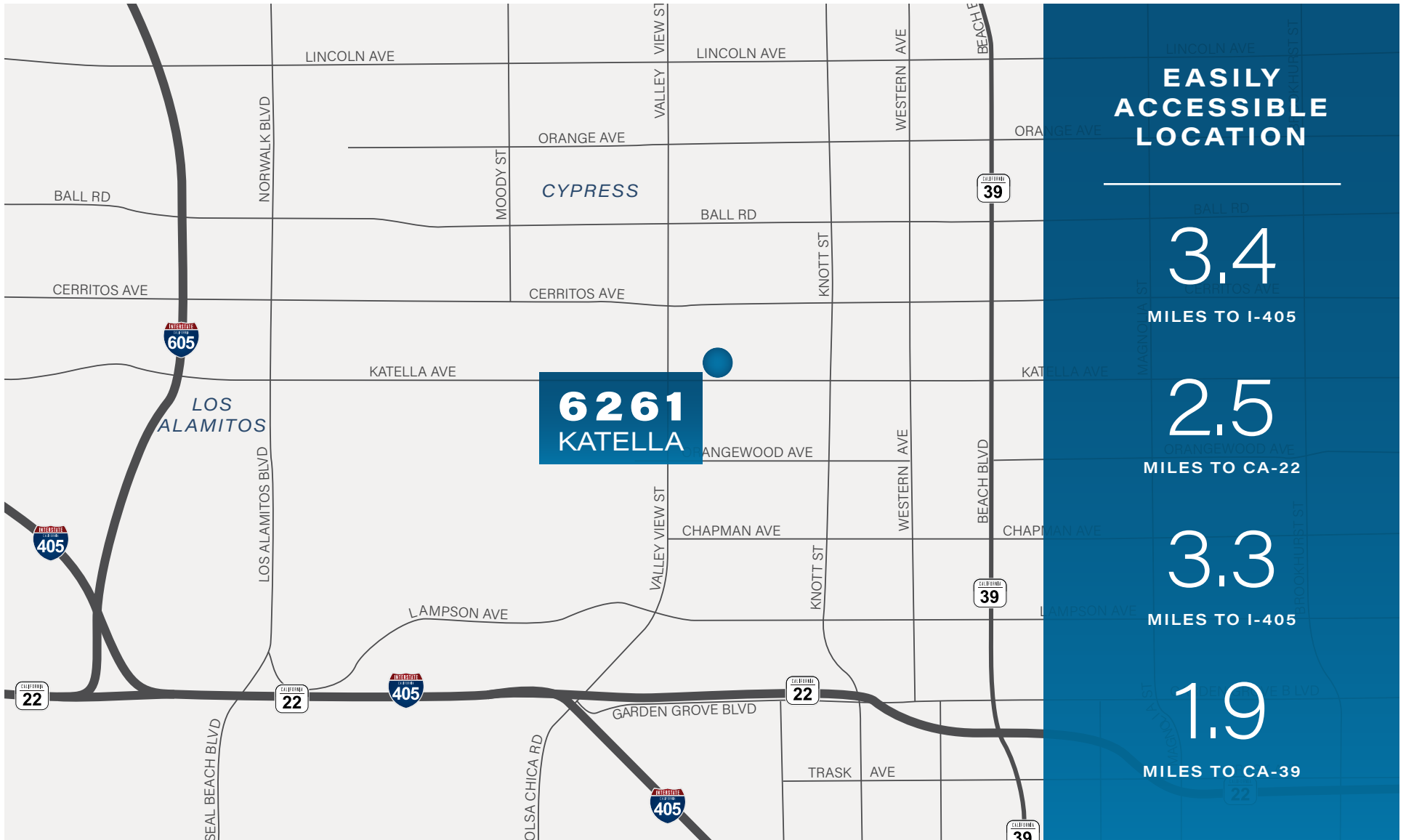

FURNITURE PLAN

SUITE 150 - 15,045 RSF

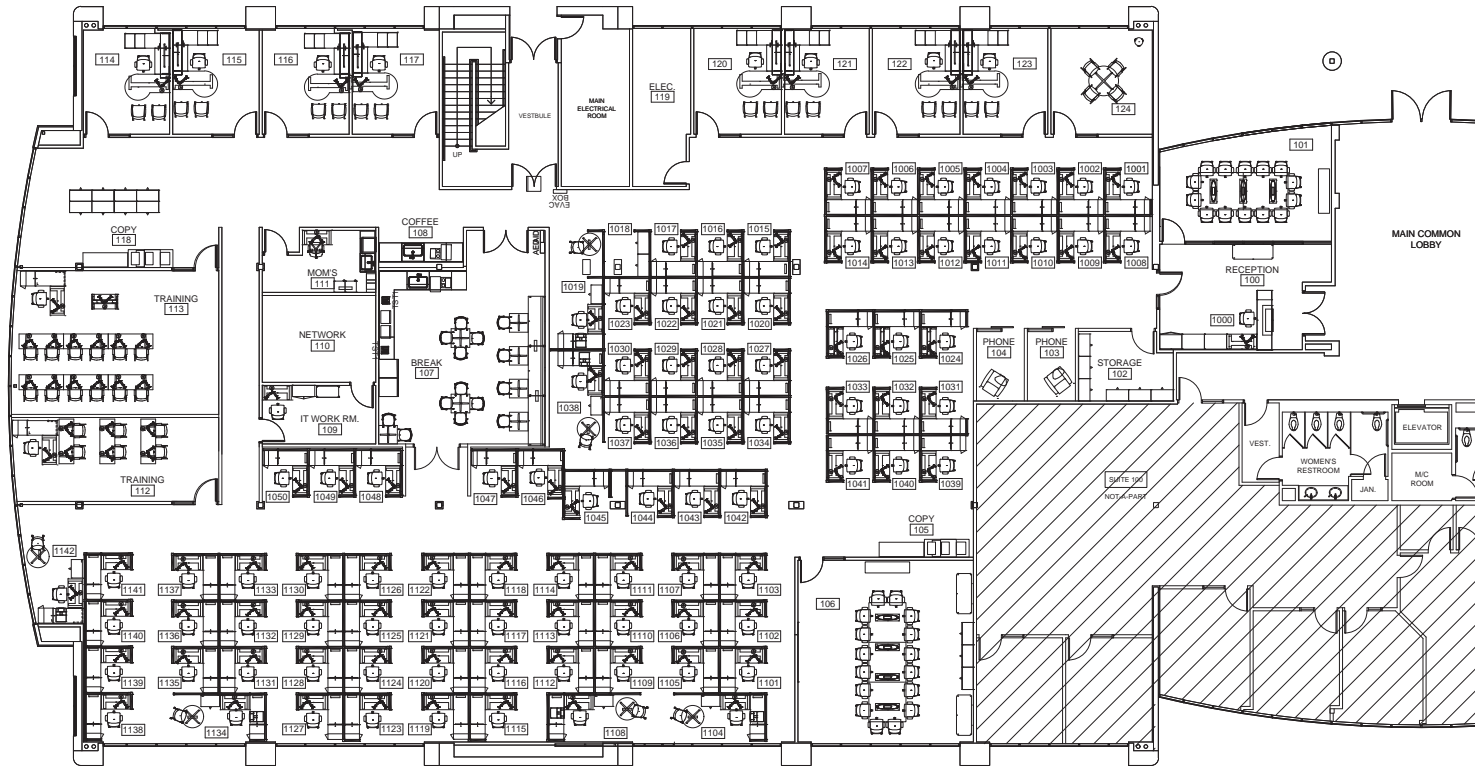

150

SUITE NUMBER

15,045

RSF AVAILABLE

1/31/24

LEASE EXPIRATION

\$1.35

FSG ASKING RATE

Now

AVAILABLE

CONTACTS

CHON KANTIKOVIT

+1 949 930 9220

chon.kantikovit@cushwake.com

Lic #01299207

JASON WARD

+1 949 955 7640

jason.ward@cushwake.com

Lic #01802243



**CUSHMAN &
WAKEFIELD**

CUSHMAN & WAKEFIELD OF CALIFORNIA, INC. | 18111 VON KARMAN AVE, SUITE 1000, IRVINE, CALIFORNIA 92612 | CUSHMANWAKEFIELD.COM

©2022 Cushman & Wakefield. All rights reserved. The information contained in this communication is strictly confidential. This information has been obtained from sources believed to be reliable but has not been verified. No warranty or representation, express or implied, is made as to the condition of the property (or properties) referenced herein or as to the accuracy or completeness of the information contained herein, and same is submitted subject to errors, omissions, change of price, rental or other conditions, withdrawal without notice, and to any special listing conditions imposed by the property owner(s). Any projections, opinions or estimates are subject to uncertainty and do not signify current or future property performance.