



250

Middlefield Road
Menlo Park, CA

±24,894 SF | Available for Sublease



250

Middlefield Road
Menlo Park, CA

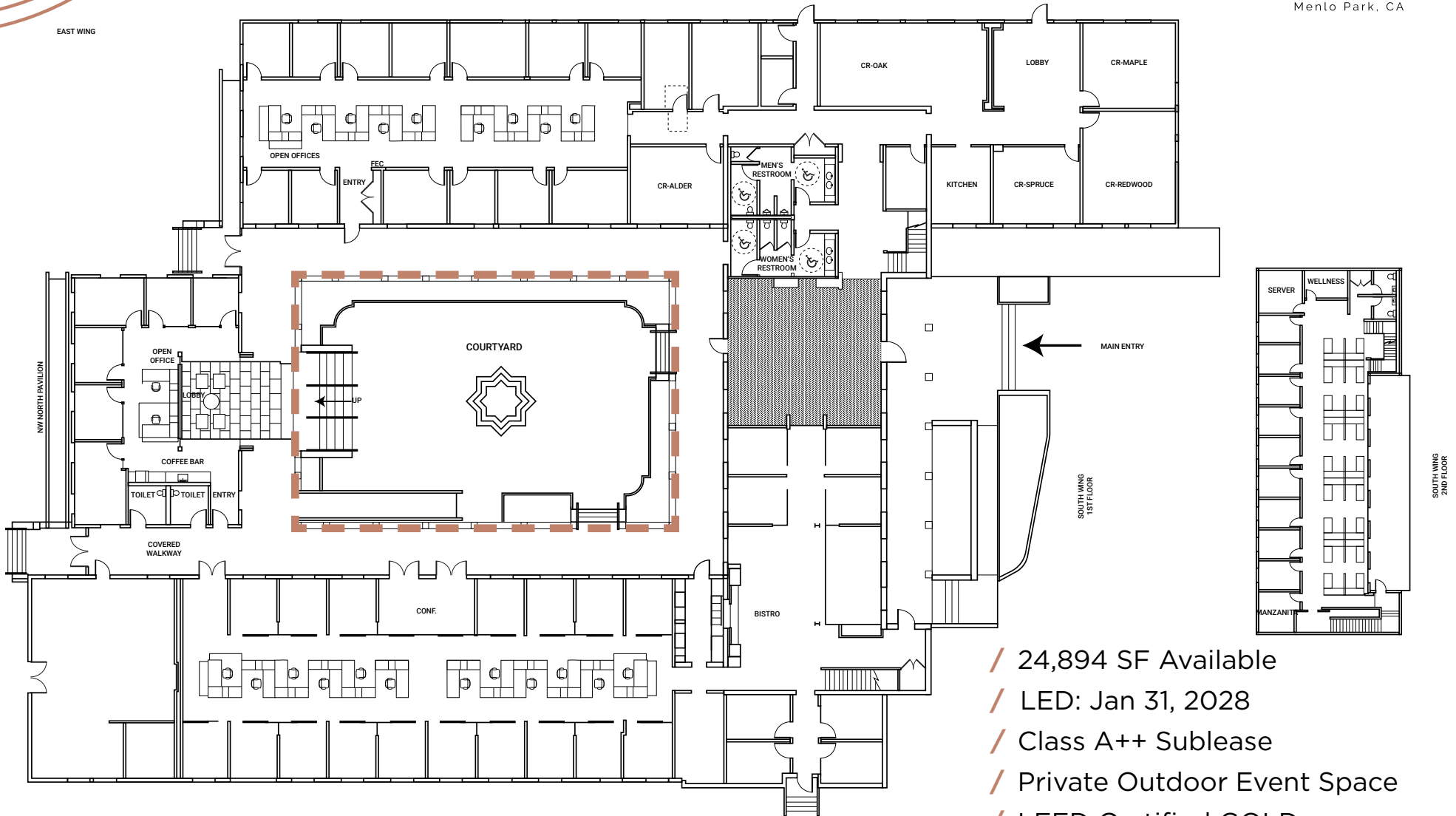

- / 24,894 SF Available
- / LED: Jan 31, 2028
- / Class A++ Sublease
- / Private Outdoor Event Space
- / LEED Certified GOLD



COURTYARD



250

Middlefield Road
Menlo Park, CA



250 MIDDLEFIELD ROAD

NEW AMENITIES

CAFES/RESTAURANTS

- Andytown Coffee Roasters
- Burma Love
- Canteen Wine Bar
- Che Fico Spinoff
- Barebottle Brew Co

DOWNTOWN MENLO PARK

DOWNTOWN MENLO PARK

<p>CAFES</p> <ul style="list-style-type: none"> • Philz Coffee • Cafe Borrone • Menlo Cafe • Starbucks <p>RESTAURANTS</p> <ul style="list-style-type: none"> • Jeffrey's Hamburgers Stacks • Shiok! • Carpaccio • Mademoiselle Colette • Cafe Del Sol • Coldstone Creamery • British Bankers Club • Gombei 	<p>SERVICES</p> <ul style="list-style-type: none"> • Chevron • 76 • Walgreens • Safeway • Draeger's • Citibank • Comerica Bank • Chase Bank • Wells Fargo Bank • Trader Joe's • Bank of America • Bank of the West • Pacific National Bank • Barre
--	---



THE STANFORD PARK HOTEL

STANFORD SHOPPING CENTER

DOWNTOWN PALO ALTO

<p>CAFES</p> <ul style="list-style-type: none"> • Philz Coffee • Coupa Cafe • Cafe Venetia • Joe & The Juice • Tono Coffee Project • Blue Bottle Coffee • Starbucks <p>RESTAURANTS</p> <ul style="list-style-type: none"> • Tamarine • Sancho's Taqueria • Oren's Hummus Shop • Gyros Gyros • Kanpai • Darbar Indian Cuisine • Crepevine Restaurants • Siam Royal • Nola • Sprout Cafe • The Patio • Evvia • Nobu Palo Alto • Saint Michael's Alley • La Morenita 	<ul style="list-style-type: none"> • Bare Bowls • Salt & Straw • Pizza My Heart • Wahlburgers • Il Fornaio • Rooh • Sushirrito <p>SERVICES</p> <ul style="list-style-type: none"> • Chase Bank • Whole Foods Market • Patagonia • Chase Bank • Citibank • Comerica Bank • Wells Fargo • Bank of America • HSBC Bank • Union Bank • T-Mobile • Apple Palo Alto • Rejuvenation • Rumble Boxing • Form Fitness
---	--



For more information,
please contact:

DAN PERSYN

Executive Managing Director
+1 650 320 0255
dan.persyn@cushwake.com
LIC #01184798

SOFIA LUNDELL

Associate
+1 650 320 0220
sofia.lundell@cushwake.com
LIC #02201946

BRAD ALTICK

Senior Vice President
+1 650 814 5169
brad.altick@cbre.com
LIC #01877935

©2024 Cushman & Wakefield. All rights reserved. The information contained in this communication is strictly confidential. This information has been obtained from sources believed to be reliable but has not been verified. NO WARRANTY OR REPRESENTATION, EXPRESS OR IMPLIED, IS MADE AS TO THE CONDITION OF THE PROPERTY (OR PROPERTIES) REFERENCED HEREIN OR AS TO THE ACCURACY OR COMPLETENESS OF THE INFORMATION CONTAINED HEREIN, AND SAME IS SUBMITTED SUBJECT TO ERRORS, OMISSIONS, CHANGE OF PRICE, RENTAL OR OTHER CONDITIONS, WITHDRAWAL WITHOUT NOTICE, AND TO ANY SPECIAL LISTING CONDITIONS IMPOSED BY THE PROPERTY OWNER(S). ANY PROJECTIONS, OPINIONS OR ESTIMATES ARE SUBJECT TO UNCERTAINTY AND DO NOT SIGNIFY CURRENT OR FUTURE PROPERTY PERFORMANCE. COE-PM-West-02.15.2024



250

Middlefield Road

Menlo Park, CA