

Ground Floor Retail For Sale

# Clyde by Porte

3237 St. John's Street  
Port Moody, BC

**CRAIG BALLANTYNE**

Personal Real Estate Corporation  
Senior Vice President  
+1 604 608 5928  
[craig.ballantyne@cushwake.com](mailto:craig.ballantyne@cushwake.com)

**LIAM BOULTBEE**

Senior Associate  
+1 604 629 5023  
[liam.boultee@ca.cushwake.com](mailto:liam.boultee@ca.cushwake.com)

700 West Georgia Street  
Suite 700 | Pacific Centre  
Vancouver, British Columbia V7Y 1A1  
[cushmanwakefield.com](http://cushmanwakefield.com)



## THE OPPORTUNITY

Clyde brings together the best that Port Moody has to offer comprising an unprecedented opportunity to purchase retail strata space in one of the region's most unique neighborhoods. With nearby access to Inlet Centre Station and the nature-dense shoreline, Clyde offers a compelling value proposition to perspective buyers seeking the opportunity to immerse themselves in a truly-mixed-use enclave. Retail strata units are seldom available for purchase in Port Moody, don't miss out on the opportunity to locate your business at the crossroads of urban and lifestyle.

## HIGHLIGHTS

- Ideal for owner user or investors
- Dedicated Commercial Parking Stalls
- Two Blocks From SkyTrain Station
- Signalized intersection
- Each strata lot includes fascia signage and rear loading
- Prominent location along St. Johns Street with exposure to 90,000 vehicles per day
- Project is complete and available immediately



# LOCATION

Located in the heart of Port Moody, prominently situated along St. John's Street within a 5-minute walking distance to the Evergreen Line's Inlet Centre Station. This high exposure location provides visibility to both foot and vehicular traffic, capturing customers with a signalized intersection and multiple street parking options and on-site underground parking. The location benefits from over 5,000 new residential units and 185,000 sf of office space nearby at Suter Brook Village. Area tenancies include Thrifty, Shoppers Drug Mart, B.C. Liquor Store and local craft breweries. The flourishing location delivers a transcendent experience to residents, employees and visitors alike with abundant green space, everyday groceries, craft beers and SkyTrain access all within a 15-minute walk. The location is further endowed with 5 storeys of residential above the available strata unit creating unmatched project synergies. The location offers plenty of lifestyle and amenities all packaged in a modern and efficient layout serving as the backdrop to the new urban vibe experienced only in Port Moody.



For over 55 years, Porte Communities has made an uncompromising commitment to build outstanding homes around the lifestyles of those who will eventually reside within them. Since

their first project in 1974, they've constructed over 2,500 homes. Today, Porte has expanded its operations to include commercial and industrial projects as well. Their experience building innovative low and mid-rise residential buildings has given them a reputation for value and high quality. Over two generations, Porte has acted with a set of fundamental beliefs. These beliefs have formed the promises they make and live by everyday. Learn more at [porte.ca](http://porte.ca)

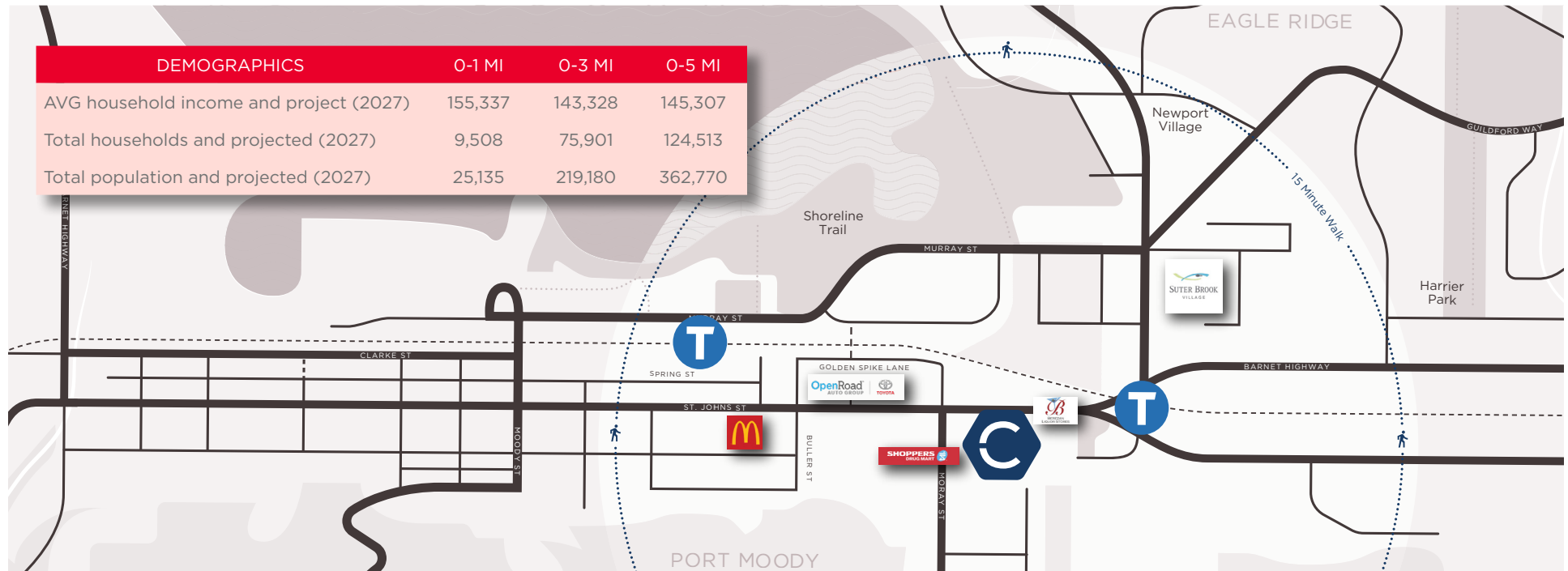

# UNIT 106 - 3227 ST. JOHN'S STREET

995 SF

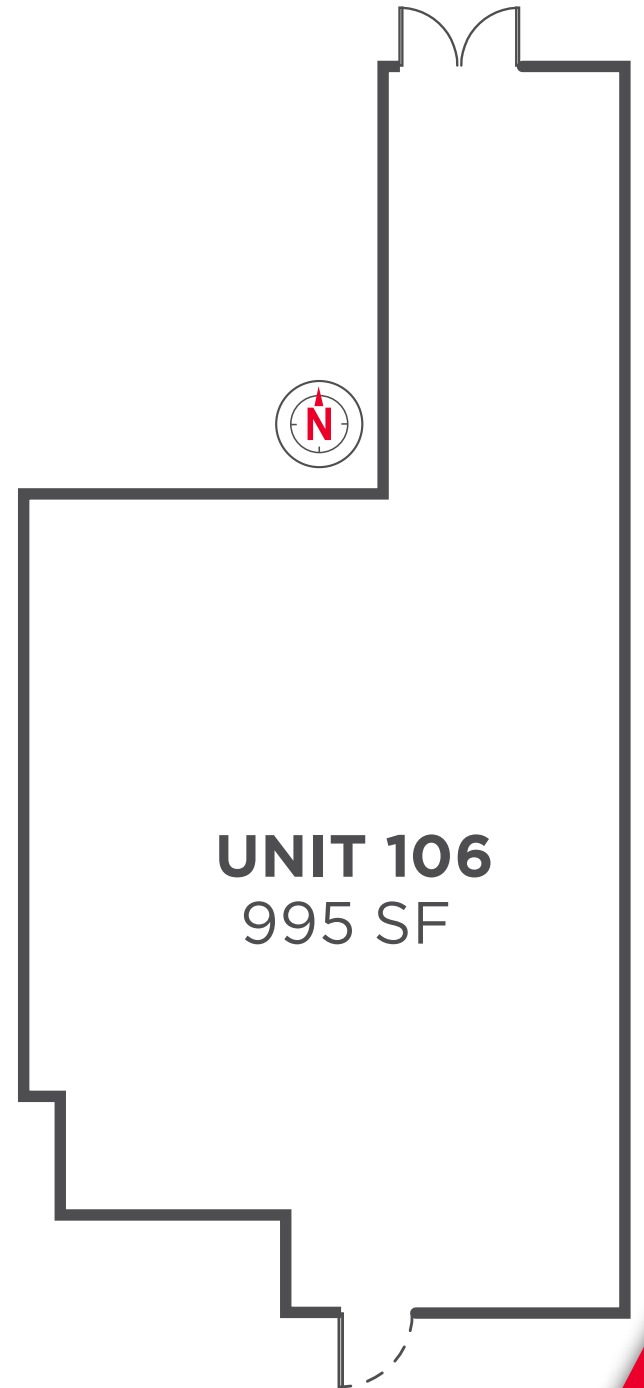
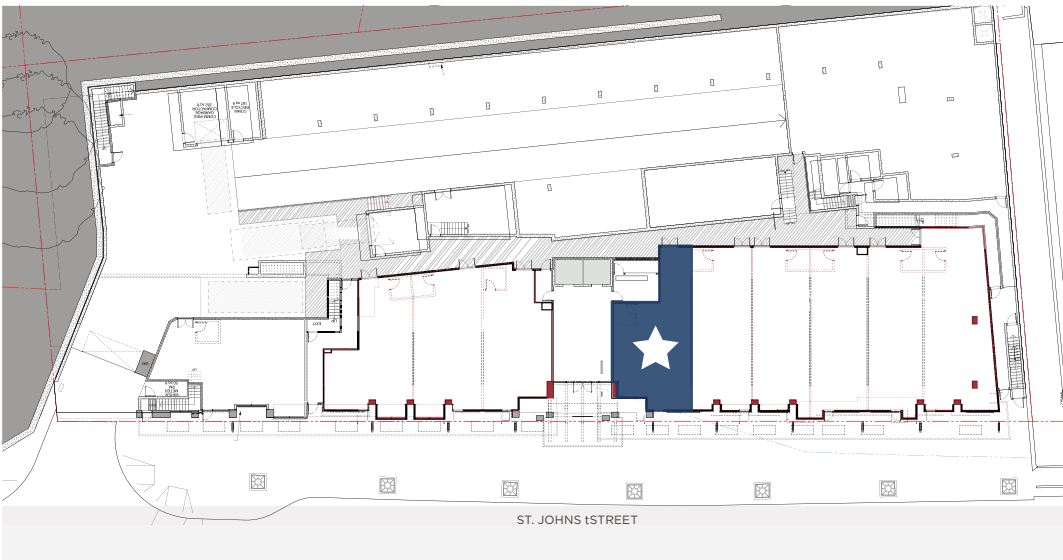

CRU	STRATA LOT	UNIT SIZE*	PRICE (Contact Listing Agent)	AVAILABILITY	PARKING
106	123	995 SF	Please Contact Listing Agent	IMMEDIATELY	1

\*Unit sizes are based on the strata plan and can change at anytime. Unit numbers are subject to change.

# UNIT 109 - 3235 ST. JOHN'S STREET

947 SF

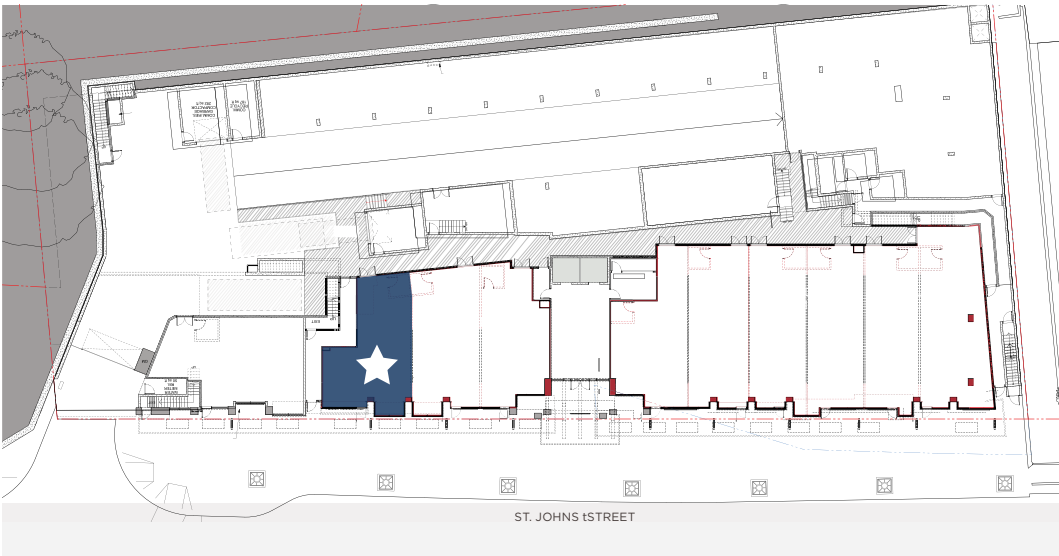

**UNIT 109**  
947 SF

CRU	STRATA LOT	UNIT SIZE*	PRICE (Contact Listing Agent)	AVAILABILITY	PARKING
109	126	947 SF	Please Contact Listing Agent	IMMEDIATELY	1

\*Unit sizes are based on the strata plan and can change at anytime. Unit numbers are subject to change.

# Clyde

## CONTACT INFORMATION:

700 West Georgia Street  
Suite 700 | Pacific Centre  
Vancouver, British Columbia V7Y 1A1  
[cushmanwakefield.com](http://cushmanwakefield.com)

**CRAIG BALLANTYNE**  
Personal Real Estate Corporation  
Senior Vice President  
+1 604 608 5928  
[craig.ballantyne@cushwake.com](mailto:craig.ballantyne@cushwake.com)

**LIAM BOULTBEE**  
Senior Associate  
+1 604 629 5023  
[liam.boultee@ca.cushwake.com](mailto:liam.boultee@ca.cushwake.com)

©2024 Cushman & Wakefield. All rights reserved. The information contained in this communication is strictly confidential. This information has been obtained from sources believed to be reliable but has not been verified. NO WARRANTY OR REPRESENTATION, EXPRESS OR IMPLIED, IS MADE AS TO THE CONDITION OF THE PROPERTY (OR PROPERTIES) REFERENCED HEREIN OR AS TO THE ACCURACY OR COMPLETENESS OF THE INFORMATION CONTAINED HEREIN, AND SAME IS SUBMITTED SUBJECT TO ERRORS, OMISSIONS, CHANGE OF PRICE, RENTAL OR OTHER CONDITIONS, WITHDRAWAL WITHOUT NOTICE, AND TO ANY SPECIAL LISTING CONDITIONS IMPOSED BY THE PROPERTY OWNER(S). ANY PROJECTIONS, OPINIONS OR ESTIMATES ARE SUBJECT TO UNCERTAINTY AND DO NOT SIGNIFY CURRENT OR FUTURE PROPERTY PERFORMANCE.

