

7000 S YOSEMITE



Zachary T. Williams

Director

+1 303 813 6474

zach.williams@cushwake.com

Nathan J. Bradley

Managing Director

+1 303 813 6444

nate.bradley@cushwake.com

W. Ryan Stout

Managing Director

+1 303 813 6448

ryan.stout@cushwake.com



**CUSHMAN &
WAKEFIELD**

IDEALLY LOCATED WITH GREAT I-25 ACCESS

EASY ACCESS FOR TENANTS TO THE
DENVER METRO AREA

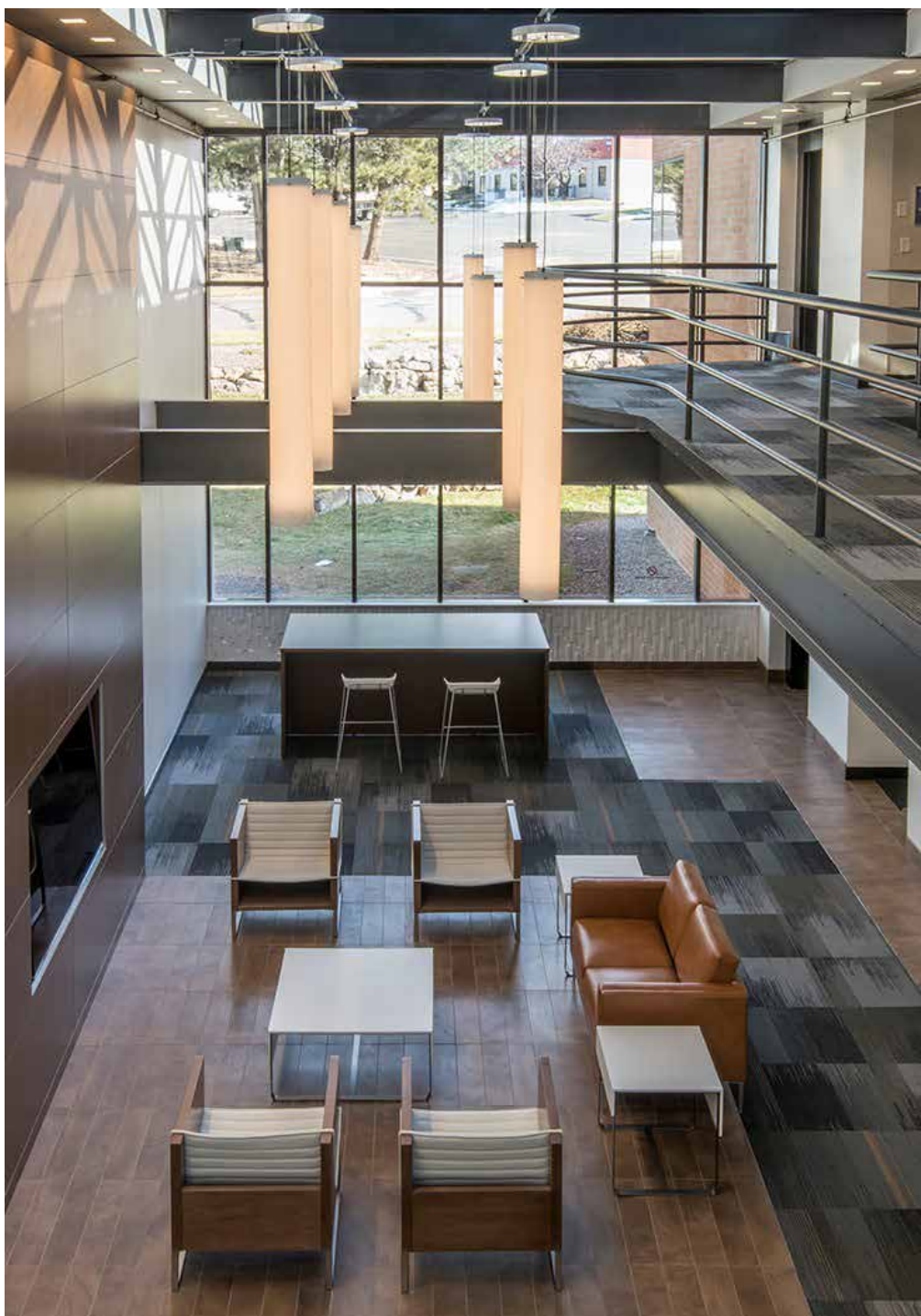



1980

YEAR OF CONSTRUCTION

53,532 SF

TOTAL BUILDING SIZE

4.0 : 1,000 SF

PARKING RATIO

25,095 SF

TYPICAL FLOOR SIZE

FEATURES:

- CONFERENCE CENTER
- FITNESS CENTER
- ON-SITE STORAGE
- EXECUTIVE COVERED PARKING
- PROXIMITY TO RESTAURANTS & RETAIL

OVERVIEW:

- RECENT RENOVATED BUILDING
- LESS THAN A MILE FROM RTD LIGHT RAIL STATIONS
- LOCATED OFF YOSEMITE BETWEEN ARAPAHOE ROAD & DRY CREEK

7000 S YOSEMITE

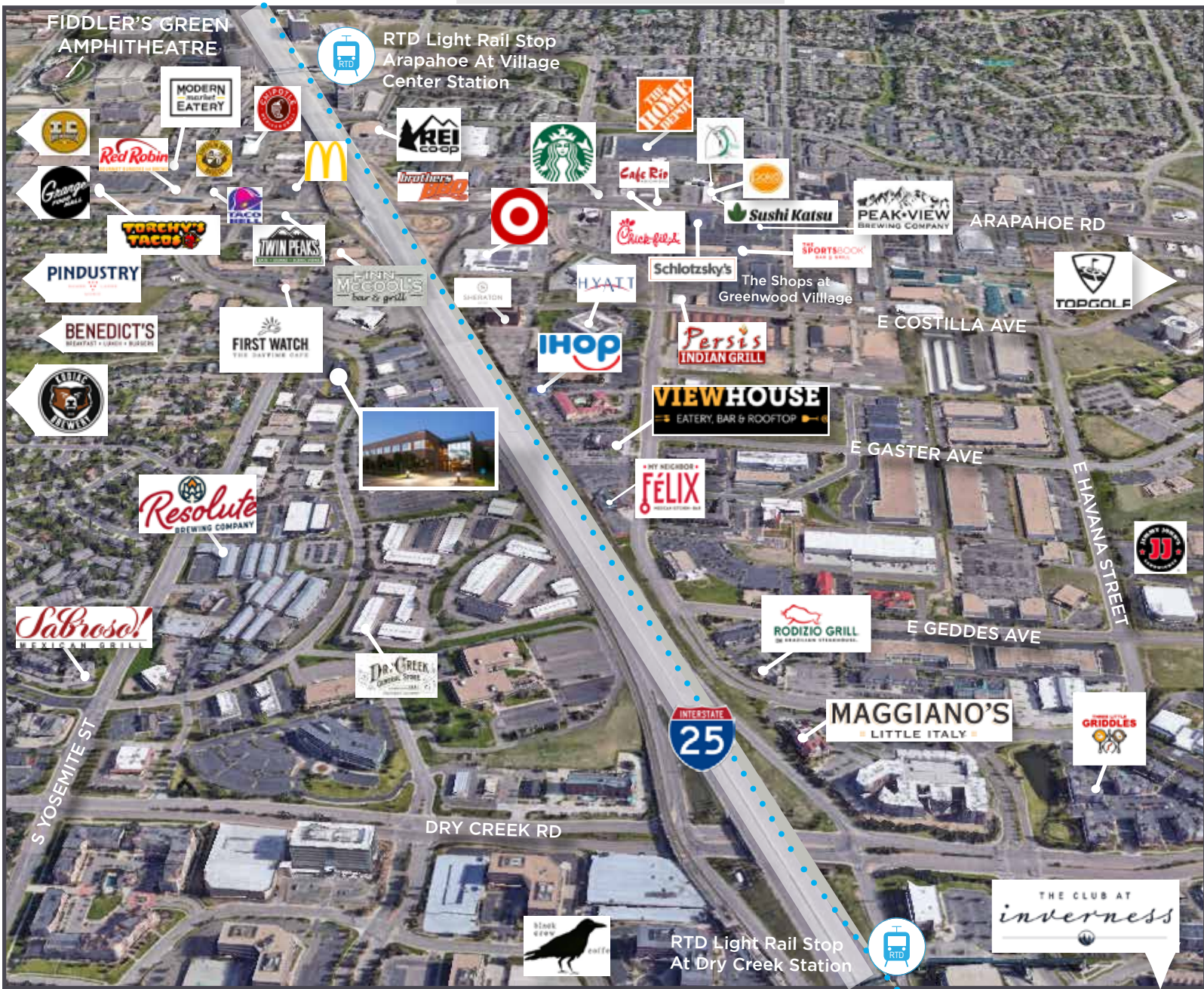

7000 S YOSEMITE, ENGLEWOOD, CO 80112

Zachary T. Williams

Director

+1 303 813 6474

zach.williams@cushwake.com

Nathan J. Bradley

Managing Director

+1 303 813 6444

nate.bradley@cushwake.com

W. Ryan Stout

Managing Director

+1 303 813 6448

ryan.stout@cushwake.com

