

AVAILABLE SEPTEMBER 1, 2024

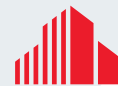

FOR LEASE 46,413 SF | SUITE 500

1000 DAVEY ROAD
WOODRIDGE, IL



CUSHMAN &
WAKEFIELD

Owned By:

nuveen

1000 DAVEY ROAD

WOODRIDGE, IL

Property Features

| | |
|-----------------------|--|
| Building Size: | 264,183 SF |
| Space Available: | Suite 500 46,413 SF |
| Office Area: | Suite 500 \pm 2,000 |
| Built: | 2009 |
| Clear Height: | 30' |
| Bay Size: | 46' x 50' |
| Loading: | 7 Exterior Docks 1 Drive-in Door |
| Sprinkler: | ESFR |
| OpEx: | \$0.92 PSF |
| Estimated R.E. Taxes: | \$1.62 PSF |
| Asking Rate: | Subject To Offer |
| Comments | Trailer parking available Immediate access to I-55 & I-355 Low DuPage County Taxes |



1000 DAVEY ROAD WOODRIDGE, IL

SITE PLAN

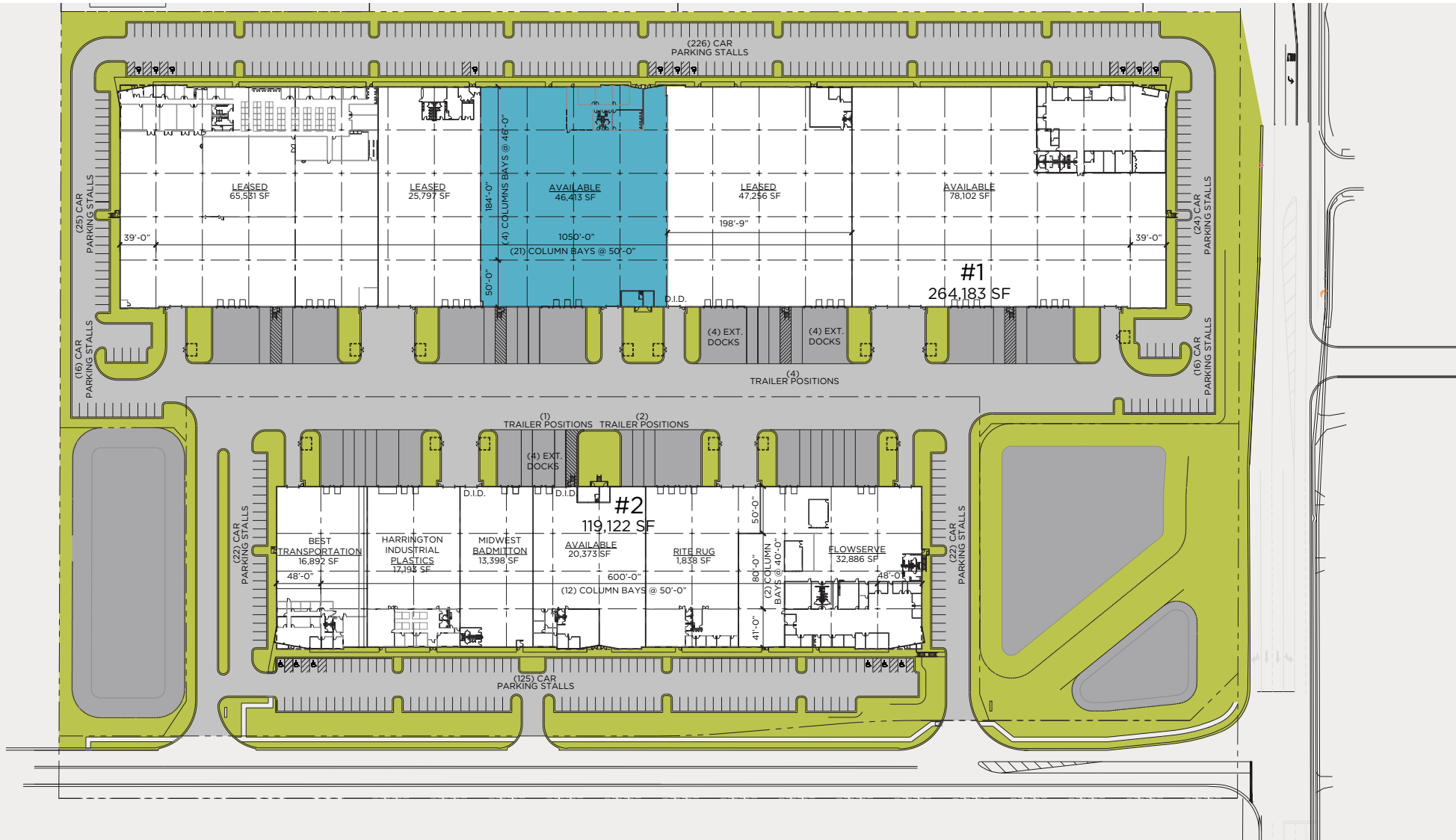



FOR MORE INFORMATION, CONTACT:

SEAN HENRICK, SIOR, CCIM
Executive Managing Director
+1 847 518 3215
sean.henrick@cushwake.com

RYAN KLINK
Managing Director
+1 847 518 3211
ryan.klink@cushwake.com



©2024 Cushman & Wakefield. All rights reserved. The information contained in this communication is strictly confidential. This information has been obtained from sources believed to be reliable but has not been verified. NO WARRANTY OR REPRESENTATION, EXPRESS OR IMPLIED, IS MADE AS TO THE CONDITION OF THE PROPERTY (OR PROPERTIES) REFERENCED HEREIN OR AS TO THE ACCURACY OR COMPLETENESS OF THE INFORMATION CONTAINED HEREIN, AND SAME IS SUBMITTED SUBJECT TO ERRORS, OMISSIONS, CHANGE OF PRICE, RENTAL OR OTHER CONDITIONS, WITHDRAWAL WITHOUT NOTICE, AND TO ANY SPECIAL LISTING CONDITIONS IMPOSED BY THE PROPERTY OWNER(S). ANY PROJECTIONS, OPINIONS OR ESTIMATES ARE SUBJECT TO UNCERTAINTY AND DO NOT SIGNIFY CURRENT OR FUTURE PROPERTY PERFORMANCE.