

---

1505 5TH AVENUE  
SEATTLE, WA



# 1505 FIFTH

---

CREATIVE PLUG AND PLAY OFFICE SPACE LOCATED  
IN THE HEART OF DOWNTOWN SEATTLE



# 1505 Fifth

## PROPERTY HIGHLIGHTS

1505 Fifth Avenue is a six-story boutique mixed-use building in Seattle's CBD

### Creative Office Space for Lease

5<sup>th</sup> Floor | 13,677 SF  
 Full Floor Opportunity  
 Plug & Play with furniture in place  
 High ceilings and great natural light

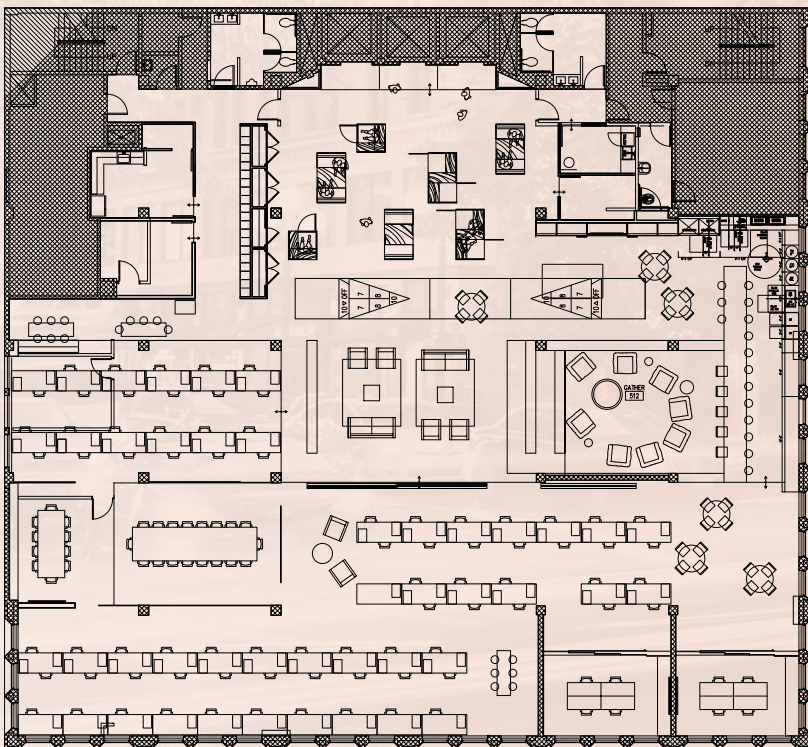

PIKE STREET

5TH AVENUE



**Shower/locker**  
facilities



**Secured**  
Bike storage



**Updated**  
Elevator cabs



**Efficient**  
floor plates



**Within blocks**  
of transit



**Convenient**  
access to major  
arterials



**Steps from a**  
variety of dining  
and retail options



**Modern lobby**  
redesign



[Click here to view virtual tour!](#)

---

# PHOTO GALLERY



STRATEGICALLY LOCATED IN THE HEART OF SEATTLE'S DOWNTOWN RETAIL CORE

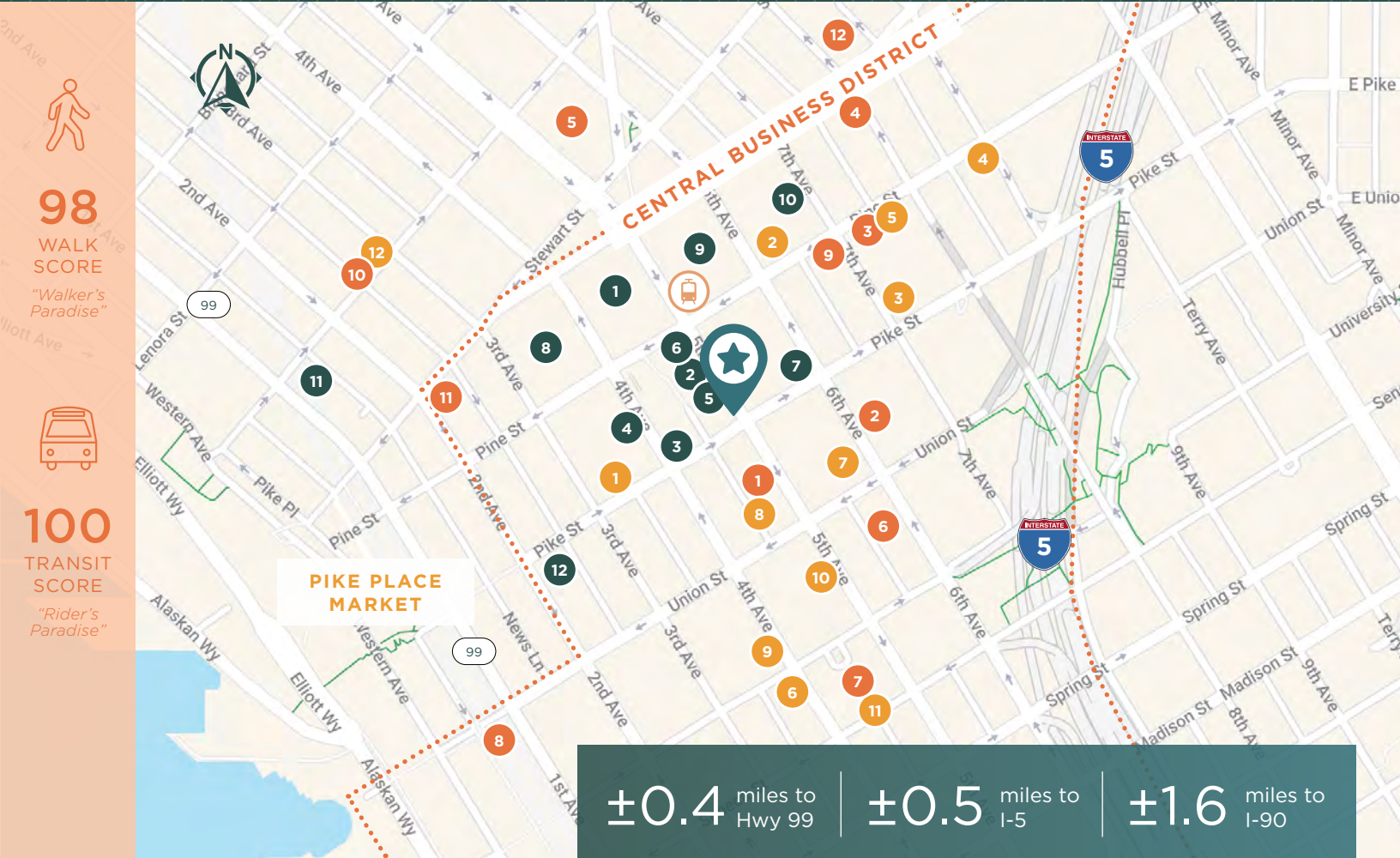

**98**  
WALK SCORE  
"Walker's Paradise"



**100**  
TRANSIT SCORE  
"Rider's Paradise"

**LOCATION OVERVIEW**



**1505 FIFTH AVENUE**

RETAIL	
1.	Westlake Center
2.	Anthropologie
3.	Arc'teryx
4.	Dr. Martens
5.	Urban Outfitters
6.	AllSaints
7.	The North Face Pike Street
8.	UNIQLO Pine Street
9.	Nordstrom
10.	Tiffany & Co.
11.	Herman Miller
12.	KÜHL

DINING	
1.	Yard House
2.	Din Tai Fung
3.	The Cheesecake Factory
4.	Dough Zone™
5.	Ruth's Chris Steak House
6.	Purple Cafe and Wine Bar
7.	Jimmy John's
8.	Elephant & Castle
9.	The Capital Grille
10.	The Fonte Bar
11.	The George
12.	Shaker + Spear

HOTELS	
1.	Hilton Motif
2.	Sheraton Grand
3.	Grand Hyatt Seattle
4.	Hyatt At Olive 8
5.	The Westin
6.	Washington Athletic Club
7.	Fairmont Olympic
8.	Four Seasons
9.	Hotel Theodore
10.	Kimpton Palladian
11.	The Charter
12.	Hyatt Regency

**FOR DETAILS CONTACT:**

**Leah Masson**  
Senior Director  
+1 206 215 9803  
leah.masson@cushwake.com

**Brandon Burmeister**  
Senior Director  
+1 206 215 9702  
brandon.burmeister@cushwake.com



©2024 Cushman & Wakefield. All rights reserved. The information contained in this communication is strictly confidential. This information has been obtained from sources believed to be reliable but has not been verified. NO WARRANTY OR REPRESENTATION, EXPRESS OR IMPLIED, IS MADE AS TO THE CONDITION OF THE PROPERTY (OR PROPERTIES) REFERENCED HEREIN OR AS TO THE ACCURACY OR COMPLETENESS OF THE INFORMATION CONTAINED HEREIN, AND SAME IS SUBMITTED SUBJECT TO ERRORS, OMISSIONS, CHANGE OF PRICE, RENTAL OR OTHER CONDITIONS, WITHDRAWAL WITHOUT NOTICE, AND TO ANY SPECIAL LISTING CONDITIONS IMPOSED BY THE PROPERTY OWNER(S). ANY PROJECTIONS, OPINIONS OR ESTIMATES ARE SUBJECT TO UNCERTAINTY AND DO NOT SIGNIFY CURRENT OR FUTURE PROPERTY PERFORMANCE.