

# 39600 Eureka Drive

Newark, CA



## 13,581 SF R&D/Lab Space For Lease

FOR MORE INFORMATION, CONTACT:

**Jeff Powers**  
Managing Director  
+1 510 891 5821  
[jeff.powers@cushwake.com](mailto:jeff.powers@cushwake.com)

**Michael Karp**  
Managing Director  
+1 510 813 0113  
[michael.karp@cushwake.com](mailto:michael.karp@cushwake.com)



**CUSHMAN &  
WAKEFIELD**



# PROPERTY FEATURES



**13,581 SF**



**ABUNDANT  
POWER**



**PRIVATE ENTRANCE  
AND LOBBY**



**PRIVATE OUTDOOR SEATING  
& BREAK AREA**



**LARGE BREAKROOM  
WITH KITCHEN AREA**



**AVAILABLE  
IMMEDIATELY**



**\$1.75 PSF NNN**



**3.8/1,000  
PARKING RATIO**

# SITE PLAN

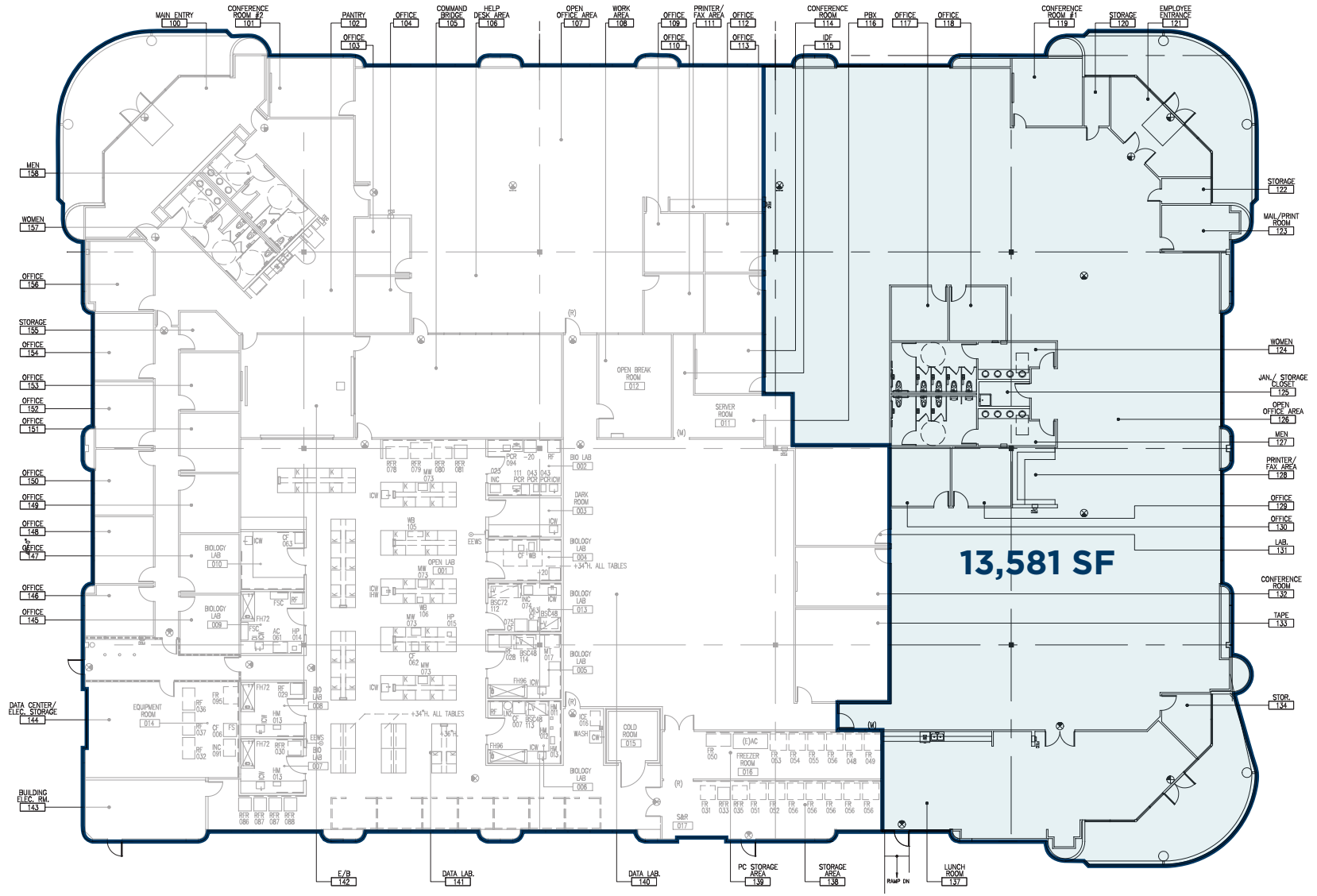

# SUITE FLOOR PLAN

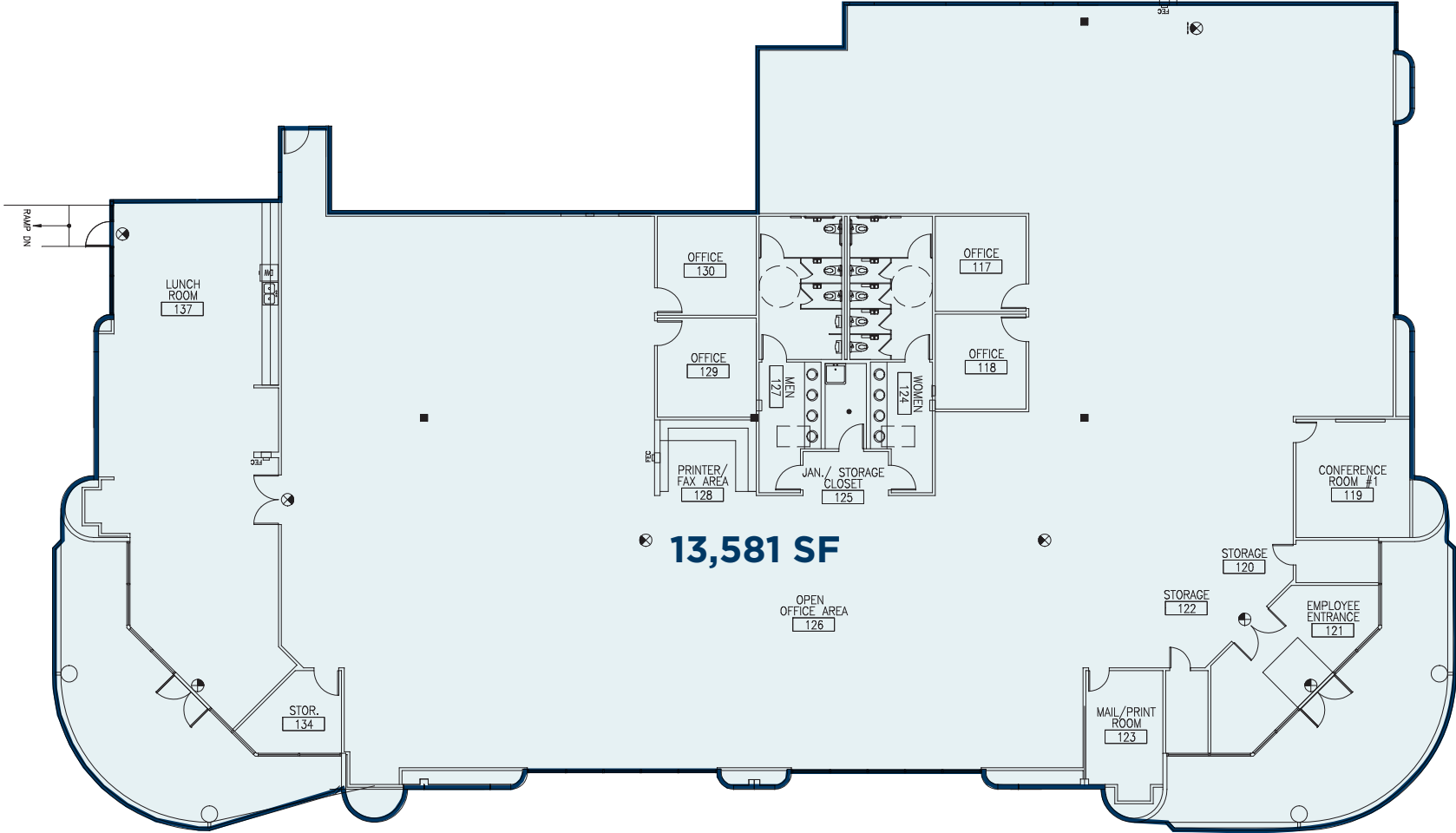



# PROPERTY IMAGES



OPEN LAYOUT







**FOR MORE INFORMATION, CONTACT:**

**Jeff Powers**  
Managing Director  
+1 510 891 5821  
[jeff.powers@cushwake.com](mailto:jeff.powers@cushwake.com)

**Michael Karp**  
Managing Director  
+1 510 813 0113  
[michael.karp@cushwake.com](mailto:michael.karp@cushwake.com)

555 12th Street, Suite 100  
Oakland, CA 94607-4061  
+1 510 465 8000  
[cushmanwakefield.com](http://cushmanwakefield.com)