

INDUSTRIAL SPACE**2,700 SF INDUSTRIAL SPACE FOR LEASE**

Lease Rate: \$11.00/SF NNN

NNN: \$4.28/SF

This is a clean industrial space with approximately 15% office finish which is heated and fully sprinkled, has a abundant lighting, and 14' clear height in the warehouse with 3-phase power available. A 12' x 14' overhead door provides great access to the unit from the north elevation. Mezzanine storage (with three-quarter inch plywood decking) is available above the offices at no additional cost. Building offers multiple configurations, easy access for semi trucks, great parking on south side and building signage above each unit. *Please see reverse for aerial and floor plan.*

PROPERTY FEATURES

Available Size	2,700 SF
Clear Height	14'
Power	220 Volt, 3 phase
Zoning	I, Industrial
Loading	12' x 14' Drive-in door
Storage	Outside storage available with landlord's approval of use



1318 DUFF DRIVE

FORT COLLINS, COLORADO 80524

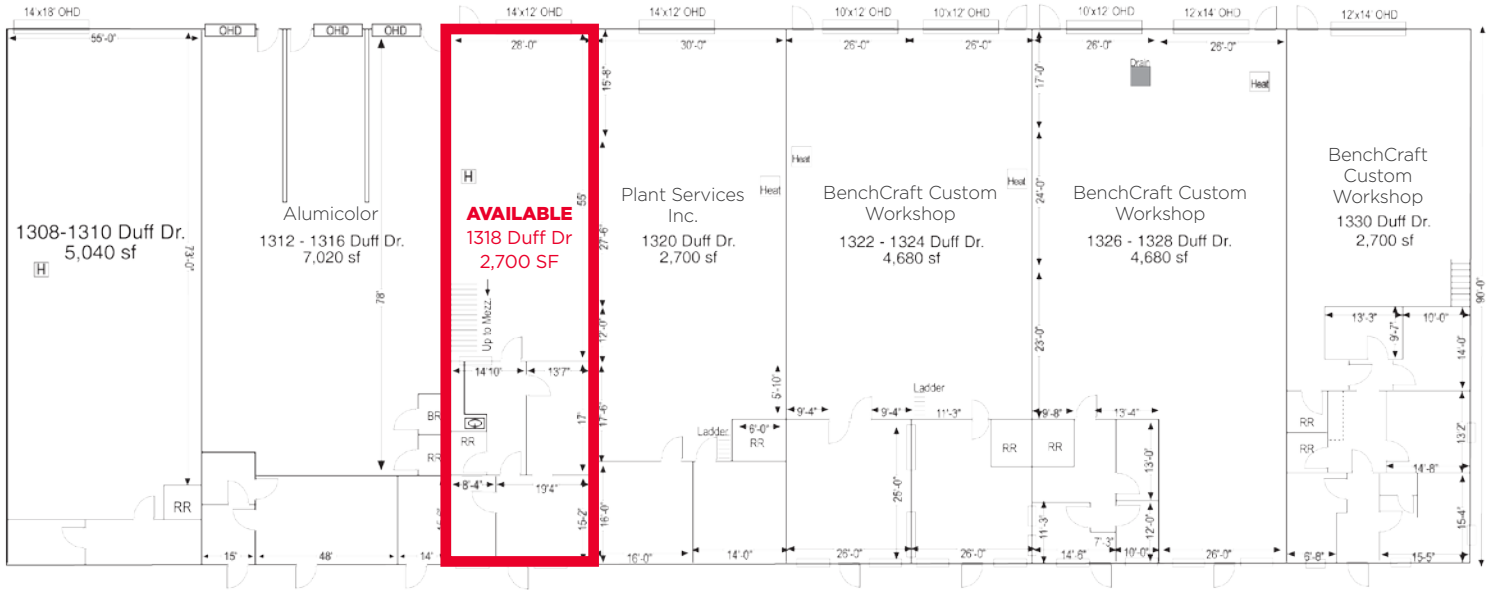

For more information, please contact:

JASON ELLS, CCIM
Senior Director
 +1 970 231 7513
 jason.ells@cushwake.com

CHASE CHRISTENSEN
Senior Associate
 +1 970 217 6382
 chase.christensen@cushwake.com

772 Whalers Way, Suite 200
 Fort Collins, Colorado 80525

T +1 970 776 3900
 F +1 970 267 7419

cushmanwakefield.com