

RETAIL FOR LEASE



30 CHARLES STREET WEST

University of Toronto Residences at Yonge & Bloor

1,964 SF at Balmuto & Charles | Great Value Retail
Space in Toronto's Densest Residential Node



Balmuto Street Frontage

WELCOME TO 30 CHARLES ST W.

Located at the transition point between Bloor-Yorkville, Downtown Yonge, the Bay Street Corridor and U of T, 30 Charles St. W. leaves you just 100 meters south of Mink Mile, but at small fraction of the neighborhood rents. With the Manulife Centre directly across the street, this unit puts you in the middle of the action, with signage and at grade level - with tremendous value. Located at the base of a University of Toronto residence building.

Details

SIZE	1,964 SF
NET RENT	\$45.00 PSF
ADDITIONAL RENT	\$19.48 PSF (2024 Est.)
TERM	5-10+ Years
AVAILABLE	Immediate

Highlights

- 100 AMP Electrical Panel
- Neighboring tenants include LCBO, Earls, Pearl Yorkville, Eataly and more.
- Clean uses preferred
- 2 outside entrances, one with double doors
- High ceilings throughout
- Suitable for various service, retail, and medical uses
- Rear shipping/receiving and garbage room

AMENITIES MAP

AMENITIES

- 1 Jack Astor's Bar and Grill
- 2 Starbucks
- 3 Café Landwer
- 4 Chick Fill-A
- 5 Pizzaiolo
- 6 Ginger Vietnamese
- 7 Naan Kabob
- 8 BBQ Chicken
- 9 Modern Cuisine
- 10 Saigon Lotus on Yonge
- 11 Toro Toro Sushi and Poke
- 12 Nani's Gelato
- 13 Shoppers Drug Mar
- 14 7 West Cafe
- 15 JouMak Korean
- 16 Pearl Yorkville Chinese Cuisine
- 17 Korean Grill House
- 18 Mogouyan Hand Pulled Noodles
- 19 More Natas Please
- 20 Holt Renfrew
- 21 Planta
- 22 The Momo House
- 23 Eataly Toronto
- 24 Cineplex Cinemas
- 25 Earls Kitchen & Bar
- 26 Indigo
- 27 Manulife Centre



Demographics

(5km radius)



Population
693,012



Daytime Population
1,181,892



Avg. Household Income
\$130,334



Daily Traffic Count
26,929



Daily Pedestrian Count
17,242



Transit Score
92

FLOOR PLANS

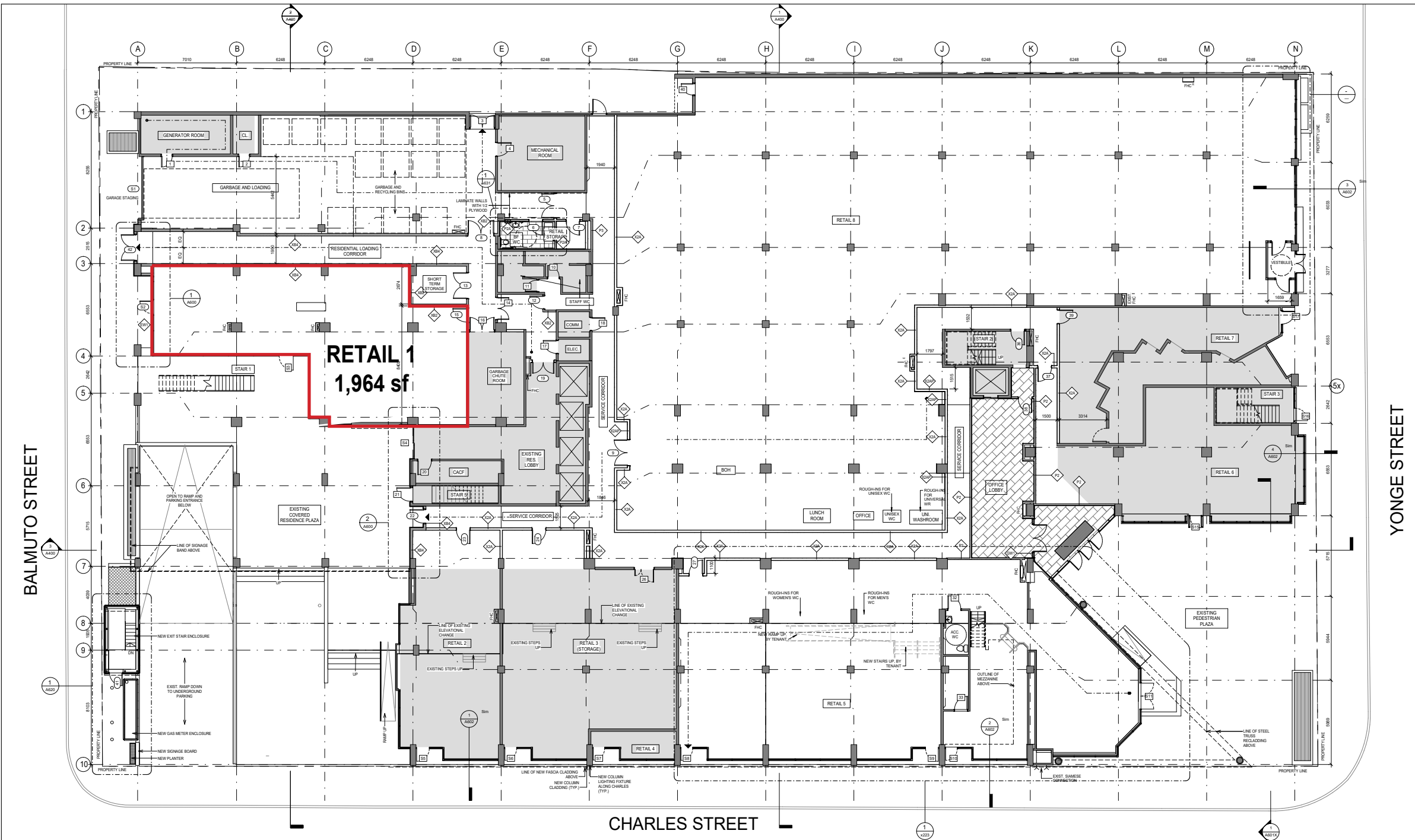

BALMUTO STREET

YONGE STREET

CHARLES STREET



161 Bay Street, Suite 1500
Toronto, ON M5J 2S1 | Canada

MICHAEL BETEL*

Vice President
Retail Services

+1 416 359 2706
michael.betel@cushwake.com

©2024 Cushman & Wakefield ULC. All rights reserved. The information contained in this communication is strictly confidential. This information has been obtained from sources believed to be reliable but has not been verified. NO WARRANTY OR REPRESENTATION, EXPRESS OR IMPLIED, IS MADE AS TO THE CONDITION OF THE PROPERTY (OR PROPERTIES) REFERENCED HEREIN OR AS TO THE ACCURACY OR COMPLETENESS OF THE INFORMATION CONTAINED HEREIN, AND SAME IS SUBMITTED SUBJECT TO ERRORS, OMISSIONS, CHANGE OF PRICE, RENTAL OR OTHER CONDITIONS, WITHDRAWAL WITHOUT NOTICE, AND TO ANY SPECIAL LISTING CONDITIONS IMPOSED BY THE PROPERTY OWNER(S). ANY PROJECTIONS, OPINIONS OR ESTIMATES ARE SUBJECT TO UNCERTAINTY AND DO NOT SIGNIFY CURRENT OR FUTURE PROPERTY PERFORMANCE. *Sales Representative *Broker