



CHELSEA - LADIES' MILE SHORT TERM RETAIL OPPORTUNITY

695

AVENUE OF THE AMERICAS

BETWEEN WEST 22ND STREET AND WEST 23RD STREET

695 Avenue of the Americas

West block between West 22nd Street and West 23rd Street

POSSESSION: June 1, 2024

TERM: Short Term – Negotiable Through Q2 2025

LEASE TYPE: Direct

ASKING RENT: Upon Request

SIZE: Ground Floor: 1,180 SF
Lower Level: 11,162 SF
Total: 12,342 SF*
*Size is approximate

FRONTAGE: 20 Feet on Sixth Avenue

NEIGHBORING RETAILERS & RESTAURANTS: Trader Joe's, Chick-fil-A, CAVA, Best Buy, Michael's, Blick Art Materials, Staples, The Container Store, Marshalls, Starbucks, Dos Toros

HIGHLIGHTS:

- Prime short-term opportunity along Ladies' Mile at the intersection of Chelsea and Flatiron – a bustling shopping/dining/professional corridor with abundant vehicular and pedestrian traffic
- Steps from the 23rd Street F/M and PATH stations and one block from N/R and 1 trains at the base of a well-maintained office building
- Excellent national retailer co-tenancy
- Vertical transportation from dedicated, double-height Ground Floor entry on Sixth Avenue
- Selling Lower Level with high ceilings, currently built as DXL
- Ability to utilize the off-Avenue building loading dock and freight elevator
- All quality dry uses considered



FLOOR PLANS

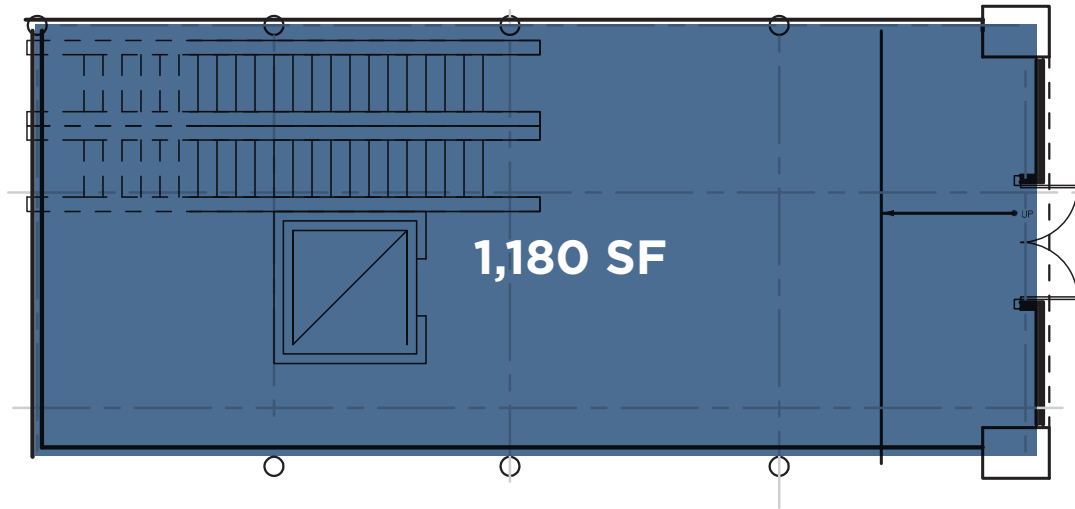

Avenue of the Americas

GROUND FLOOR

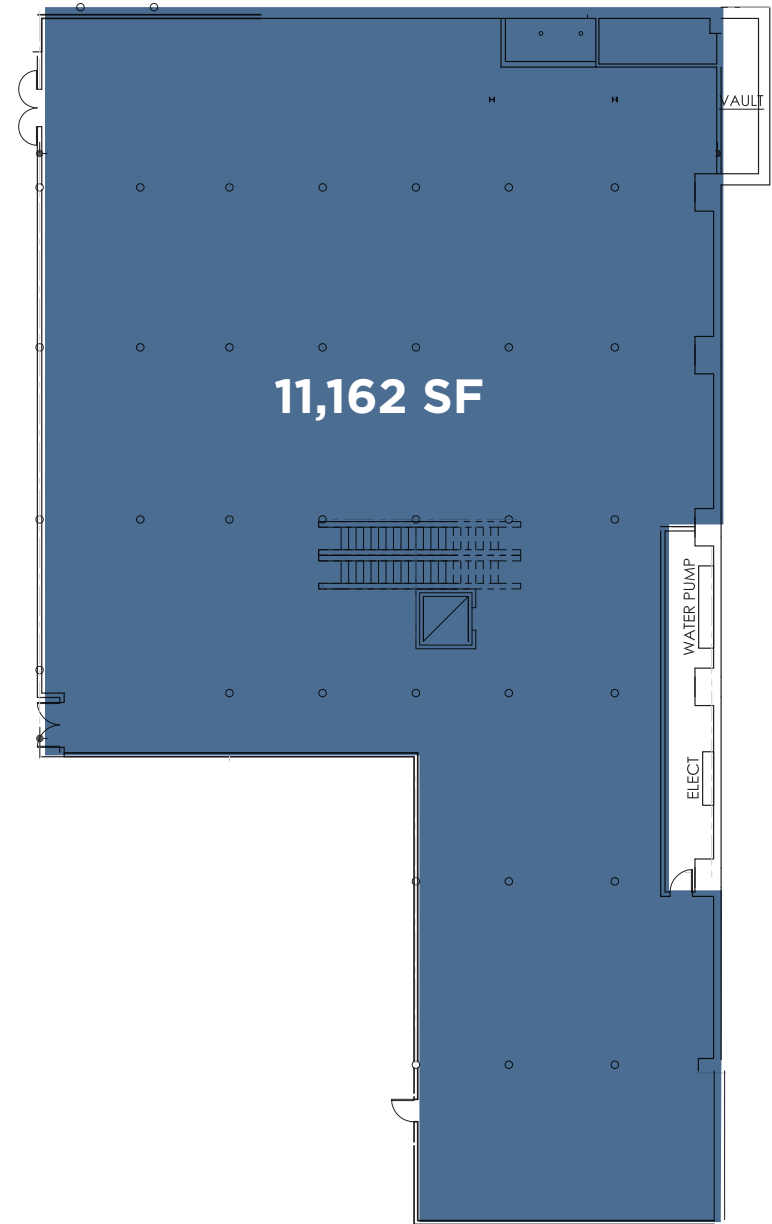

LOWER LEVEL

EXISTING INTERIOR





CONTACT:

SEAN MORAN

sean.moran@cushwake.com

+1 212 841 7668

STEVEN SOUTENDIJK

steven.soutendijk@cushwake.com

+1 212 713 6845

ALAN SCHMERZLER

alan.schmerzler@cushwake.com

+1 212 841 5930

PATRICK O'ROURKE

patrick.orourke@cushwake.com

+1 212 660 7777

CATHERINE MERCK

catherine.merck@cushwake.com

+1 212 698 2621



©2024 Cushman & Wakefield. All rights reserved. The information contained in this communication is strictly confidential. This information has been obtained from sources believed to be reliable but has not been verified. NO WARRANTY OR REPRESENTATION, EXPRESS OR IMPLIED, IS MADE AS TO THE CONDITION OF THE PROPERTY (OR PROPERTIES) REFERENCED HEREIN OR AS TO THE ACCURACY OR COMPLETENESS OF THE INFORMATION CONTAINED HEREIN, AND SAME IS SUBMITTED SUBJECT TO ERRORS, OMISSIONS, CHANGE OF PRICE, RENTAL OR OTHER CONDITIONS, WITHDRAWAL WITHOUT NOTICE, AND TO ANY SPECIAL LISTING CONDITIONS IMPOSED BY THE PROPERTY OWNER(S). ANY PROJECTIONS, OPINIONS OR ESTIMATES ARE SUBJECT TO UNCERTAINTY AND DO NOT SIGNIFY CURRENT OR FUTURE PROPERTY PERFORMANCE.