





450 JOHNSON AVENUE, BROOKLYN, NEW YORK  
Brooklyn Logistics Center 1



20,000 SF Industrial Space + 5k Yard for Lease

# Building Specifications

- 20,000 SF available with build-to-suit office
- 5,000 SF yard
- One interior recessed loading position
- 12'-16' clear height
- 20' x 48'-8" column spacing
- Paved and fenced parking lot and street parking available
- M1-2 zoning

-  Available
-  Leased
-  Non-Prologis Building
-  Dock Door
-  Drive-in Door

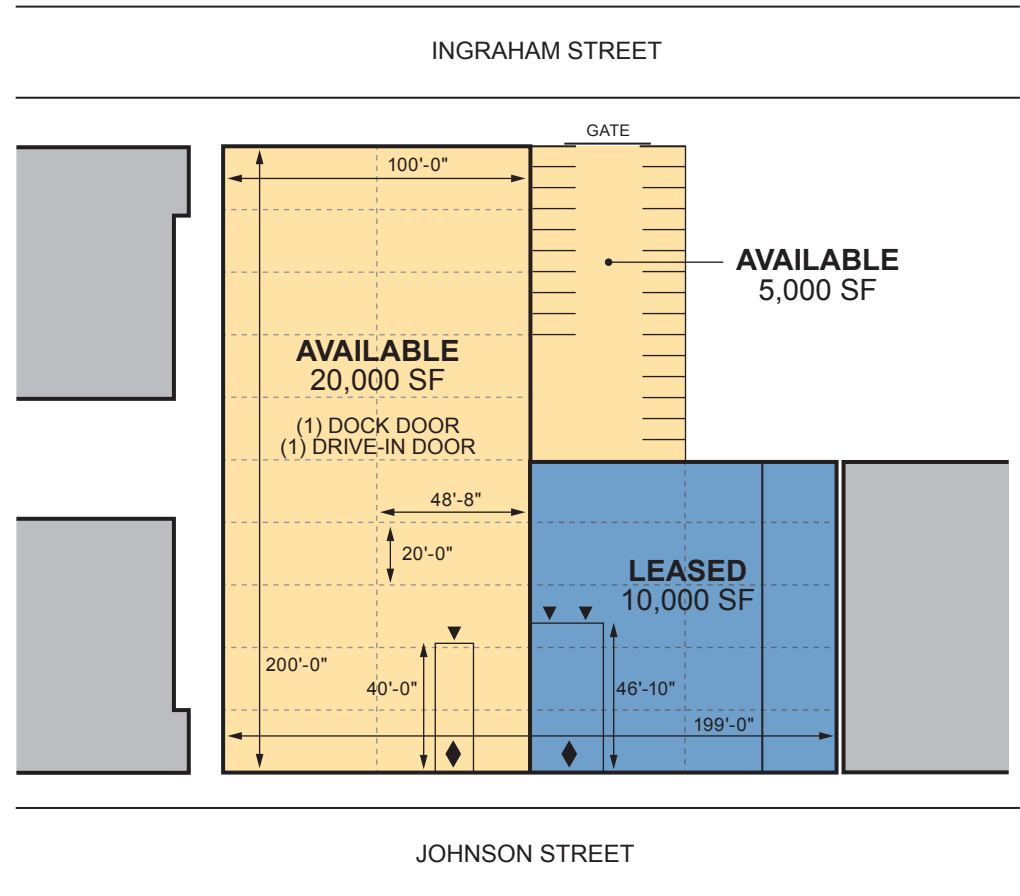

## Population

	Total Population	Total Daytime Population
<b>1 MILE »</b>	133,560	102,562
<b>3 MILES »</b>	1,084,796	885,625
<b>5 MILES »</b>	3,341,506	4,713,600



## Household Income

	Median	Average	Per Capita
<b>1 MILE »</b>	\$49,767	\$73,975	\$26,760
<b>3 MILES »</b>	\$56,802	\$84,554	\$32,909
<b>5 MILES »</b>	\$68,855	\$111,916	\$46,621



450 JOHNSON AVENUE, BROOKLYN, NEW YORK

# Prime Location

- Less than three miles to Manhattan
- Easy access to the E or L subway line and B57 and B60 buses
- Walking distance from Morgan, Montrose and Flushing Avenues

# Brooklyn Logistics Center 1

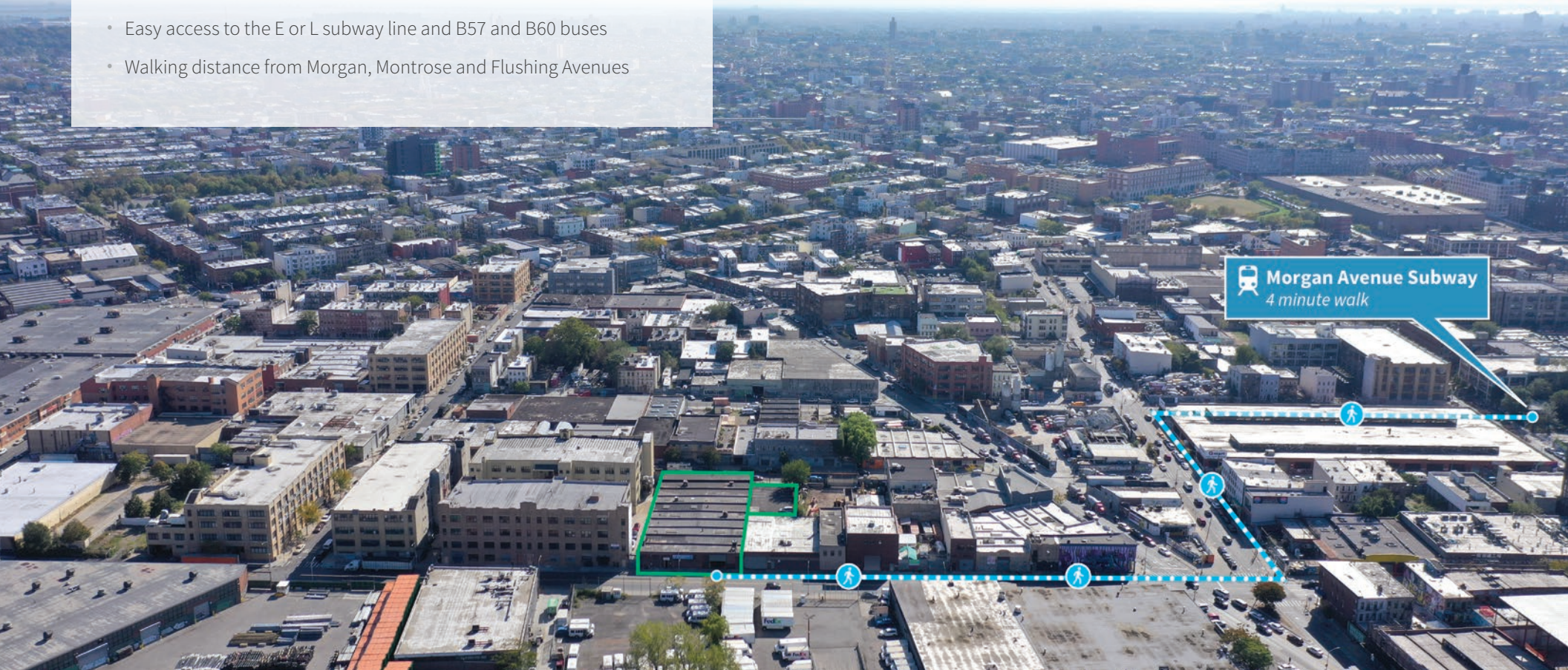

## Education (Population ages 25+)

AA Degree	BA/BS Degree	PhD Degree	H.S. Grad, GED or Alternative	MA/MS Degree	Professional School Degree	Some College, 1+ Yrs, No Degree	Some College, <1 Yr	Total Pop. 25+
3,878	20,115	221	21,934	6,828	849	9,120	2,837	93,140
44,232	170,946	5,941	188,695	72,644	15,095	76,744	28,916	753,765
131,056	624,373	40,540	540,589	301,655	99,532	224,656	74,291	2,426,105





Studio

Art

Restaurant

Bar

Retail



**Rico Murtha**  
 Managing Director  
 Direct: +1 212 390 1369  
 rico.murtha@cushwake.com

**Helen Paul**  
 Managing Director  
 Direct: +1 617 694 9967  
 helen.paul@cushwake.com



**Andrew Forsyth**  
 VP, Leasing Officer  
 Direct: +1 201 528 9575  
 aforsyth@prologis.com

**Prologis - NY/NJ**  
 461 5th Avenue, 21st Floor  
 New York, NY 10017  
 Main: +1 201 635 6000

**Prologis Headquarters**  
 Pier 1, Bay 1  
 San Francisco, CA 94111  
 Main: +1 415 394 9000  
 info@prologis.com

www.prologis.com  
 NYSE: PLD

Prologis is the world's largest owner, operator, and developer of logistics real estate with approximately 1.2 billion square feet owned and under management in 19 countries on four continents. We lease modern logistics facilities to a diverse base of approximately 6,700 customers principally across two major categories: business-to-business and retail/online fulfillment.

Data as of June 30, 2023, for assets the company owned or had investments in, on a wholly owned basis or through co-investment ventures, properties and development projects.

PLD\_PBLCB\_102923