



1 Park Place

DUBLIN, CA

CUSHMAN &
WAKEFIELD

±56,549 SQUARE FOOT

PLUG & PLAY OPPORTUNITY





Opportunity Highlights

1 Park Place boasts conveniences that make your workday a breeze, like ample parking, walkable amenities, and high-end, on-site tenant-exclusive amenities. This exciting Class A sublease opportunity within the business park offers approximately 56,549 square feet across two expansive floors and is fully furnished and equipped, allowing users to quickly set up shop without the hassle of installation or additional setup.

// ±56,549 SF ACROSS TWO FLOORS

// LED: 11/30/2026

// LAB & LASER TESTING AREA

// 2.74/1,000 SF PARKING RATIO

// TENANT FITNESS & CONFERENCE CENTERS

// WALKING DISTANCE TO RETAIL & TRANSIT



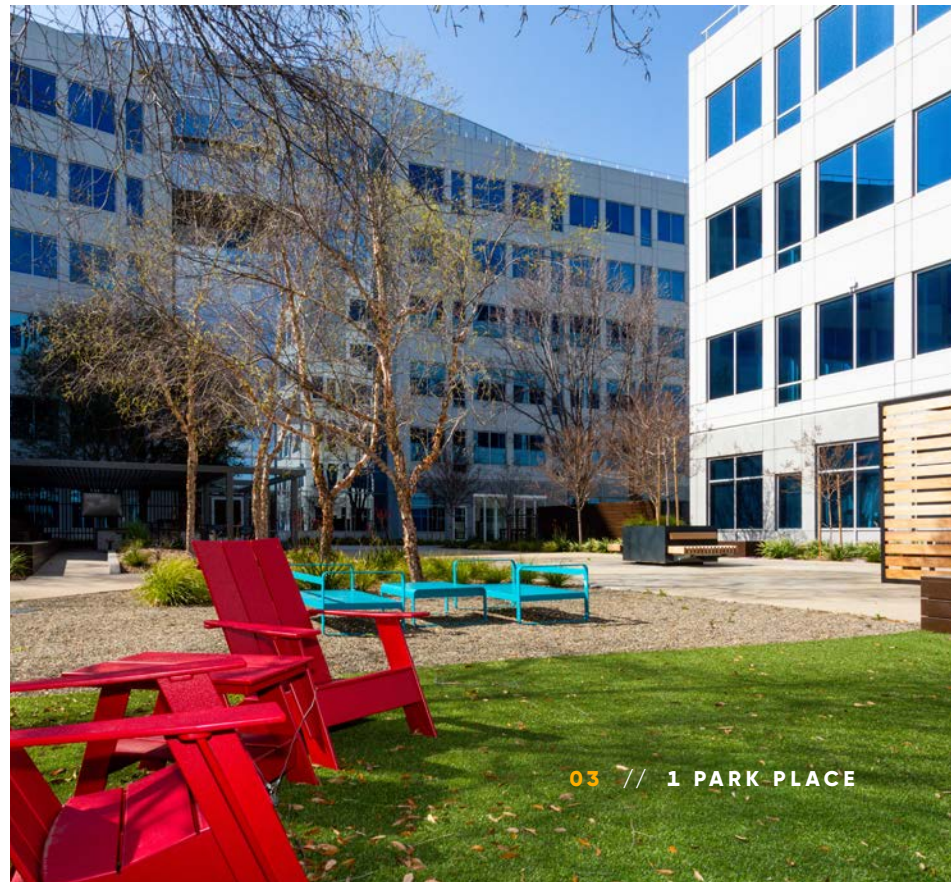

Floor Plans

// 1ST FLOOR

// ±20,890 SF

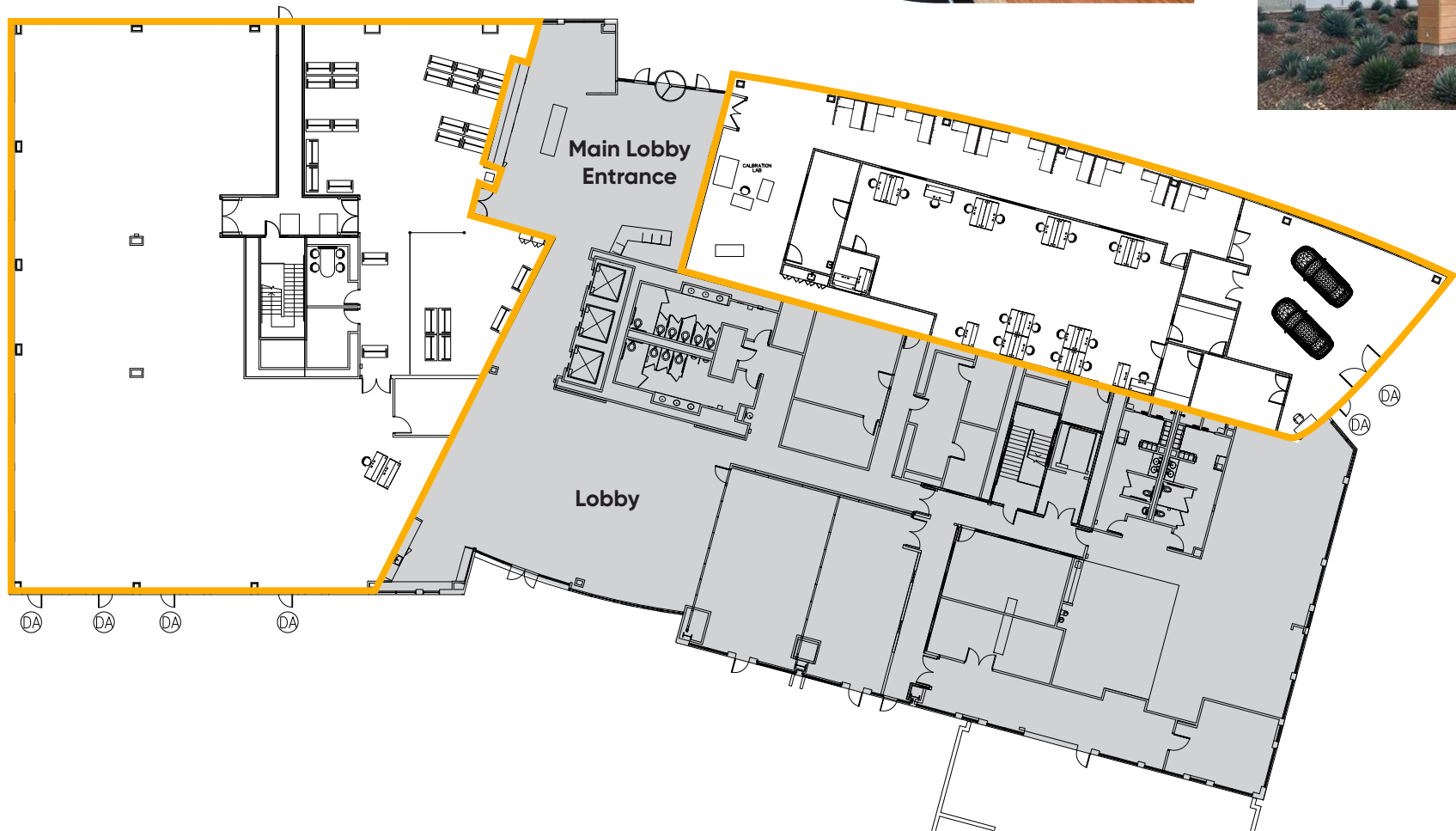

Floor Plans

// 2ND FLOOR

// ±35,659 SF



Amenities

DUBLIN

// PERSIMMON PLACE

CAFES/RESTAURANTS

- Chipotle
- Habit Burger
- Nick the Greek
- Pacific Catch
- Patxi's Pizza & Bar
- Starbucks
- Urban Plates

RETAIL

- Ethan Allen
- HomeGoods
- Nordstrom Rack
- Orangetheory Fitness
- Sephora
- Whole Foods
- Verizon Wireless

15-MIN WALK

SITE

// HACIENDA CROSSING

CAFES/RESTAURANTS

- Applebee's
- Cherie's Southern Kitchen
- Five Guys
- Ike's Love & Sandwiches
- Jamba Juice
- Lazy Dog Restaurant/Bar
- Market Tavern
- Roadtrip Bowls
- Sri Thai
- Star Chaat Cuisine

RETAIL

- Barnes & Noble
- Barons
- Best Buy
- Cox Family Store
- Five Below
- Old Navy
- PGA Tour Superstore
- Regal Hacienda Crossing
- Shell
- Spirit Halloween
- T.J. Maxx
- Tilly
- Ulta Beauty
- World of Beer

LODGING

- Hyatt Place

DUBLIN/PLEASANTON
BART STATION

PERSIMMON
PLACE

HACIENDA
CROSSINGS

OWENS DR

METRO
580

// METRO 580

CAFES/RESTAURANTS

- Arusuvai Virunthu
- McDonald's

RETAIL

- Kohl's
- Party City
- Walmart Supercenter

GATEWAY SQUARE
SHOPPING CENTER

STONERIDGE DR

// GATEWAY SQUARE SHOPPING CENTER

CAFES/RESTAURANTS

- AappaKadai
- Annachikadai
- Bentolicious
- Chili's Grill & Bar
- Curry Kona
- Gobi
- Honey Baked Ham Company
- La Michoacana
- Mavericks
- Starbucks
- Subway Sandwiches

LODGING

- Courtyard by Marriott
- Extended Stay
- Four Points by Sheraton
- Hyatt House

RETAIL

- AT&T Store
- Chase Bank
- Marzel's
- The UPS Store
- Wells Fargo

PLEASANTON



1 Park Place

DUBLIN, CA



// MIKE DREW

Executive Director
+1 408 355 4820
michael.drew@cushwake.com
LIC #01900650

// MARK MOSER

Vice Chairman
+1 650 619 9446
mark.moser@cushwake.com
LIC #01052881

// BRIAN WILSON

Director
+1 925 274 2814
brian.r.wilson@cushwake.com
LIC #02053208