

FOR SUBLEASE

90 CRANLEIGH DRIVE SE

UNIT 7 | 750 SF



Property Details

Available Space	Unit 7: 750 SF
Availability	August 1, 2024
Sublease Expiry	November 29, 2024
Operating Costs	\$24.64 psf (2024) *Utilities are separately metered and not included
Parking	Surface Parking

Property Highlights

- Neighbouring tenants include: Circle K, Western Pizza Express, Encompass Sports Therapy, Esso, and Glow Hair and Nails
- Proximate to multiple transit stops
- Ample parking available

DAVID LEES
Executive Vice President
Office Sales and Leasing
+1 403 261 1102
david.lees@cushwake.com

ADAM RAMSAY
Executive Vice President
Office Sales & Leasing
+1 403 261 1103
adam.ramsay@cushwake.com

TRENT PETERSON
Vice President
Office Sales & Leasing
+1 403 261 1101
trent.peterson@cushwake.com

Floor Plan

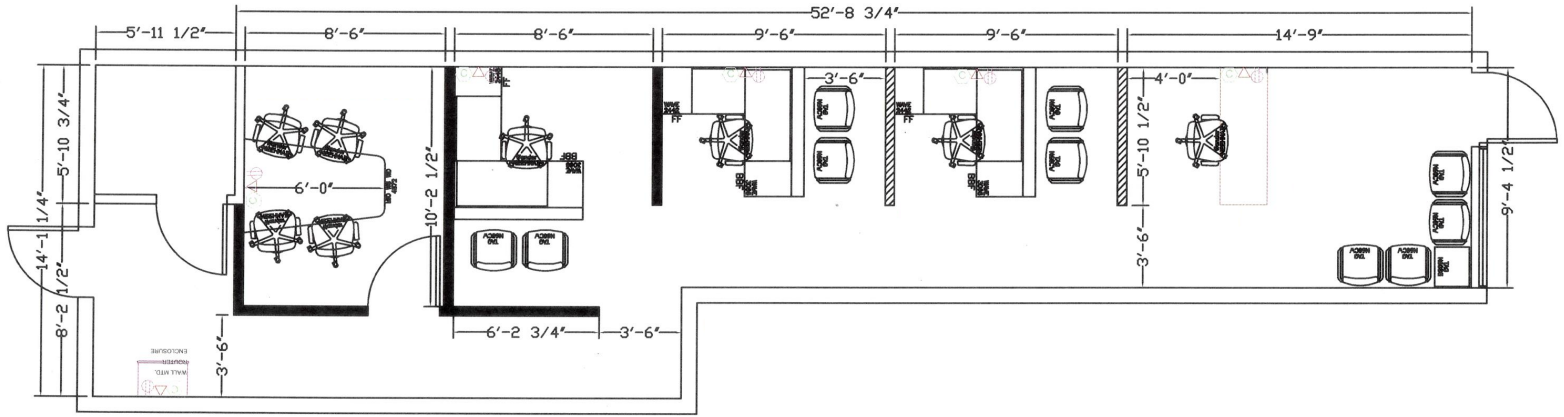

Area Map

