

6100 STEVENSON BOULEVARD

FREMONT, CA

±10,000 - ±116,780 SF FOR LEASE



DOLLINGER PROPERTIES



CUSHMAN & WAKEFIELD

6100 STEVENSON BOULEVARD

FREMONT, CA

PROPERTY HIGHLIGHTS

- Single Story Manufacturing Lab / R&D / Office Space
- Flexible Sizes from $\pm 10,000$ to $\pm 116,780$ SF
- Prominent Street Identity on Stevenson Blvd
- Exterior & Interior Market Ready Work Underway
- ± 19 - 22 Foot Clear Height
- 2,000 Amps per Building (Total of 6,000 Amps at 277/480)
- 100% HVAC & Fully Sprinklered
- Parking Ratio: $\pm 3.6/1000$
- Direct Access to I-880, I-680 & Hwy 84

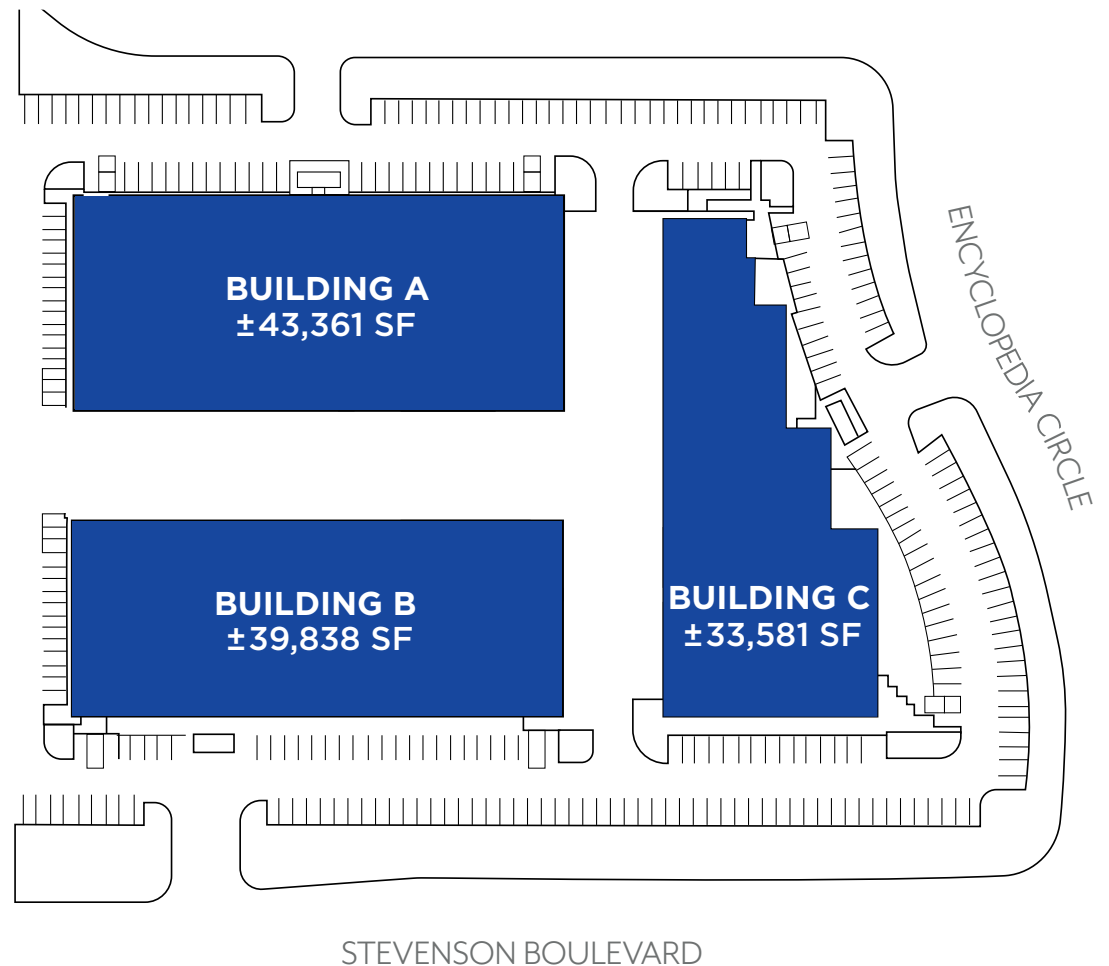

6100 STEVENSON BOULEVARD

FREMONT, CA

BUILDING A | ±43,361 SF

Divisible to ±10,000 SF

ENCYCLOPEDIA CIRCLE

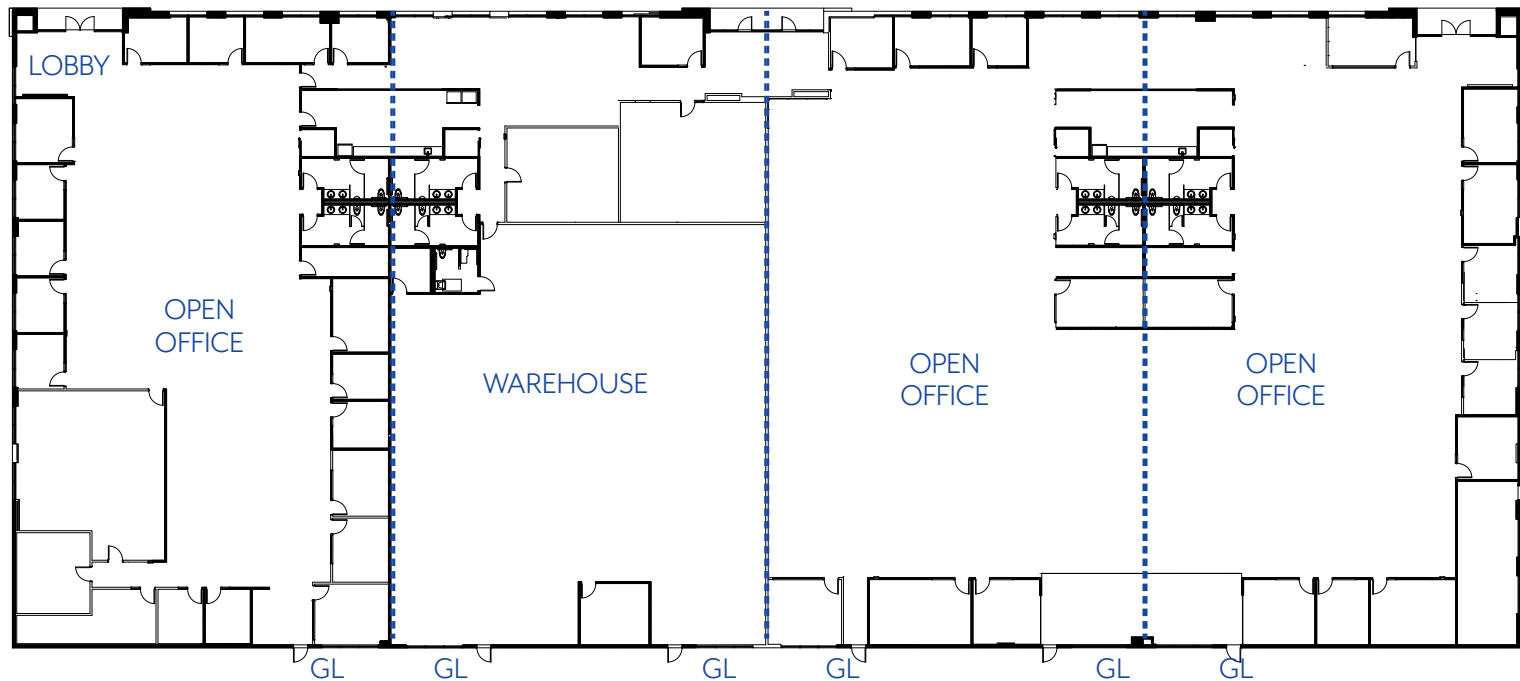

..... POTENTIAL DEMISING WALLS

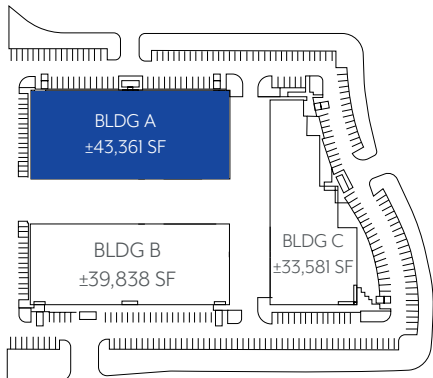

6100 STEVENSON BOULEVARD

FREMONT, CA

BUILDING B | ±39,838 SF

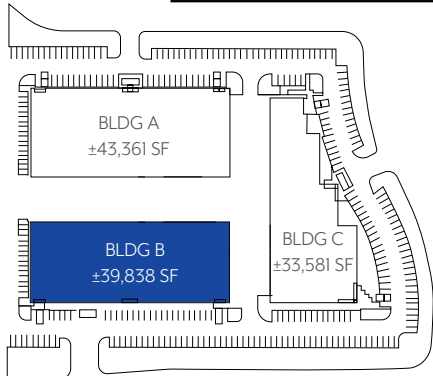
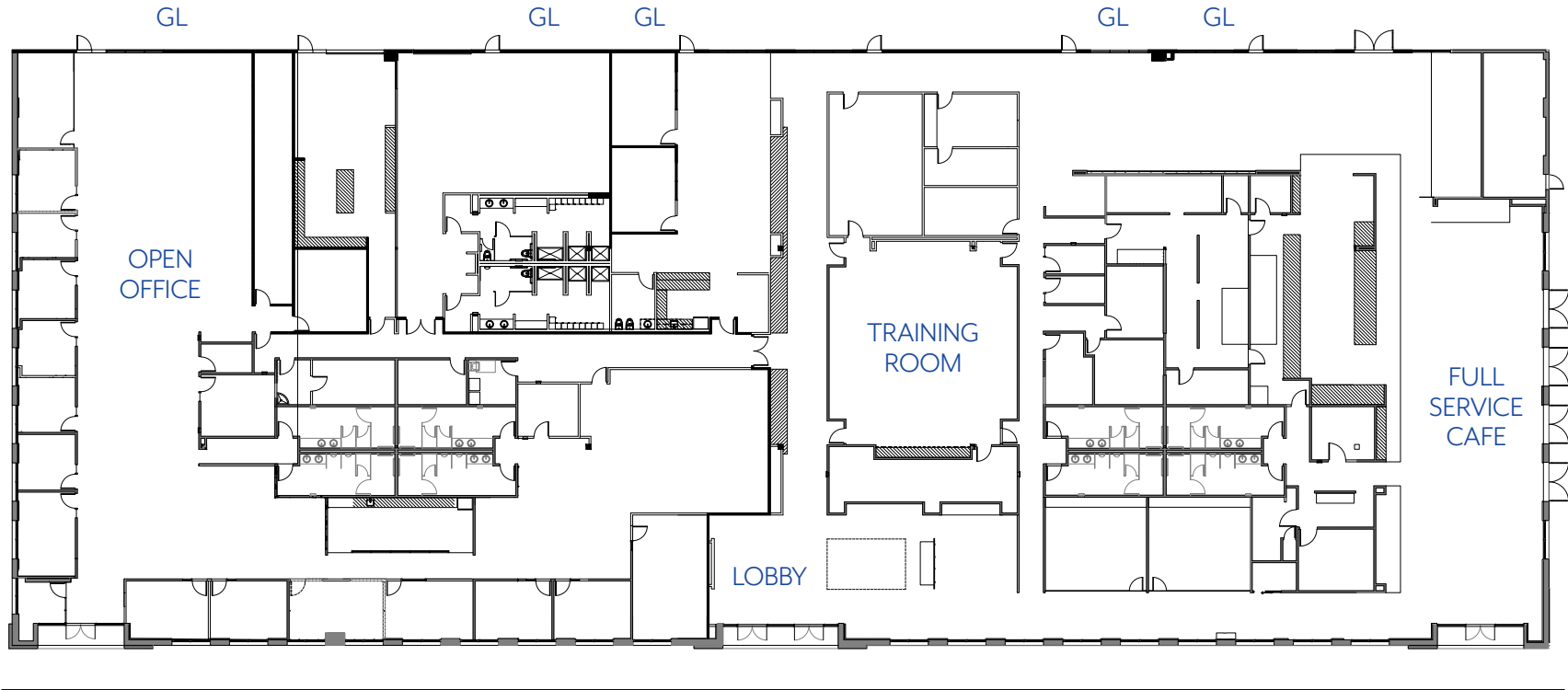

6100 STEVENSON BOULEVARD

FREMONT, CA

BUILDING C | ±33,581 SF

Divisible to ±16,000 SF

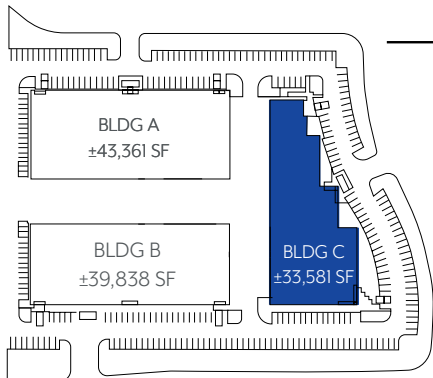
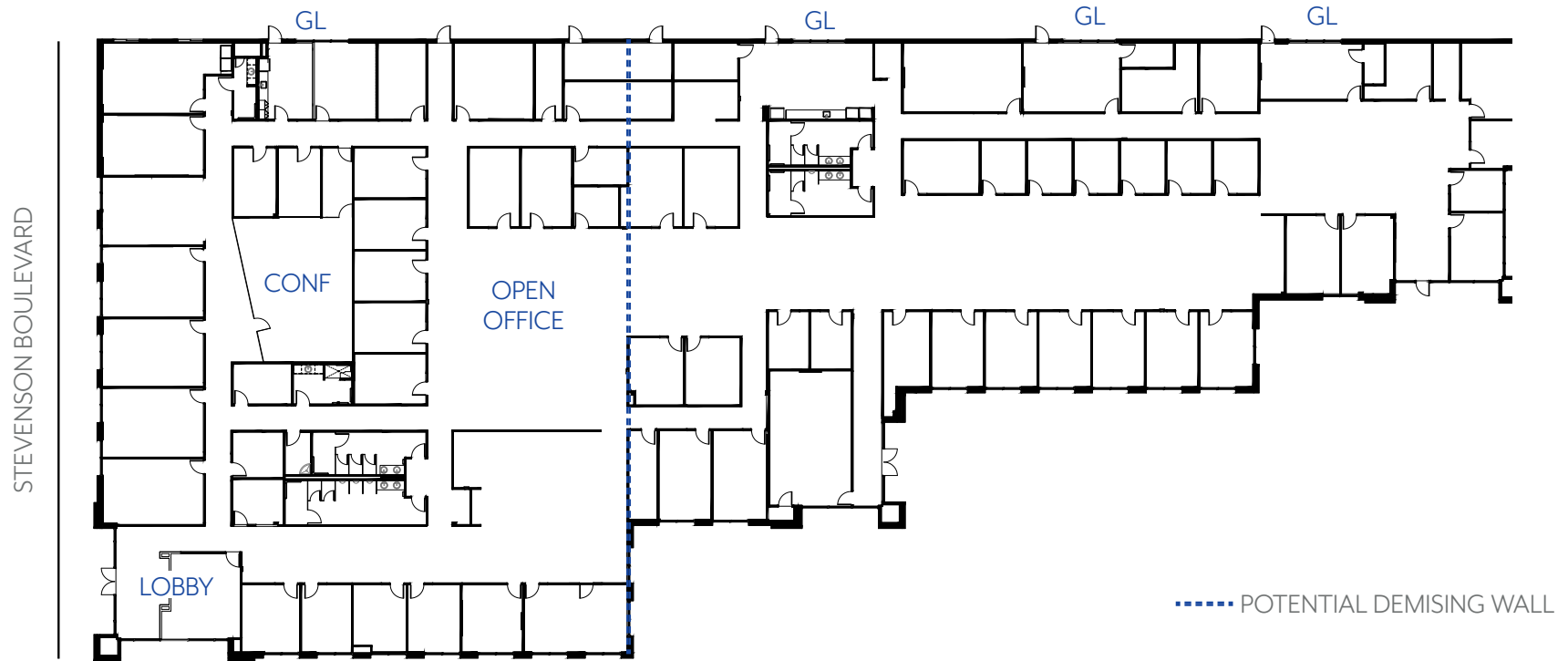

ENCYCLOPEDIA CIRCLE

6100 STEVENSON BOULEVARD

FREMONT, CA

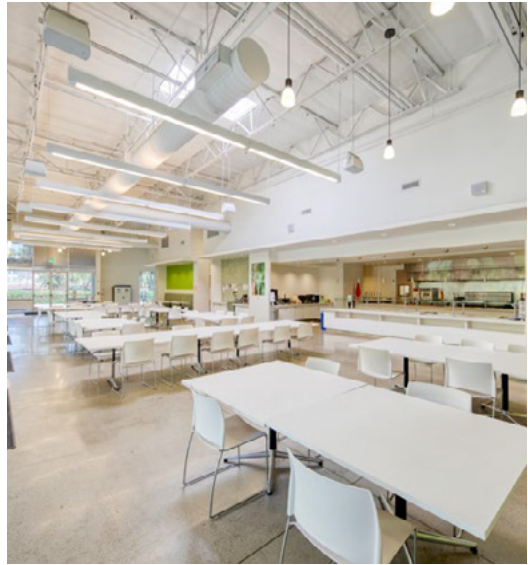
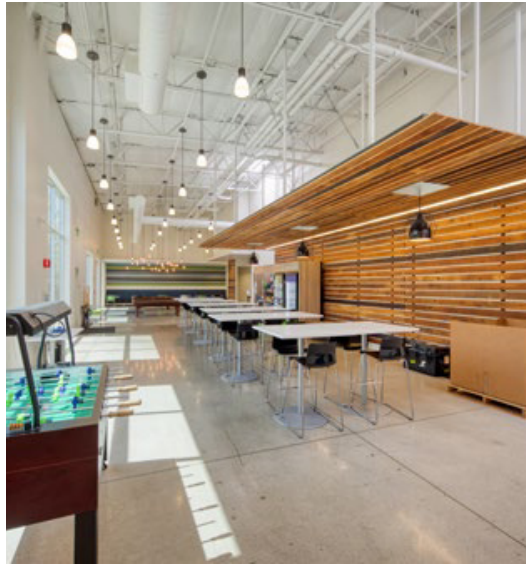
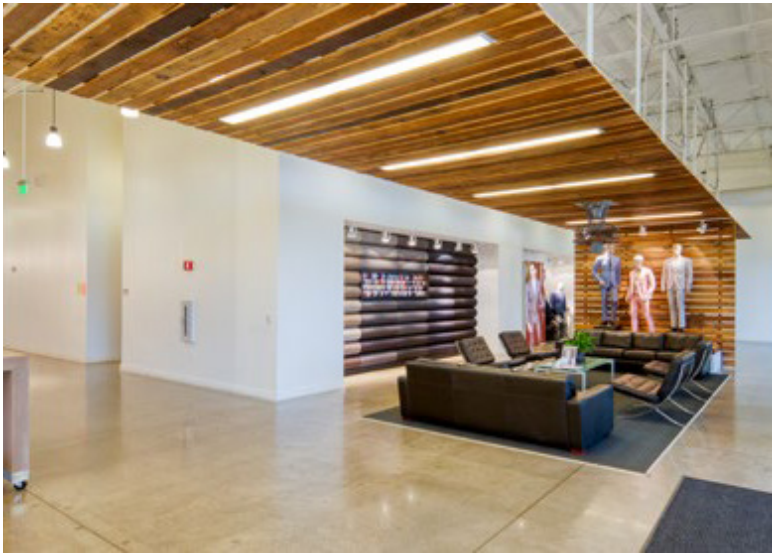
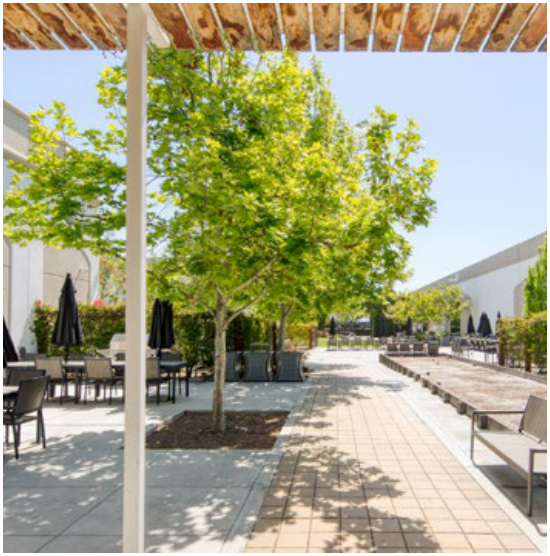

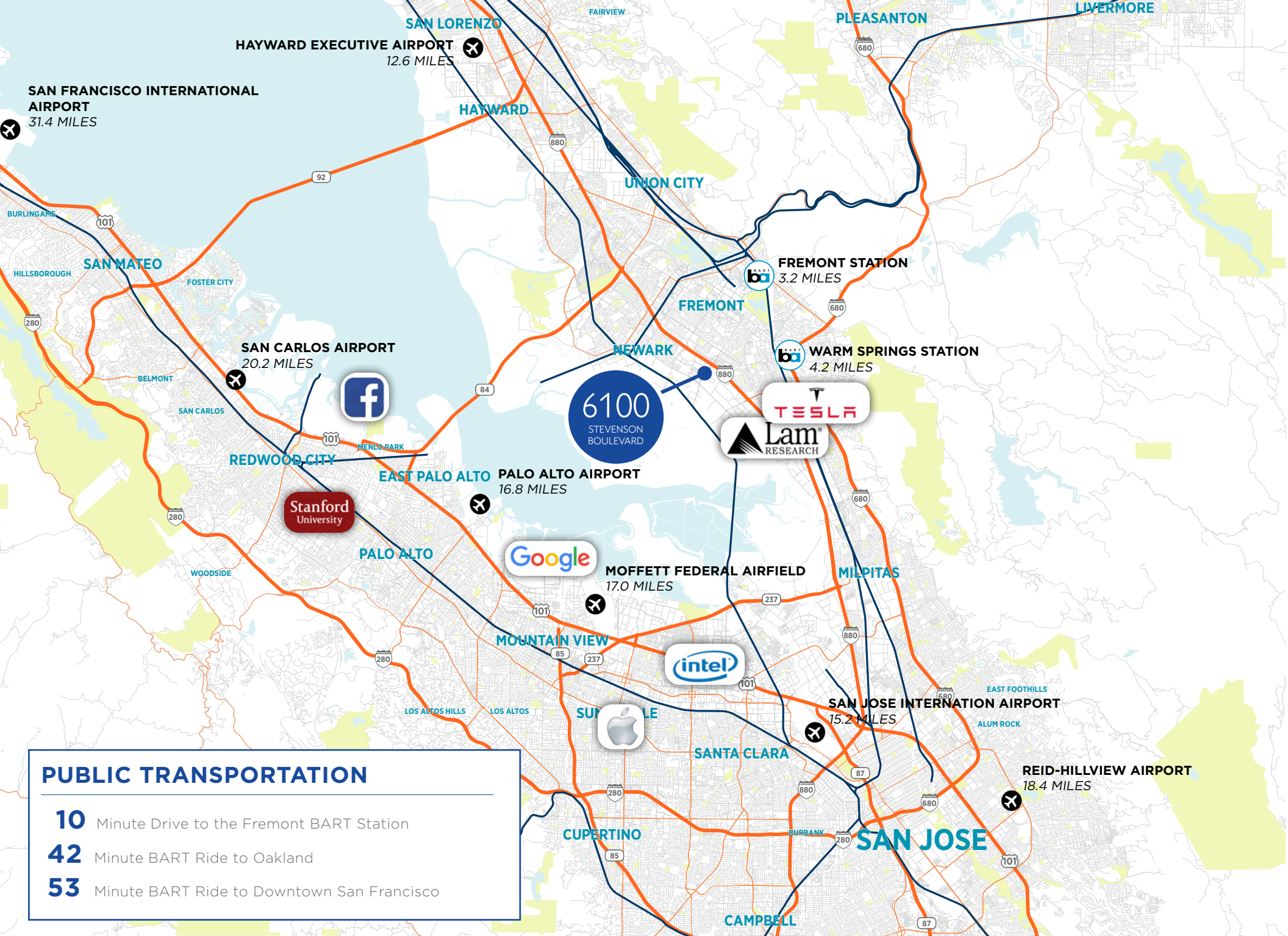

PUBLIC TRANSPORTATION

10 Minute Drive to the Fremont BART Station

42 Minute BART Ride to Oakland

53 Minute BART Ride to Downtown San Francisco

6100 STEVENSON BOULEVARD

FREMONT, CA

±10,000 - ±116,780 SF FOR LEASE

CONTACT

Walt Stephenson | walt.stephenson@cushwake.com | +1 408 615 3458 | LIC. 01793438

Alan Guterman | alan.guterman@cushwake.com | +1 408 615 3414 | LIC. 00884495

Kelly Yoder | kelly.yoder@cushwake.com | +1 408 615 3427 | LIC. 01821117

Jon DeCoite | jon.decoite@cushwake.com | +1 408 615 3408 | LIC. 01471300

Steve Horton | steve.horton@cushwake.com | +1 408 615 3412 | LIC. 01127340

